



YAMAHA

MX100F

SUPPLEMENTARY ASSEMBLY MANUAL



LIT-11666-01-63

www.legends-yamaha-enduros.com

90894-07841

FOREWORD

This supplementary Assembly Manual for MX100F has been published to supplement the Assembly Manual for DT100D. For complete information on assembly procedures, it is necessary to use this Supplementary Assembly Manual together with the Assembly Manual for the DT100D (90894-07620) (LIT-11666-00-36).

NOTICE

The service specifications given in this Assembly Manual are based on the model as manufactured. If the design of this model is modified, the service specifications may be subject to change in the future.

If any significant change is introduced into the specifications or service procedure, Yamaha dealers will be notified through technical service information to be published by Yamaha.

The assembly procedure is described in the order that the mechanic should follow, and the correct service tools should be used in the correct and professional manner. For this reason, this manual is directed only to trained and experienced Yamaha service personnel. Failure to correctly assemble and service this machine could lead to damage to the machine and possible injury to its operator.

**MX100F
SUPPLEMENTARY ASSEMBLY MANUAL
1st EDITION, OCTOBER 1978
OVERSEAS SERVICE DEPARTMENT
YAMAHA MOTOR CO., LTD.
IWATA, JAPAN
LIT-11666-01-63**

www.legends-yamaha-enduros.com

PARTS CHECK LIST

Parts List: Cardboard crate

No.	Part name	Q'ty
1	Seat	1
2	Front wheel assembly	1
3	Foot rest	1
4	Front fender	1
5	Carton box "A"	1

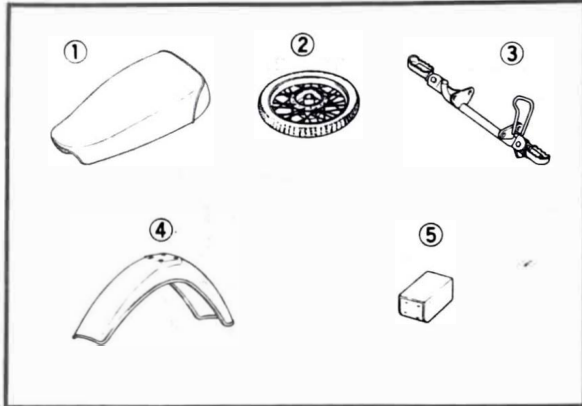

Parts List: Vinyl bag "A"

No.	Part name	Q'ty	Remarks
1	Plate washer	4	Front fender
2	Bolt with washer	4	
3	Nut	4	
4	Bolt with washer	2	Wire holder
5	Stopper	1	Seat
6	Clevis pin	1	
7	Bolt with washer	1	Front wheel
8	Cotter pin	1	
9	Clamp	2	Tank breather hose
10	Bolt	1	Foot rest
11	Bolt	1	



Parts List: Carton box "A"

No.	Part name	Q'ty
1	Owner's manual	1
2	Tool kit	1
3	Tool band	1
4	Tool cover	1
5	Tank breather hose	1
6	Wire holder	1
7	Switch cord band	2
8	Vinyl bag "A"	1

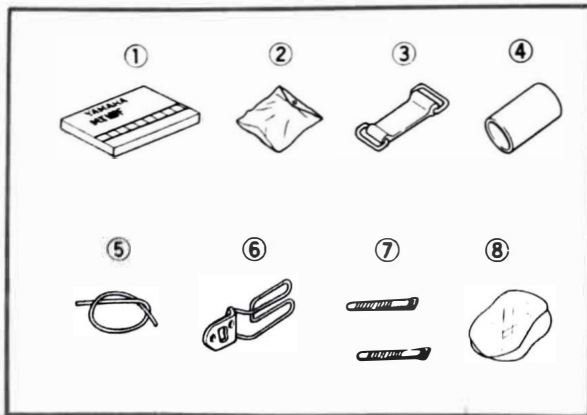

Parts List: Foam tray

No.	Part name	Q'ty
1	Brake shoe plate assembly	1
2	Brake cable assembly	1
3	Shift pedal	1
4	Handlebar assembly	1
5	Collar	1
6	Vinyl bag "B"	1

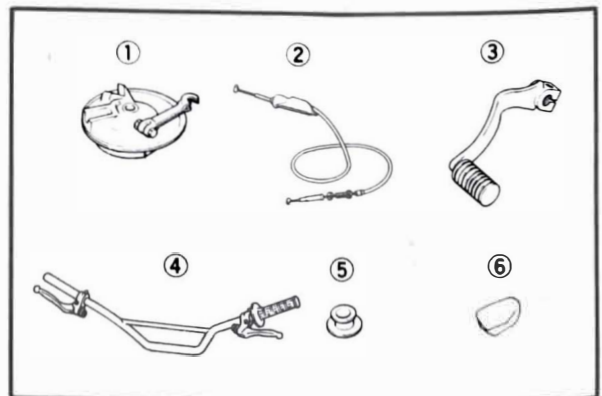

Parts List: Vinyl bag "B"

SET-UP PROCEDURES

No.	Part name	Q'ty	Remarks
1	Bolt	1	Shift pedal
2	Handle upper holder	2	Handlebar
3	Flange bolt	4	

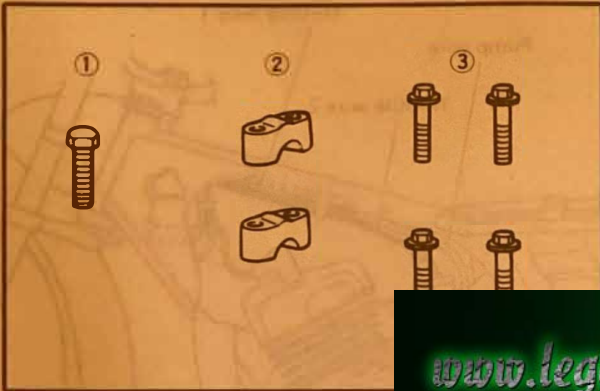

NOTE:

This model is designed upon the DT100D but built as an off-road machine like the YZ series machine, so the headlight, speedometer, flasher lights, taillight, and battery are removed. When assembling this model, refer to the DT100D (90894-07620) (LIT-11666-00-36) Assembly Manual.

CABLE ROUTING DIAGRAM

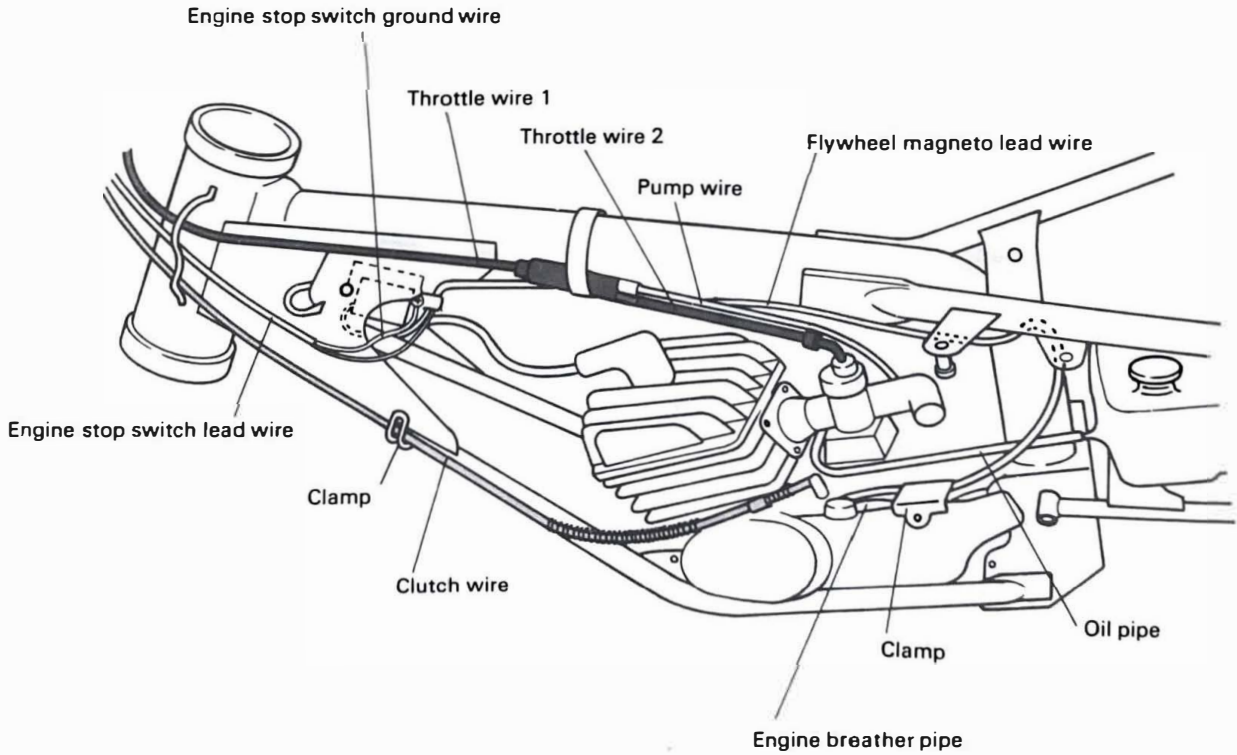
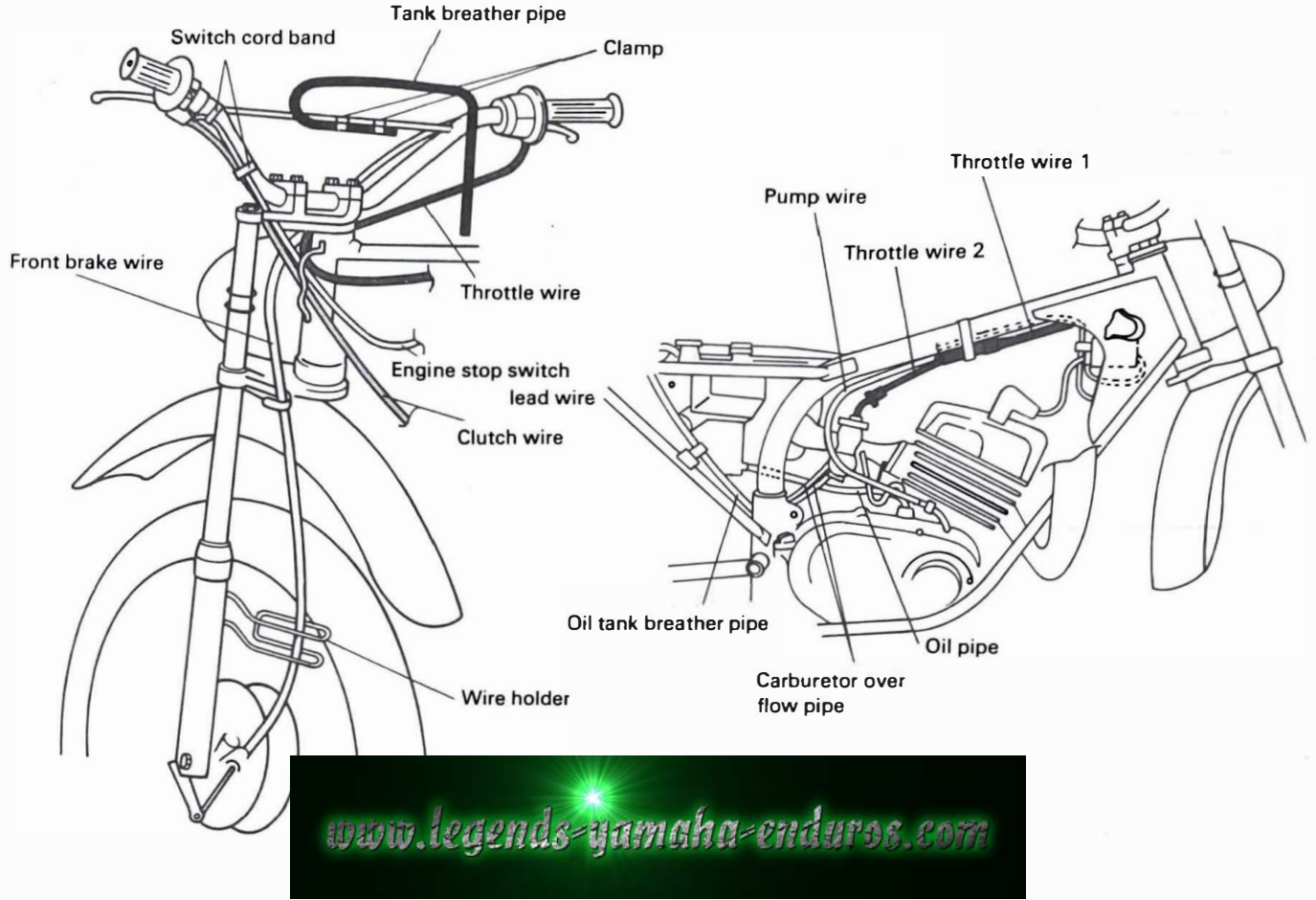

www.legends-yamaha-enduros.com



YAMAHA MOTOR CO., LTD.

IWATA, JAPAN

PRINTED IN JAPAN
78 · 10 · 2 15 x 1 CR