



YAMAHA

www.legends-yamaha-enduros.com

YZ60K

SUPPLEMENTARY ASSEMBLY MANUAL

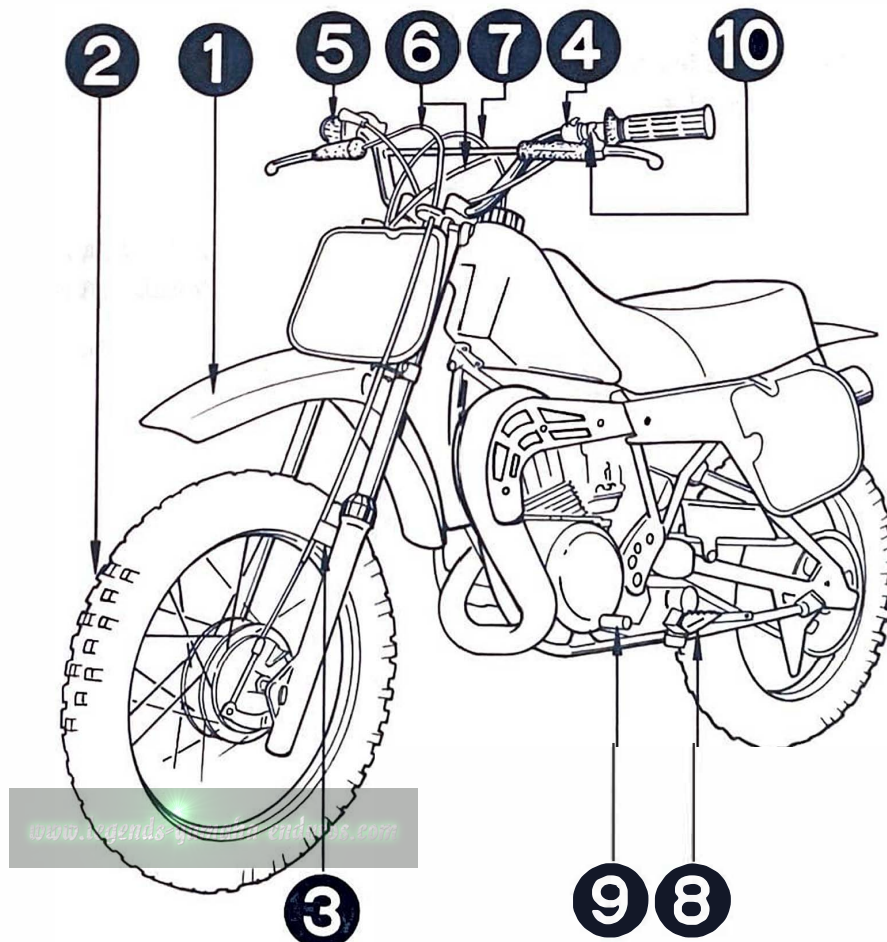

FOREWORD

This Supplementary assembly manual has been prepared to introduce the setup procedures and pre-delivery service for the YZ60K.

For complete information, it is necessary to use the YZ/IT series Basic assembly manual (LIT-11666-03-31) together with this Supplementary assembly manual.

NOTICE

The service specifications given in this Supplementary assembly manual are based on the model as manufactured. Modifications and significant changes in specifications and/or procedures will be forwarded to Authorized Yamaha Dealers. The procedures below are described in the order that the procedures are carried out correctly and completely. Failure to do so can result in poor performance and possible harm to the machine and/or rider.

CONCERNING CRATE DAMAGE: _____
Follow the instructions in the Dealer warranty handbook, Procedure section.

Particularly important information is distinguished in this manual by the following notations:

NOTE: A NOTE provides key information to make procedure easier or clearer.

CAUTION: A CAUTION indicates special procedures that must be followed to avoid damage to the machine.

WARNING: A WARNING indicates special procedures that must be followed to avoid injury to a machine operator or person inspecting or repairing the machine.

SERVICE DEPT.
INTERNATIONAL DIVISION
YAMAHA MOTOR CO., LTD.

YZ60K SUPPLEMENTARY ASSEMBLY MANUAL

© 1982 by Yamaha Motor Corporation, U.S.A.

1st edition, MAY 1982

All rights reserved. Any reprinting or
unauthorized use without the written permission
of Yamaha Motor Corporation, U.S.A., is
expressly prohibited.

Printed in U.S.A.

LIT-11666-03-80

GLOSSARY

(Symbols most commonly used)

- C:** The "C" marked parts are contained in the small carton box.
- S:** The "S" marked parts are contained in the styrofoam tray (Upper or Lower)
- V:** The "V" marked parts are contained in the vinyl bag.
- ✳:** The asterisked (✳) parts are temporarily fitted on the machine.

SETUP PROCEDURES

NOTE:

Please read the following chapters in the Basic assembly manual before proceeding to the set-up.

CHAPTER 1: INTRODUCTION

CHAPTER 2: SETUP AND PREDELIVERY CHECK

CHAPTER 3: TOOLS AND TORQUE SPECIFICATIONS

CHAPTER 4: CRATES

CHAPTER 5: INSTALLATION PROCEDURES

1 Front fender [F.F-B]

Parts list

No.	Part name	Qty	Locating mark	Remarks
1	Front fender	1	S	
2	Hexagon bolt with spring washer	4	V	d = 6 mm (0.24 in) ℓ = 16 mm (0.64 in)
3	Plain washer	4	V	d = 6 mm (0.24 in)

2 Front wheel [F.W-A]

Parts list

No.	Part name	Qty	Locating mark	Remarks
1	Front wheel	1	S	
2	Front wheel axle	1	*	d = 10 mm (0.4 in) ℓ = 00 mm (0.0 in)
3	Wheel axle collar	1	S	d = 10 mm (0.4 in)
4	Brake shoe plate assembly	1	S	
5	Plain washer	—	—	—
6	Castle nut	1	*	d = 10 mm (0.4 in)
7	Cotter pin	1	V	

3 Cable holder (Left) [C.H-D]

Parts list

No.	Part name	Qty	Locating mark	Remarks
1	Cable holder	2	*	
2	Panhead screw	1	*	d = 6 mm (0.24 in) ℓ = 12 mm (0.48 in)
3	Spring washer	1	*	d = 6 mm (0.24 in)

4 Handlebar [H.B-A]

Parts list

No.	Part name	Qty	Locating mark	Remarks
1	Handlebar	1	S	
2	Flange bolt	4	V	d = 8 mm (0.32 in) ℓ = 35 mm (1.38 in)
3	Handlebar upper holder	2	V	

5 Throttle grip [T.G-B]

Parts list

No.	Part name	Qty	Locating mark	Remarks
1	Throttle grip	1	*	
2	Panhead screw	2	*	d = 5 mm (0.2 in) ℓ = 16 mm (0.64 in)

6 Brake and clutch cable [B.C-A]

7 Fuel tank breather pipe [F.B-C]

Parts list

No.	Part name	Qty	Locating mark	Remarks
1	Fuel tank breather pipe	1	C	Rubber

8 Footrest [F.R-B]

Parts list

No.	Part name	Qty	Locating mark	Remarks
1	Footrest (left)	1	V	
2	Hexagon bolt	1	V	d = 10 mm (0.4 in) ℓ = 16 mm (0.64 in)
3	Plain washer	1	V	d = 10 mm (0.4 in)

9 Change pedal [C.P-B]

Parts list

No.	Part name	Qty	Locating mark	Remarks
1	Change pedal	1	V	
2	Hexagon bolt	1	V	d = 6 mm (0.24 in) ℓ = 20 mm (0.8 in)

10 Engine stop switch [E.S-B]

Parts list

No.	Part name	Qty	Locating mark	Remarks
1	Engine stop switch	1	*	
2	Panhead screw	1	V	d = 3 mm (0.12 in)
3	Plain washer	1	V	d = 3 mm (0.12 in)
4	Engine stop switch holder (upper and lower)	2	V	
5	Hexagon nut	1	V	d = 3 mm (0.12 in)
6	Handlebar band	3	C	

CABLE ROUTING

CAUTION:

Proper cable and lead routing is essential to insure safe vehicle operation.

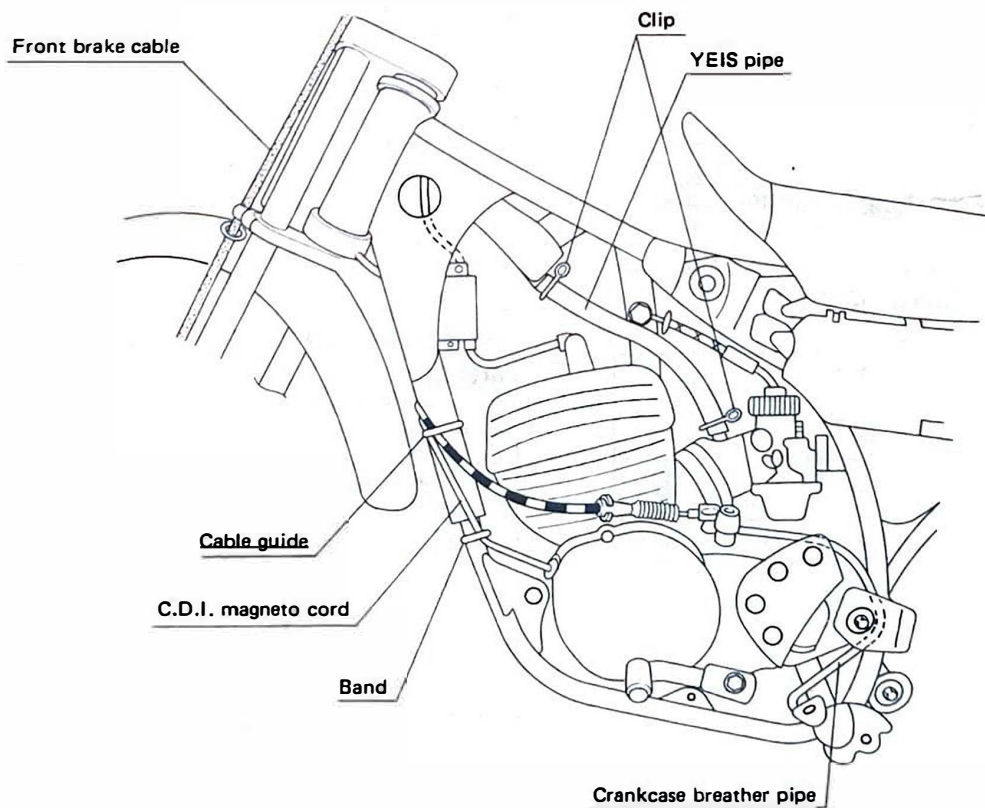
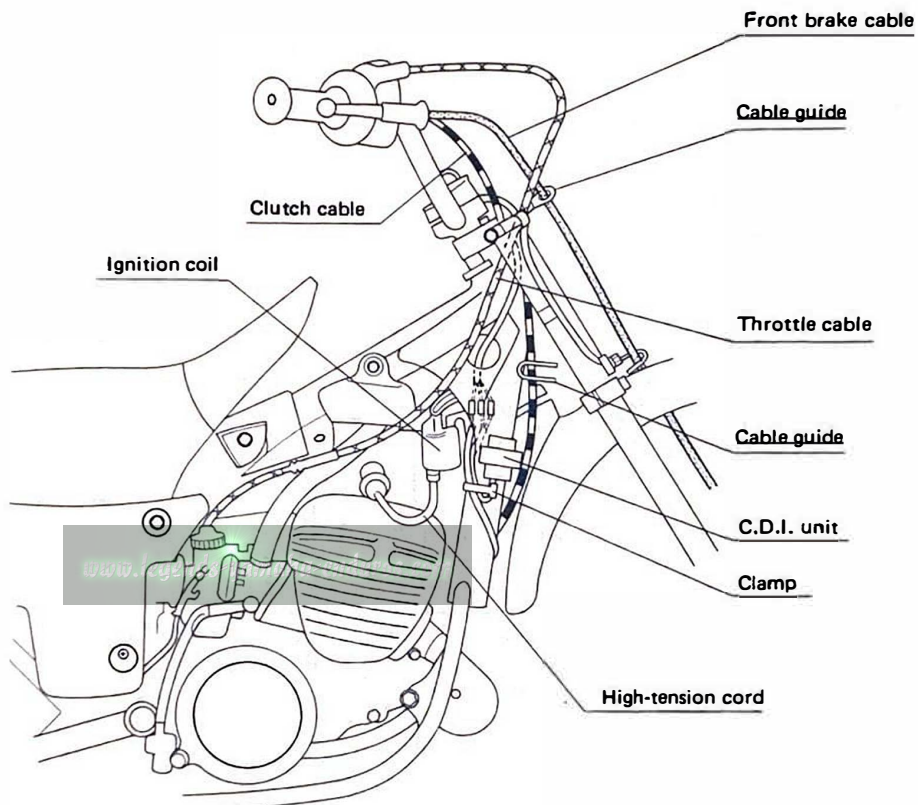

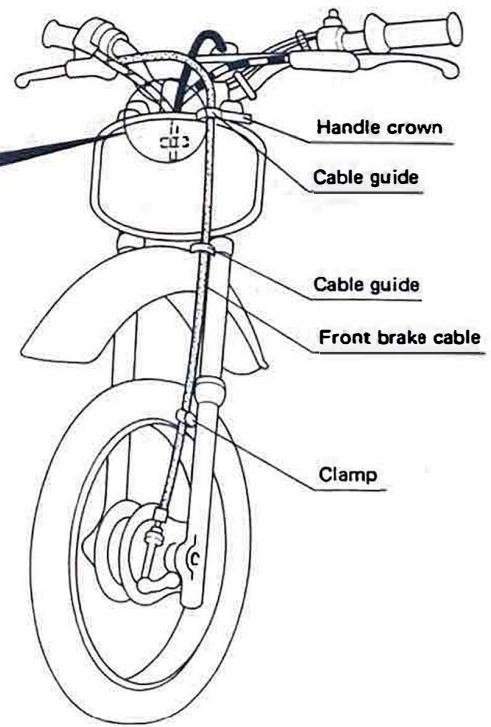
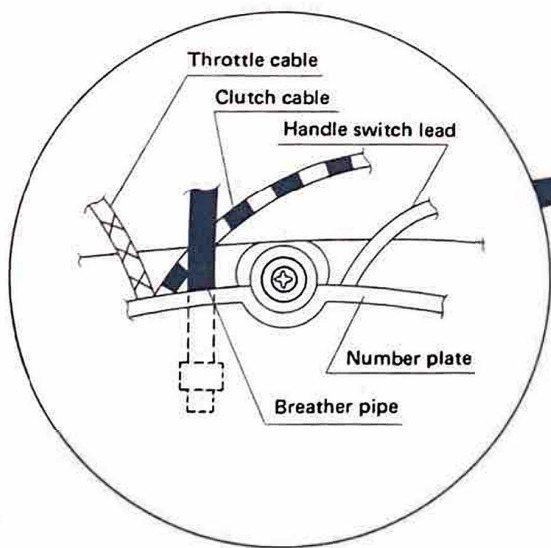
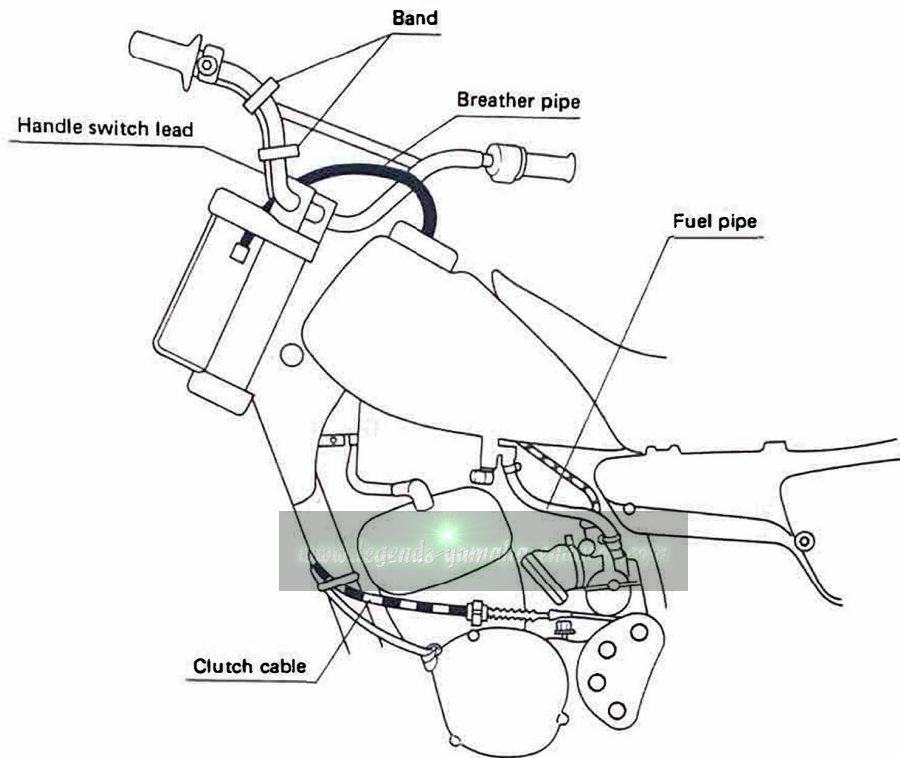

ADJUSTMENTS AND PREDELIVERY SERVICE

NOTE: _____

Please read the following chapter in the Basic assembly manual before proceeding to the adjustments and predelivery service.

CHAPTER 6: APPENDICES

1 Front brake adjustment [F.B-A]

Front brake lever free play:
5 ~ 8 mm (0.2 ~ 0.3 in)

2 Rear brake adjustment [R.B-A]

Rear brake pedal free play:
20 ~ 30 mm (0.8 ~ 1.2 in)

3 Clutch adjustment [C.A-A]

Clutch lever free play:
2 ~ 3 mm (0.08 ~ 0.12 in)

4 Throttle cable adjustment [T.C-A]

Throttle cable free play:
3 ~ 5 mm (0.12 ~ 0.21 in)

5 Fuel draining [F.D-A]

6 Transmission oil replacement [T.R-A]

7 Drive chain tension check [D.C-A]

Drive chain deflection:
5 ~ 10 mm (0.2 ~ 0.4 in)

8 Troubleshooting [T.S-A]

SERVICE DATA

Idling engine speed:	As desired (S.T.D. 1350 r/min)
Spark plug: Type Gap	N-2 (CHAMPION) 0.7 ~ 0.8 mm (0.028 ~ 0.031 in)
Fuel: Recommended fuel Fuel tank capacity	Premium gasoline (Mixed gas 24 : 1) 3.3 L (1.0 Imp gal, 0.9 US gal)
Engine oil: Recommended oil	Yamalube Racing 2-cycle oil (See Owner's manual)
Transmission oil: Recommended oil Oil quantity (Periodic oil change)	Yamalube 4-cycle oil or SAE 10W30 SE motor oil 0.65 ~ 0.7 L (0.57 ~ 0.61 Imp qt, 0.69 ~ 0.74 US qt)
Tire pressure (Cold tire pressure): Front Rear	98 kPa (1.0 kg/cm ² , 14 psi) 98 kPa (1.0 kg/cm ² , 14 psi)

TORQUE SPECIFICATION CHART

Parts to be tightened		Bolt/nut size	Tightening torque		
			Nm	m•kg	ft•lb
Engine:					
	Spark plug	M14	25	2.5	18
	Drain plug	M12	20	2.0	14
Chassis:					
	Front fender and under bracket (F.F-B # 1)	M6 x 1.0	6	0.6	4.3
	Front wheel axle and nut (F.W-A # 1)	M10 x 1.25	35	3.5	25
	Handlebar upper holder and handlebar lower holder (H.B-A # 1)	M8 x 1.25	15	1.5	11
	Front footrest (Right) and frame (F.R-B # 1)	M10 x 1.25	50	5.0	36
	Change pedal (C.P-B # 1)	M6 x 1.0	6	0.6	4.3
	Cam shaft lever and cam shaft	M6 x 1.0	6	0.6	4.3
	Handle crown and steering shaft	M14 x 1.25	58	5.8	42
	Handle crown and inner tube	M8 x 1.25	15	1.5	11
	Engine mounting: Front	M8 x 1.25	24	2.4	17
	Under	M8 x 1.25	24	2.4	17
	Pivot shaft and lock nut	M12 x 1.25	50	5.0	36
	Rear wheel axle and nut	M12 x 1.25	45	4.5	32
	Rear hub and stud bolt	M8 x 1.25	30	3.0	22
	Sprocket mounting nut	M8 x 1.25	26	2.6	19
	Fuel tank and holder damper	M6 x 1.0	7	0.7	5.1
	Fuel tank and frame	M6 x 1.0	7	0.7	5.1
	Side stand and frame	M8 x 1.25	20	2.0	14
	Rear fender and frame	M6 x 1.0	7	0.7	5.1
	Chain case and rear arm	M5 x 0.8	2.5	0.25	1.4

OWNER'S TOOL KIT

No.	Part name	Q'ty
1	Owner's tool bag	1
2	Spark plug wrench	1
3	Spark plug wrench handle	1
4	Special spanner	1

www.legends-yamaha-enduros.com



YAMAHA MOTOR CO., LTD.

IWATA, JAPAN

PRINTED IN U.S.A.