

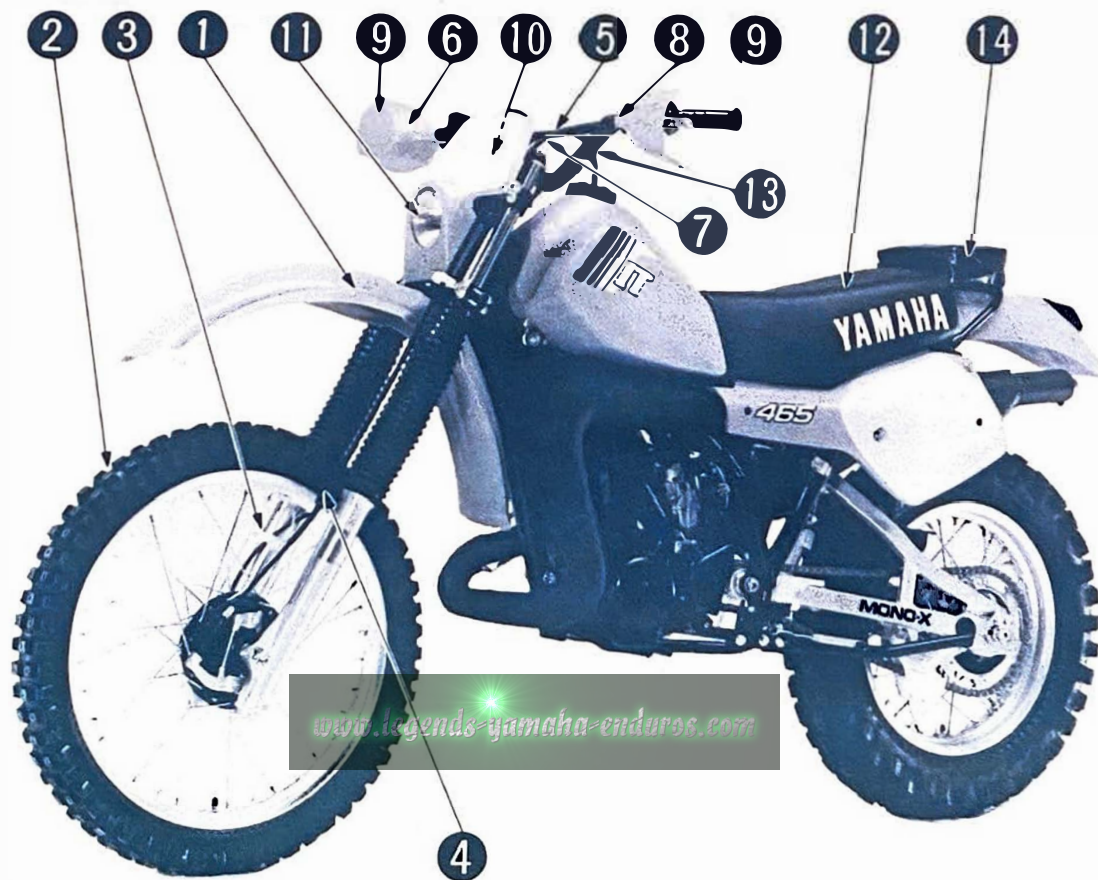

YAMAHA

IT465J

SUPPLEMENTARY ASSEMBLY MANUAL



FOREWORD

This Supplementary assembly manual has been prepared to introduce the setup procedures and predelivery service for the IT465J.

For complete information, it is necessary to use the YZ/IT series Basic assembly manual (LIT-11666-03-31) together with this Supplementary assembly manual.

NOTICE

The service specifications given in this Supplementary assembly manual are based on the model as manufactured. Modifications and significant changes in specifications and/or procedures will be forwarded to Authorized Yamaha Dealers. The procedures below are described in the order that the procedures are carried out correctly and completely. Failure to do so can result in poor performance and possible harm to the machine and/or rider.

CONCERNING CRATE DAMAGE:

Follow the instructions in the Dealer warranty handbook, Procedure section.

Particularly important information is distinguished in this manual by the following notations:

NOTE:

A NOTE provides key information to make procedure easier or clearer.

CAUTION:

A CAUTION indicates special procedures that must be followed to avoid damage to the machine.

WARNING:

A WARNING indicates special procedures that must be followed to avoid injury to a machine operator or person inspecting or repairing the machine.

SERVICE DEPT.
INTERNATIONAL DIVISION
YAMAHA MOTOR CO., LTD.

IT465J SUPPLEMENTARY ASSEMBLY MANUAL

© 1981 by Yamaha Motor Corporation, U.S.A.

1st edition, August 1981

**All rights reserved. Any reprinting or
unauthorized use without the written permission
of Yamaha Motor Corporation, U.S.A., is
expressly prohibited.**

Printed in U.S.A.

LIT-11666-03-11

GLOSSARY

(Symbols most commonly used)

- C:** The "C" marked parts are contained in the small carton box.
- S:** The "S" marked parts are contained in the styrofoam tray (Upper or Lower).
- V:** The "V" marked parts are contained in the vinyl bag.
- ***: The asterisk (*) parts are temporarily fitted on the machine.

SETUP PROCEDURES

NOTE:

Please read the following chapters in the Basic assembly manual before proceeding to the setup.

CHAPTER 1: INTRODUCTION

CHAPTER 2: SETUP AND PREDELIVERY CHECK

CHAPTER 3: TOOLS AND TORQUE SPECIFICATIONS

CHAPTER 4: CRATES

CHAPTER 5: INSTALLATION PROCEDURES

① Front fender [F.F-A]

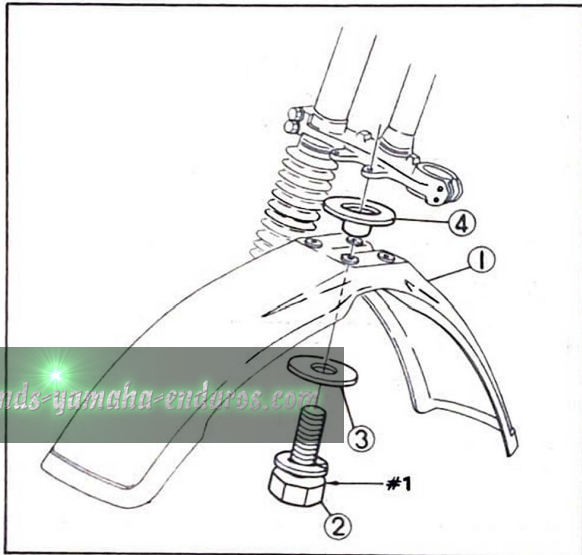

Parts list

No.	Part name	Q'ty	Locating mark	Remarks
1	Front fender	1	S	
2	Hexagon bolt with spring washer	4	V	d = 6 mm (0.24 in), l = 20 mm (0.79 in)
3	Plain washer	4	V	d = 6 mm (0.24 in)
4	Special washer	4	V	d = 6 mm (0.24 in)

② Front wheel [F.W-D]

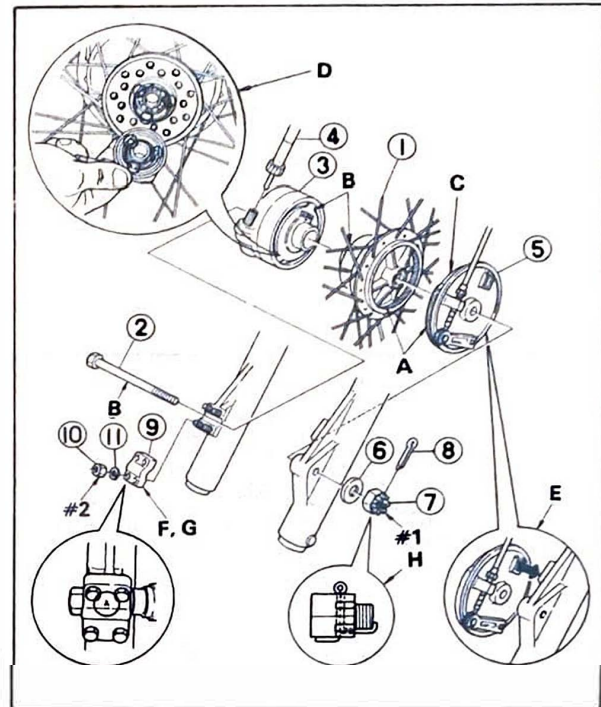

Parts list

No.	Part name	Q'ty	Locating mark	Remarks
1	Front wheel	1	S	
2	Front wheel axle	1	*	d = 15 mm (0.59 in)
3	Speedometer housing	1	S	
4	Speedometer cable	1	S	
5	Brake shoe plate assembly	1	S	
6	Plain washer	1	*	d = 15 mm (0.59 in)
7	Castle nut	1	*	d = 14 mm (0.55 in)
8	Cotter pin	1	V	d = 3 mm (0.12 in), l = 30 mm (1.18 in)
9	Front wheel axle holder	1	*	
10	Hexagon nut	4	*	d = 8 mm (0.32 in)
11	Spring washer	4	*	d = 8 mm (0.32 in)

3 Cable holder (Right) [C.H-B]

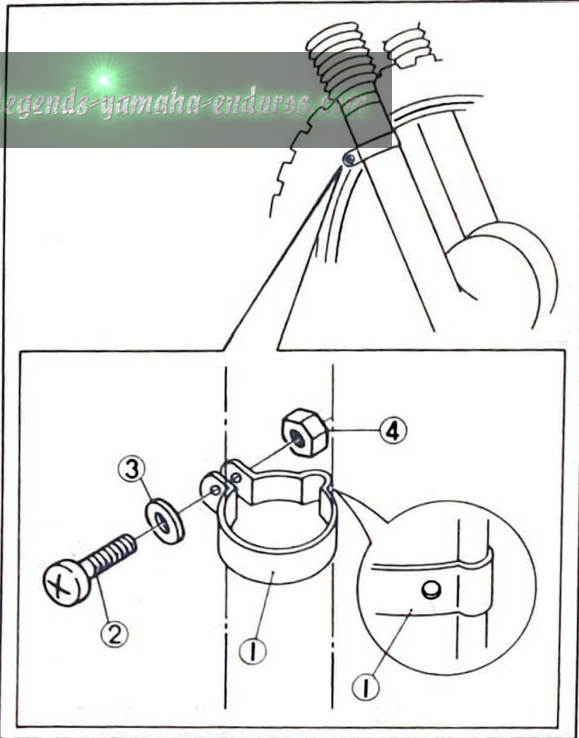

Parts list

No.	Part name	Q'ty	Locating mark	Remarks
1	Cable holder	1	C	
2	Panhead screw	1	V	d = 5 mm (0.2 in), ℓ = 18 mm (0.71 in)
3	Plain washer	1	V	d = 5 mm (0.2 in)
4	Hexagon nut	1	V	d = 5 mm (0.2 in)

4 Cable holder (Left) [C.H-C]

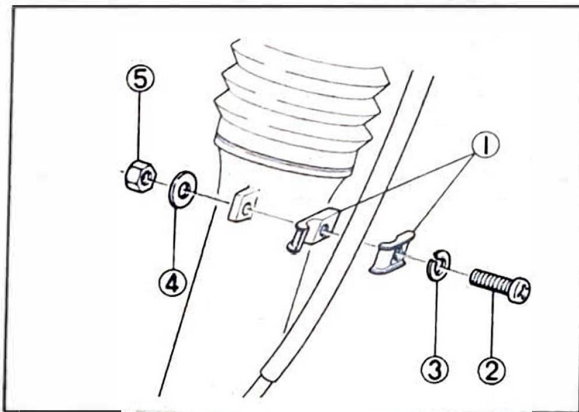

Parts list

No.	Part name	Q'ty	Locating mark	Remarks
1	Cable holder (Left and Right)	2	*	
2	Panhead screw	1	*	d = 6 mm (0.24 in), ℓ = 25 mm (0.98 in)
3	Spring washer	1	*	d = 6 mm (0.24 in)
4	Plain washer	1	*	d = 6 mm (0.24 in)
5	Hexagon nut	1	*	d = 6 mm (0.24 in)

5 Handlebar [H.B-A]

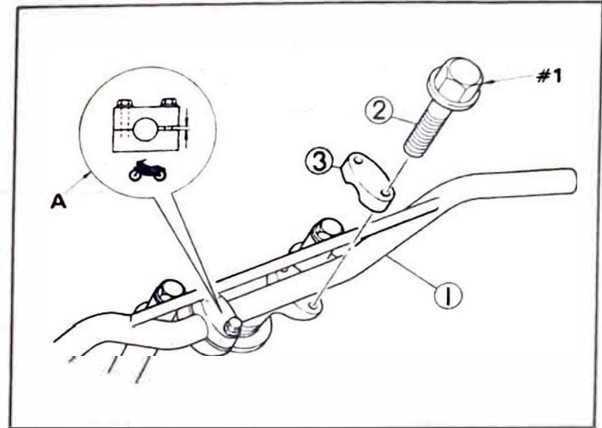

Parts list

No.	Part name	Q'ty	Locating mark	Remarks
1	Handlebar	1	S	
2	Flange bolt	4	V	d = 8 mm (0.32 in), ℓ = 35 mm (1.38 in)
3	Handlebar upper holder	2	V	

6 Throttle grip [T.G-A]

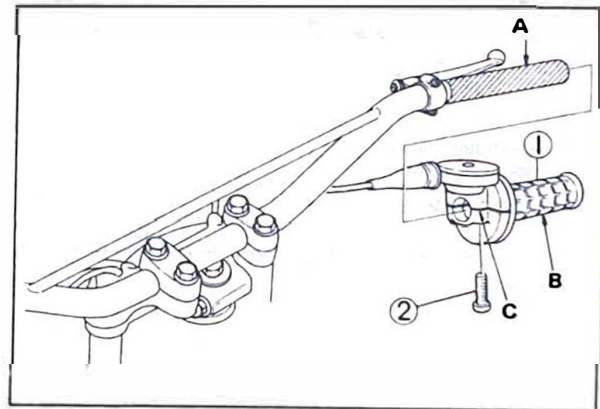

Parts list

No.	Part name	Q'ty	Locating mark	Remarks
1	Throttle grip	1	*	
2	Panhead screw	2	*	d = 5 mm (0.2 in), ℓ = 16 mm (0.63 in)

7 Brake and clutch cable [B.C-A]

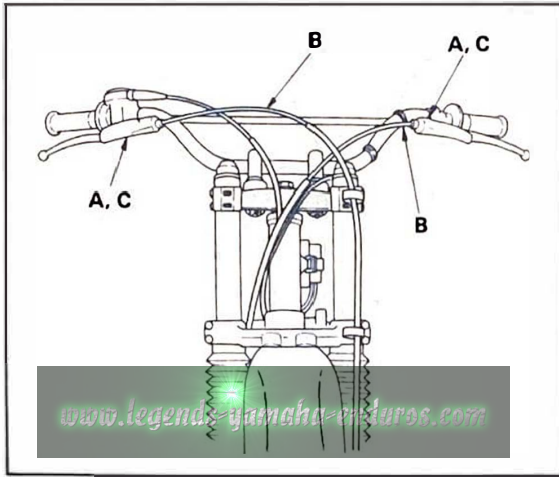

8 Engine stop switch [E.S-B]

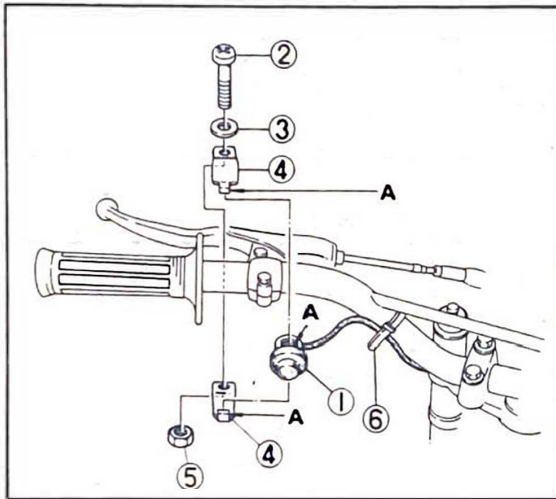

Parts list

No.	Part name	Q'ty	Locating mark	Remarks
1	Engine stop switch	1	*	
2	Panhead screw	1	V	d = 3 mm (0.12 in)
3	Plain washer	1	V	d = 3 mm (0.12 in)
4	Engine stop switch holder (Upper and Lower)	2	V	
5	Hexagon nut	1	V	d = 3 mm (0.12 in)
6	Handlebar band	2	V	Plastic

9 Bush guard [B.G-A]

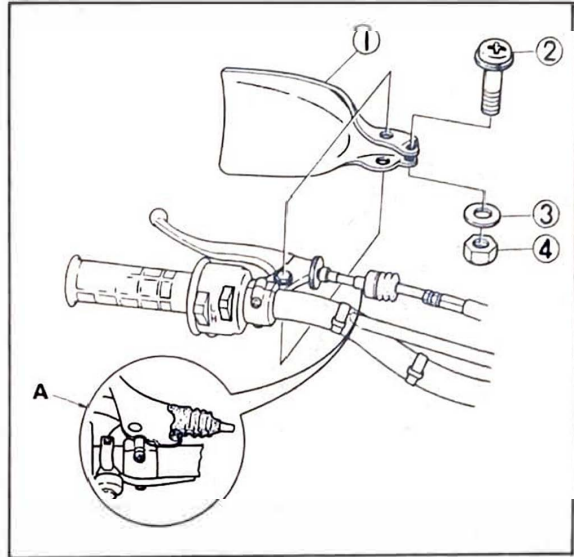

Parts list

No.	Part name	Q'ty	Locating mark	Remarks
1	Bush guard (Left and Right)	2	C	
2	Panhead screw with spring washer	2	V	d = 6 mm (0.24 in), l = 16 mm (0.63 in)
3	Plain washer	2	V	d = 6 mm (0.24 in)
4	Hexagon nut	2	V	d = 6 mm (0.24 in)

10 Meter assembly [M.A-A]

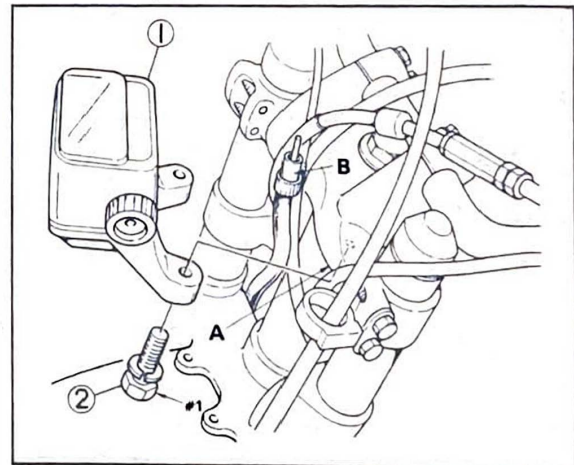

Parts list

No.	Part name	Q'ty	Locating mark	Remarks
1	Meter assembly	1	S	
2	Hexagon bolt with spring washer	2	V	d = 6 mm (0.24 in), l = 12 mm (0.47 in)

11 Headlight [H.L-B]

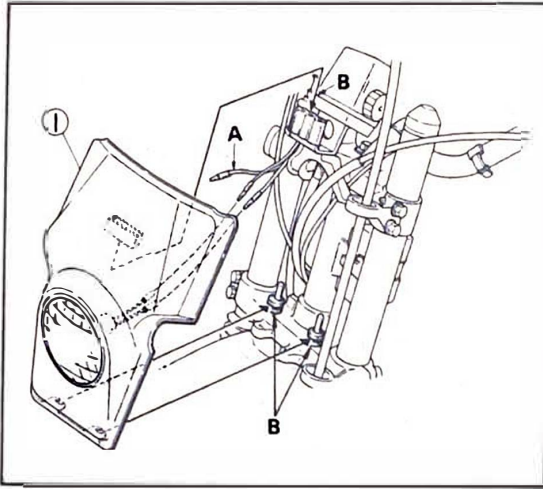

Parts list

No.	Part name	Q'ty	Locating mark	Remarks
1	Headlight assembly	1	S	

12 Fuel tank breather pipe [F.B-A]

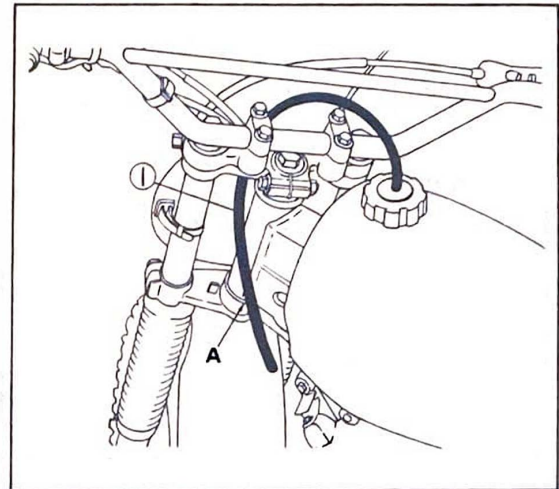

Parts list

No.	Part name	Q'ty	Locating mark	Remarks
1	Fuel tank breather pipe	1	C	Rubber

13 Seat [S.T-C]

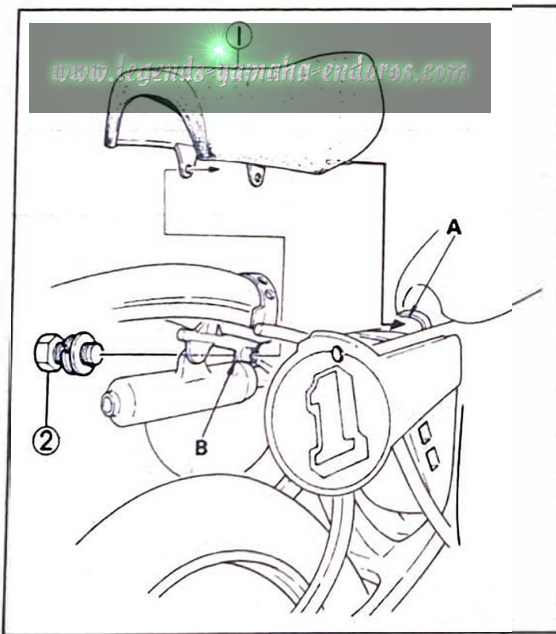

Parts list

No.	Part name	Q'ty	Locating mark	Remarks
1	Seat	1	S	
2	Hexagon bolt with spring washer and plain washer	2	V	d = 6 mm (0.24 in), l = 16 mm (0.63 in)

14 Tool kit [T.K-D]

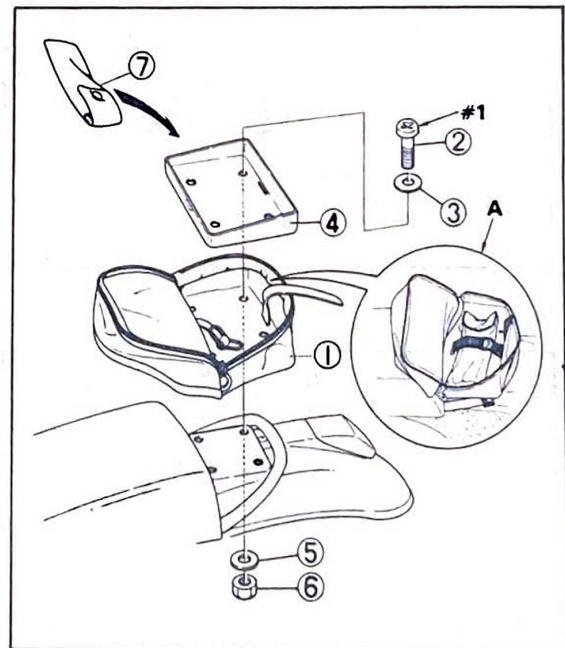

Parts list

No.	Part name	Q'ty	Locating mark	Remarks
1	Carrier box	1	S	
2	Panhead screw	4	V	d = 6 mm (0.24 in), l = 20 mm (0.79 in)
3	Plain washer	4	V	d = 6 mm (0.24 in)
4	Carrier box bracket	1	S	
5	Plain washer	4	V	d = 6 mm (0.24 in)
6	Hexagon nut	4	V	d = 6 mm (0.24 in)
7	Tool kit	1	C	

OFF-ROAD RIDING KIT

An off-road riding kit is provided with each vehicle to comply with noise level and spark arrester laws and regulations.

IMPORTANT NOTICE: _____

Always check the local regulations governing the areas where you will ride. An 86 dB(A) silencer spark arrester kit is provided with this vehicle for use where required. Installation of kit will reduce performance substantially. This vehicle may not be legally operated public streets, roads or high-ways. Such use is prohibited by law.

OFF-road riding kit

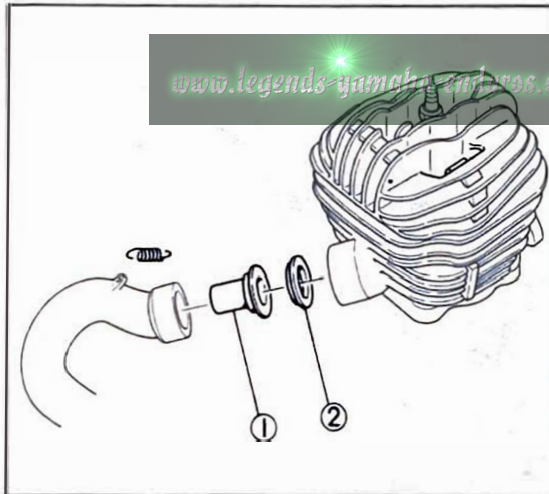

Parts list

No.	Part name	Q'ty	Locating mark	Remarks
1	Choke pipe	1	C	
2	Exhaust pipe gasket	1	*	

CABLE ROUTING

CAUTION:

Proper cable and lead routing is essential to insure safe vehicle operation. REFER TO "CABLE ROUTING".

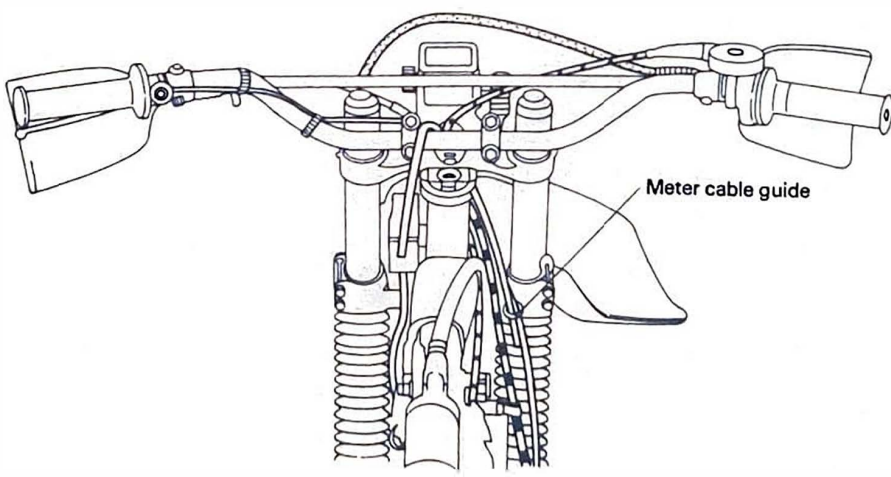
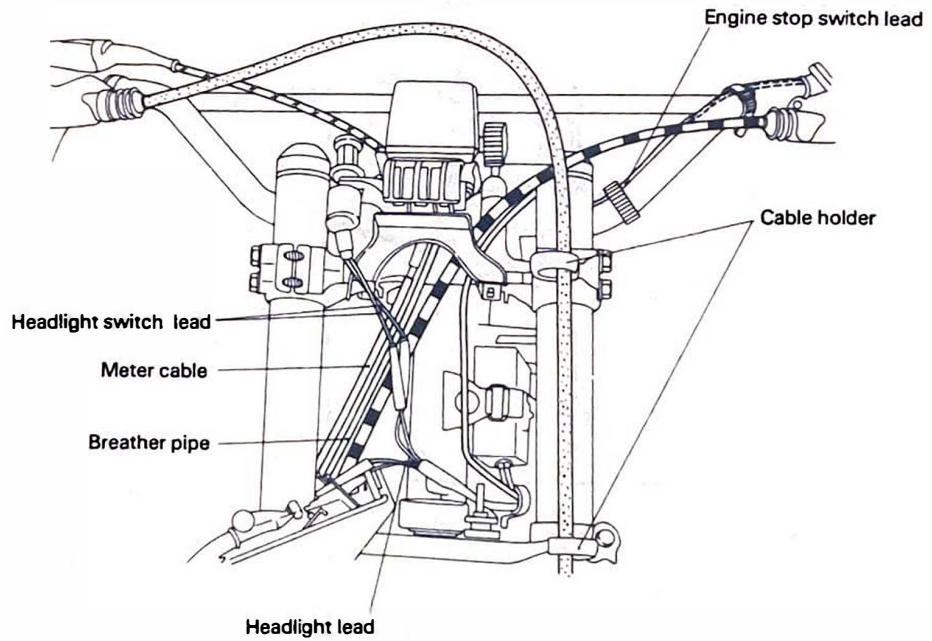
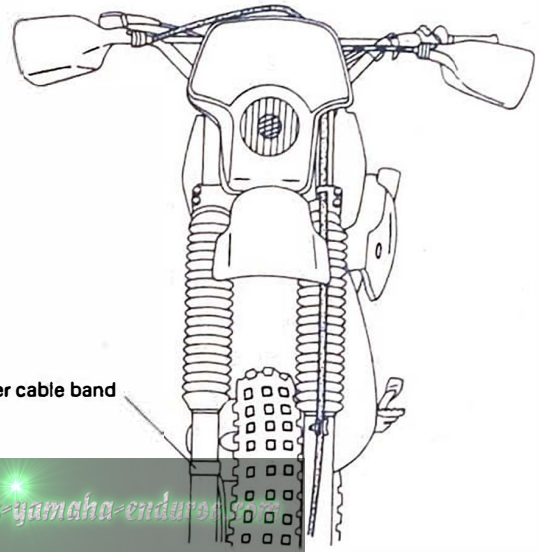

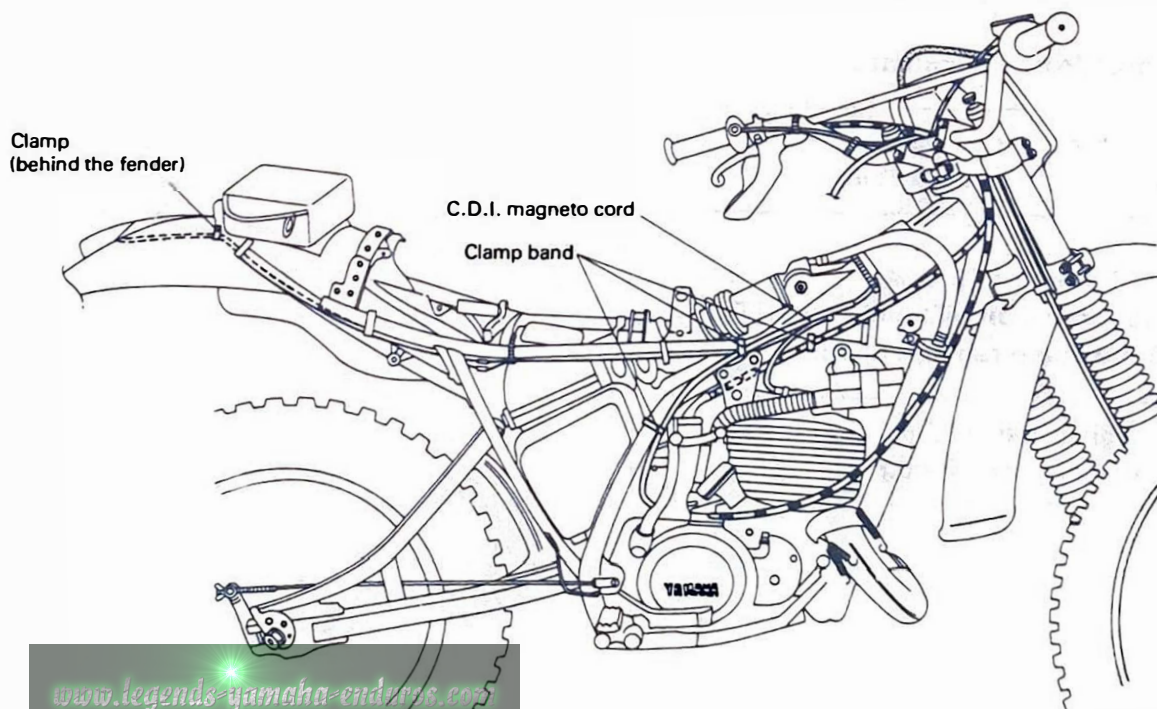
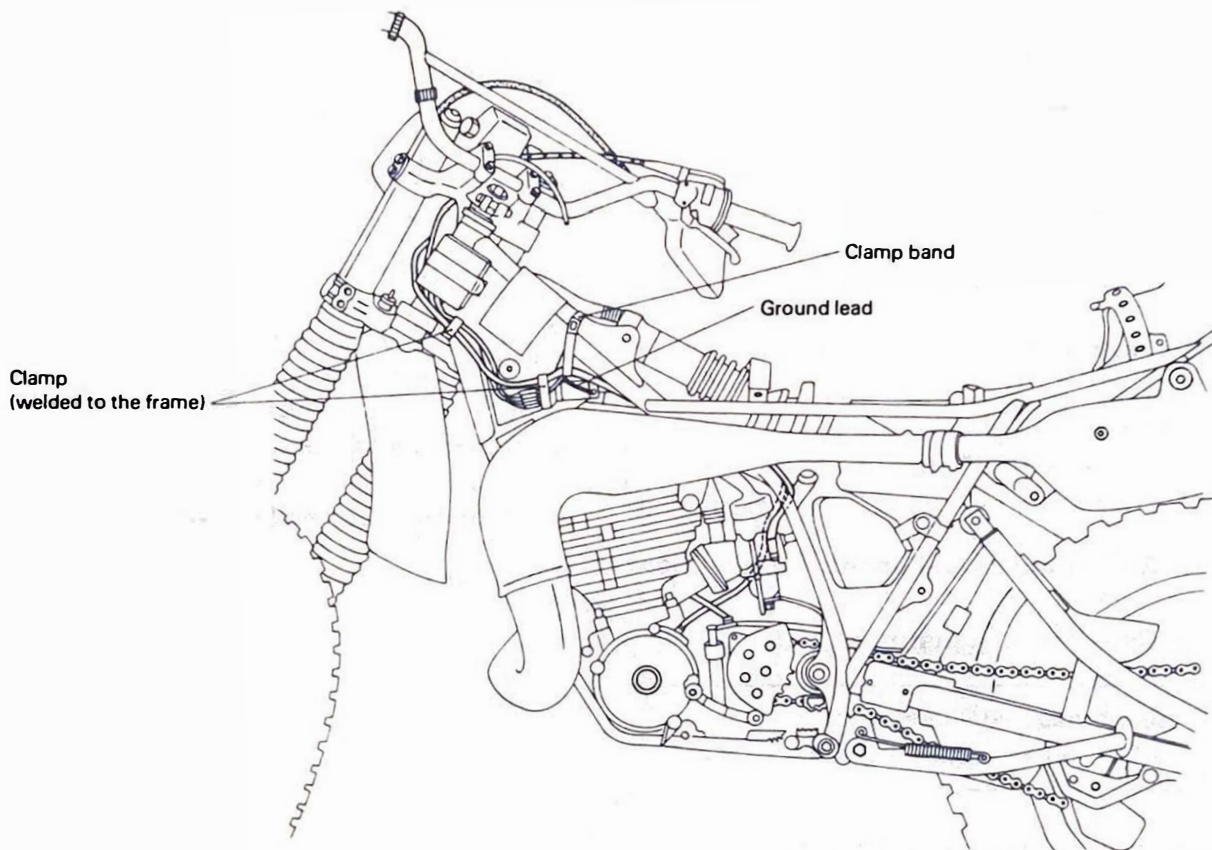

www.legends-yamaha-endless.com

ADJUSTMENTS AND PREDELIVERY SERVICE

NOTE: _____

Please read the following chapter in the Basic assembly manual before proceeding to the adjustments and predelivery service.

CHAPTER 6: APPENDICES

① Front brake adjustment [F.B-A]

Front brake lever free play:
5 ~ 8 mm (0.2 ~ 0.3 in)

② Rear brake pedal position adjustment [R.P-A]

③ Rear brake adjustment [R.B-A]

Rear brake pedal free play:
20 ~ 30 mm (0.8 ~ 1.2 in)

④ Clutch adjustment [C.A-B]

Clutch lever free play:
2 ~ 3 mm (0.08 ~ 0.12 in)

⑤ Throttle cable adjustment [T.C-A]

Throttle cable free play:
3 ~ 5 mm (0.12 ~ 0.21 in)

⑥ Fuel draining [F.D-A]

⑦ Transmission oil level check [T.L-A]

⑧ Drive chain tension check [D.C-A]

Drive chain deflection:
10 ~ 15 mm (0.4 ~ 0.6 in)

Handling of grease-sealed chain

Notes on handling

Cleaning:

To wash the grease-sealed chain, be sure to use kerosene. Never use a high pressure steam washing wire brush. It will damage O-rings and thus the chain will also be damaged or wear faster.

Oiling:

After washing, dry up the chain and coat it with SAE 30 ~ 50 motor oil.

Avoid using a conventional type lubricant because it contains a solvent.

⑨ Troubleshooting [T.S-A]

www.legends-yamaha-enduros.com

SERVICE DATA

Idling engine speed:	As desired
Spark plug: Type Gap	N-3 (CHAMPION) 0.6 ~ 0.7 mm (0.024 ~ 0.028 in)
Fuel: Recommended fuel Fuel tank capacity	Premium gasoline (Mixed gas 24 : 1) 13 L (3.43 US gal, 2.86 Imp gal)
Engine oil: Recommended oil	Yamalube Racing 2-cycle oil (See Owner's manual)
Transmission oil: Recommended oil Oil quantity (Periodic oil change)	Yamalube 4-cycle oil or SAE 10W 30 motor oil 750 cm ³ (0.79 US qt, 0.66 Imp qt)
Tire pressure (Cold tire pressure): Front Rear	98 kPa (1.0 kg/cm ² , 14 psi) 98 kPa (1.0 kg/cm ² , 14 psi)

TORQUE SPECIFICATION CHART

www.legends-yamaha-enduros.com

Parts to be tightened	Tightening torque		
	Nm	m · kg	ft · lb
Engine			
Spark plug M14	25	2.5	18
Drain plug M12	25	2.0	14
Chassis:			
Front fender M6 (F.F-A)	5	0.5	3.6
Front wheel axle M14 (F.W-D #1)	58	5.8	42
Front wheel axle holder M8 (F.W-D #2)	10	1.0	7.2
Handlebar upper holder M8 (H.B-A)	23	2.3	17
Throttle grip M5 (T.G-A)	5	0.5	3.6
Meter assembly M6 (M.A-A)	10	1.0	7.2
Seat M6 (S.T-C)	10	1.0	7.2
Carrier box M6 (T.K-D)	7	0.7	5.1
Kick crank M12	50	5.0	36
Change pedal M6	10	1.0	7.2
Handle crown:			
Steering shaft M22	95	9.5	68
Inner tube M8	23	2.3	17
Pivot shaft M16	80	8.0	58
Rear wheel axle M18	100	10.0	72
Rear shock absorber M10	30	3.0	22
Tension bar M8	23	2.3	17
Camshaft lever (brake) M6	10	1.0	7.2
Footrest M12	100	10.0	72

OWNER'S TOOL KIT

No.	Part name	Q'ty
1	Owner's tool bag	1
2	Spanner (10-12)	1
3	Spanner (14-17)	1
4	Spoke nipple wrench	1
5	Screwdriver grip	1
6	Screwdriver cap	1
7	Screwdriver bit (Phillips head)	1
8	Screwdriver bit (Phillips head-Slotted head)	1
9	Pliers	1
10	Hexagon wrench (8)	1
11	Special spanner (19-22)	1
12	Special spanner (22-24)	1
13	Special spanner (32)	1
14	Spark plug wrench	1



www.legends-yamaha-enduros.com



YAMAHA MOTOR CO.,LTD.

IWATA, JAPAN

PRINTED IN U.S.A.