



YAMAHA

www.legends-yamaha-enduros.com

YZ80F

SUPPLEMENTARY ASSEMBLY MANUAL



FOREWORD

This supplementary Assembly Manual for YZ80F has been published to supplement the Assembly Manual for YZ80E. For complete information on assembly procedures, it is necessary to use this Supplementary Assembly Manual together with the Assembly Manual for the YZ80E (90894-07742) (LIT-11666-00-88).

NOTICE

The service specifications given in this Assembly Manual are based on the model as manufactured. If the design of this model is modified, the service specifications may be subject to change in the future.

If any significant change is introduced into the specifications or service procedure, Yamaha dealers will be notified through technical service information to be published by Yamaha.

The assembly procedure is described in the order that the mechanic should follow, and the correct service tools should be used in the correct and professional manner. For this reason, this manual is directed only to trained and experienced Yamaha service personnel. Failure to correctly assemble and service this machine could lead to damage to the machine and possible injury to its operator.

**YAMAHA YZ80F
SUPPLEMENTARY ASSEMBLY MANUAL
1st EDITION, July 1978
OVERSEAS SERVICE DEPARTMENT
YAMAHA MOTOR CO., LTD.
IWATA, JAPAN
LIT-11666-01-36**

www.legends-yamaha-enduros.com

PARTS CHECK LIST

Parts List: Foam tray

No.	Part name	Q'ty
1	Owner's manual	1
2	Tool kit	1
3	Number plate	1
4	Brake shoe plate ass'y	1
5	Brake wire	1
6	Handlebar ass'y	1
7	Vinyl bag "1"	1
8	Vinyl bag "2"	1

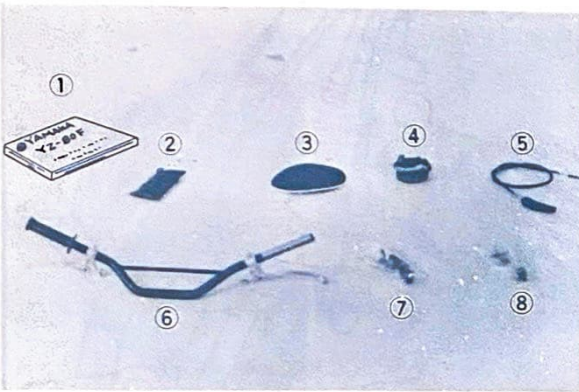

Parts List: Carton box

No.	Part name	Q'ty
1	Semi double seat	1
2	Front fender	1
3	Footrest ass'y	1
4	Front wheel ass'y	1

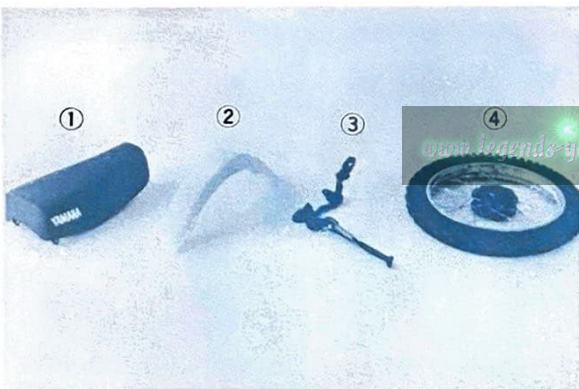

Parts List: Vinyl bag "1"

No.	Part name	Q'ty	Remarks
1	Cotter pin	1	Front wheel
2	Fuel tank breather pipe	1	Fuel tank
3	Bolt	4	Footrest
4	Spring washer	4	
5	Damper	4	Front fender
6	Collar	4	
7	Plate washer	4	
8	Bolt with spring washer	4	
9	Handlebar switch cord	1	Handlebar
10	Bolt with spring washer (Left)	1	Seat

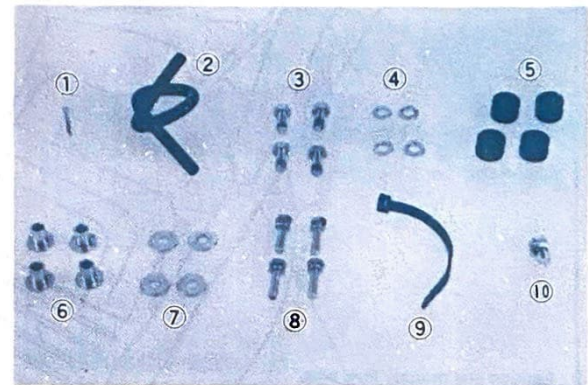

Parts List: Vinyl bag "2"

No.	Part name	Q'ty	Remarks
1	Band	2	Number plate
2	Number plate stay	2	
3	Handle upper holder	2	Steering handle
4	Flange bolt	4	
5	Collar	1	Front wheel

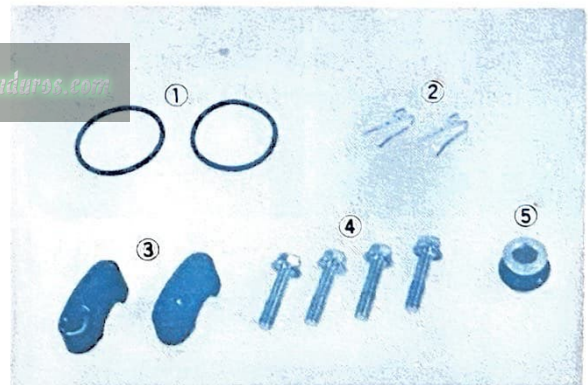

(PAGE 6)

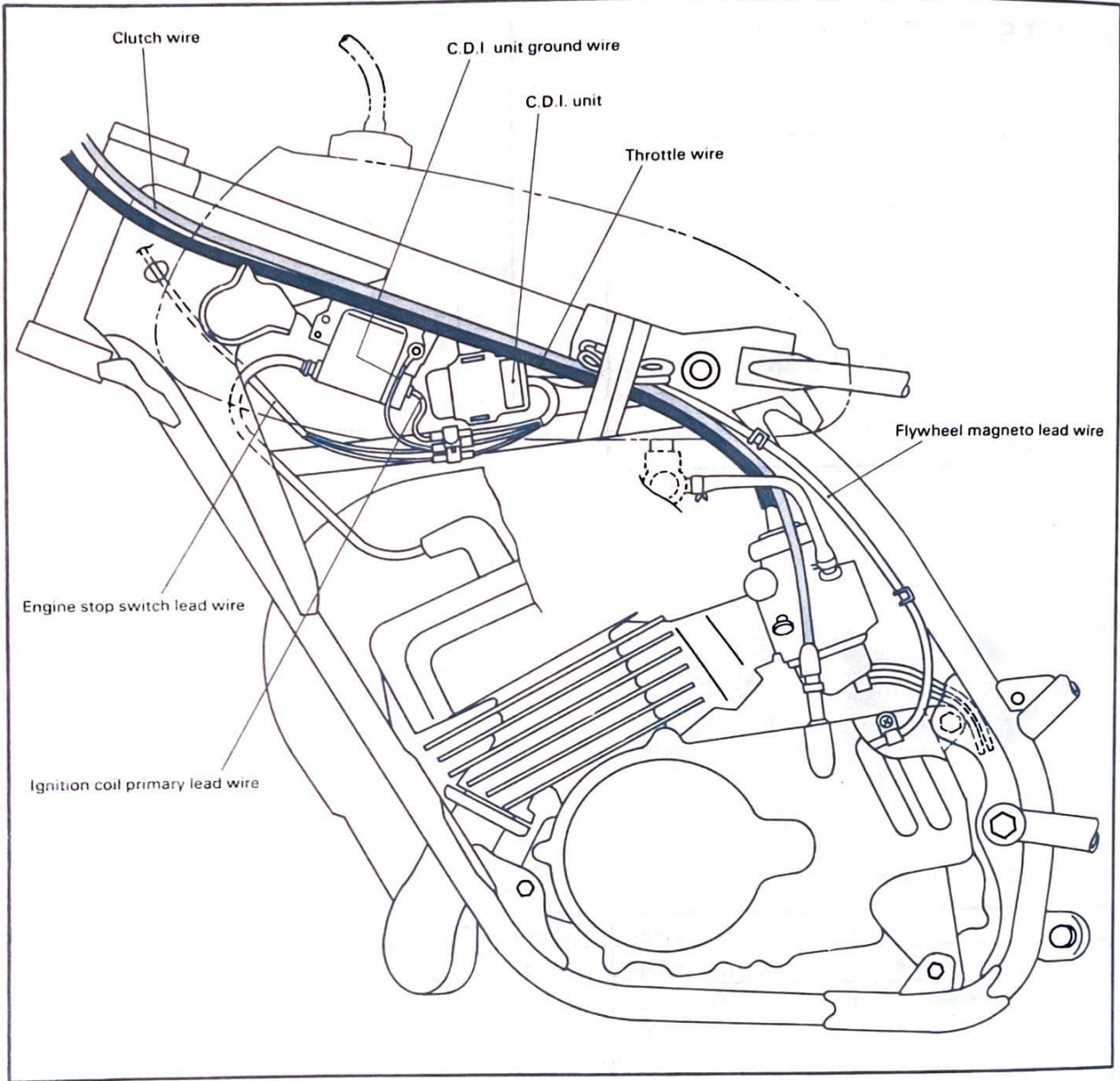

(PAGE 9)

15. Footrest installation

Install the footrest assembly to frame using the hexagon bolts and washers.

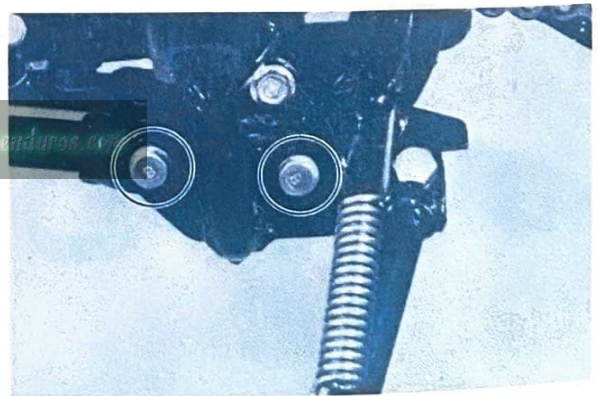

(ADDITION)

Adjustment

NOTE:

This section deals with the main points only. For details, refer to the service manual of this model.

1. Front brake

Loosen the brake wire adjuster lock nut, and adjust the play of the brake lever to specification. After adjustment, tighten the lock nut.

Free play:

5 ~ 8 mm (0.2 ~ 0.32 in)

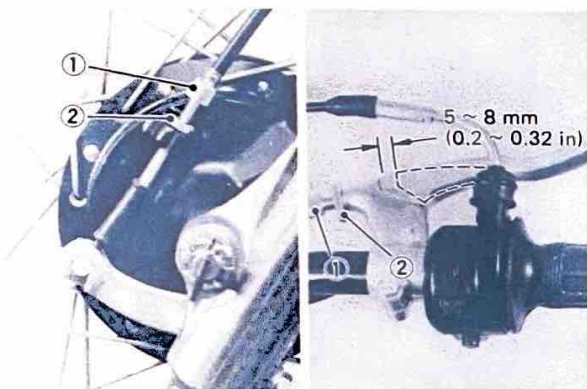

- 1. Adjuster
- 2. Lock nut

2. Rear brake

Adjust the rear brake pedal free play to suit, providing a minimum of 20 ~ 30 mm (0.8 ~ 1.2 in).

Turn the adjuster on the rear brake ferule in or out until brake pedal free play is suitable.

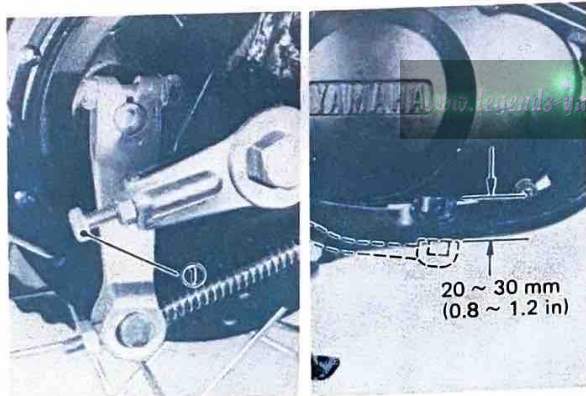

- 1. Adjuster

3. Clutch

Loosen the clutch wire adjuster lock nut and adjust the clutch wire by turning the wire adjuster.

Turning the adjuster clockwise (adjuster is tightened) increases clutch wire play. While turning counter clockwise decreases the play.

Free play:

2 ~ 3 mm (0.08 ~ 0.12 in)

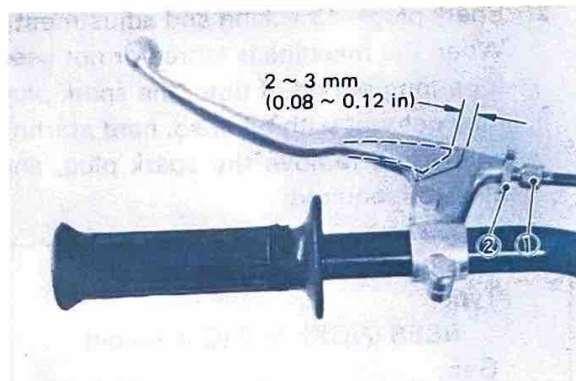

- 1. Adjuster
- 2. Lock nut

4. Throttle wire

Check play in turning deflection of throttle grip. Play should be 5 ~ 8 mm (0.2 ~ 0.3 in) at grip flange. Loosen the lock nut and turn the wire adjuster to make the necessary adjustment. After adjusting, be sure to tighten the lock nut properly.

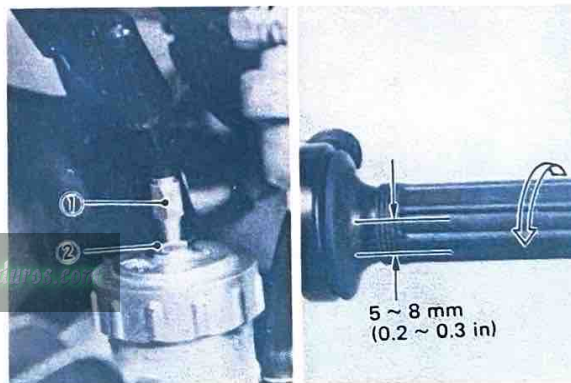

- 1. Adjuster
- 2. Lock nut

Troubleshooting

If the engine will not start or will not start easily after inspections and adjustment, check the following parts.

1. Ignition timing—Checking and adjustment

After starting the engine, check the ignition timing, and if necessary, adjust.

Ignition timing:
0.8 mm (0.31 in) B.T.D.C.

2. Spark plug—Checking and adjustment

When the machine is stored or not used for a long period of time, the spark plug may get wet with oil. If so, hard starting will result, remove the spark plug, and clean as required.

Spark plug:
Type:
B8ES (NGK), N-2 (Champion)
Gap:
0.7 ~ 0.8 mm (0.028 ~ 0.031 in)

3. Carburetor—Cleaning

Remove the drain cover attached to the carburetor float bowl, and drain off the fuel. Add fresh fuel.

NOTE:

For details, refer to the Service Manual for this model.

www.legends-yamaha-enduros.com



YAMAHA MOTOR CO., LTD.

IWATA, JAPAN

PRINTED IN JAPAN
78・7 - 2.15 x 1 CR

(英)