



YAMAHA

GENUINE

**PARTS CATALOGUE
MOTORCYCLE**

www.legends-yamaha-enduros.com

CYLINDER - REED VALVE

Ref. No.	Part Number	Description	Qty	Remarks
1	(363-11111-00-00)	HEAD, CYLINDER 1	1	
2	90430-98066-00	GASKET (363-11181-00)	1	
3	90116-08104-00	BOLT, STUD	6	
4	95333-08600-00	NUT, HEXAGON	6	
5	90201-08100-00	WASHER, PLATE	6	
6	(363-11311-00-00)	CYLINDER 1	1	
	(363-11311-01-00)	CYLINDER 1	1	
7	363-11351-00-00	GASKET, CYLINDER	1	
8	90116-10087-00	BOLT, STUD	4	
9	90116-10088-00	BOLT, STUD (363-11362-00)	2	
10	90179-10201-00	NUT	6	
11	90201-11155-00	WASHER, PLATE (363-11175-00)	6	
12	NGK-B8EV0-00-00	NGK B8EV 4PK (824-24315-00)	1	
13	90340-14022-00	PLUG, STRAIGHT SCRW (214-11197-00)	1	
14	214-11198-01-00	GASKET	1	
15	(363-13610-00-00)	REED VALVE ASSEMBLY	1	
16	363-13613-00-00	. REED, VALVE	2	
17	363-13616-00-00	. STOPPER, REED VALVE	2	
18	92990-03100-00	. WASHER, SPRING (92901-03100)	6	
19	98580-03008-00	. SCREW, PAN HEAD	6	
20	363-13621-00-00	GASKET, VALVE SEAT	1	
21	97313-06030-00	BOLT, HEXAGON	4	
22	92995-06100-00	WASHER, SPRING	4	
23	90462-05005-00	CLAMP	1	
24	363-11161-00-00	ABSORBER 1 (363-11161-00)	24	

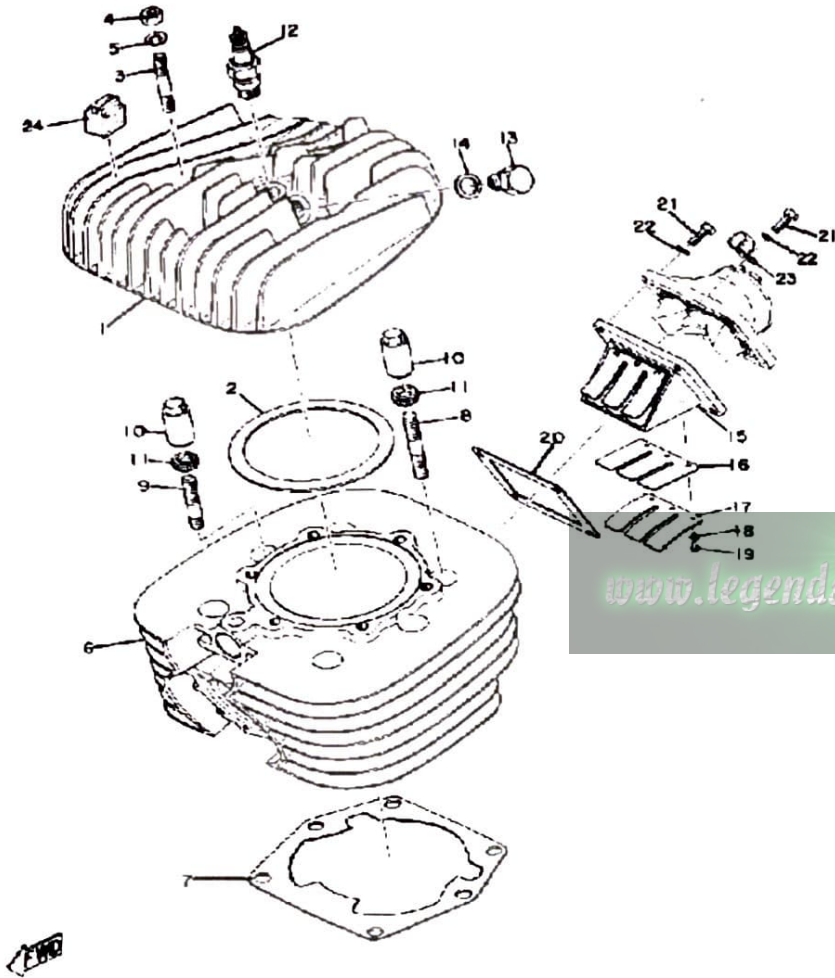

DECOMPRESSION VALVE

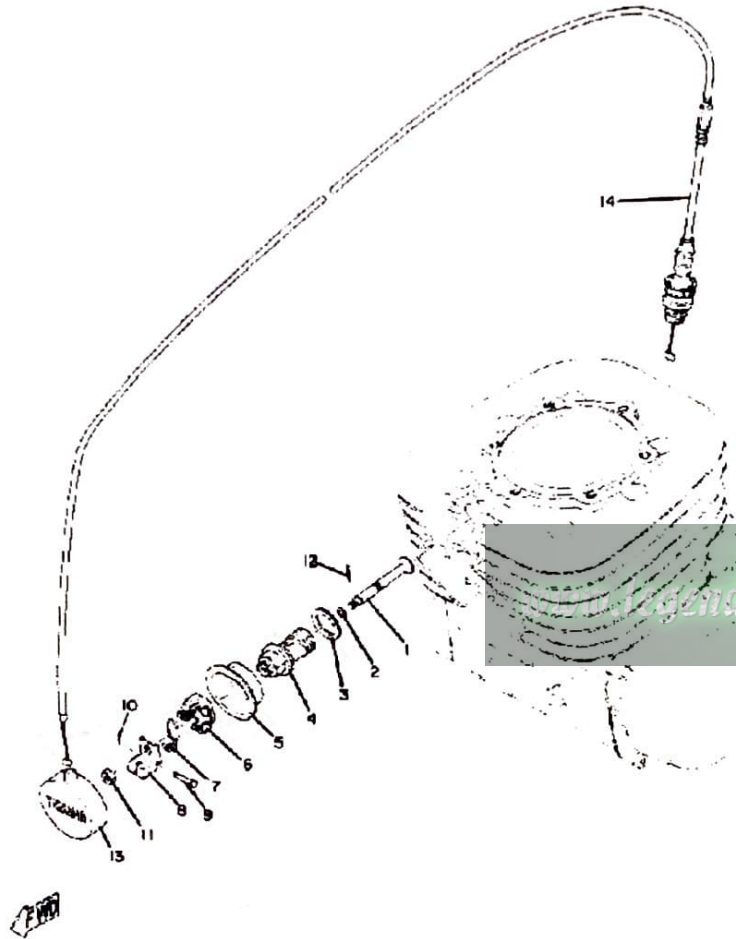

Ref. No.	Part Number	Description	Qty	Remarks
1	363-12281-01-00	VALVE, DCOMP	1	
2	93210-05215-00	O-RING	1	
3	90430-22123-00	GASKET	1	
4	363-12283-01-00	BRACKET, DCOMP	1	
5	363-12279-00-00	PLATE	1	
6	363-12273-00-00	HOLDER, CABLE	1	
7	90508-10010-00	SPRING, TORSION (363-12287-00)	1	
8	363-12282-00-00	LEVER, DCOMP	1	
9	90240-03003-00	PIN, CLEVIS (363-12284-00) ...	1	
10	91490-16020-00	PIN, COTTER	1	
11	95311-05700-00	NUT	1	
12	91490-16020-00	PIN, COTTER	1	
13	275-12278-00-00	COVER, DCOMP	1	
14	363-12292-02-00	CABLE, DCOMP (363-12292-01)	1	
-1	(363-12200-00-00)	DECOMP KIT	1	

CRANKCASE

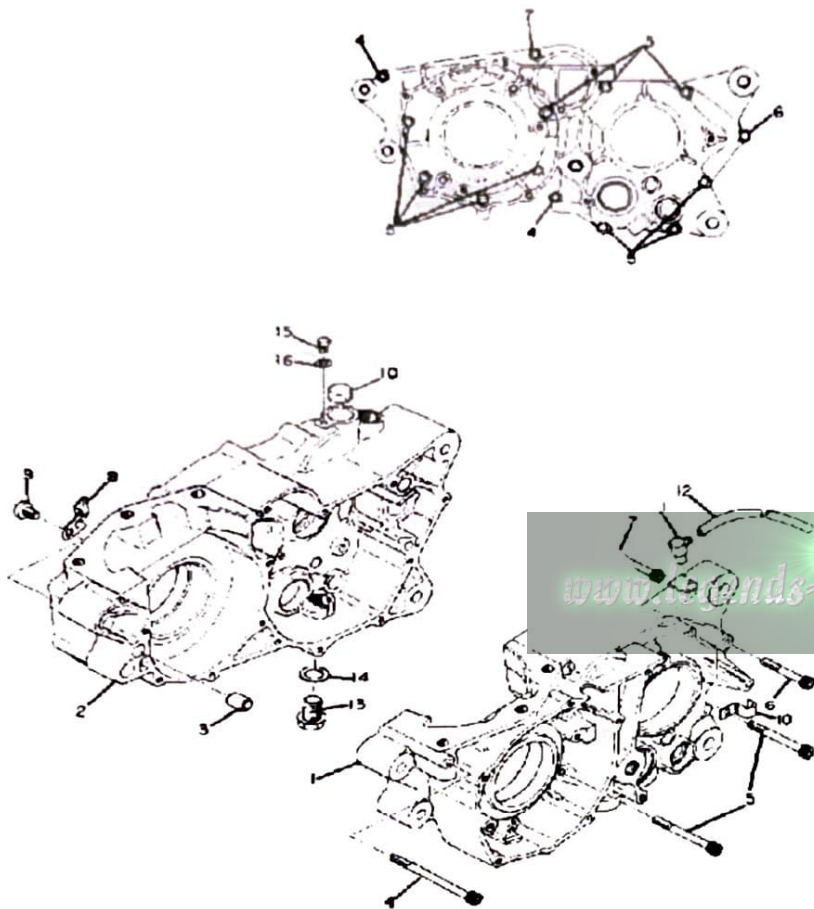

Ref. No.	Part Number	Description	Qty	Remarks
1	(363-15111-00-00)	CRANKCASE 1	1	
	(363-15111-02-00)	CRANKCASE 1	1	
3	99510-12016-00	PIN, DOWEL	4	
4	91316-06085-00	BOLT, SOCKET HEAD	2	
5	91316-06060-00	BOLT	10	
6	91316-06045-00	BOLT, SOCKET HEAD	1	
7	91316-06070-00	BOLT, SOCKET HEAD	1	
8	(363-15118-00-00)	HOLDER	2	
9	98501-08012-00	SCREW, PAN HEAD	2	
10	90338-20023-00	PLUG	1	
11	583-15371-00-00	BREATHER	1	
12	90446-07241-00	HOSE (3AK)	1	
13	90109-14385-00	BOLT	1	
14	137-15353-00-00	GASKET, DRAIN	1	
15	97011-06010-00	BOLT	1	
16	92995-06100-00	WASHER, SPRING	1	

FR

CRANKCASE COVER

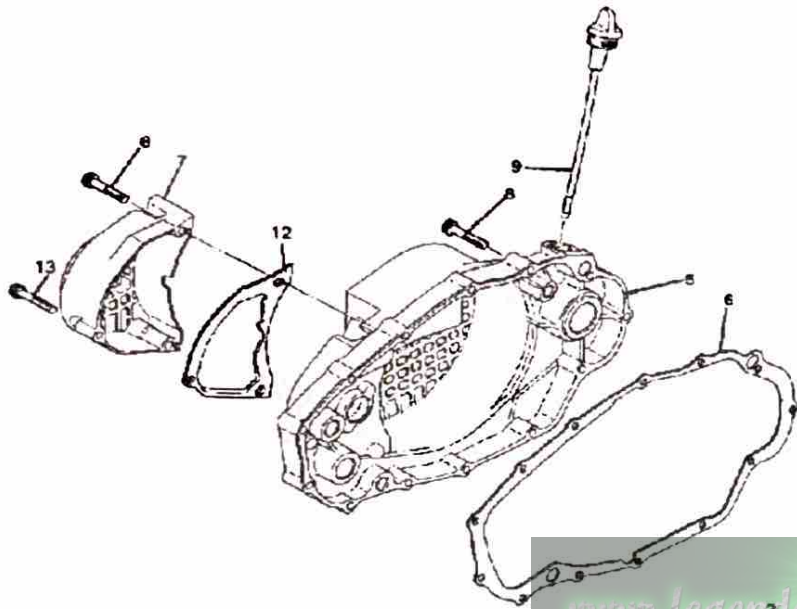

Ref. No.	Part Number	Description	Qty	Remarks
1	(363-15411-00-00)	COVER, CRANKCASE L	1	
2	(363-15421-01-00)	COVER, CRANKCASE R	1	
3	90110-06138-00	BOLT, HEX SKT HEAD	8	
4	363-15451-00-00	GASKET, CRCS COVER	1	
5	(363-15431-02-00)	COVER, CRANKCASE 3	1	
6	363-15461-00-00	GASKET, CRCS CVR 2	1	
7	(363-15416-01-00)	COVER, OIL PUMP	1	
8	91316-06035-00	BOLT	15	
	91316-06035-00	BOLT	16	
9	322-15363-00-00	PLUG, OIL	1	
10	583-15371-00-00	BREATHER	1	
11	90446-07094-00	HOSE (5-500) (308-15373-00)	1	
12	363-15456-00-00	GASKET, O/PMP CVR 1	1	
13	91316-06045-00	BOLT, SOCKET HEAD	1	

www.legends-yamaha-enduros.com

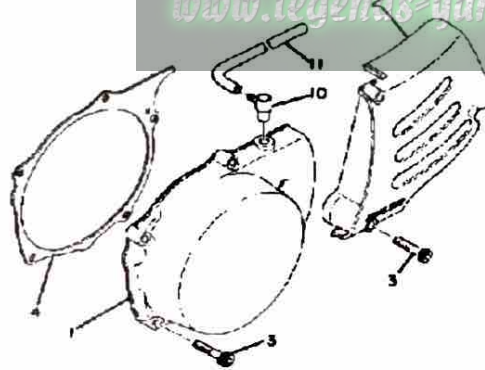

CRANK - PISTON

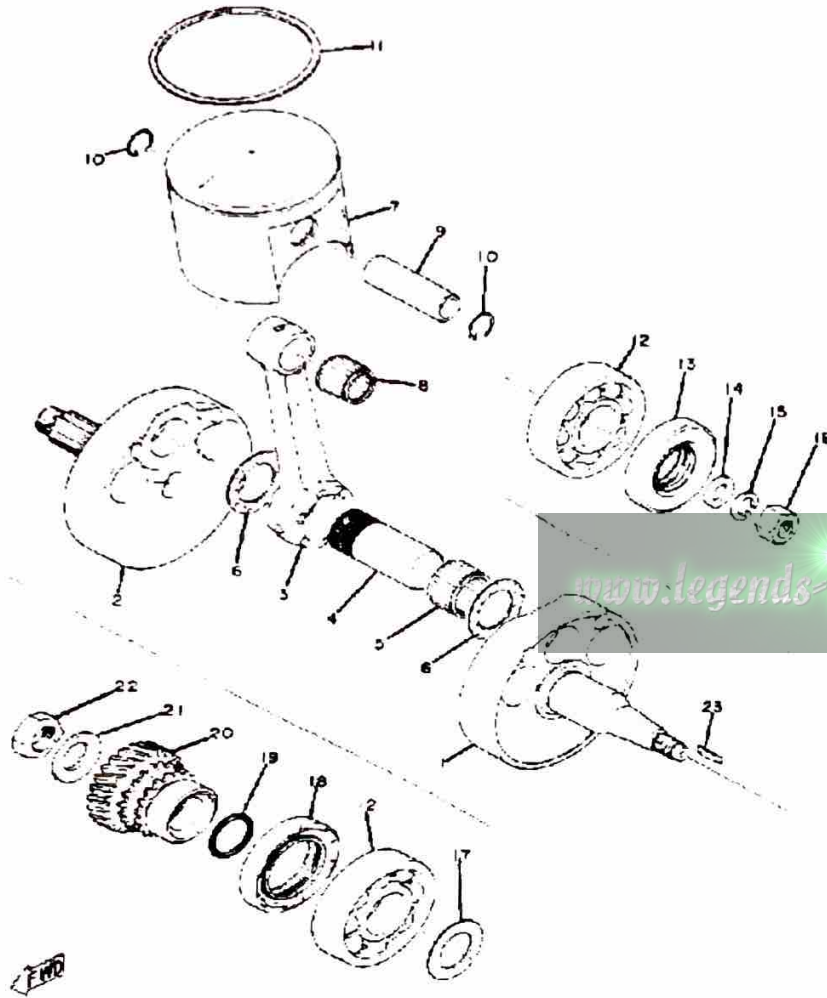

Ref. No.	Part Number	Description	Qty	Remarks
1	(363-11412-01-00)	. CRANK 1	1	
2	(363-11422-00-00)	. CRANK 2	1	
3	(363-11651-01-00)	. ROD, CONNECTING	1	
4	(363-11681-00-00)	. PIN, CRANK 1	1	
5	93310-42775-00	. BEARING, CYLINDER.# 0	1	
6	(363-11685-00-00)	. WASHER, CRANK PIN	1	
7	(363-11631-03-96)	PISTON STD 0 1	1	361-(SC500A) M4-026
	(363-11635-03-00)	PISTON 1 O/S 0. 5	1	ALTERNATE PT
	363-11636-03-00	PISTON 2 O/S 0. 0	1	ALTERNATE PT
	363-11637-03-00	PISTON 3 O/S 0. 5	1	ALTERNATE PT
	363-11638-03-00	PISTON 4 O/S 1. 0	1	ALTERNATE PT
8	93310-22062-00	BEARING, CYLINDER.# 0	1	
9	363-11633-00-00	PIN, PISTON	1	
10	363-11634-00-00	CLIP, PISTON PIN	2	
11	(363-11611-00-00)	RING, PISTON STD	1	
	363-11611-10-00	RING, PISTON 1ST	1	ALTERNATE PT
	363-11611-20-00	RING, PISTON 2ND	1	ALTERNATE PT
	363-11611-30-00	RING, PISTON 3RD	1	ALTERNATE PT
	363-11611-40-00	RING, PISTON 4TH	1	ALTERNATE PT
12	93306-30615-00	BEARING (B6306)	2	
	93306-30630-00	BEARING	2	NOV. 73
13	93103-30072-00	OIL SEAL, SW-TYPE	1	
14	90201-12535-00	WASHER, PLATE	1	
15	92901-12100-00	WASHER, SPRING	1	
16	90170-12347-00	NUT, HEXAGON	1	
17	156-11564-00-03	SHIM, CRANK 4 (25-44-0.3)	1	U.R.
	156-11564-00-04	SHIM, CRANK 4 (25-44-0.5)	1	U.R.
18	93103-38086-00	OIL SEAL, SW-TYPE	1	
19	93210-25070-00	O-RING	1	

CONTINUED ON NEXT FRAME ►

CRANK - PISTON

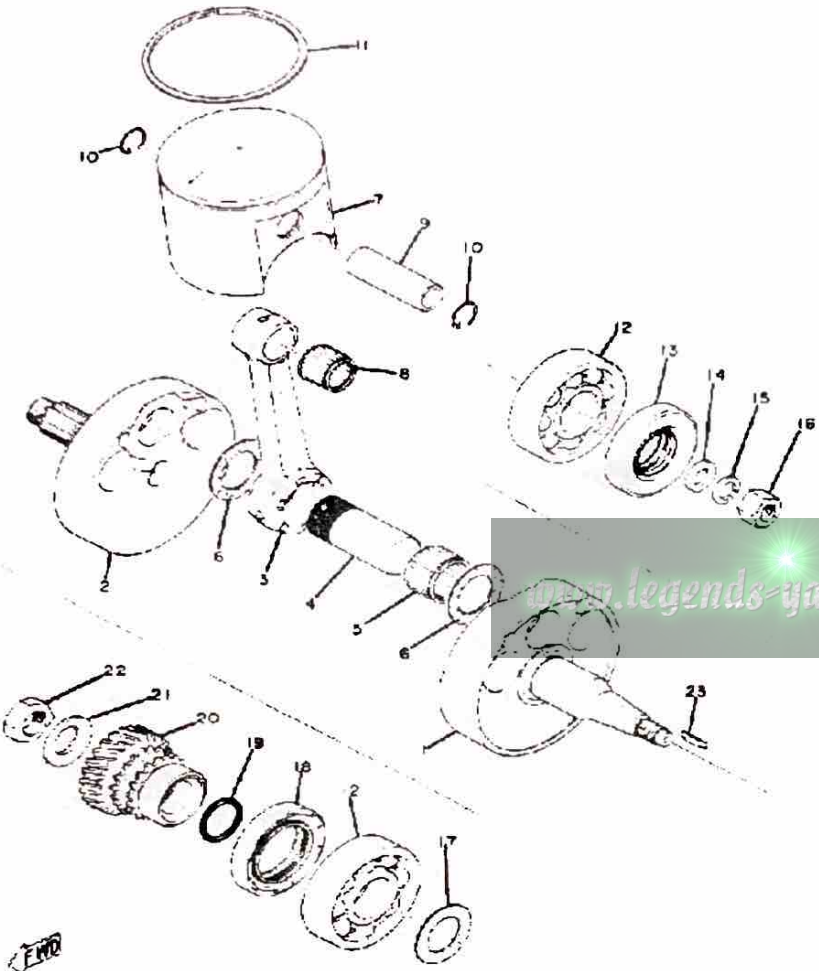

Ref. No.	Part Number	Description	Qty	Remarks
20	(363-16111-01-00)	GEAR, PRI DRIVE	1	
21	214-16119-00-00	SPRING, BELLEVILLE	1	
22	90170-18086-00	NUT, HEXAGON	1	
23	90280-16053-00	KEY, WOODRUFF	1	
-1	(363-11400-00-00)	CRANKSHAFT ASSEMBLY ...	1	

CRANK BALANCER

Ref. No.	Part Number	Description	Qty	Remarks
1	(363-11454-01-00)	WEIGHT 1	1	
2	(93306-20410-00)	BEARING	1	
3	(93390-00008-00)	BEARING, CYLINDER.# 0	1	
4	(363-11458-01-00)	SPROCKET, WHEEL	1	
5	(363-11449-00-00)	WASHER, LOCK	1	
6	(363-11459-00-00)	NUT, SPECIAL	1	
7	(90282-04004-00)	KEY, STRAIGHT	1	
8	(363-11455-01-00)	SHAFT 1	2	
9	(363-11438-00-00)	SPROCKET, IDLE 2	2	
10	93310-42071-00	BEARING, CYLINDER.# 0	2	
11	(363-11457-02-00)	GUIDE, CHAIN	2	
12	363-11474-00-00	GUIDE, UPPER	1	
13	91316-06016-00	BOLT, SOCKET HEAD	1	
14	91316-06035-00	BOLT	1	
15	92995-06100-00	WASHER, SPRING	2	
16	90110-06138-00	BOLT, HEX SKT HEAD	1	
17	94862-09066-00	CHAIN	1	
18	(363-11466-00-00)	BUSH	4	

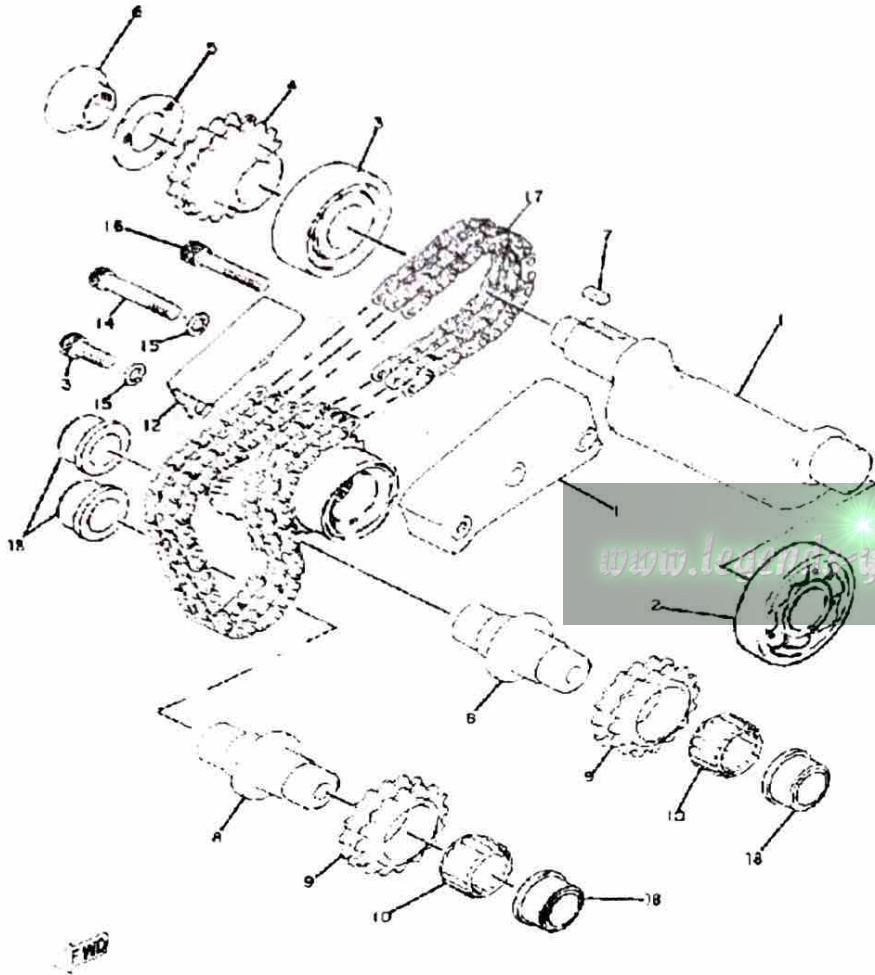

C - D - I - MAGNETO

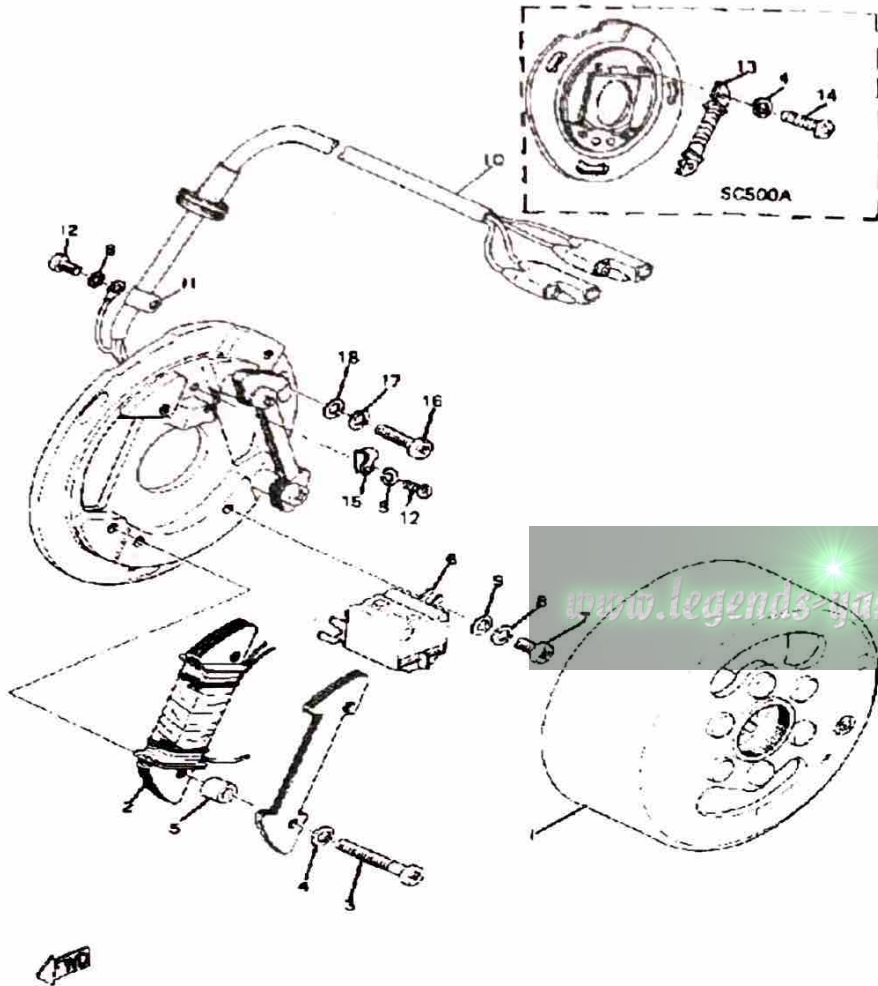

Ref. No.	Part Number	Description	Qty	Remarks
1	(363-85550-10-00)	ROTOR ASSEMBLY	1	
	(363-85550-11-00)	ROTOR ASSEMBLY	1	
2	(363-85541-10-00)	COIL, CHARGE	1	
3	(647-81323-10-00)	SCREW 1	2	
4	92990-05100-00	. WASHER, SPRING	2	
	92990-05100-00	. WASHER, SPRING	4	
5	647-81318-10-00	. SPACER	2	
6	(363-85543-10-00)	COIL PULSER	2	
	(363-85543-11-00)	COIL PULSER	1	
7	110-81346-21-00	. SCREW, PAN HEAD	2	
8	92901-04100-00	. WASHER, SPRING	4	
9	92990-04200-00	. WASHER, PLAIN	2	
10	(363-85515-10-00)	LEAD WIRE ASSEMBLY	1	
	(363-85515-11-00)	LEAD WIRE ASSEMBLY	1	
11	109-81328-11-00	. CLAMP	1	
12	98580-04008-00	. SCREW, PAN HEAD	2	
13	363-85544-10-00	. PULSER 2	1	
14	98580-05012-00	. SCREW, PAN HEAD	2	
15	(363-85528-10-00)	CLAMP, LEAD	1	
16	98580-06018-00	SCREW, PAN HEAD	3	
17	92995-06100-00	WASHER, SPRING	3	
18	92990-06200-00	WASHER	3	
-1	(363-85500-12-00)	CDI MAGNETO ASSEMBLY ...	1	

M4-032A

OIL PUMP

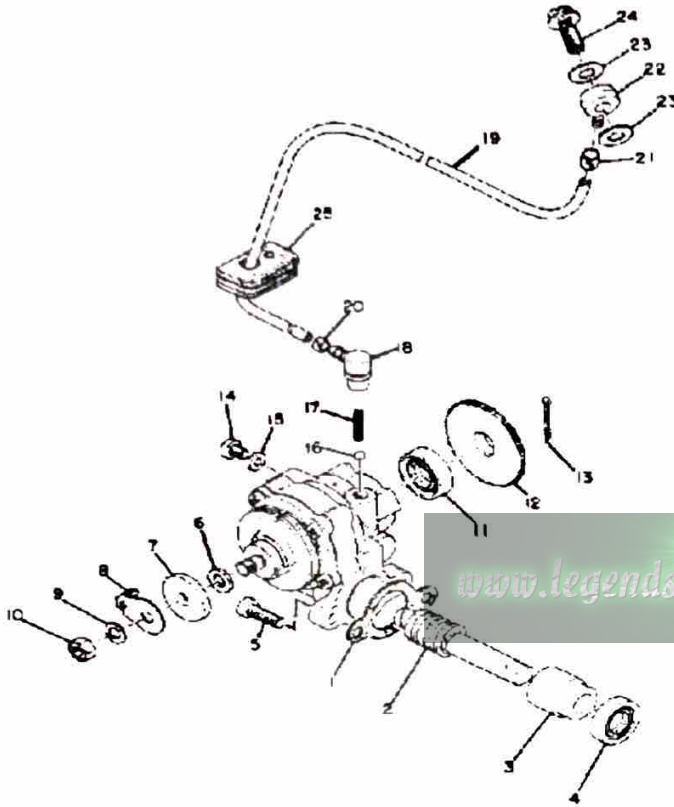

Ref. No.	Part Number	Description	Qty	Remarks
1	3MT-13116-00-00	GASKET, PUMP CASE (8Y0-13116-00)	1	
2	(363-13175-00-00)	SHAFT, WORM	1	
3	1E7-13176-00-00	METAL, WRM SHAF OTR	1	
4	93101-10002-00	OIL SEAL	1	
5	98580-05016-00	SCREW, PAN HEAD (98501-05016)	2	
6	137-13137-00-03	. SHIM (0.3T)	1	
	137-13137-00-05	. SHIM (0.5T)	1	
7	137-13138-01-00	. PLATE, ADJUSTING	1	
8	402-13146-00-00	. UNAVAILABLE IN PRICE BOOK	1	
9	92990-05100-00	. WASHER, SPRING	1	
10	95380-05600-00	. NUT	1	
11	93101-10090-00	. OIL SEAL	1	
12	137-13138-01-00	. PLATE, ADJUSTING	1	
13	91401-12018-00	. PIN, COTTER	1	
14	98901-04008-00	. SCREW, BIND	1	
15	90430-04004-00	. GASKET	1	
16	93505-32002-00	. BALL	1	
17	90501-02018-00	. SPRING, COMPRESSION	1	
18	353-13552-01-00	. NOZZLE	1	
19	90445-052F5-00	. HOSE	1	
20	90468-02033-00	. CLIP	1	
21	90468-02033-00	CLIP	1	
22	214-13162-01-00	BANJO, DLVRY PIPE	1	
23	90430-06011-00	GASKET	2	
24	90401-06001-00	BOLT, UNION	1	
25	(363-13174-00-00)	HOLDER, OIL PIPE	1	
-1	(363-13101-03-00)	OIL PUMP ASSEMBLY	1	

CLUTCH

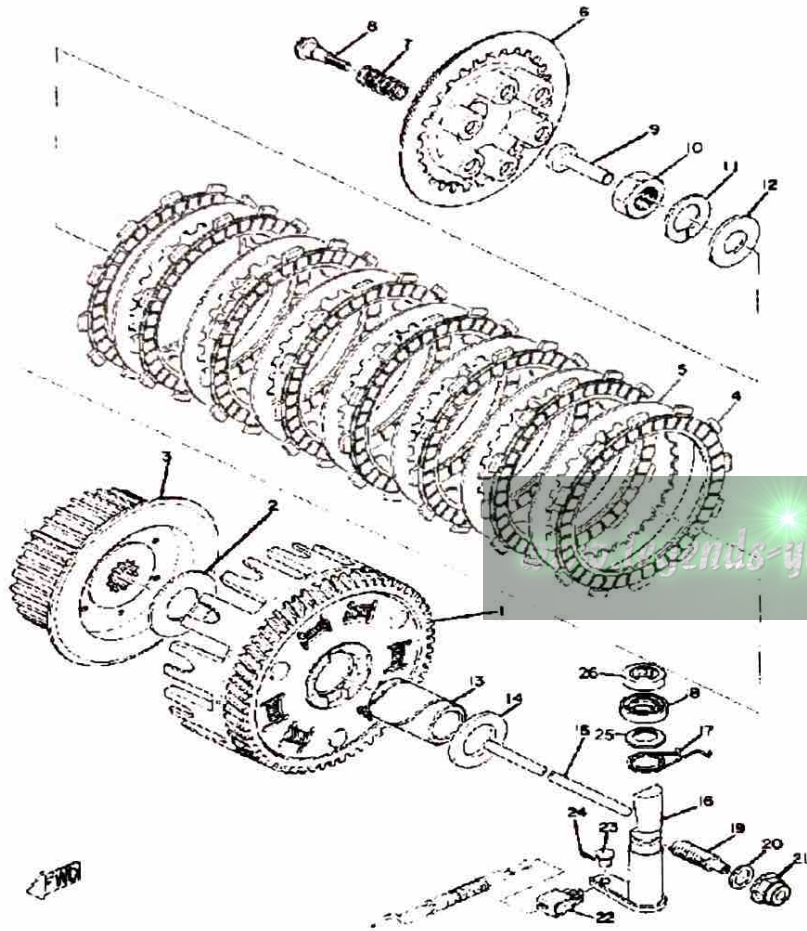

Ref. No.	Part Number	Description	Qty	Remarks
1	(363-16150-00-00)	PRI DRVN GEAR	1	
2	170-16164-00-00	. PLATE, THRUST 2	1	
3	(363-16371-00-00)	BOSS, CLUTCH	1	
4	363-16321-00-00	. PLATE, FRICTION	8	
5	4H7-16325-00-00	. PLATE, CLUTCH 2	7	
6	(363-16351-00-00)	PLATE, PRESSURE 1	1	
7	90501-20361-00	. SPRING, COMPRESSION	6	
8	(90149-05147-00)	SCREW, SPECL SHAPE	6	
9	174-16356-00-00	ROD, PUSH 1	1	
10	90170-18089-00	NUT, HEXAGON	1	
11	92901-18100-00	WASHER, SPRING	1	
12	92990-18200-00	WASHER	1	
13	(363-16181-00-00)	SPACER 1	1	
14	363-16154-00-00	PLATE, THRUST 1	1	
15	(363-16356-00-00)	ROD, PUSH 1	1	
16	(363-16382-00-00)	AXLE, PUSH LEVER	1	
	434-16382-01-00	AXLE, PUSH LEVER	1	
17	(90508-12131-00)	SPRING, TORSION	1	
18	93102-17004-00	OIL SEAL	1	
19	(363-16343-00-00)	SCREW, ADJUSTING	1	
20	90430-12207-00	GASKET	1	
21	583-16344-00-00	NUT, ADJUSTING	1	
22	214-16389-00-00	JOINT	1	
23	90240-06005-00	PIN, CLEVIS	1	
24	91401-10015-00	PIN, COTTER	1	
25	90201-17327-00	WASHER, PLATE	1	
26	93315-11720-00	BEARING	1	
-1	(363-16301-00-00)	CLUTCH ASSEMBLY	1	

TRANSMISSION

Ref. No.	Part Number	Description	Qty	Remarks
1	(363-17411-00-00)	AXLE, MAIN	1	
	(363-17411-60-00)	AXLE, MAIN	1	STD
2	(363-17141-60-00)	GEAR, 4TH PINION	1	STD
	(363-17221-00-00)	GEAR, 2ND WHEEL	1	
3	90201-253K0-00	WASHER, PLATE (T=1.0)	1	
4	93440-25020-00	CIRCLIP	1	
5	(363-17121-00-00)	GEAR, 2ND PINION	1	
	(363-17121-60-00)	GEAR, 2ND PINION	1	
6	(363-17131-00-00)	GEAR, 3RD PINION	1	
7	90201-20266-00	WASHER, PLATE (1.0T)	1	
8	99009-19400-00	CIRCLIP	1	
9	93311-42012-00	BEARING, CYLINDER.# 1	1	
10	168-17428-01-03	SHIM 2 (25-34-0.3)	1	
	168-17428-01-05	SHIM 2 (25-34-0.5)	1	
11	93304-20501-00	BEARING	1	
12	(363-15383-00-00)	PLATE, BRNG COVER	1	
13	98701-06014-00	SCREW, FLAT HEAD	2	
14	(363-15631-00-00)	GEAR, KICK PINION	1	
15	(363-17421-00-00)	AXLE, DRIVE	1	
16	93440-30015-00	CIRCLIP, OUTER	2	
17	(363-17231-00-00)	GEAR, 3RD WHEEL	1	
18	(363-17221-00-00)	GEAR, 2ND WHEEL	1	
	363-17221-60-00	NO LONGER AVAILABLE	1	STD
19	90201-253K0-00	WASHER, PLATE (T=1.0)	1	
20	93440-25027-00	1CIRCLIP, OUTER	1	
21	(363-17241-00-00)	GEAR, 4TH WHEEL	1	
22	(363-17211-00-00)	GEAR, 1ST WHEEL	1	
	(363-17211-60-00)	GEAR, 1ST WHEEL	1	STD
23	90201-20278-00	WASHER, PLATE	1	

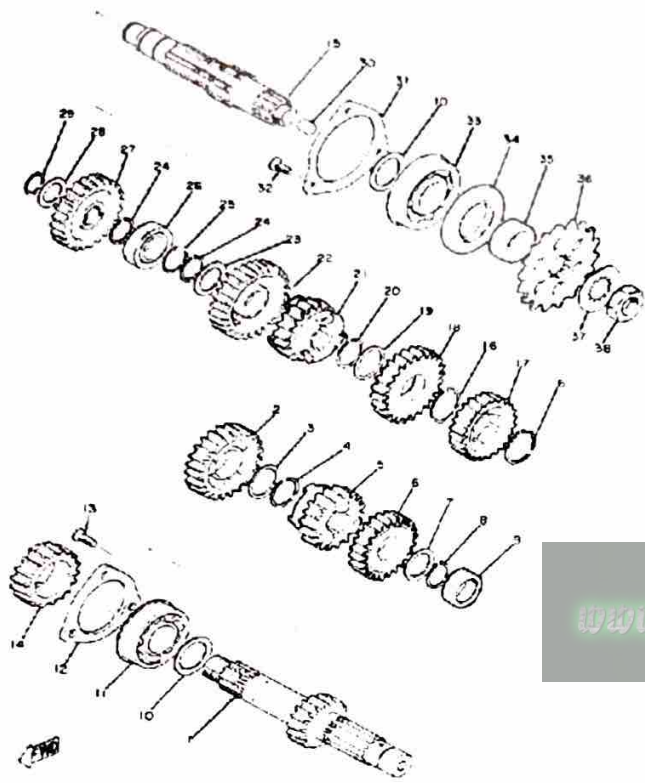

www.legends-yamaha.com

SC500A

DRIVE - PRIMARY (TYPE) (TEETH) (RATIO)	Holical Gear	64/24	2.666:1
SECONDARY (TYPE) (TEETH) (RATIO)	DK520	104 Links	51/16 3.188:1
TRANSMISSION RATIOS 1ST (TEETH) (RATIO) (O.A.)	30/15	2.000	17.000
2ND	27/20	1.350	11.475
3RD	23/23	1.000	8.500
4TH	21/26	0.807	6.865

CONTINUED ON NEXT FRAME ►

TRANSMISSION

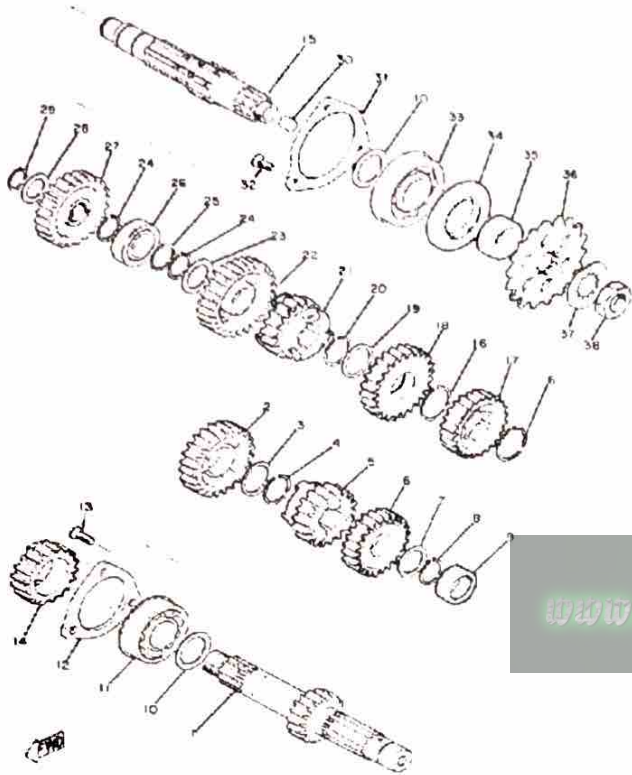

Ref. No.	Part Number	Description	Qty	Remarks
24	99009-19400-00	CIRCLIP	2	
25	90201-20266-00	WASHER, PLATE (1.0T)	1	
26	93313-32008-00	BEARING, CYLINDER.# 3	1	
27	(363-15651-00-00)	GEAR, KICK IDLE	1	
28	90201-17255-00	WASHER, PLATE	1	
29	99009-17400-00	CIRCLIP	1	
30	214-17481-00-00	PLUG, BLIND	1	
31	(363-15381-00-00)	PLATE, BRNG COVER	1	
32	98701-05012-00	SCREW, FLAT HEAD	3	
33	93306-30517-00	BEARING	1	
34	93102-35109-00	OIL SEAL (SD-35-62-6 HS)	1	
35	(90387-25193-00)	COLLAR	1	
36	9383E-15082-00	SPROCKET, DRIVE (15T)	1	
	9383E-16106-00	SPROCKET, DRIVE 16T (16T) ..	1	STD
37	90215-21022-00	WASHER, LOCK	1	
38	90179-18020-00	NUT	1	

www.legends-yamaha.com

SC500A

DRIVE - PRIMARY (TYPE) (TEETH) (RATIO)	Helical Gear	64/24	2.666:1
SECONDARY (TYPE) (TEETH) (RATIO)	DK520	104 Links	51/16 3.188:1
TRANSMISSION RATIOS 1ST (TEETH) (RATIO) (O.A.)	30/15	2.000	17.000
2ND	27/20	1.350	11.475
3RD	23/23	1.000	8.500
4TH	21/26	0.807	6.865

SHIFTER 1

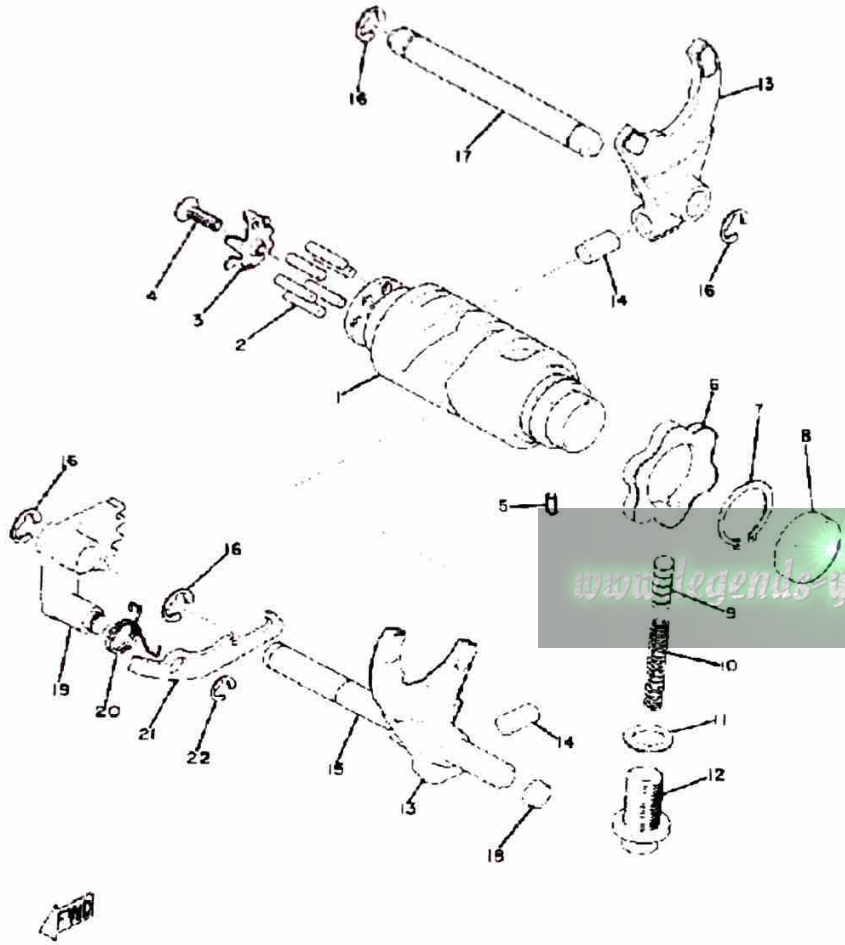

Ref. No.	Part Number	Description	Qty	Remarks
1	(363-18541-00-00)	CAM, SHIFT	1	
	(363-18541-01-00)	CAM, SHIFT	1	
2	93604-18100-00	PIN, DOWEL	6	
3	(363-18561-01-00)	PLATE, SIDE 1	1	
	434-18561-00-00	PLATE, SIDE 1	1	
4	98701-05012-00	SCREW, FLAT HEAD	1	
5	360-18141-01-00	PLATE, STOPPER	1	
	93604-08071-00	PIN, DOWEL	1	
7	99009-30400-00	CIRCLIP	1	
8	(90338-32031-00)	PLUG, SPEC"L SHAPE	1	
9	278-18547-02-00	STOPPER, CAM	1	
10	90501-10062-00	SPRING, COMPRESSION	1	
11	137-15353-00-00	GASKET, DRAIN	1	
12	90109-14485-00	BOLT	1	
13	363-18511-00-00	FORK, SHIFT 1	2	
14	90250-08017-00	PIN, STRAIGHT	2	
15	(363-18531-00-00)	BAR, SHIF FRK GDE 1	1	
16	99001-08600-00	CIRCLIP	4	
17	363-18535-00-00	BAR, SHIF FRK GDE 2	1	
18	90334-10006-00	PLUG, STRAIGHT	1	
19	(363-18122-00-00)	LEVER, SHIFT 2	1	
	434-18122-00-00	LEVER, SHIFT 2	1	
20	90508-08008-00	SPRING, TORSION (363-18123-00)	1	
21	498-18151-03-00	LEVER, SHIFT 3	1	
22	99080-07600-00	CIRCLIP (E)	1	

SHIFTER 2

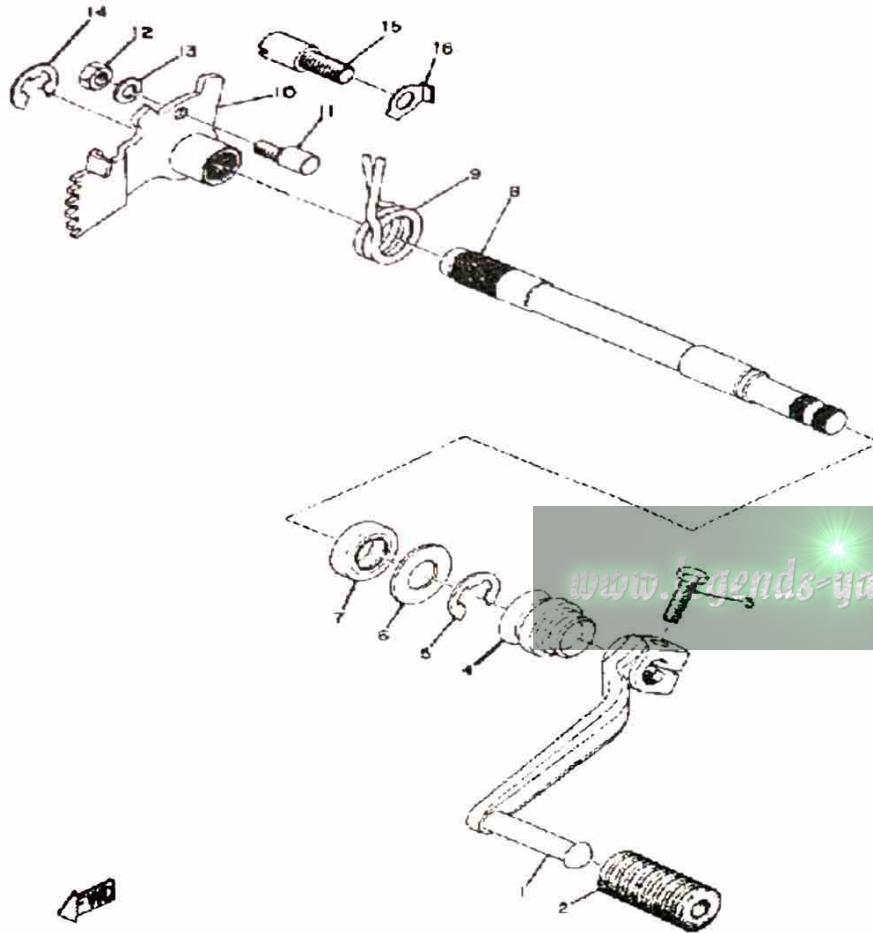

Ref. No.	Part Number	Description	Qty	Remarks
1	22U-18110-00-00	SHIFT PEDAL ASSEMBLY	1	
2	132-18113-01-00	COVER, SHIFT PEDAL	1	
3	97011-06020-00	BOLT	1	
4	214-18131-00-00	BOOT, SEALING	1	
5	99001-12600-00	CIRCLIP	1	
6	90201-14220-00	WASHER, PLATE	1	
7	93109-14010-00	OIL SEAL, SDO-TYPE	1	
8	363-18125-00-00	SHAFT, SHIFT	1	
9	90508-32052-00	SPRING, TORSION (214-18124-00)	1	
10	363-18121-00-00	LEVER, SHIFT 1	1	
	434-18121-00-00	LEVER, SHIFT 1	1	
11	90149-06017-00	SCREW, SPEC'L SHAPE (214-18186-00)	1	
12	95380-06600-00	NUT	1	
13	90215-06016-00	WASHER, LOCK	1	
14	99006-10600-00	CIRCLIP	1	
15	278-18127-00-00	STOPPER, SCREW	1	
16	90215-08015-00	WASHER, LOCK (214-18139-00)	1	

STARTER

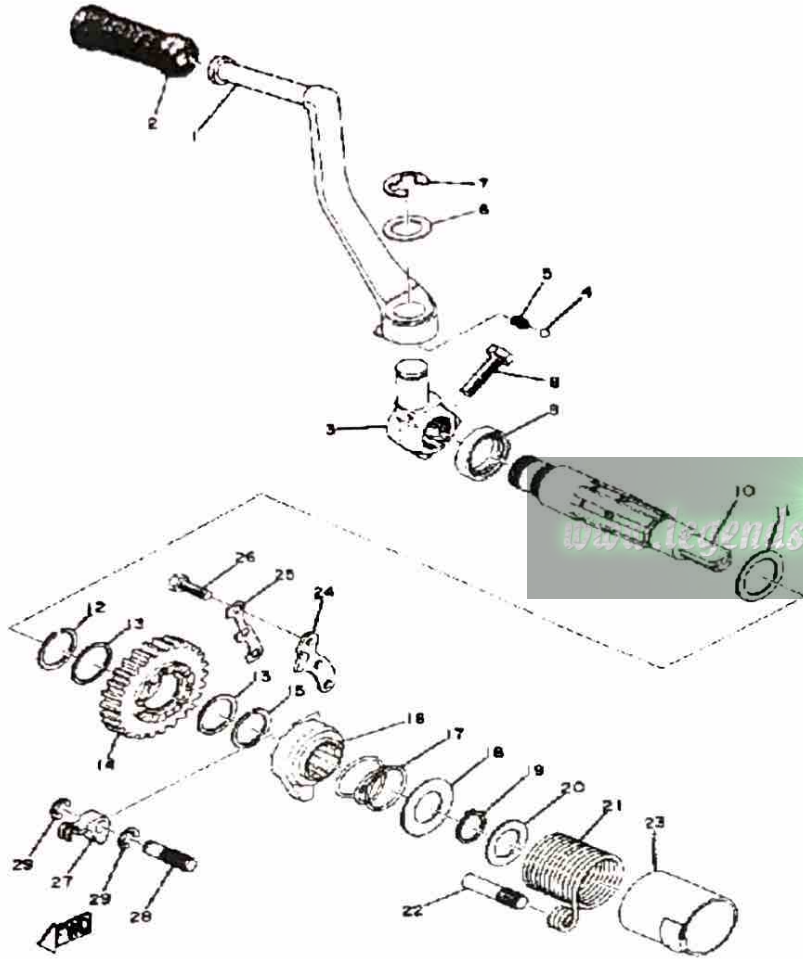

Ref. No.	Part Number	Description	Qty	Remarks
1	(363-15611-00-91)	CRANK, KICK	1	
2	156-15618-01-00	COVER, KICK LEVER	1	
3	(363-15621-00-00)	BOSS, KICK CRANK	1	
4	93507-32031-00	BALL	1	
5	90501-12081-00	SPRING, COMPRESSION	1	
6	90201-17256-00	WASHER, PLATE	1	
7	93430-12022-00	CIRCLIP, E-TYPE	1	
8	97313-08030-00	BOLT, HEXAGON	1	
9	93102-25064-00	OIL SEAL	1	
10	(363-15661-00-00)	AXLE, KICK	1	
	(363-15661-01-00)	AXLE, KICK	1	
11	90201-256K6-00	WASHER, PLATE (0.9T)	1	
12	93440-25084-00	CIRCLIP	1	
13	90201-253K0-00	WASHER, PLATE (T=1.0)	2	
14	(363-15641-00-00)	GEAR, KICK	1	
15	93440-25020-00	CIRCLIP	1	
16	363-15671-01-00	WHEEL, RATCHET	1	
17	90501-23143-00	SPRING, COMPRESSION (363-15675-00)	1	
18	363-15676-00-00	COVER, SPRING	1	
19	99009-19400-00	CIRCLIP	1	
20	90201-20278-00	WASHER, PLATE	1	
21	90508-32060-00	SPRING, TORSION (363-15665-00)	1	
22	257-15668-00-00	STOPPER	1	
23	(498-15664-00-00)	GUIDE, SPRING	1	
24	(363-15674-00-00)	GUIDE, RATCHET WHL	1	
25	363-15686-00-00	WASHER, LOCK	1	
26	97011-06020-00	BOLT	3	

CONTINUED ON NEXT FRAME ►

STARTER

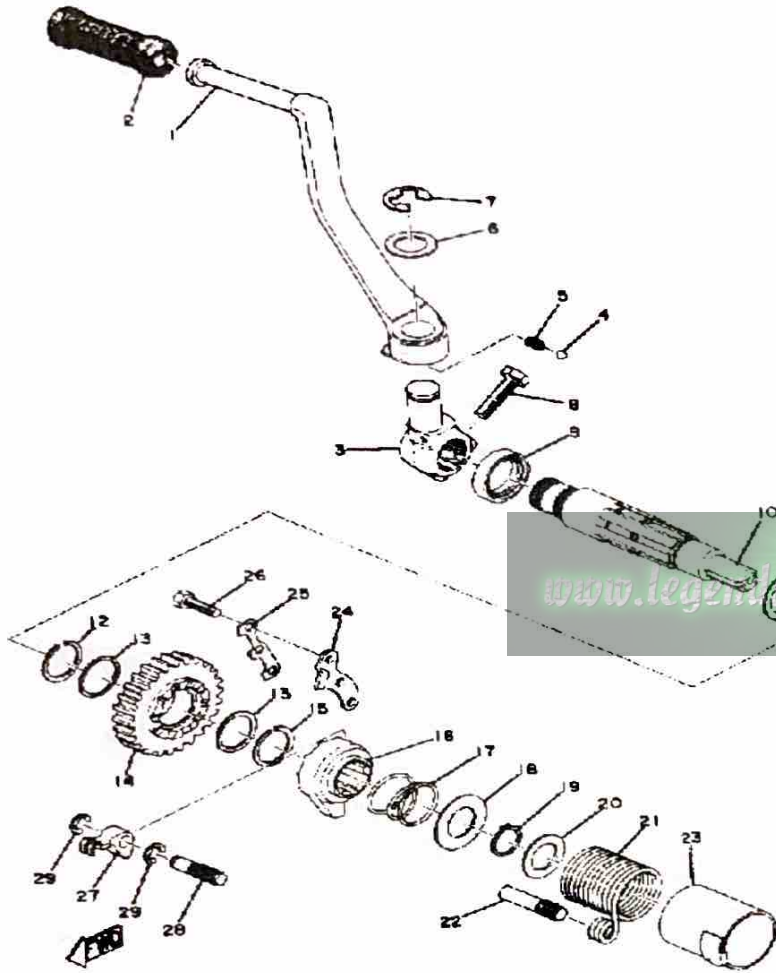

Ref. No.	Part Number	Description	Qty	Remarks
27	363-15656-00-00	LINK	1	
28	363-15659-00-00	SHAFT	1	
29	93430-07020-00	CIRCLIP, E-TYPE	2	

CARBURETOR

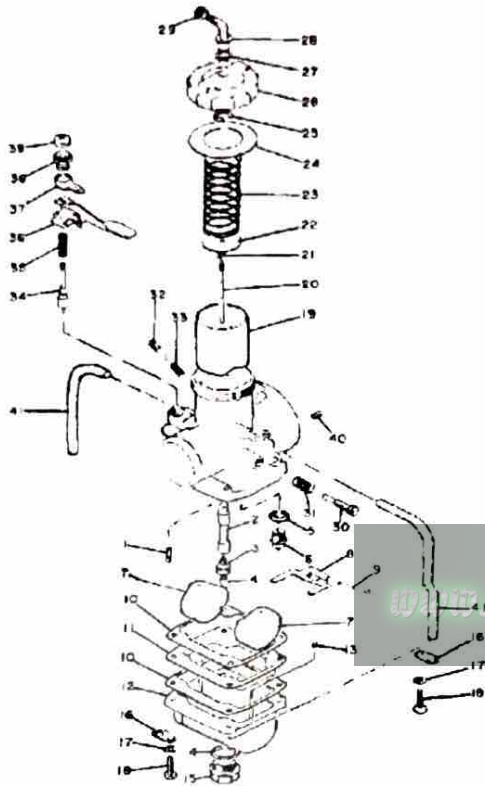

SC500A

CARBURETOR (MFR) (TYPE) (I.D. NUMBER)	Mikuni VM 38SC	363E1, 363B1 or 38362
MAIN JET	(E/N 02319~) No. 340	(E/N~02318 No. 400
NEEDLE JET	0.8	Skyway) 0.8
JET NEEDLE/CLIP POSITION	5F16-2	5F16-2
CLIP AWAY	No. 3.5	No. 3.5
PILOT JET	No. 80	No. 80
AIR JET	2.0	2.0
STARTER JET	No. 80	No. 80
AIR SCREW (TURNS OUT)	1 1/2	1 1/2

Ref. No.	Part Number	Description	Qty	Remarks
1	193-14142-80-00	. JET, PILOT (# 80)	1	
2	(363-14141-38-00)	NOZZLE, MAIN	1	
3	363-14145-00-00	. SETTER, NEEDLE JET	1	
4	137-14143-68-00	. JET, MAIN (#340)	1	U.R. STD
	137-14143-70-00	. JET, MAIN (#350)	1	U.R.
	137-14143-80-00	. JET, MAIN (#400)	1	U.R. STD
	137-14143-82-00	. JET, MAIN (#410)	1	U.R.
5	239-14195-00-00	. WASHER, NEEDLE VALVE ..	1	
6	23X-14107-35-00	. NEEDLE VALVE SET	1	
7	214-14185-00-00	. FLOAT	2	
8	363-14187-00-00	. ARM, FLOAT	1	
9	127-14186-00-00	. PIN, FLOAT	1	
10	363-14184-00-00	. GASKET, FLOAT CHMBR ...	2	
11	(363-14146-00-00)	PLATE	1	
12	(363-14181-00-33)	BODY, FLOAT CHMBR 1	1	
13	214-14118-00-00	. CAP	2	
14	239-14117-00-00	. WASHER, PLUG SCREWSCREW	1	
15	363-14115-00-00	. PLUG, SCREW	1	
16	313-14146-00-00	. PLATE	2	
17	92990-05100-00	. WASHER, SPRING	4	
18	98501-05018-00	. SCREW, PAN HEAD	4	
19	(363-14112-35-00)	VALVE, THROTTLE 1	1	
20	239-14116-16-00	. NEEDLE	1	
21	164-14137-00-00	. CLIP	1	
22	(363-14136-00-00)	SEAT, SPRING	1	
23	363-14131-00-00	. SPRING, THROTTLE VALVE .	1	
24	363-14126-00-00	. GASKET	1	
25	363-14137-00-00	. CLIP	1	

CONTINUED ON NEXT FRAME ►

CARBURETOR

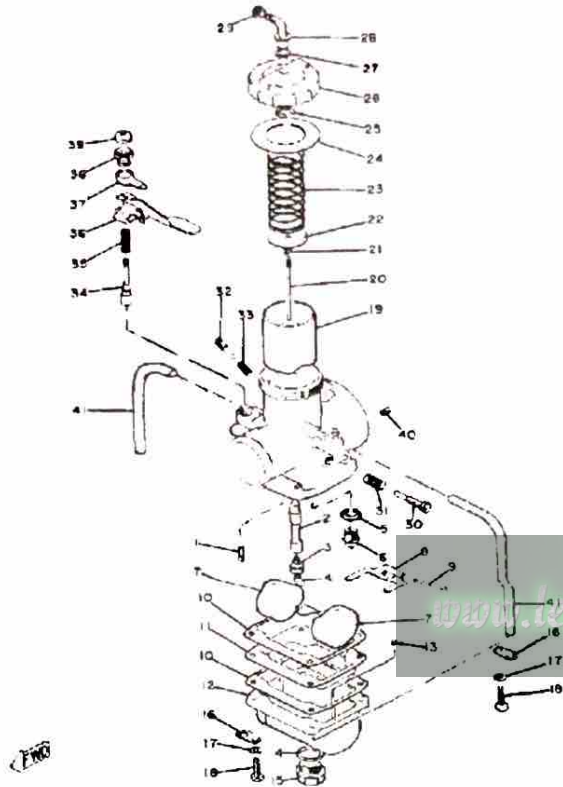

Ref. No.	Part Number	Description	Qty	Remarks
26	(363-14158-00-33)	TOP, MIXING CHAMBER	1	
27	363-14198-00-00	GASKET	1	
28	363-14155-00-00	GUIDE, CABLE	1	
29	127-14161-00-00	NUT, CABLE ADJUSTING	1	
30	23X-14103-00-00	THROTTLE SCREW SET	1	
	24X-14103-00-00	THROTTLE SCREW SET	1	
31	137-14133-00-00	SPRING, THRTL STOP	1	
32	23X-14104-00-00	AIR SCREW SET	1	
33	127-14134-00-00	SPRING, AIR ADJUSTING	1	
34	174-14171-00-00	PLUNGER, STARTER	1	
35	256-14135-00-00	SPRING, PLUNGER	1	
36	(310-14175-00-00)	LEVER, STARTER 1	1	
37	275-14178-00-00	PLATE, STARTER LVR	1	
38	802-14174-00-00	CAP, PLUNGER	1	
39	802-14173-00-00	COVER, PLUNGER CAP	1	
40	(237-14172-20-00)	PILOT JET, AIR # 0	1	
41	310-14197-00-00	PIPE, AIRVENT	2	
-1	(363-14101-63-00)	CARBURETOR ASSEMBLY 1	1	

SC500A

CARBURETOR (MFR) (TYPE) (I.D. NUMBER)	Mikuni VM 38SC	363E1, 36301 or 38362
MAIN JET	(E/N 02319~) No. 34D	(E/N~02318 No. 400
NEEDLE JET	0-8	Skyway) 0-8
JET NEEDLE/CLIP POSITION	5F16-2	5F16-2
CUT AWAY	No. 3.5	No. 3.5
PILOT JET	No. 80	No. 80
AIR JET	2.0	2.0
STARTER JET	No. 80	No. 80
AIR SCREW (TURNS OUT)	1%	1%

AIR CLEANER

Ref. No.	Part Number	Description	Qty	Remarks
1	363-13565-01-00	JOINT, CARBURETOR	1	
2	90460-51059-00	CLAMP, HOSE	1	
3	90460-71129-00	CLAMP, HOSE (90460-71017) .	2	
4	363-14453-00-00	JOINT, AIR CLNR 1	1	
5	363-14458-01-00	GUIDE, ELEMENT	1	
6	363-14451-00-00	ELEMENT, AIR CLNR	1	
7	(363-14412-00-00)	CAP, CLEANER CASE 1	1	
8	(90202-08021-00)	WASHER, PLATE	1	
9	92990-08200-00	WASHER, PLAIN	1	
10	(363-14428-00-00)	BOLT	1	

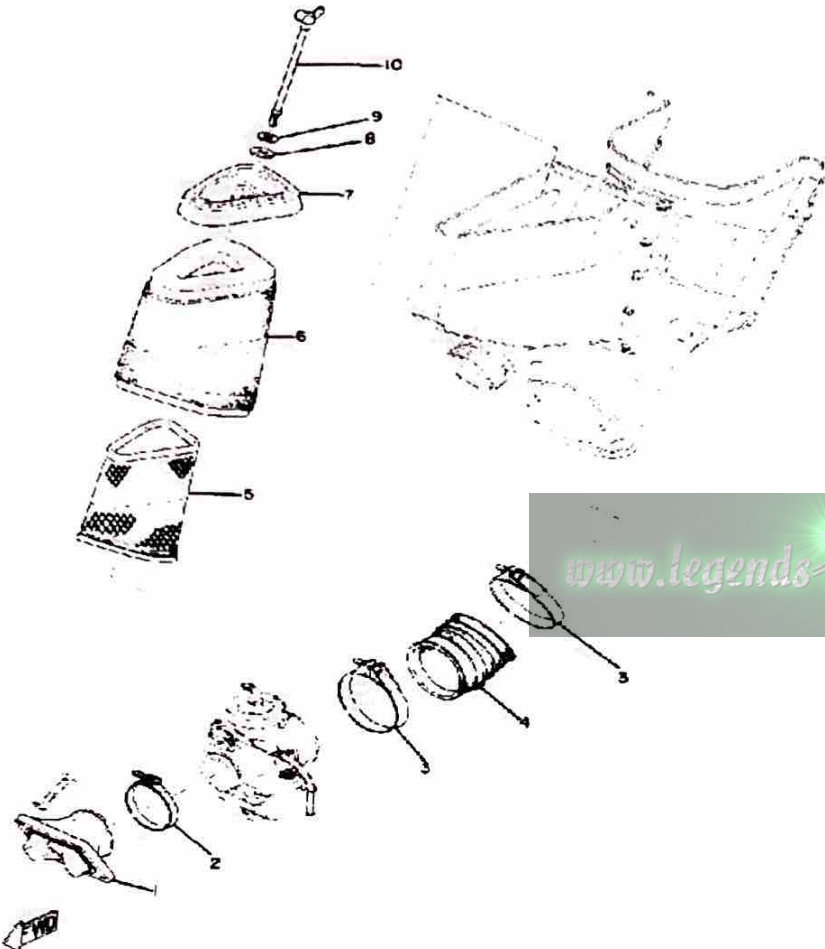

www.legends-yamaha-enduros.com

EXHAUST

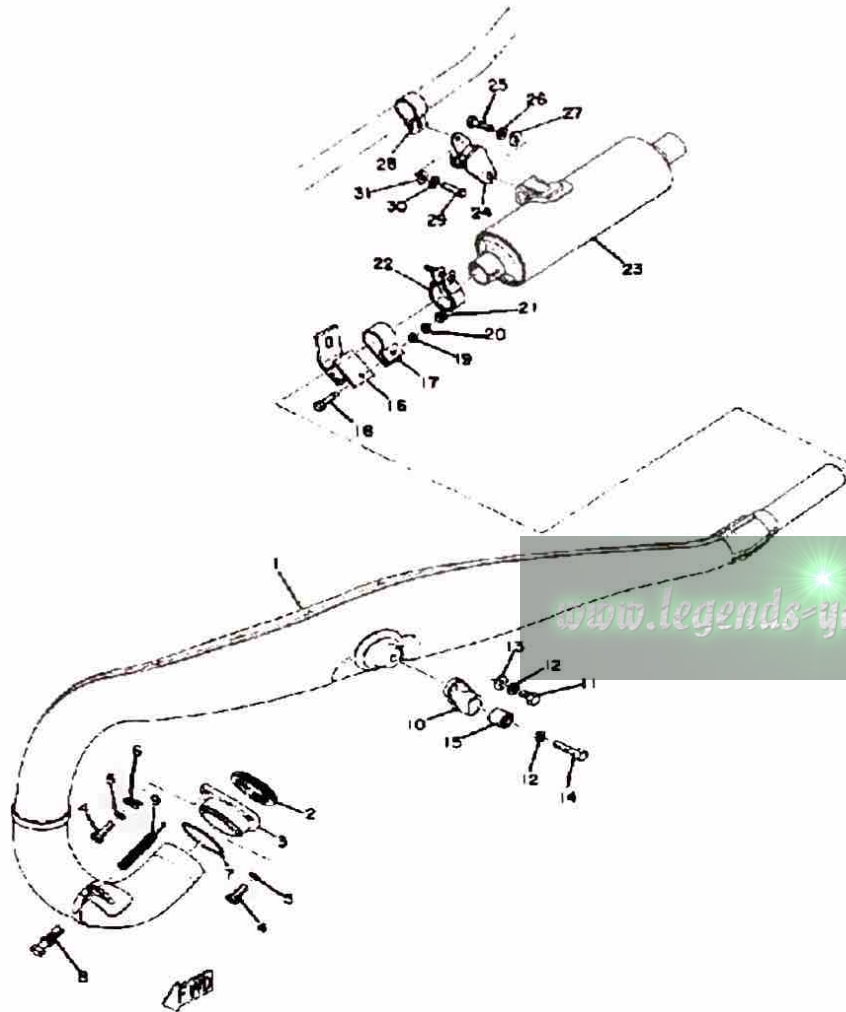

Ref. No.	Part Number	Description	Qty	Remarks
1	(363-14610-01-00)	EXHAUST PIPE ASSEMBLY L .	1	STD
	(364-14610-01-00)	EXHAUST PIPE ASSEMBLY L .	1	ALTERNATE PT
2	(363-14613-00-00)	GASKET, EXST PIPE	1	
3	(363-14612-00-00)	NUT, RING	1	STD
	(363-14612-01-00)	NUT, RING	1	ALTERNATE PT
4	97011-06020-00	BOLT	3	
5	92995-06100-00	WASHER, SPRING	3	
6	363-14685-00-00	PLATE	1	
7	248-14623-00-00	GASKET, EXST PIPE	1	
8	90109-08305-00	BOLT (322-14684-10)	1	
9	90507-20012-00	SPRING, TENSION (145-14683-00)	1	
10	363-14771-00-00	STAY, MUFFLER 1	1	
11	97313-08018-00	BOLT, HEXAGON (97301-08016)	1	
12	92990-08100-00	WASHER	2	
13	92990-08200-00	WASHER, PLAIN	1	
14	97313-08035-00	BOLT, HEXAGON	1	
15	164-22216-00-00	BUSH, REAR SHOCK ABSORBER	1	
16	(363-14791-00-00)	STAY, MUFFLER	1	
17	(285-14781-11-00)	STAY, MUFFLER 2	1	
18	97011-06025-00	BOLT (97001-06025)	1	
19	92990-06200-00	WASHER	1	
20	92995-06100-00	WASHER, SPRING	1	
21	95380-06600-00	NUT	1	
22	322-14788-11-00	BAND, SILENCER	1	ALTERNATE PT
	90460-34018-00	CLAMP, HOSE (363-14788-10) .	1	STD
23	(363-14753-11-00)	SILENCER, EXHAUST	1	STD
	(364-14753-00-00)	SILENCER, EXHAUST	1	ALTERNATE PT

CONTINUED ON NEXT FRAME ►

EXHAUST

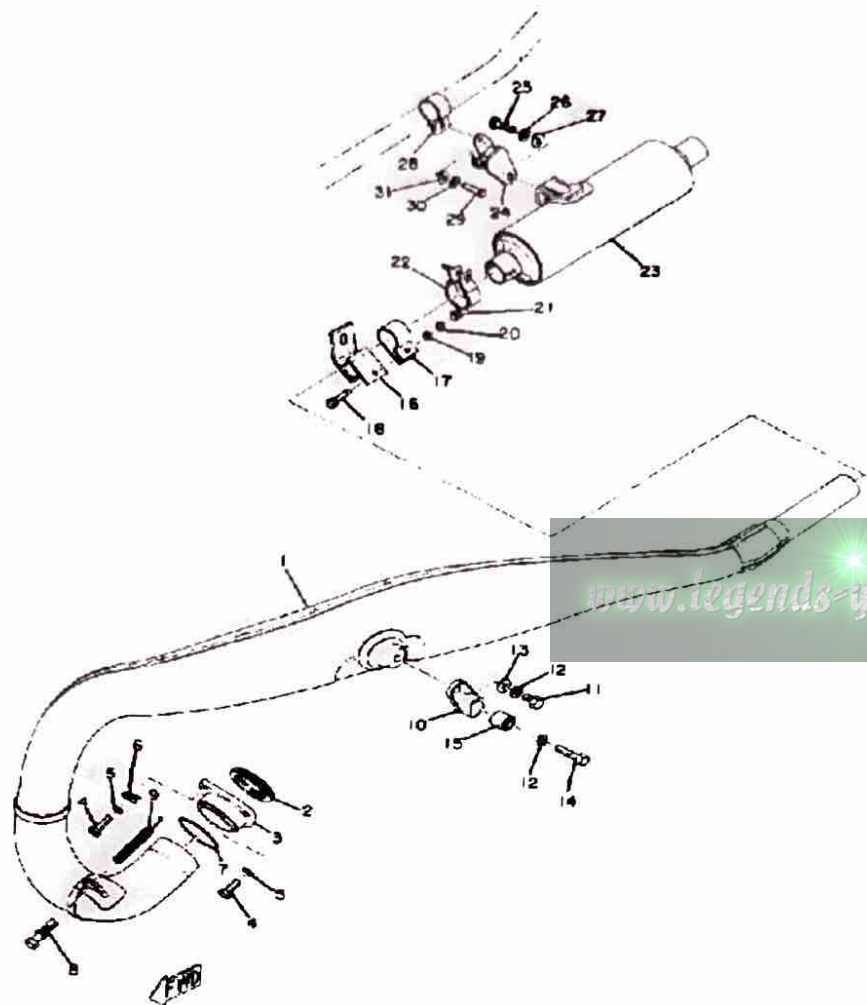

Ref. No.	Part Number	Description	Qty	Remarks
24	363-14782-10-00	STAY 5	1	
25	97313-08018-00	BOLT, HEXAGON (97301-08016)	1	
26	92990-08100-00	WASHER	1	
27	92990-08200-00	WASHER, PLAIN	1	
28	(322-14792-10-00)	STAY, MUFFLER	1	
29	97011-06020-00	BOLT	1	
30	92995-06100-00	WASHER, SPRING	1	
31	92990-06200-00	WASHER	1	

FRAME - SIDE COVER

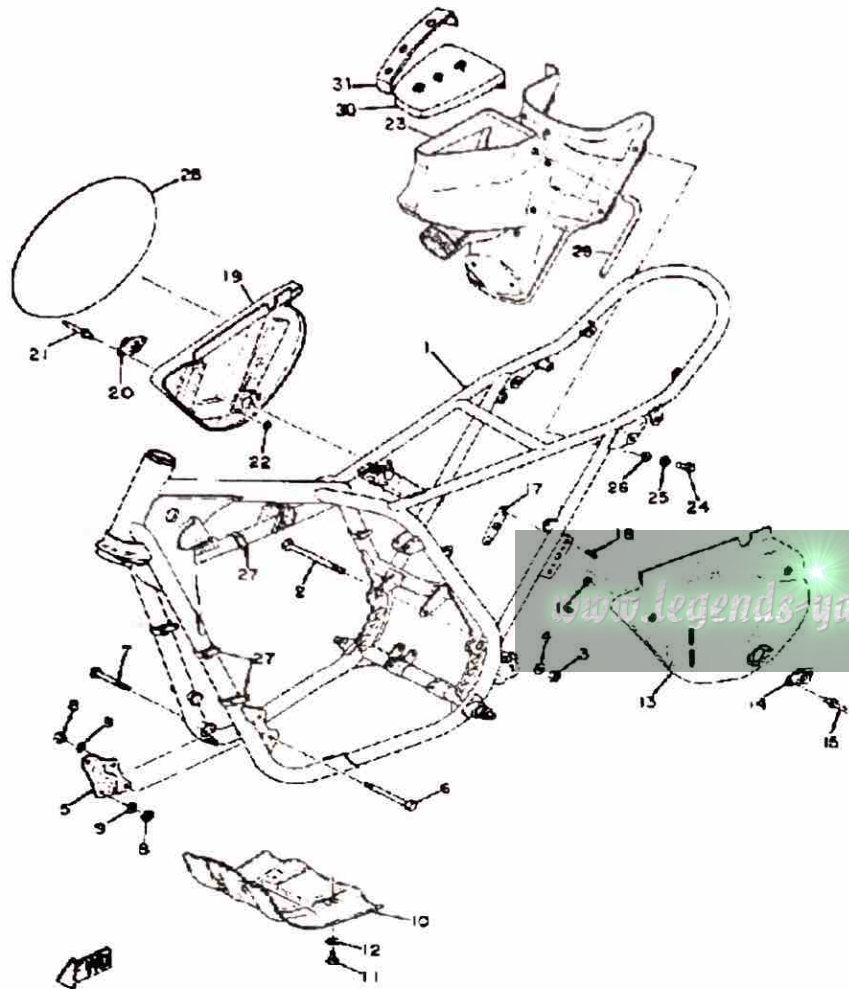

Ref. No.	Part Number	Description	Qty	Remarks
1	363-21110-00-33	NO LONGER AVAILABLE	1	YAMAHA BLK
2	90105-10051-00	BOLT, WASHER BASED	2	
3	95303-10600-00	NUT (95301-10600)	2	
4	92990-10100-00	LOCKWASHER	2	
5	(438-21416-01-33)	BRACKET, FRT UPR 2	1	
6	90105-08120-00	BOLT, WASHER BASED	2	
7	97013-08060-00	BOLT (663)	2	
8	95333-08600-00	NUT, HEXAGON	3	
9	92990-08100-00	WASHER	4	
10	363-21471-00-00	PROTECTOR, ENGINE	1	
11	97013-06012-00	BOLT	4	
12	92995-06100-00	WASHER, SPRING	4	
13	(363-21711-01-01)	COVER, SIDE 1	1	SILVER DUST/YAMAHA BLK
	(363-21711-10-02)	COVER, SIDE 1	1	COMP. YELLOW
14	(363-21189-00-00)	FASTENER, SIGN	1	
15	90267-40037-00	RIVET, BLIND	4	
16	90201-04014-00	WASHER, PLATE (322-21747-00)	4	
17	363-21736-00-00	NUT, PLATE	2	
18	98701-04010-00	SCREW, FLAT HEAD	4	
19	(363-21721-01-Y1)	COVER, SIDE 2	1	SILVER DUST
	(363-21721-10-00)	COVER, SIDE 2	1	COMP. YELLOW
20	(363-21189-00-00)	FASTENER, SIGN	1	
21	90267-40077-00	RIVET, BLIND	2	
22	90201-04014-00	WASHER, PLATE (322-21747-00)	2	
23	(363-21240-02-00)	BOX, AIR CLEANER	1	
	(363-21240-03-00)	BOX, AIR CLEANER	1	
24	97313-06016-00	BOLT, HEXAGON	4	

CONTINUED ON NEXT FRAME ►

FRAME - SIDE COVER

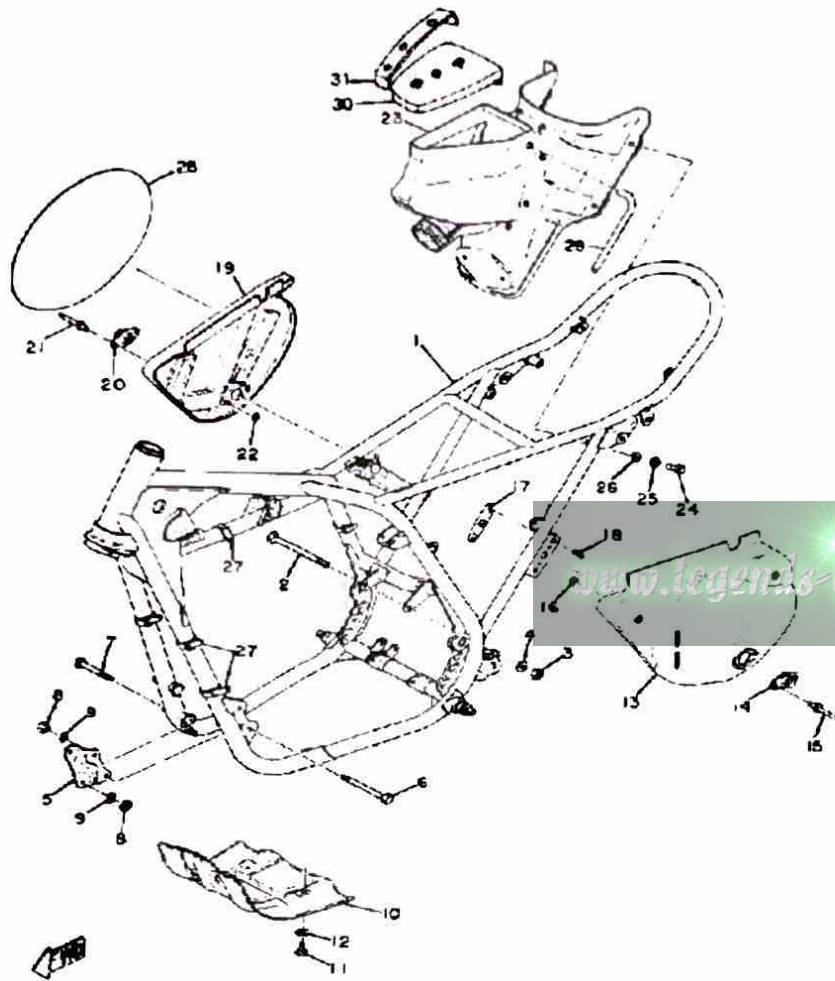

Ref. No.	Part Number	Description	Qty	Remarks
25	92995-06100-00	WASHER, SPRING	4	
26	90201-06067-00	WASHER, PLATE	4	
27	341-26397-01-00	BAND	8	
28	322-23395-00-00	EMBLEM	1	
29	(90445-09060-00)	HOSE	1	
30	(363-21269-00-00)	SEAL	1	
31	(363-21256-00-00)	PATCH 1	1	

REAR ARM - REAR CUSHION

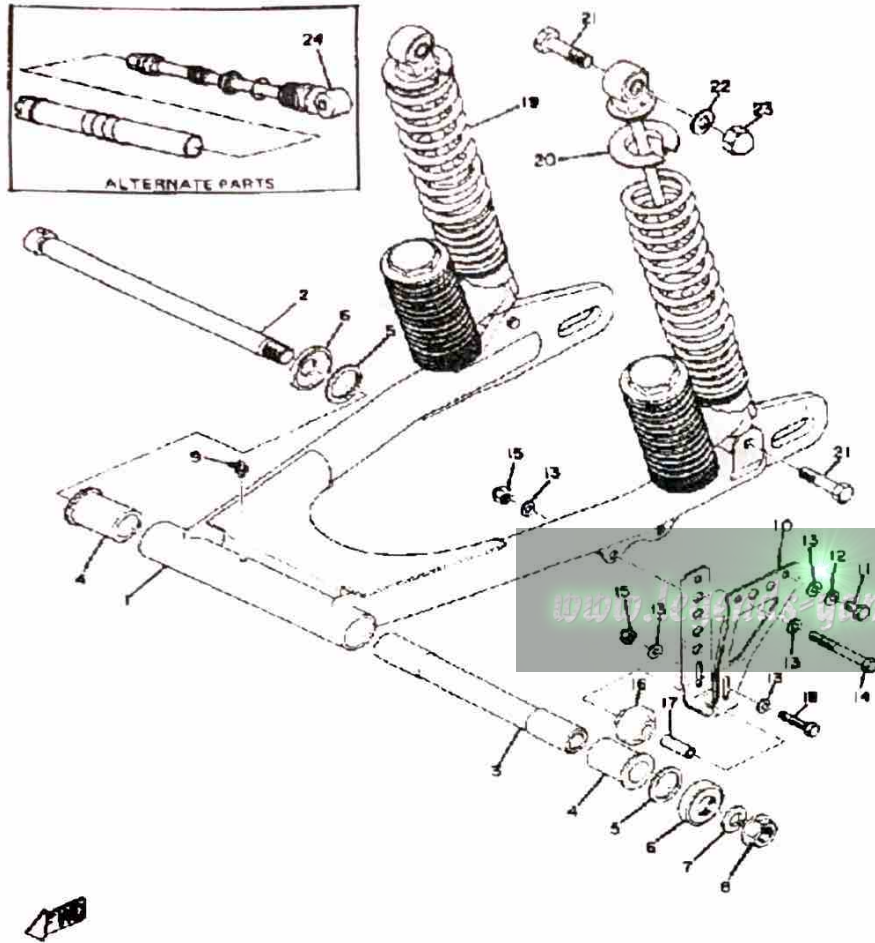

Ref. No.	Part Number	Description	Qty	Remarks
1	(322-22110-00-33)	REAR ARM	1	YAMAHA BLK
2	275-22141-00-00	SHAFT, PIVOT	1	
3	90387-16398-00	COLLAR (322-22124-00)	1	
4	3Y1-22184-01-00	BUSH	2	
5	240-22127-00-00	SHIM	1	
6	322-22128-01-00	COVER, THRUST 1	2	
7	92901-14100-00	WASHER, SPRING	1	
8	90179-14163-00	NUT, SPEC'L SHAPE (363-22143-00)	1	
9	93700-06005-00	NIPPLE, GREASE	1	
10	322-22153-00-33	GUARD, CHAIN	1	
11	97013-06012-00	BOLT	1	
12	92995-06100-00	WASHER, SPRING	1	
13	92990-06200-00	WASHER	5	
14	97313-06050-00	BOLT	1	
15	95380-06700-00	NUT	2	
16	322-22178-00-00	TENSIONER	1	
17	90560-06003-00	SPACER (322-22137-00)	1	
18	97313-06040-00	BOLT, HEXAGON	1	
19	(363-22210-75-00)	SHK/ABS ASSEMBLY, REAR	2	
20	(322-22213-20-00)	SEAT, SPRING UPPER	2	
21	90106-10025-00	BOLT, DOME HEAD	4	
22	92990-10100-00	LOCKWASHER	1	
23	95303-10800-00	NUT (CROWN) (92803-10700)	1	
24	(363-22250-09-00)	DAMPER UNIT ASSEMBLY	1	ALTERNATE PARTS/P/N 369
	(363-22250-79-00)	DAMPER UNIT ASSEMBLY	1	ALTERNATE PARTS/M4-062

STAND - FOOTREST - BRAKE PEDAL

Ref. No.	Part Number	Description	Qty	Remarks
1	214-27311-01-00	STAND, SIDE	1	
2	90102-10006-00	BOLT, WITH HOLE (278-27317-00)	1	
3	95303-10900-00	NUT, SLOTTED	1	
4	91490-20025-00	PIN, SPLIT	1	
5	90507-29004-00	SPRING, TENSION (214-27316-00)	1	
6	(363-27412-01-00)	BRACKET, FOOTREST 1	1	
7	(90508-26039-00)	SPRING, TORSION	1	
8	(363-27411-00-00)	FOOTREST 1	1	
9	93430-10015-00	CIRCLIP, E-TYPE	2	
10	97013-08025-00	BOLT	2	
11	95301-12700-00	NUT (95302-12700)	2	
	95701-12500-00	NUT, FLANGE	2	
12	(363-27422-01-00)	BRACKET, FOOTREST 2	1	
13	(90508-26112-00)	SPRING, TORSION	1	
14	(363-27421-00-00)	FOOTREST 2	1	
15	363-27211-00-33	PEDAL, BRAKE	1	YAMAHA BLK
16	(363-27212-00-00)	SHAFT, BRAKE PEDAL	1	
17	97011-06020-00	BOLT	1	
18	(363-27216-00-00)	SPRING, BRAKE PEDAL	1	
19	(90109-06339-00)	BOLT	1	
20	95380-06700-00	NUT	1	
21	363-27231-00-00	ROD, BRAKE	1	
22	90240-06006-00	PIN, CLEVIS	1	
23	92990-06200-00	WASHER	1	
24	91401-25020-00	PIN, COTTER	1	
25	90501-10245-00	SPRING, COMPRESSION	1	
26	90249-12008-00	PIN	1	

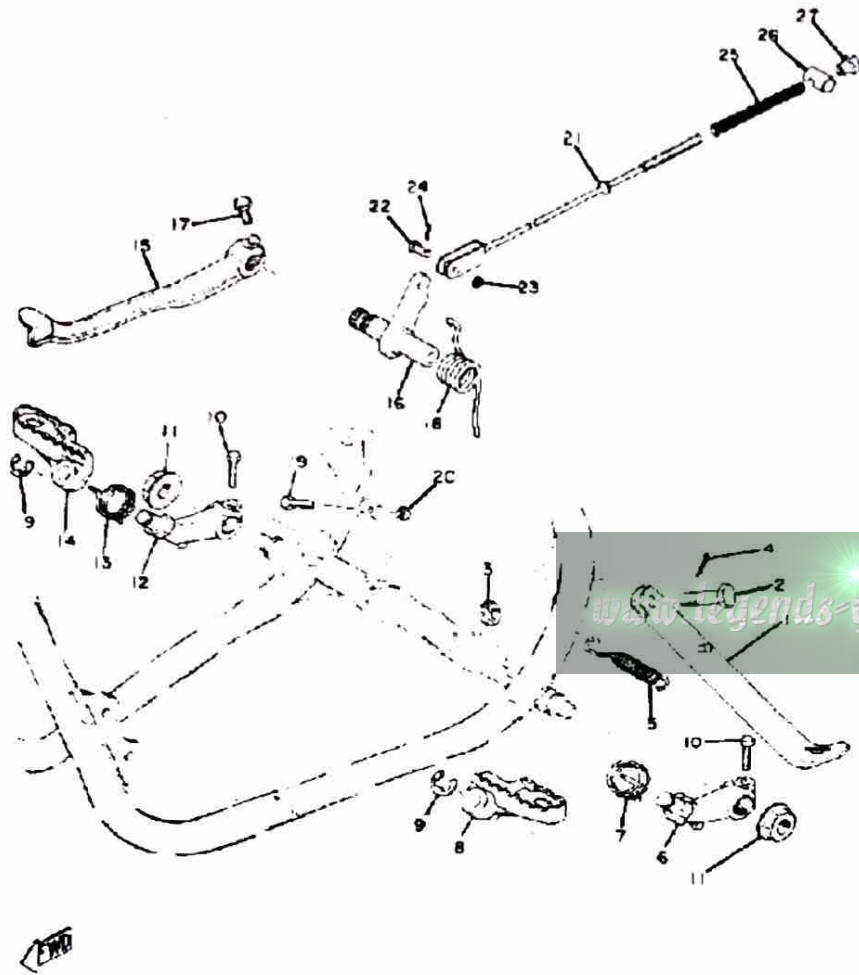

CONTINUED ON NEXT FRAME ►

STAND - FOOTREST - BRAKE PEDAL

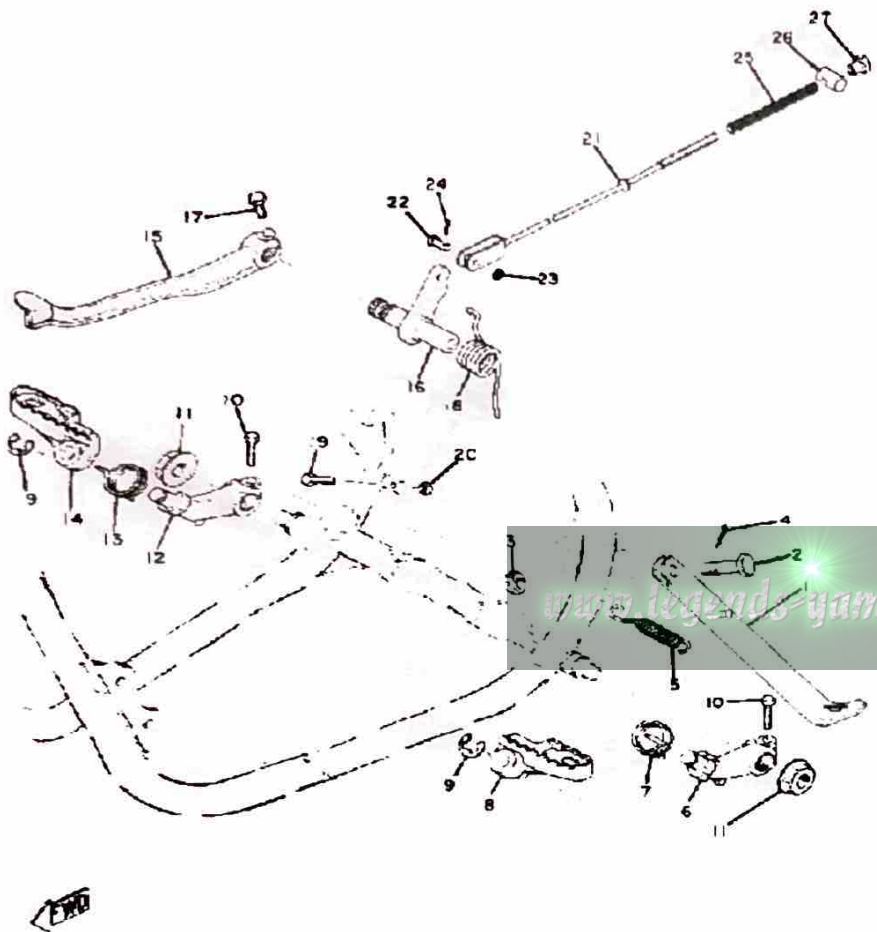

Ref. No.	Part Number	Description	Qty	Remarks
27	90179-06411-00	NUT	1	

FRONT FENDER - REAR FENDER

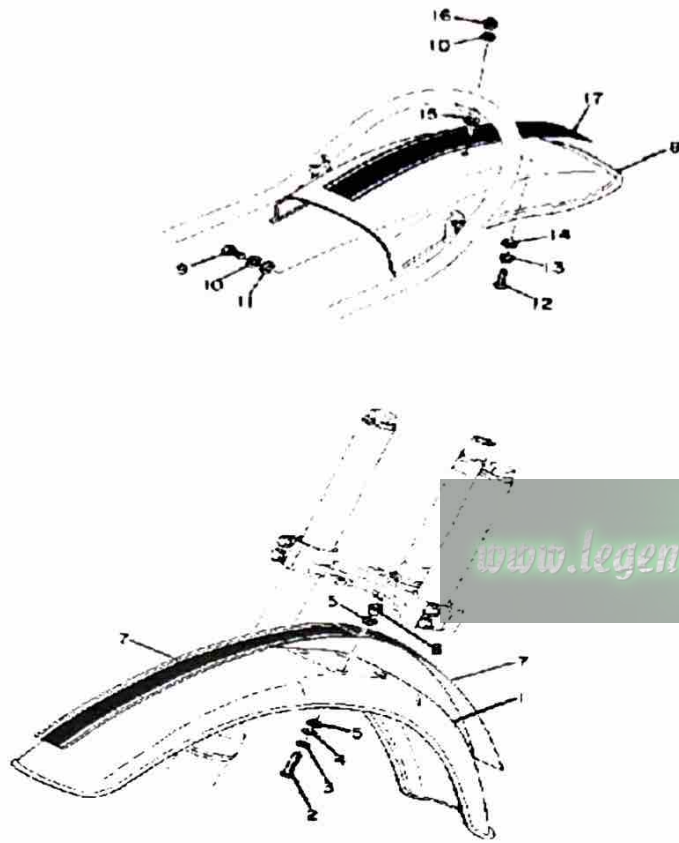

Ref. No.	Part Number	Description	Qty	Remarks
1	(322-21511-00-Y1)	FENDER, FRONT	1	SILVER DUST
	453-21511-01-00	FENDER, FRONT	1	COMP. YELLOW
2	97313-06030-00	BOLT, HEXAGON	4	
3	92995-06100-00	WASHER, SPRING	4	
4	90201-06067-00	WASHER, PLATE	4	
5	322-21541-00-00	DAMPER 1	8	
6	90387-06388-00	COLLAR	4	
7	(363-21519-00-01)	MOLD, FENDER	2	YAMAHA BLK/PASTEL RED
	(402-21519-00-00)	MOLD, FENDER	2	
8	322-26111-00-Y1	UNAVAILABLE IN PRICE BOOK	1	SILVER DUST
	363-21611-00-00	FENDER, REAR	1	COMP. YELLOW
9	97313-06016-00	BOLT, HEXAGON	2	
10	92995-06100-00	WASHER, SPRING	3	
11	90201-06067-00	WASHER, PLATE	2	
12	98580-06018-00	SCREW, PAN HEAD	1	
13	90209-06087-00	WASHER, SPEC'L SHAP	1	
14	(322-21639-00-00)	DAMPER 2	1	
15	322-21541-00-00	DAMPER 1	1	
16	95380-06700-00	NUT	1	
17	(363-21619-00-01)	STRIPE, REAR FENDER	1	YAMAHA BLK/PASTEL RED
	(363-21619-10-00)	STRIPE, REAR FENDER	1	

FR

STEERING

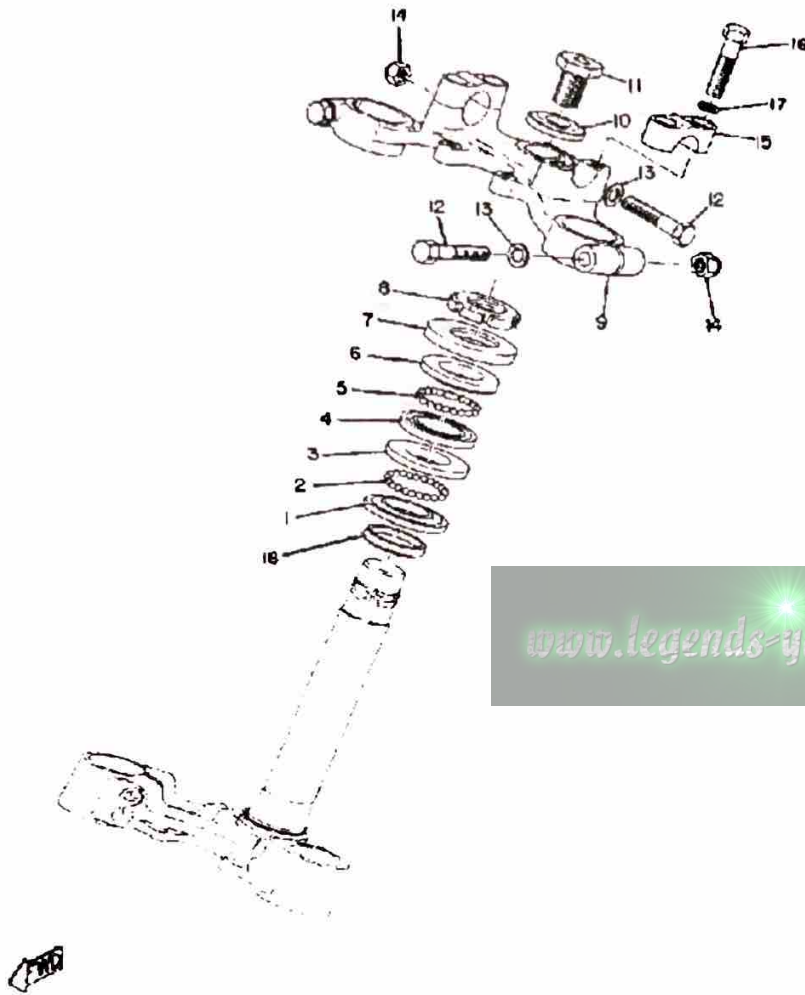

Ref. No.	Part Number	Description	Qty	Remarks
1	156-23411-00-00	RACE, BALL 1	1	
2	93501-04011-00	BALL	19	
3	156-23412-00-00	RACE, BALL 2	1	
4	22F-23412-01-00	RACE, BALL 2	1	
5	93503-16010-00	BALL	22	
6	22F-23411-01-00	RACE, BALL 1	1	
7	122-23416-00-00	COVER, BALL RACE 2	1	
8	90179-25033-00	NUT	1	
9	(321-23435-01-98)	CROWN, HANDLE	1	FROSTING BLK
10	90209-14022-00	WASHER, SPEC"L SHAP (214-23443-00)	1	
11	90109-14235-00	BOLT (322-23451-00)	1	
12	97321-08055-00	BOLT, HEXAGON	3	
13	90201-08083-00	WASHER, PLATE	3	
14	95611-08100-00	NUT, U	3	
15	322-23411-01-98	UNAVAILABLE IN PRICE BOOK	2	FROSTING BLK
16	97313-08035-00	BOLT, HEXAGON	4	
17	92990-08100-00	WASHER	4	
18	164-23462-00-00	SEAL, STEERING	1	

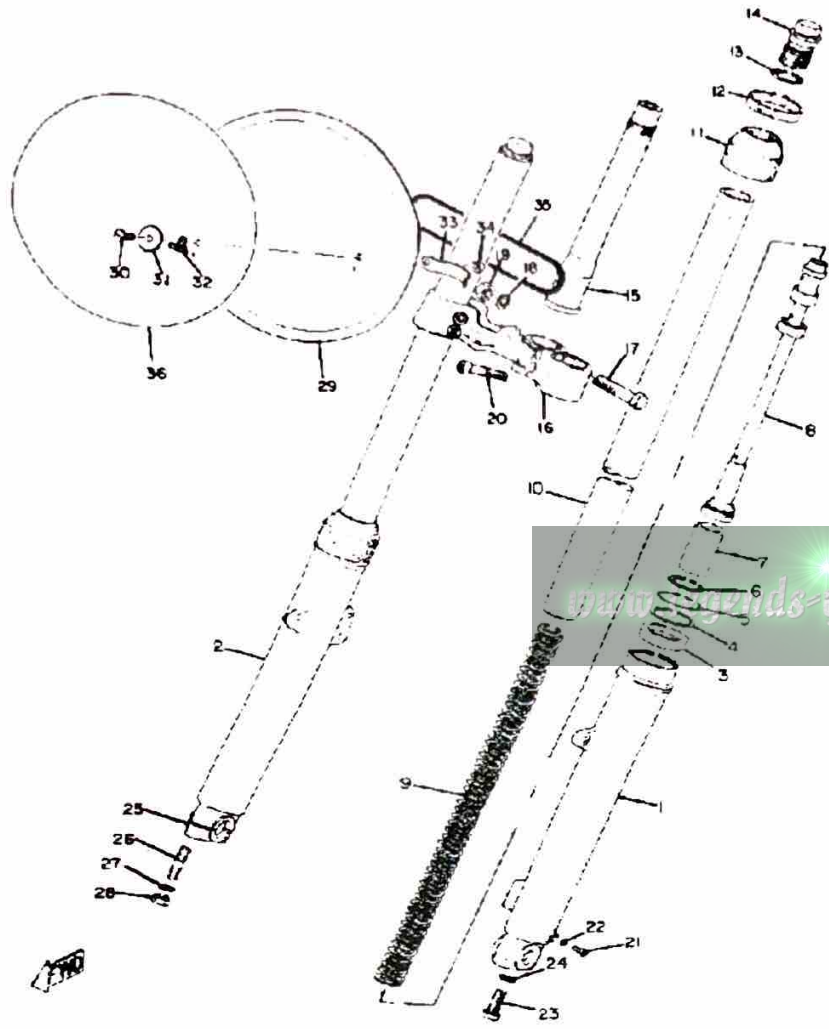

FRONT FORK

Ref. No.	Part Number	Description	Qty	Remarks
1	(291-23126-60-00)	TUBE, OUTER 1	1	
2	(291-23136-60-00)	TUBE, OUTER 2	1	
3	278-23145-51-00	OIL SEAL	2	
4	214-23146-00-00	WASHER, OIL SEAL	2	
5	214-23156-00-00	CLIP, OIL SEAL	2	
6	93450-30033-00	CIRCLIP, INNER	2	
7	(322-23171-00-00)	PISTON, FRONT FORK	2	
8	(363-23170-00-00)	CYLINDER, FRTRFK	2	
9	(363-23141-01-00)	SPRING, FRONT FORK	2	
10	(363-23124-00-00)	TUBE, INNER 1	2	
11	292-23144-00-00	SEAL, DUST	2	
12	(90460-54061-00)	CLAMP, HOSE	1	
13	214-23114-00-00	GASKET	2	
14	(291-23111-60-00)	BOLT, CAP	2	
15	(1E6-23341-00-00)	SHAFT, STEERING	1	
16	(322-23345-00-33)	BRACKET, LOWER	1	YAMAHA BLK
17	(322-23356-00-00)	BOLT 2	1	
18	92990-10100-00	LOCKWASHER	1	
19	(322-23357-00-00)	NUT	1	
20	(322-23346-00-00)	BOLT 1	4	
21	98580-04008-00	SCREW, PAN HEAD	2	
22	122-23129-00-00	GASKET, DRAIN PLUG	2	
23	278-23181-50-00	BOLT, HEXAGON SOCKET HEAD	2	
24	509-23158-L0-00	GASKET	2	
25	291-23167-61-00	HOLDER, AXLE (291-23167-60)	1	
26	90116-08261-00	BOLT, STUD	2	
27	92990-08100-00	WASHER	2	
28	95333-08600-00	NUT, HEXAGON	2	

CONTINUED ON NEXT FRAME ►

FRONT FORK

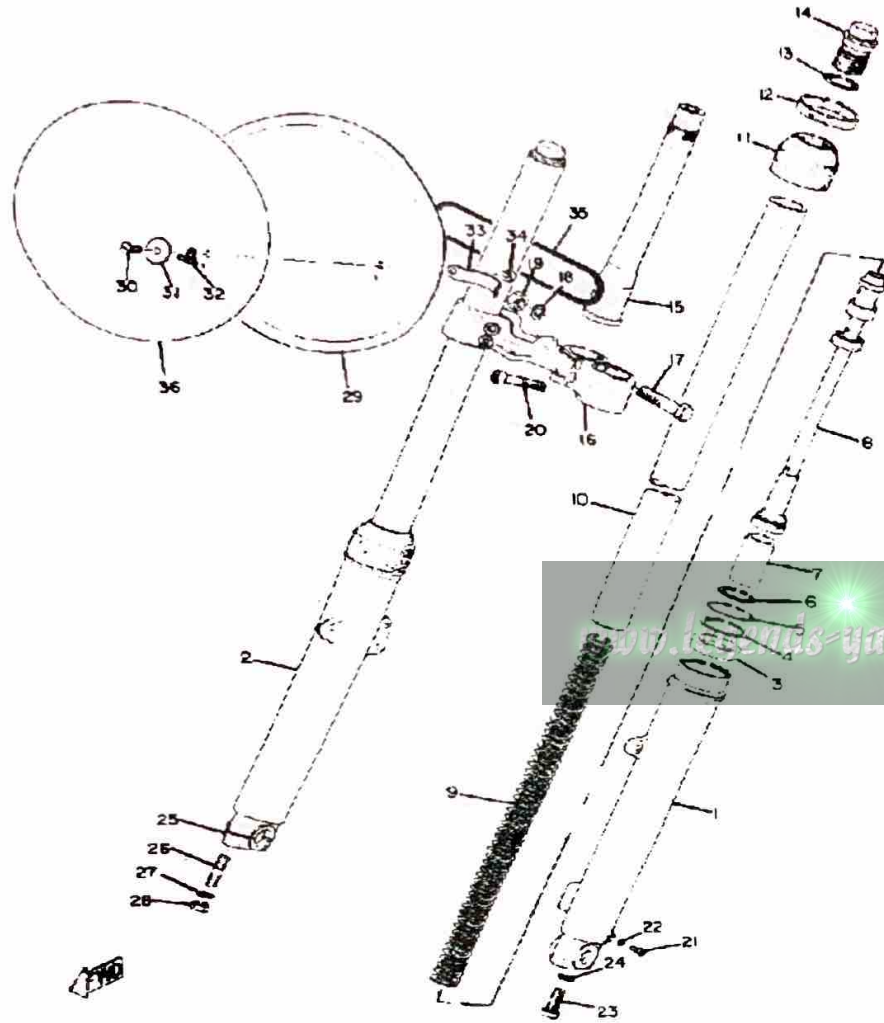

Ref. No.	Part Number	Description	Qty	Remarks
29	322-23485-00-00	PLATE, NUMBER	1	
30	90146-06007-00	SCREW, OVAL FLSTR (322-23396-00)	2	
31	90201-06073-00	WASHER, PLATE	2	
32	(322-23319-00-00)	HOLDER, CABLE 2	1	
33	(318-23487-00-00)	STAY, PLATE	2	
34	95380-06600-00	NUT	1	
35	93210-99103-00	O-RING	1	
36	322-23395-00-00	EMBLEM	1	
-1	(363-23101-02-00)	FRONT FORK ASSEMBLY	1	

HANDLE - WIRE

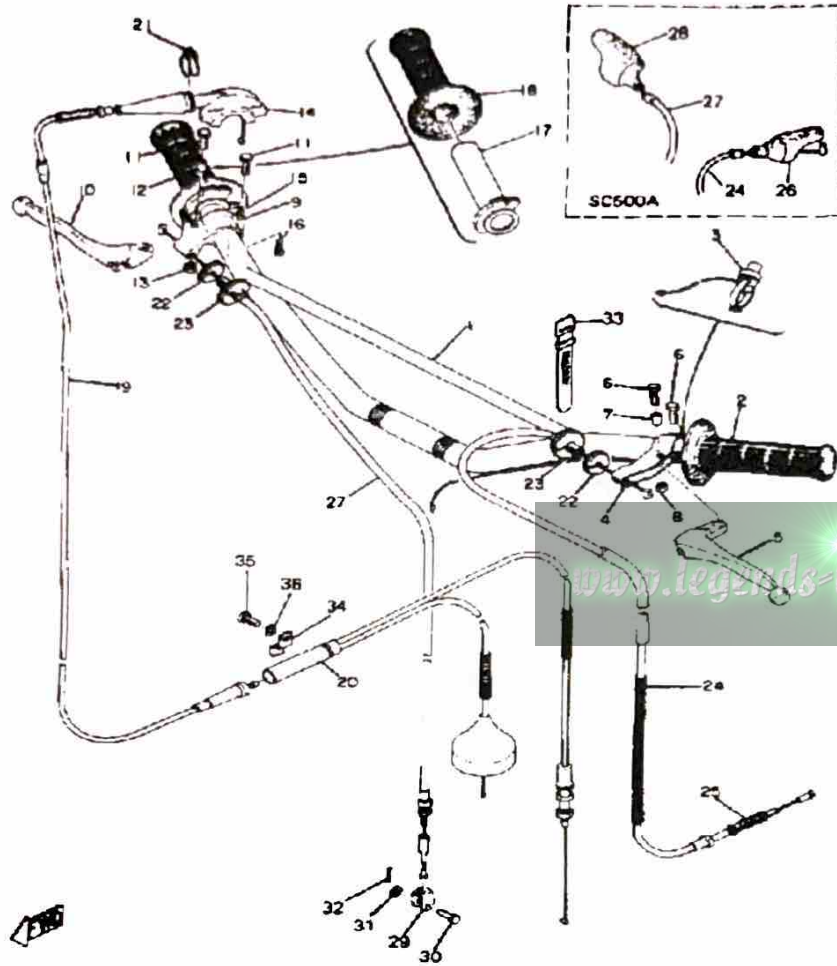

Ref. No.	Part Number	Description	Qty	Remarks
1	(483-26111-00-00)	HANDLEBAR	1	
2	1E6-26241-00-00	GRIP LH	1	
3	(363-83976-01-00)	SWITCH, HANDLE 1	1	
4	214-82911-01-00	. HOLDER, LEVER 1	1	
5	214-83912-00-00	. LEVER 1	1	
6	97023-06020-00	. BOLT (3XF)	2	
7	214-83913-00-00	. COLLAR, LEVER 1	1	
8	95380-06600-00	. NUT	1	
9	233-82921-31-00	. HOLDER, LEVER 2	1	
10	233-83922-30-00	. LEVER R	1	
11	97023-06020-00	. BOLT (3XF)	2	
12	214-83913-00-00	. COLLAR, LEVER 1	1	
13	95380-06600-00	. NUT	1	
14	322-26281-00-98	CAP, GRIP UPPER	1	
15	322-26282-00-00	CAP, GRIP LOWER	1	
16	98580-05020-00	SCREW, PAN HEAD	2	
17	322-26243-00-00	TUBE, throttle guide	1	
18	583-26242-00-00	GRIP RH	1	
19	363-26311-00-00	CABLE, THROTTLE 1	1	
20	363-26312-00-00	CABLE, THROTTLE 2	1	
21	90460-12268-00	CLAMP, HOSE	1	
22	90179-08148-00	NUT	2	
23	90123-08046-00	BOLT	2	
24	363-26335-03-00	CABLE, CLUTCH	1	
25	(363-26342-00-00)	BOOT, CABLE	1	
26	382-26372-01-00	. COVER, HANDLE LEVER ...	1	
27	427-26341-00-00	CABLE, BRAKE	1	
28	382-26372-01-00	. COVER, HANDLE LEVER ...	1	
29	156-26347-00-00	JOINT, CABLE	1	

CONTINUED ON NEXT FRAME ►

HANDLE - WIRE

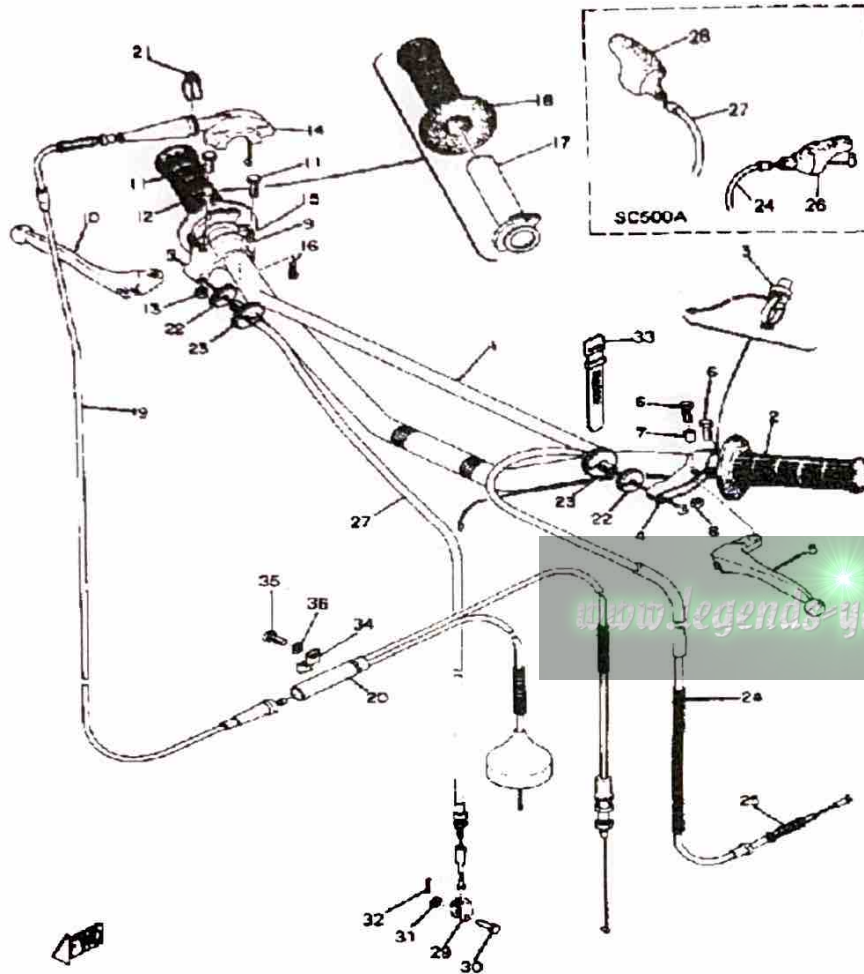

Ref. No.	Part Number	Description	Qty	Remarks
30	90240-08013-00	PIN, CLEVIS	1	
31	90201-08083-00	WASHER, PLATE	1	
32	91490-20020-00	PIN, COTTER	1	
33	437-83936-01-00	BAND, SWITCH CORD	2	
34	363-26393-00-00	HOLDER	1	
35	98580-06010-00	SCREW, PAN HEAD (92503-06010)	1	
36	92995-06100-00	WASHER, SPRING	1	
-1	214-82910-07-00	LEVER HOLDER ASSEMBLY 1 (214-82910-05)	1	
-2	(233-82920-03-00)	LEVER HOLDER ASSEMBLY 2	1	

FUEL TANK

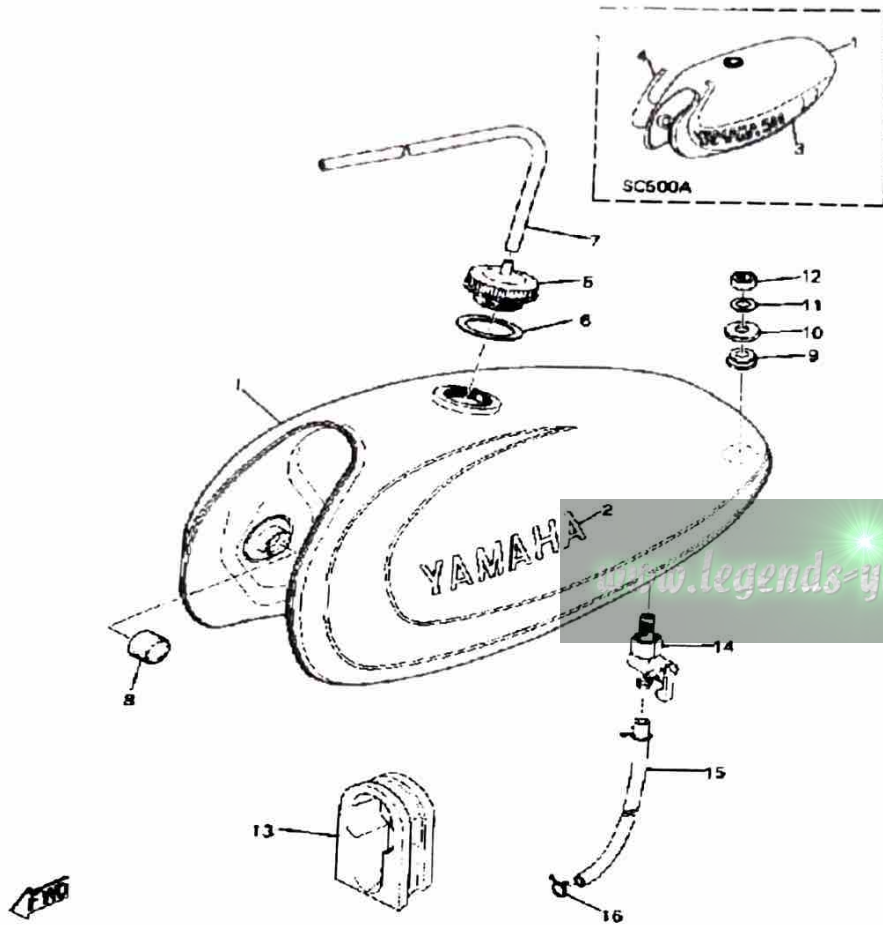

Ref. No.	Part Number	Description	Qty	Remarks
1	(363-24110-00-01)	FUEL TANK	1	SILVER DUST/YAMAHA BLK
	(363-24110-01-04)	FUEL TANK	1	COMP. YELLOW
2	322-24161-00-00	. EMBLEM 1	2	
5	322-24611-02-00	BODY, CAP	1	
6	90430-37052-00	GASKET (322-24612-00)	1	
7	90445-09111-00	HOSE	1	
8	278-24181-00-00	DAMPER, LOCATING 1	2	
9	(90480-25189-00)	GROMMET	1	
10	(90209-10101-00)	WASHER, SPEC"L SHAP	1	
11	92990-10100-00	LOCKWASHER	1	
12	95303-10700-00	NUT	1	
13	363-24183-00-00	DAMPER, LOCATING 3	1	
14	322-24500-02-00	FUEL COCK ASSEMBLY 1 (322-24500-00)	1	M5-013
15	90445-11150-00	HOSE (363-24311-00)	1	
16	90467-10008-00	CLIP	2	

OIL TANK

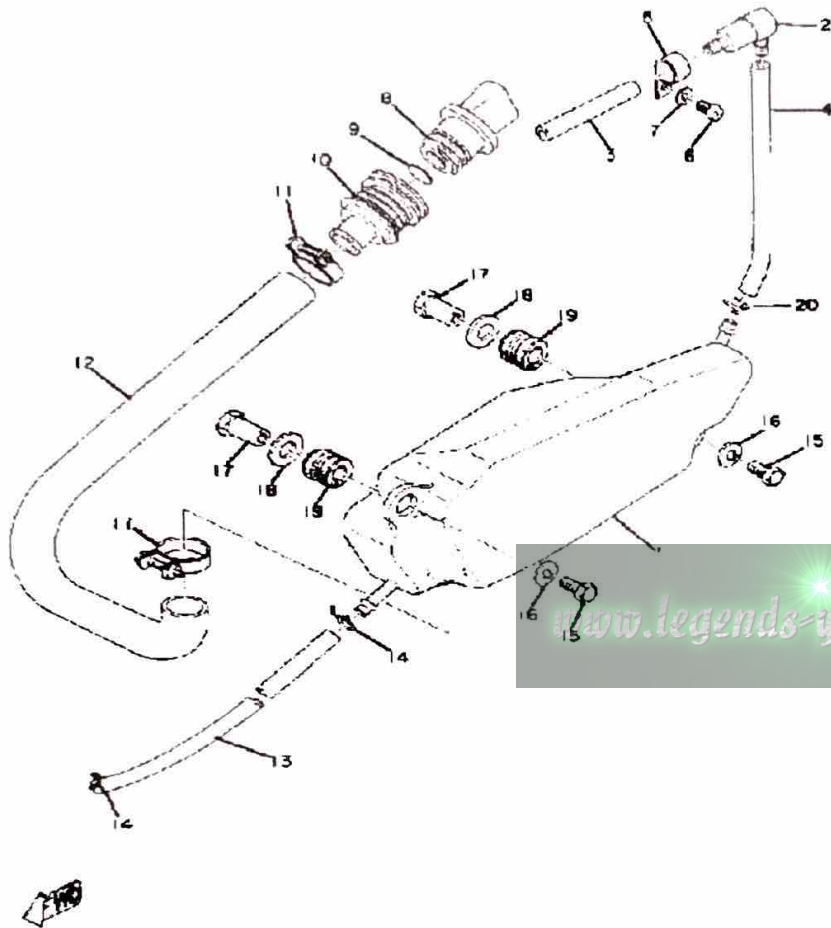

Ref. No.	Part Number	Description	Qty	Remarks
1	(363-21751-01-00)	TANK, OIL	1	
2	(363-21744-00-00)	BREATHER	1	
3	(90445-09060-00)	HOSE	1	
4	(363-21745-00-00)	PIPE, OIL TNK BRTHR	1	
5	(90461-08008-00)	CLAMP	1	
6	98580-05010-00	SCREW, PAN HEAD	1	
7	92990-05200-00	WASHER, PLAIN	1	
8	363-21771-01-00	BODY, CAP	1	
9	(363-21765-00-00)	DISC, CAP	1	
10	(363-21752-00-00)	TUBE, FILLER 1	1	
11	(90460-24006-00)	CLAMP, HOSE	2	
12	(363-21753-01-00)	BOSS, CONNECTOR	1	
13	90445-09112-00	HOSE	1	
14	90467-10008-00	CLIP	2	
15	97013-06012-00	BOLT	2	
16	92995-06100-00	WASHER, SPRING	2	
17	(90179-06136-00)	NUT, SPEC"L SHAPE	2	
18	92990-10200-00	WASHER, PLAIN	2	
19	90480-14023-00	GROMMET	2	
20	(363-21780-00-00)	LOCK ASSEMBLY	1	

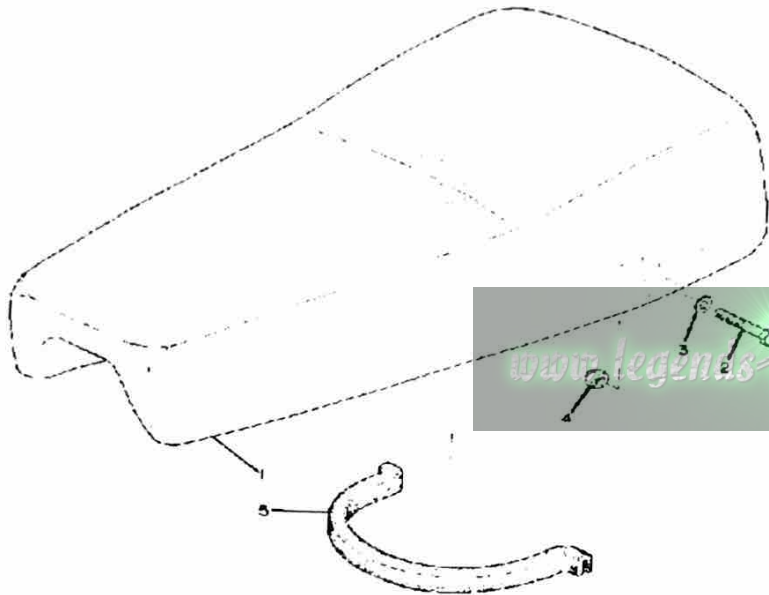
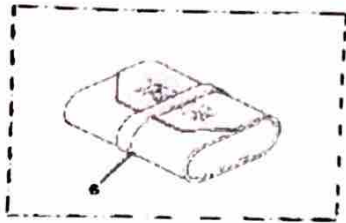

SEAT

Ref. No.	Part Number	Description	Qty	Remarks
1	(363-24770-01-00)	SEMI-DBL SEAT ASSEMBLY ..	1	
2	97313-08050-00	BOLT, HEXAGON (90101-08125)	2	
3	92990-08200-00	WASHER, PLAIN	2	
4	95611-08100-00	NUT, U	2	
5	(363-21746-00-00)	DAMPER	1	
6	(363-28100-10-00)	TOOL KIT	1	
1-1	(363-24771-00-00)	COVER, SM-DBL SEAT	1	

FRONT WHEEL

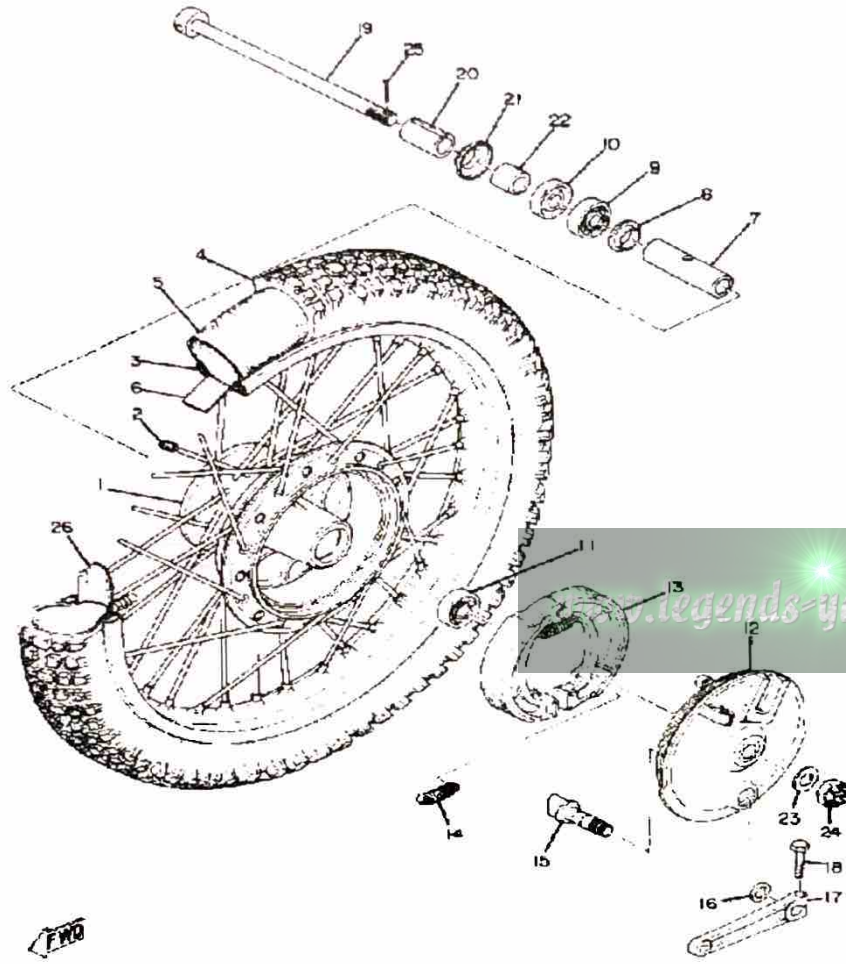

Ref. No.	Part Number	Description	Qty	Remarks
1	(322-25111-00-00)	HUB, FRONT	1	
2	(322-25104-01-00)	SPOKE SET, FRONT	1	
	(322-25179-90-00)	SPOKE SET, INNER 2	9	10PK
	(322-25189-90-00)	SPOKE SET, OUTER 2	9	10PK
	(322-25196-90-00)	SPOKE SET, INNER 1	9	10PK
	(322-25197-90-00)	SPOKE SET, OUTER 1	9	10PK
3	94416-21234-00	RIM 1.60X 1	1	
4	(94130-213A4-00)	300-21 M1B (TT)	1	
5	94227-21101-00	TUBE (80/100-21 TR4 BTL)	1	
6	(94327-21024-00)	BAND, RIM	1	
7	90560-15116-00	SPACER	1	
8	146-25116-00-00	FLANGE, SPACER 2	1	
9	93306-20211-00	BEARING (6202SH2-C3)	1	
10	93102-20009-00	OIL SEAL	1	
11	93306-20204-00	BEARING (B6202Z)	1	
12	(322-25121-00-00)	PLATE, BRAKE SHOE	1	
13	322-W2535-00-00	BRAKESHOE SET-2PCS	2	
14	90506-17328-00	SPRING, TENSION	2	
15	23X-25151-00-00	CAMSHAFT	1	
16	137-25159-00-00	SEAL, CAMSHAFT	1	
17	322-25155-00-00	LEVER, CAMSHAFT 1	1	
18	97011-06025-00	BOLT (97001-06025)	1	
19	275-25181-00-00	AXLE, WHEEL	1	
20	90387-15116-00	COLLAR (322-25186-00)	1	
21	322-25118-00-00	COVER, HUB DUST	1	
22	90387-15418-00	COLLAR (322-25183-00)	1	
23	92990-14200-00	WASHER, PLAIN	1	
24	90171-14020-00	NUT, CASTLE	1	
25	91401-30030-00	PIN, COTTER	1	

CONTINUED ON NEXT FRAME ►

FRONT WHEEL

Ref. No.	Part Number	Description	Qty	Remarks
26	1T1-25194-00-00	SPACER, BEAD	2	

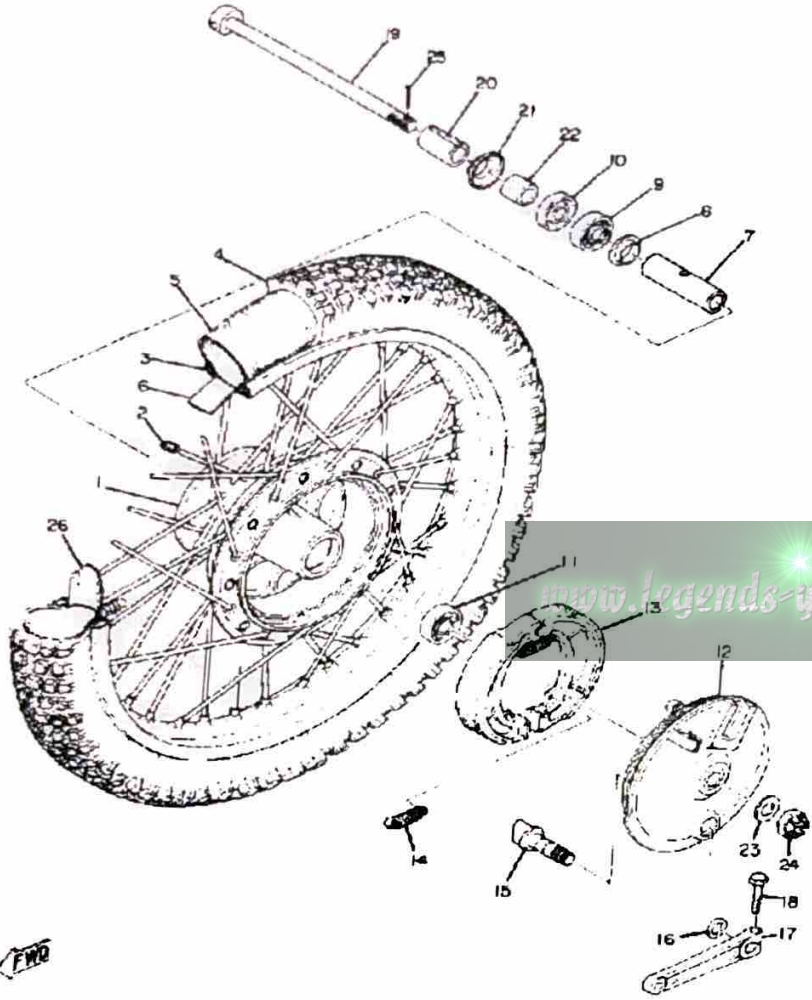

FRONT

REAR WHEEL

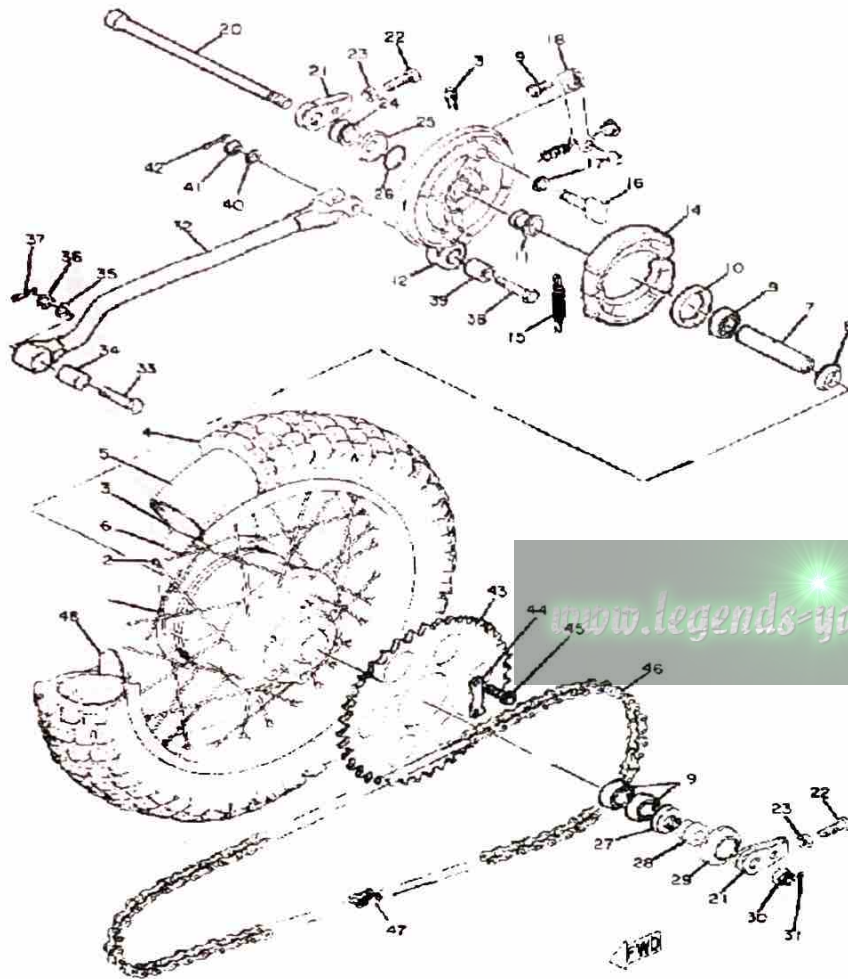

Ref. No.	Part Number	Description	Qty	Remarks
1	(322-25311-00-00)	HUB, REAR	1	
2	(322-25392-90-00)	SPOKE SET, OUTER 1	9	10PK
	(322-25396-90-00)	SPOKE SET, INNER 2	9	10PK
	(322-25397-90-00)	SPOKE SET, OUTER 2	9	10PK
	322-25304-00-00	SPOKE SET, REAR	1	
	322-25391-90-00	NO LONGER AVAILABLE	9	10PK
3	(94421-18070-00)	RIM 2.15X 8	1	
4	(94146-18109-00)	460X18 DUN SR SPRT	1	
5	(94246-18040-00)	TUBE	1	
6	94340-18022-00	BAND, RIM (4.00-18)	1	
7	90560-17311-00	SPACER	1	
8	146-25315-00-00	FLANGE, SPACER	1	
9	93306-20310-00	BEARING	3	
10	(93104-46029-00)	OIL SEAL, SO-TYPE	1	
11	(90387-17450-00)	COLLAR	1	
12	(438-25320-10-00)	BRAKE SHOE PLT ASSEMBLY	1	
13	93700-06M03-00	NIPPLE, GREASE	1	
14	214-W2535-00-00	BRAKESHOE SET-2PCS	2	
15	90507-20002-00	SPRING, TENSION	2	
16	214-25351-01-00	CAMSHAFT	1	
17	148-25353-00-00	SHIM, CAMSHAFT	1	
18	4V5-25355-00-00	LEVER, CAMSHAFT (168-25355-00)	1	
19	97011-06025-00	BOLT (97001-06025)	1	
20	150-25381-00-00	AXLE, WHEEL	1	
21	168-25389-00-00	PULLER, CHAIN 2	2	
22	90101-08699-00	BOLT	2	
23	95303-08700-00	NUT	2	
24	90387-17141-00	COLLAR	1	

CONTINUED ON NEXT FRAME ►

REAR WHEEL

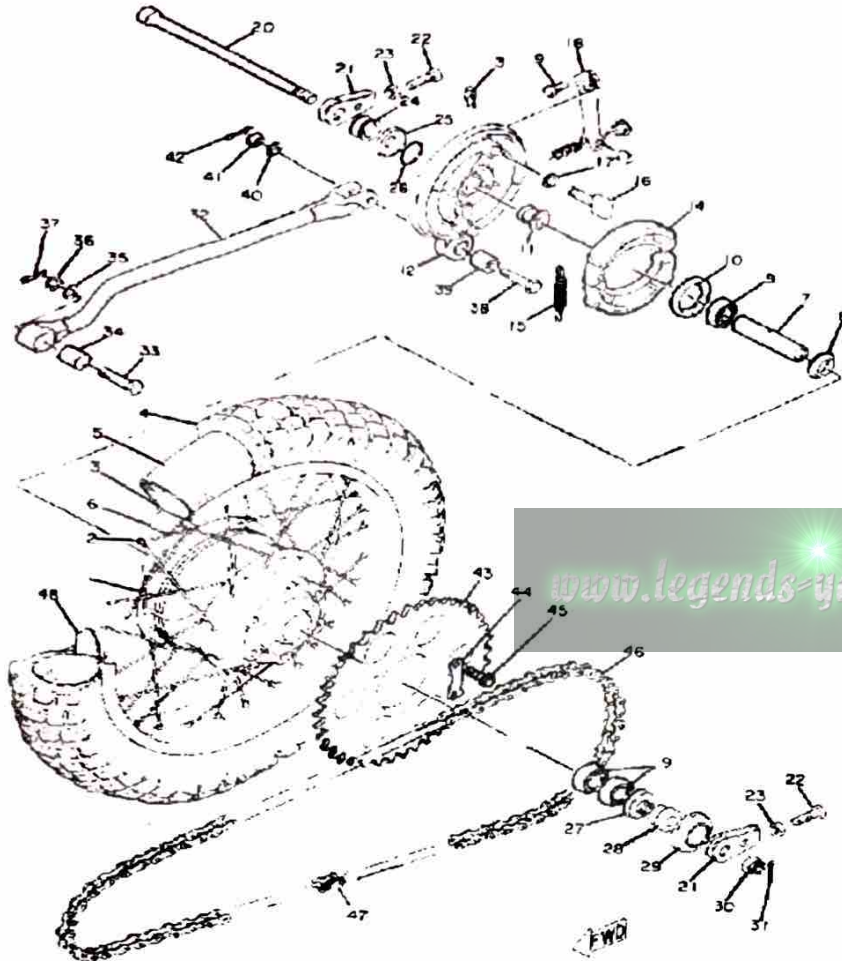

Ref. No.	Part Number	Description	Qty	Remarks
25	275-25327-00-00	COVER, PLATE	1	
26	93210-31114-00	O-RING	1	
27	93106-25003-00	OIL SEAL, DD-TYPE (DD-25-40-9)	1	
28	90387-17140-00	COLLAR (275-25377-00)	1	
29	275-25367-00-00	COVER, HUB DUST	1	
30	90171-16007-00	NUT, CASTLE (275-25382-00)	1	
31	91401-30030-00	PIN, COTTER	1	
32	(363-25371-00-00)	BAR, TENSION	1	
33	(90102-08019-00)	BOLT, WITH HOLE	1	
34	(363-22123-00-00)	BUSH 1	1	
35	92990-08100-00	WASHER	1	
36	95301-08900-00	NUT, SLOTTED (98801-08500)	1	
37	91490-20020-00	PIN, COTTER	1	
38	(90102-10007-00)	BOLT, WITH HOLE	1	
39	(275-22123-00-00)	BUSH 1	1	
40	92990-10100-00	LOCKWASHER	1	
41	95303-10700-00	NUT	1	
42	91401-25020-00	PIN, COTTER	1	
43	322-25451-00-00	SPROCKET, DRIVN 51T	1	
44	256-25412-00-00	WASHER	3	
45	94585-20106-00	520 DS 106L	6	
46	94585-20106-00	520 DS 106L	1	
47	94680-11001-00	JOINT CHAIN	1	
48	363-25394-00-00	SPACER, BEAD	2	

ELECTRICAL

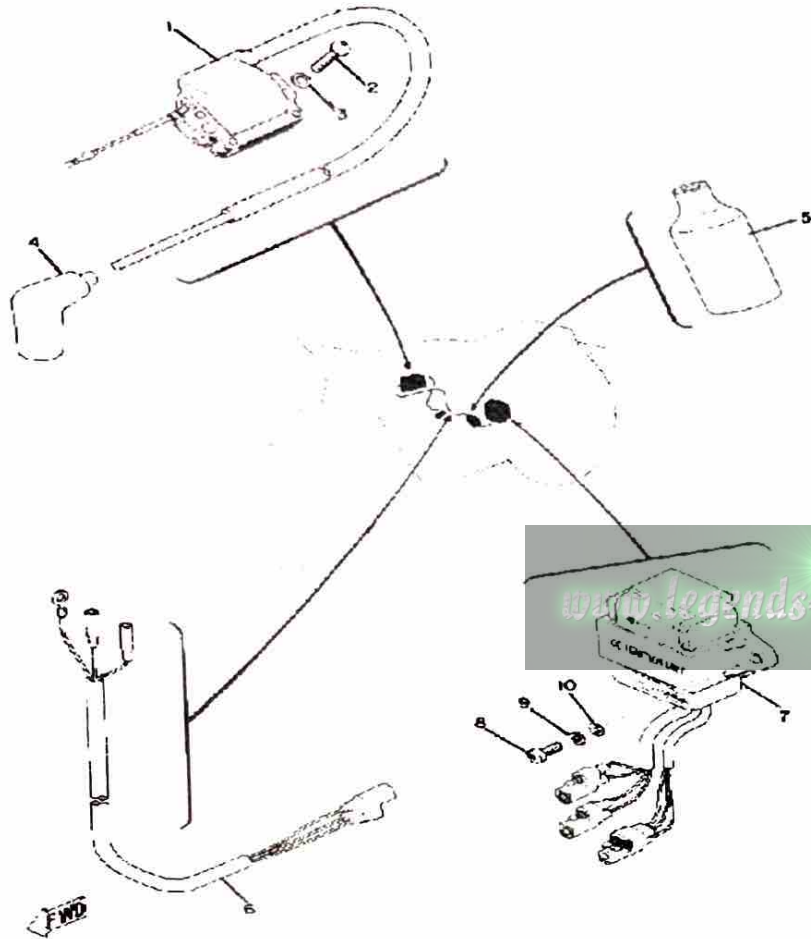

Ref. No.	Part Number	Description	Qty	Remarks
1	363-82310-10-00	IGNITION COIL ASSEMBLY	1	
2	98511-06025-00	SCREW PAN HEAD (92501-06025)	2	
3	92995-06100-00	WASHER, SPRING	2	
4	56J-82370-00-00	PLUG CAP ASSEMBLY	1	
5	(256-82599-00-00)	COVER, CONNECTER	1	
6	(363-85517-00-00)	WIRE, SUB LEAD	1	
7	363-85540-13-00	CDI UNIT ASSEMBLY	1	
	363-85540-13-00	CDI UNIT ASSEMBLY	1	M4-040M4-032
8	98580-06018-00	SCREW, PAN HEAD	2	
9	92995-06100-00	WASHER, SPRING	2	
10	90201-06M08-00	WASHER, PLATE	2	

www.legends-yamaha-enduros.com