



YAMAHA

www.legends-yamaha-enduros.com

MX80G

SUPPLEMENTARY ASSEMBLY MANUAL



FOREWORD

This Supplementary Assembly Manual for MX80G has been published to supplement the Assembly Manual for GT80E. For complete information on assembly procedure, it is necessary to use this Supplementary Assembly Manual together with the Assembly Manual for GT80E (90894-07803, LIT-11666-01-06).

NOTICE

The service specifications given in this Assembly Manual are based on the model as manufactured. If the design of this model is modified, the service specifications may be subject to change in the future.

If any significant change is introduced into the specifications or service procedure, Yamaha dealers will be notified through technical service information to be published by Yamaha.

The assembly procedure is described in the order that the mechanic should follow, and the correct service tools should be used in the correct and professional manner. For this reason, this manual is directed only to trained and experienced Yamaha service personnel. Failure to correctly assemble and service this machine could lead to damage to the machine and possible injury to its operator.

www.legends-yamaha-enduros.com
CONCERNING CRATE DAMAGE:

Follow the instructions in the Dealer Warranty Handbook, Procedure Section.

MX80G Supplementary Assembly Manual

© Yamaha Motor Corporation, U.S.A., 1979

1st. edition, June 1979

**All rights reserved. Any reprinting or
Unauthorized use without the written
permission of Yamaha Motor Corporation,
U.S.A., is expressly prohibited.**

Printed in Japan

P/N LIT-11666-01-77

Details of changes

1. The procedure for handlebar disassembly has been changed and as a result, the place where the disassembled parts are carried has been partly changed.
2. Due to change in the sequence of disassembly, the following parts, which used to be held to the frame, are now contained in a vinyl bag:

*Bolts and plate washers for front fender installation.

PARTS CHECK LIST

NOTE:

The size of bolts, nuts, washers and collars are shown below. The sizes of special parts are indicated in the respective tables.

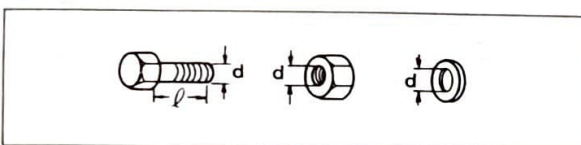

Parts List: Cardboard crate

No.	Part name	Q'ty
1	Front fender	1
2	Front wheel assembly	1

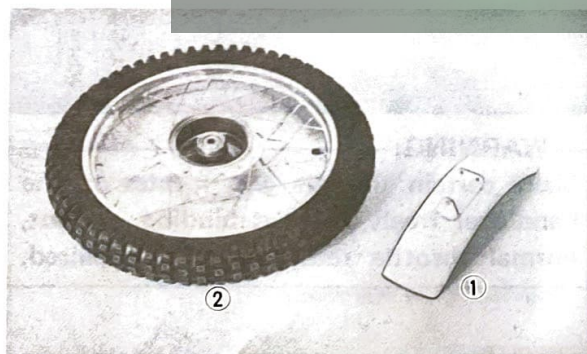

Parts List: Foam tray

No.	Part name	Q'ty
1	Owner's Service Manual	1
2	Tool kit	1
3	Kick crank	1
4	Change pedal	1
5	Brake shoe plate assembly	1
6	Handlebar assembly	1
7	Brake wire	1
8	Foot rest (Right)	1
9	Vinyl bag A	1
10	Vinyl bag B	1

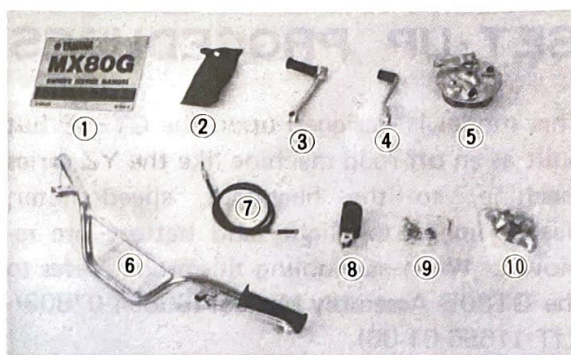

Parts List: Vinyl bag A

No.	Part name	Q'ty	Remarks
1	Bolt (d=6mm, l=20mm)	1	Change pedal
2	Nut (d=10mm)	2	Lower holder
3	Plate washer (d=10mm)	2	
4	Spring washer (d=10mm)	2	Front fender
5	Bolt (d=6mm, l=10mm)	3	
6	Plate washer (d=6mm)	3	Front axle
7	Split pin	1	
8	Split pin	1	Footrest (R)

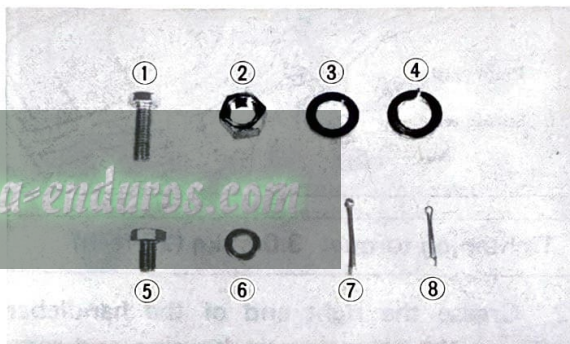

Parts List: Vinyl bag B

No.	Part name	Q'ty	Remarks
1	Collar	1	Front axle
2	Upper holder	2	Handlebar
3	Lower holder	2	
4	Bolt with washer (d=6mm, l=17mm)	4	Foot rest
5	Clevis pin	1	
6	Bolt (d=6mm, l=25mm)	1	Kick crank



SET-UP PROCEDURES

This model is designed upon the GT80E but built as an off-road machine like the YZ series machine, so the headlight, speedometer, flasher lights, tail light, and battery are removed. When assembling this model, refer to the GT80E Assembly Manual (90894-07803/-LIT-11666-01-06).

Handlebar installation has been changed as follows:

1. Install the speedometer and lower handle holder to handle crown using spring washer, plate washer and hexagon nut (M6).

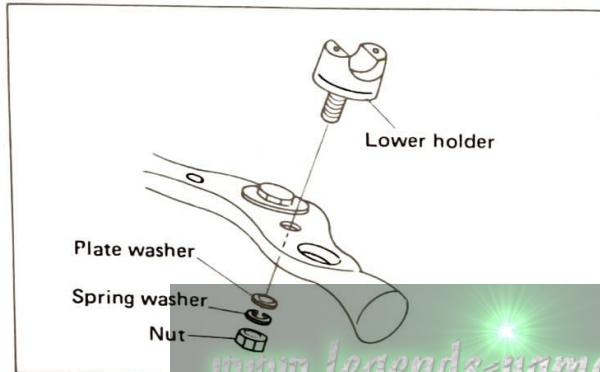

Tightening torque: 3.0 m-kG (22 ft-lb)

2. Grease the right end of the handlebar and the throttle grip housing and temporarily fit the throttle grip.

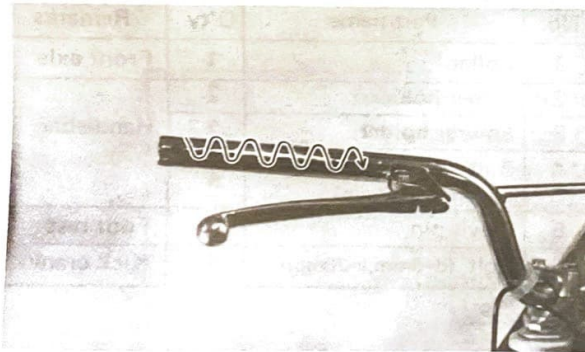

3. Install the handlebar using two upper holders, four hexagon bolts with washer.

Tightening torque: 1.0 m-kG (7 ft-lb)

CAUTION:

Tighten bolts in stages and maintain an equal gap on each side of both holders.

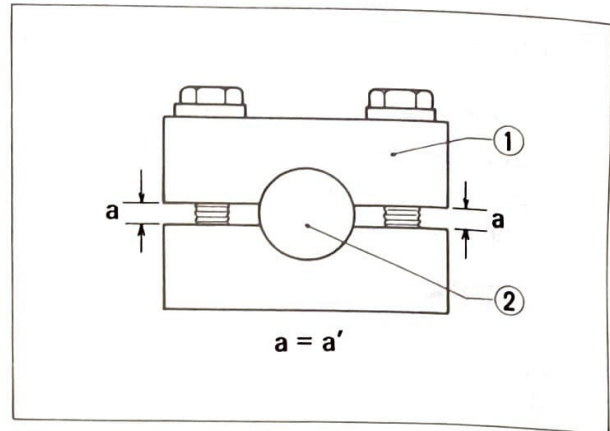

1. Holder 2. Handlebar

4. Slip the throttle grip over the handlebar to the limit and slide it back about 5 mm (0.2 in). Assemble the throttle housing using the screws provided.



WARNING:

Make certain throttle grip rotates on the handlebar freely without binding. If not, normal throttle return will be impaired.

CABLE ROUTING

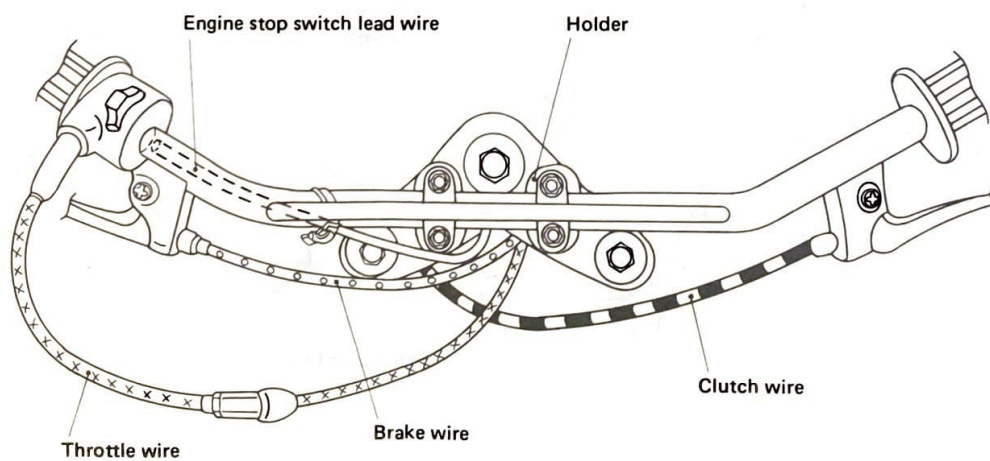
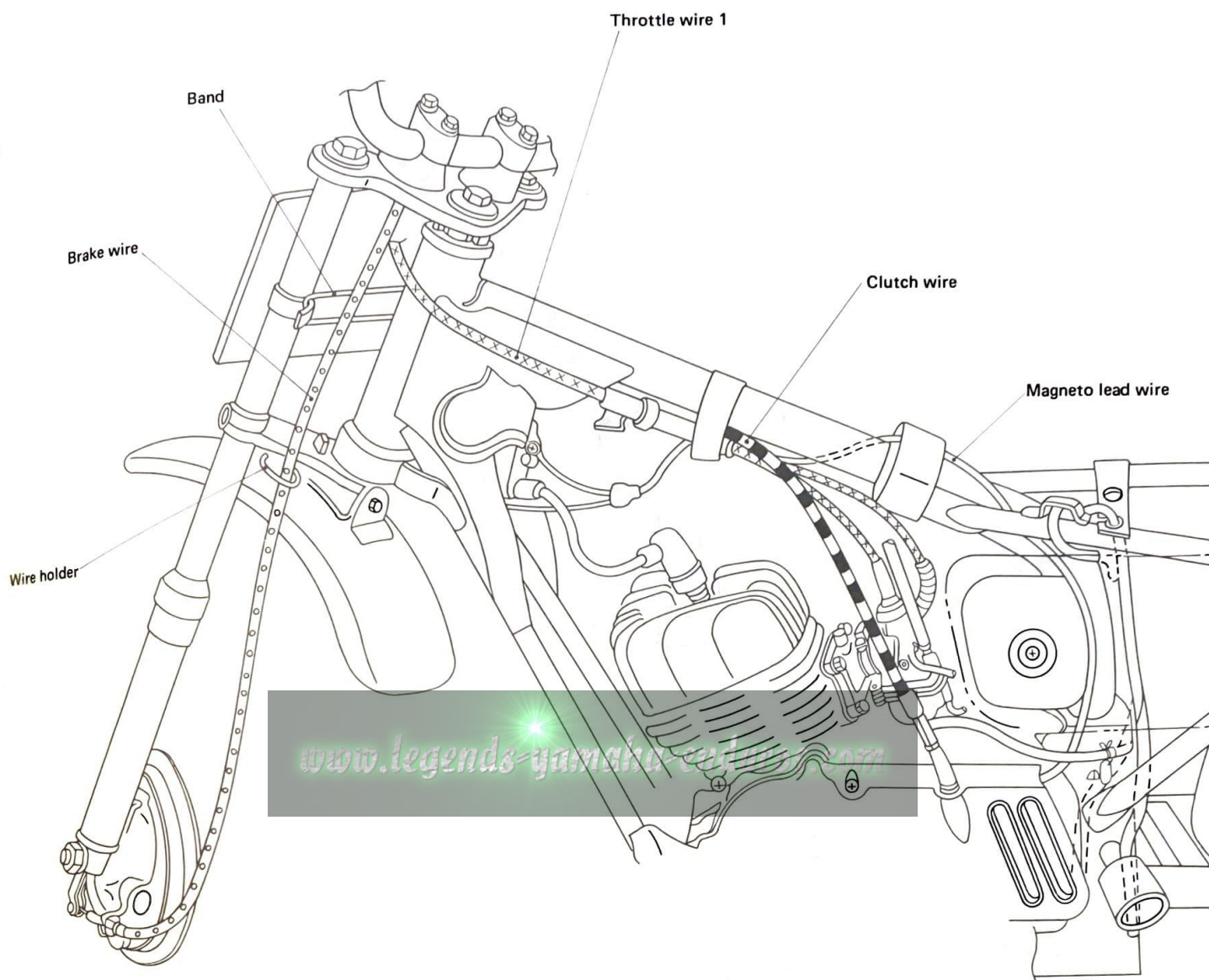

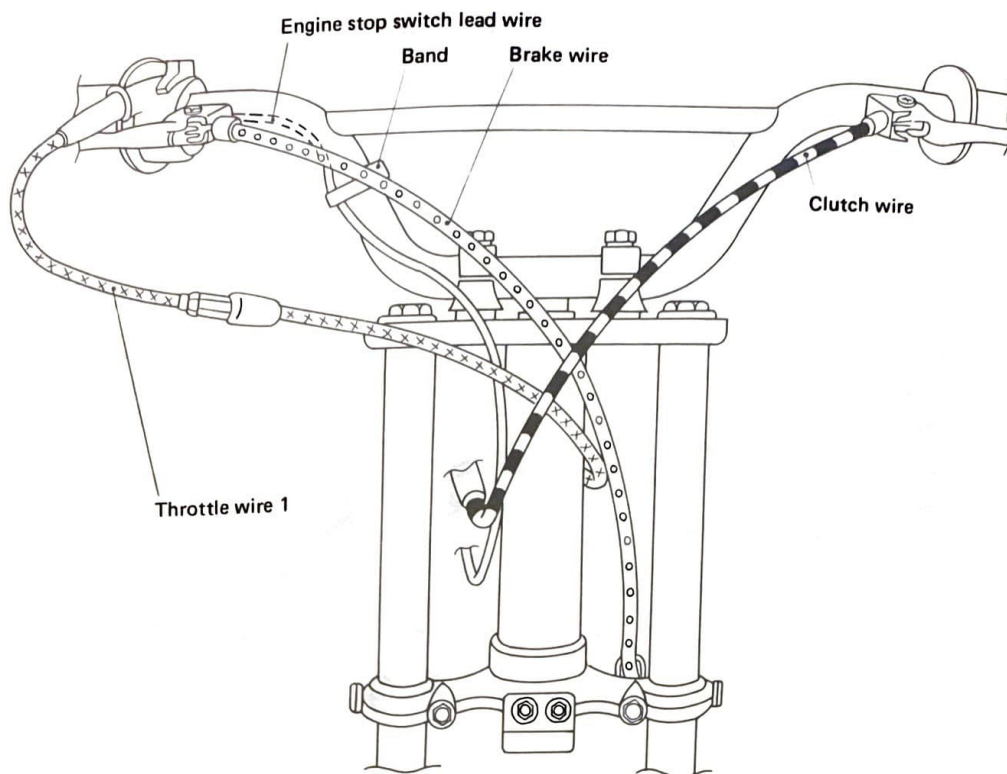

www.legends-yamaha-enduros.com

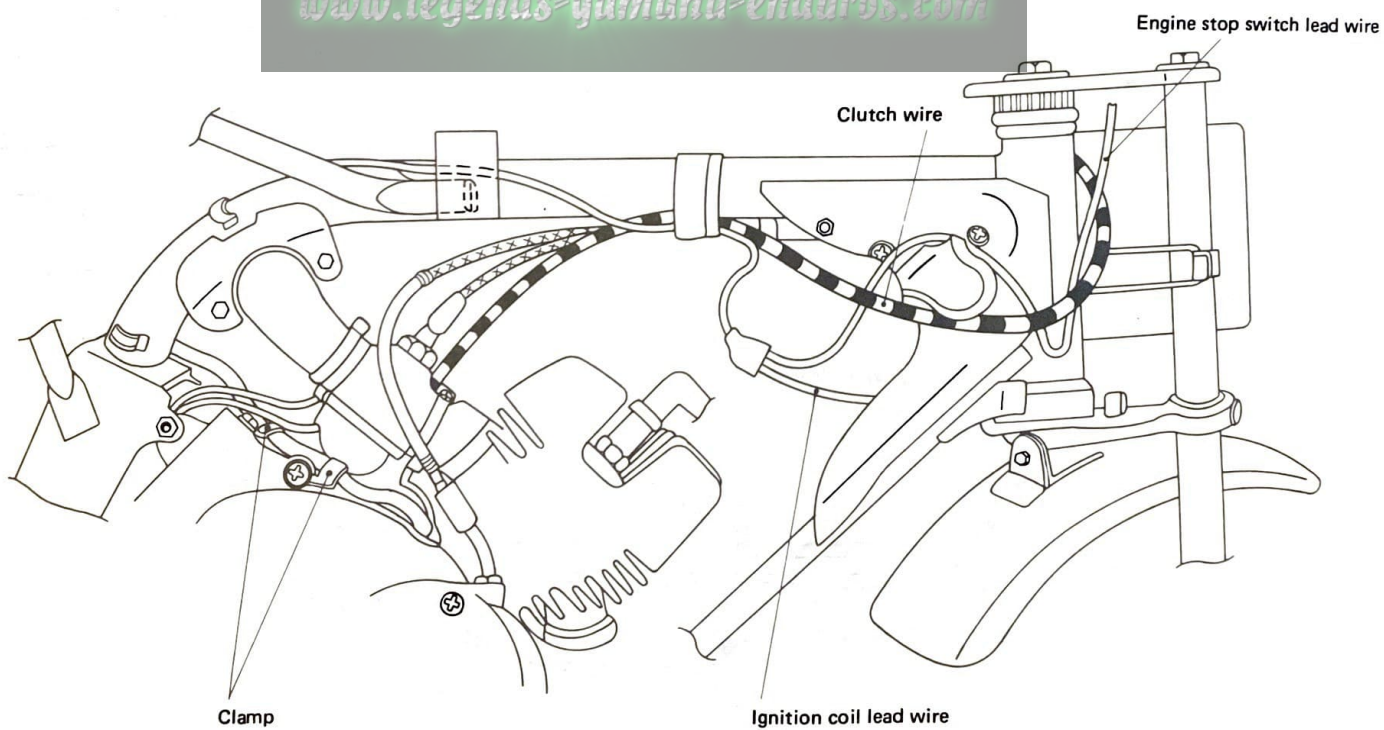

WIRING DIAGRAM

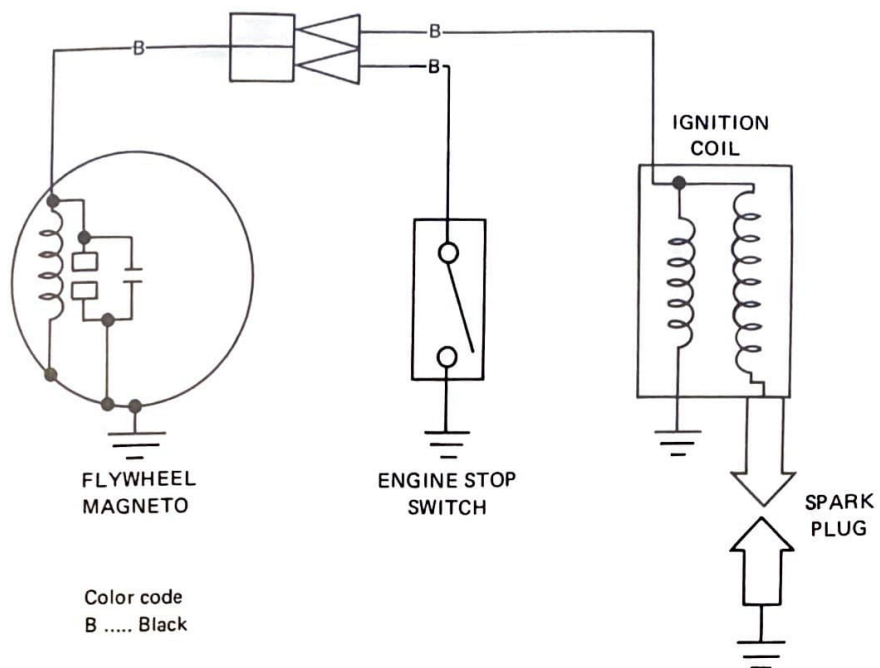

www.legends-yamaha-enduros.com

www.legends-yamaha-enduros.com



YAMAHA MOTOR CO.,LTD.

IWATA, JAPAN

PRINTED IN JAPAN
79.6 - 2.02 x 1

(英)