



YAMAHA

www.legends-yamaha-enduros.com

DT100G

SUPPLEMENTARY ASSEMBLY MANUAL



LIT-11666-01-67

90894-07906

Particularly important information is distinguished in this manual by the following notations:

- NOTE:** A NOTE provides key information to make procedures easier or clearer.
- CAUTION:** A CAUTION indicates special procedures that must be followed to avoid damage to the motorcycle.
- WARNING:** A WARNING indicates special procedures that must be followed to avoid injury to a motorcycle operator or person inspecting or repairing the motorcycle.



www.legends-yamaha-enduros.com

DT100G
SUPPLEMENTARY ASSEMBLY MANUAL
FIRST EDITION, APRIL 1979
OVERSEAS SERVICE DEPARTMENT
YAMAHA MOTOR CO., LTD.
LIT-11666-01-67

FOREWORD

This Supplementary Assembly Manual for DT100G has been published to supplement the Assembly Manual for DT100E.

For complete information on assembly procedures, it is necessary to use this Supplementary Assembly Manual together with the Assembly Manual for DT100E. Page numbers shown in brackets are identical with page numbers of the Assembly Manual for the DT100E (LIT-11666-01-02).

The Assembly Manual contains the information required to unpack and assemble Yamaha motorcycles correctly prior to delivery to the customer. Proper motorcycle set-up assembly and pre-delivery inspection demands a basic knowledge of motorcycle service procedures, familiarity with Yamaha products, and correct tools. This assembly manual should be used with the Dealer Set-up and Pre-delivery Check List, Service Manual, and Parts List for this model.

Proper set-up assembly and pre-delivery service is necessary for the following reasons:

To assure the customer of the long life and performance he expects from his new Yamaha motorcycle.

To minimize service problems during the break-in period.

To conform with federal new vehicle regulations.

NOTICE

The service specifications given in this manual are based on the model as manufactured. Modifications and significant changes in specifications and/or procedures will be forwarded to all Authorized Yamaha Dealers.

The procedures below are described in the order that the mechanic should follow. Special care should be taken to ensure that the procedures are carried out correctly and completely. Failure to do so can result in poor performance, excessive emissions, and possible harm to the motorcycle and/rider.

THE DEALER SET-UP AND PRE-DELIVERY CHECK LIST has been designed to be used with this Assembly Manual. As each procedure is satisfactorily completed, the mechanic should mark the appropriate space on the sheet. After it has been signed by the assembling mechanic, the servicing mechanic, and the customer, a copy of the Check List should be given to the customer and another copy retained in the Dealership files. If the Service Manager test rides the motorcycle before delivery, he should also sign the Check List.

CONCERNING CRATE DAMAGE:

Follow the instructions in the Dealer Warranty Handbook, Procedure Section.

www.legends-yamaha-enduros.com

(PAGE 3 ~ 4)

“PARTS CHECK LIST” section should be changed as follows.

NOTE:

The sizes of bolts, nuts, washers and collars are shown below. The sizes of special parts are indicated in the respective tables.

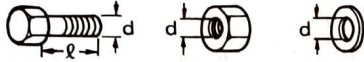

Parts List: Carton box

No.	Part name	Q'ty
1	Owner's manual	1
2	Rear view mirror	1
3	Tool kit	1
4	Tool cover	1
5	Tank breather hose	1
6	Battery breather hose	1
7	Wire holder	1
8	Front flasher stay (R and L)	2
9	Rear flasher stay (R and L)	2
10	Tool band	1
11	Vinyl bag "A"	1

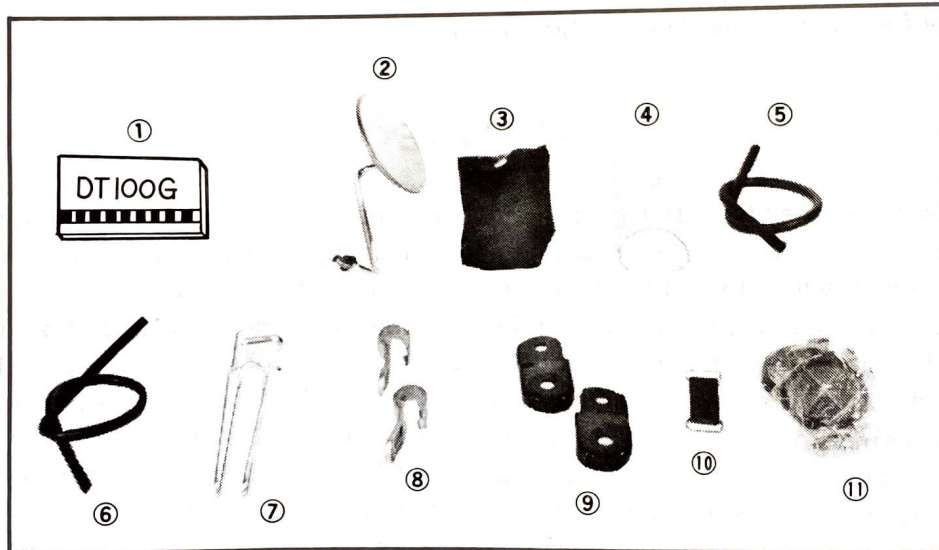

Parts List: Vinyl bag "A"

No.	Part name	Q'ty	Remarks
1	Front reflector	2	Reflector
2	Rear reflector	1	
3	Spring washer (d = 5 mm (0.20 in))	3	
4	Plate washer (d = 5 mm (0.20 in))	3	
5	Nut (d = 5 mm (0.20 in))	1	Taillight
6	Bolt (d = 6 mm (0.24 in), ℓ = 14 mm (0.55 in))	3	
7	Spring washer (d = 6 mm (0.24 in))	3	
8	Nut (d = 6 mm (0.24 in))	1	
9	Crown nut (d = 8 mm (0.31 in))	2	Front flasher
10	Nut (d = 8 mm (0.31 in))	2	
11	Bolt (d = 8 mm (0.31 in), ℓ = 20 mm (0.79 in))	2	
12	Nut (d = 10 mm (0.39 in))	2	Rear flasher
13	Spring washer (d = 10 mm (0.39 in))	2	
14	Cotter pin	1	Front wheel
15	Bolt with spring washer (d = 6 mm (0.24 in), ℓ = 16 mm (0.63 in))	2	Licence bracket

No.	Part name	Q'ty	Remarks
16	Plate washer (d = 6 mm (0.24 in))	2	Licence bracket
17	Nut (d = 6 mm (0.24 in))	2	
18	Spring washer (d = 6 mm (0.24 in))	2	Wire holder
19	Bolt with spring washer (d = 6 mm (0.24 in), ℓ = 12 mm (0.47 in))	2	
20	Clip	2	Tank breather hose
21	Plate washer (d = 6 mm (0.24 in))	4	Front fender
22	Bolt with spring washer (d = 6 mm (0.24 in), ℓ = 14 mm (0.55 in))	4	
23	Nut (d = 6 mm (0.24 in))	4	
24	Stopper	1	Seat
25	Bolt with spring washer (d = 6 mm (0.24 in), ℓ = 12 mm (0.47 in))	1	
26	Clevis pin	1	Footrest
27	Bolt with spring washer (d = 8 mm (0.31 in), ℓ = 20 mm (0.79 in))	2	
28	Bolt with spring washer (d = 8 mm (0.31 in), ℓ = 16 mm (0.63 in))	2	

www.legends-yamaha-enduros.com

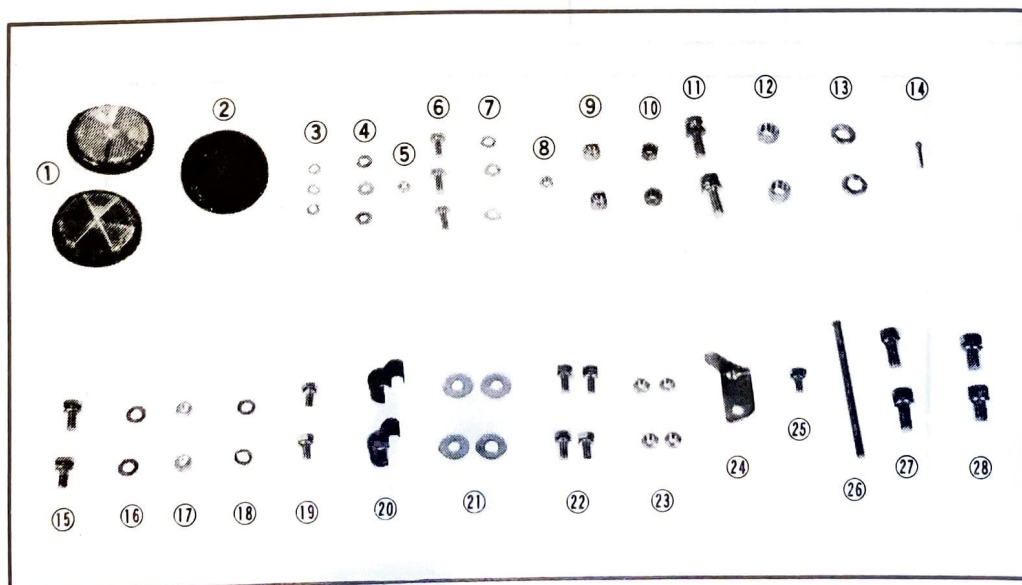

Parts List: Foam tray

No.	Part name	Q'ty
1	Handlebar assembly	1
2	Speedometer cable assembly	1
3	Front brake cable assembly	1
4	Front brake shoe plate assembly	1
5	Change pedal	1
6	Speedometer assembly	1

No.	Part name	Q'ty
7	Front flasher light (R)	1
8	Front flasher light (L)	1
9	Rear flasher light (R and L)	2
10	Taillight assembly	1
11	Licence bracket	1
12	Vinyl bag "B"	1

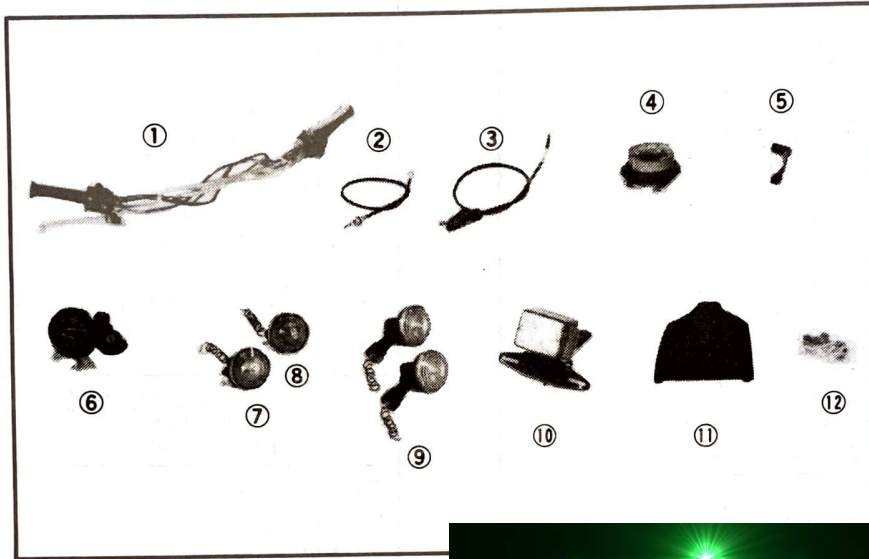

Parts List: Vinyl bag "B"

No.	Part name	Q'ty	Remarks
1	Bolt (d = 6 mm (0.24 in), ℓ = 20 mm (0.79 in))	1	Change pedal
2	Handle upper holder	2	Handlebar
3	Flange bolt (d = 8 mm (0.31 in), ℓ = 35 mm (1.38 in))	4	

No.	Part name	Q'ty	Remarks
4	Hub dust cover	1	Front wheel
5	Bolt with spring washer (d = 6 mm (0.24 in), ℓ = 10 mm (0.39 in))	2	Speedometer

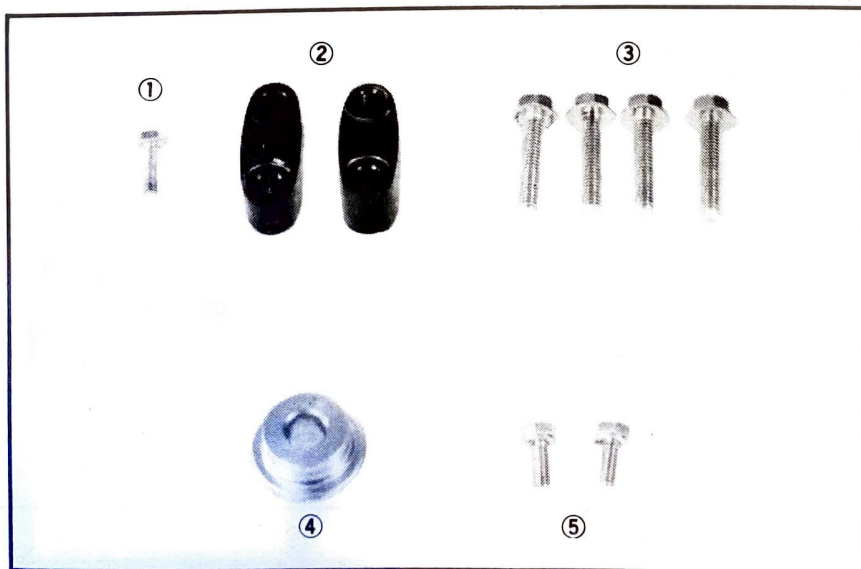

SET-UP PROCEDURES

(PAGE 9)

“Handlebar installation” section should be changed as follows.

14. Handlebar installation

- a. Insert the lead wire coming from the handlebar switch into the headlight body.
- b. Install the handlebar using the two handle upper holders and four flange bolts.

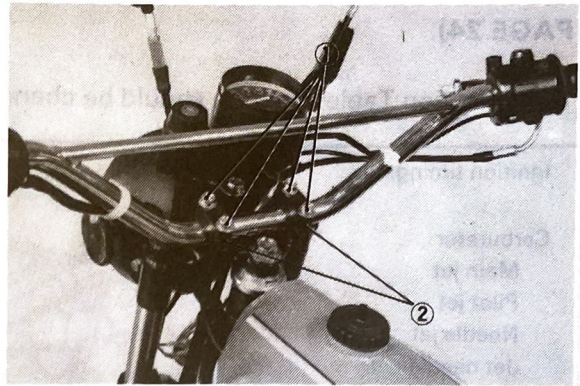

1. Flange bolt 2. Handle upper holder

ADJUSTMENTS — Pre-delivery Service

(PAGE 16)

“Drive chain adjustment” section should be changed as follows.

To check the chain play, the motorcycle must stand vertically with its both wheels on the ground and without passenger on it.

Then measure the play at the bottom of the chain at a point midway between the drive and driven sprockets.

The normal vertical deflection is approximately 20 ~ 30 mm (0.8 ~ 1.2 in). If the chain deflection is not as specified, adjust the chain tension.

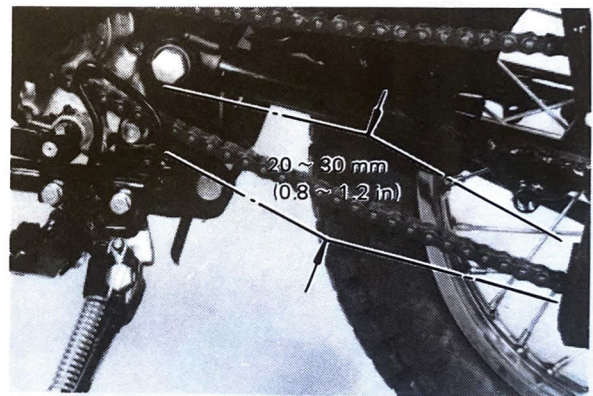

(PAGE 21)

Ignition timing

On the G model (3A3), the Condenser discharge Ignition (CDI) system has been employed in place of the conventional contact breaker ignition system and as a result, no ignition timing adjustment is necessary.

www.legends-yamaha-enduros.com

(PAGE 24)

“Specification Table” section should be change as follows.

Ignition timing:	21° B.T.D.C./2,000 r/min [1.8 ± 0.15 mm (0.07 ± 0.006 in)]
Carburetor:	
Main jet	#130
Pilot jet	#15
Needle jet	0-6
Jet needle	4L17
Throttle valve cut away	2.0
Idling engine speed	1,300 ~ 1,450 r/min
Fuel tank capacity:	4.5 lit. (1.2 US gal.)
Oil tank capacity:	1.0 lit. (1.1 US qt.)



CABLE ROUTING

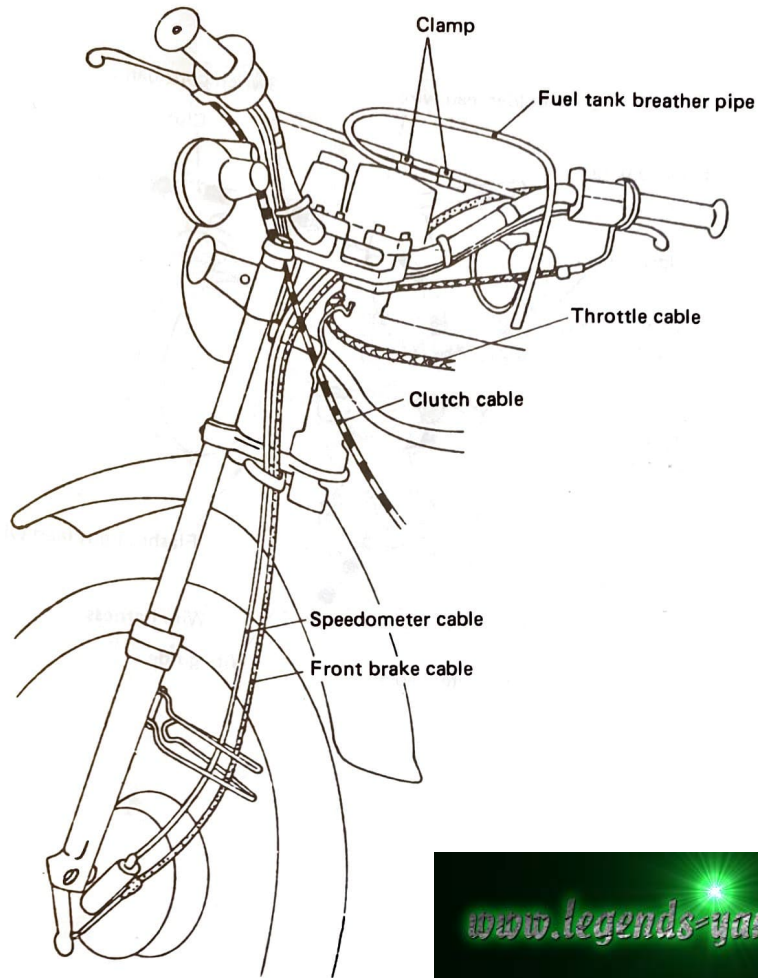

www.legends-yamaha-enduros.com

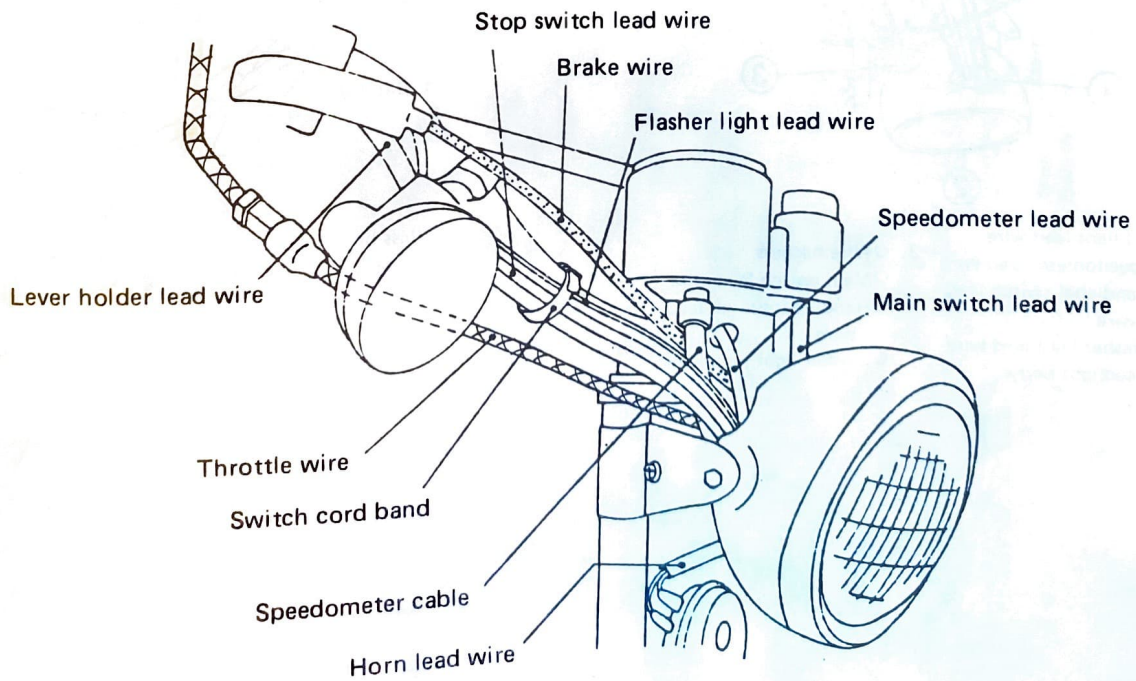

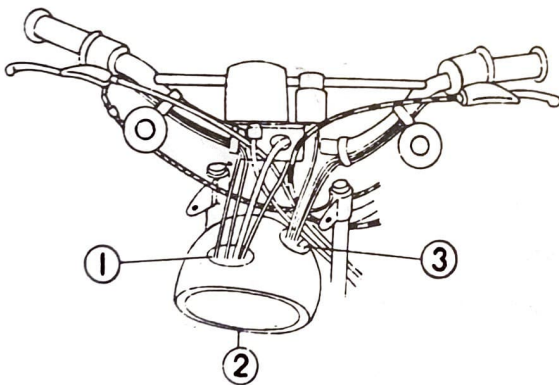
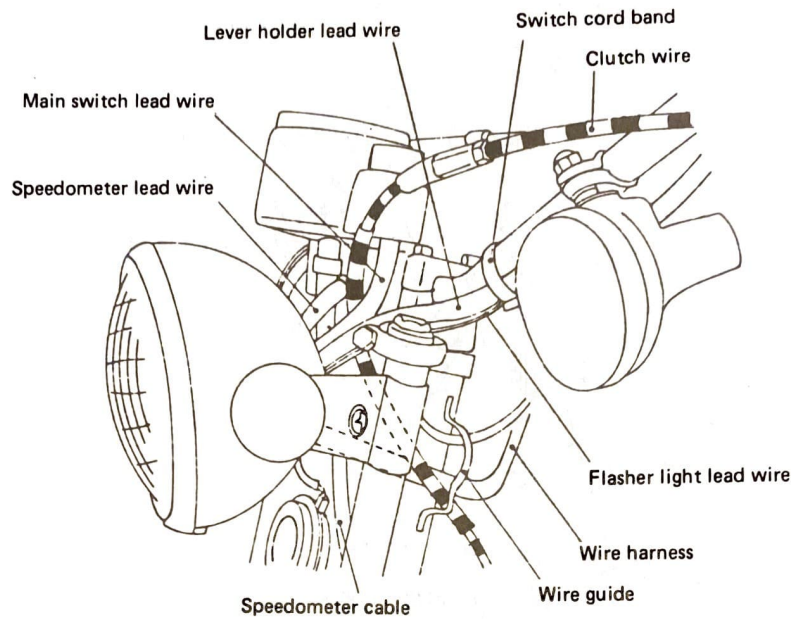

- 1. ○ Oil light lead wire
- Speedometer lead wire
- Handlebar switch lead wire
- Flasher light lead wire
- 2. ○ Headlight body
- 3. ○ Wire harness
- Main switch lead wire
- Handlebar switch lead wire
- Flasher light lead wire

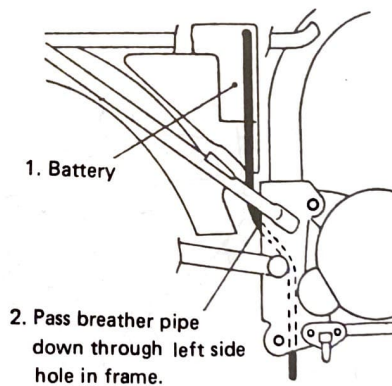

WIRING DIAGRAM

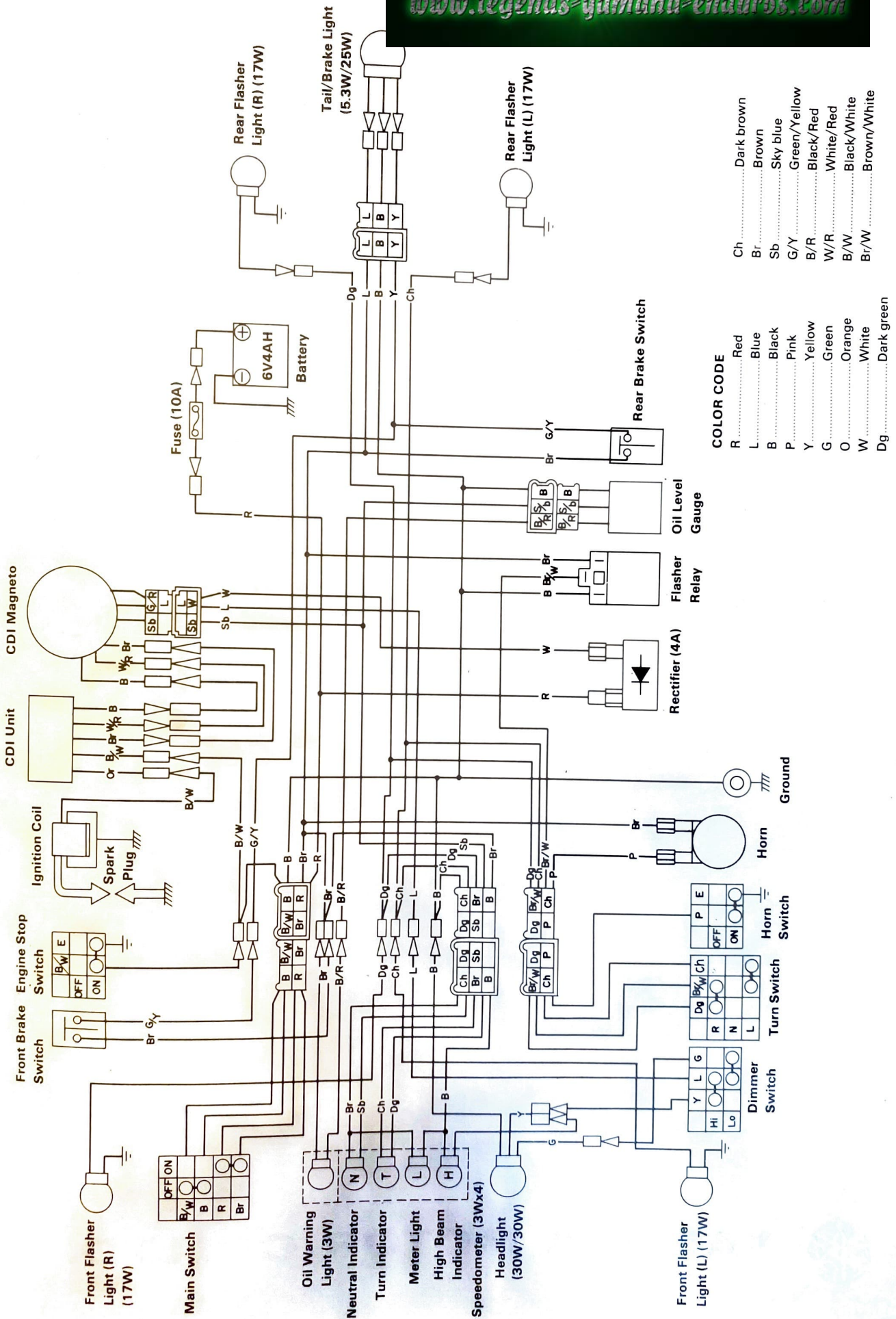

COLOR CODE

R	Red	Ch	Dark brown
L	Blue	Br	Brown
B	Black	Sb	Sky blue
P	Pink	G/Y	Green/Yellow
Y	Yellow	B/R	Black/Red
G	Green	W/R	White/Red
O	Orange	B/W	Black/White
W	White	Br/W	Brown/White
Dg	Dark green			

www.legends-yamaha-enduros.com



YAMAHA MOTOR CO., LTD.

IWATA, JAPAN

PRINTED IN JAPAN
79・4・2.02 x 1 CR
(英)