



YAMAHA

GENUINE

PARTS CATALOGUE

MOTORCYCLE

www.legends-yamaha-enduros.com

CRANKCASE-CYLINDER

Initial Engine Number/Frame Number	3M2-000101 / 3M2-000101
Bore/Stroke/Number Cylinders/Displacement (cc)	66mm / 50mm / 1 / 171cc
Compression Ratio/Compression Pressure min ~ max	6.8 1 / ϕ

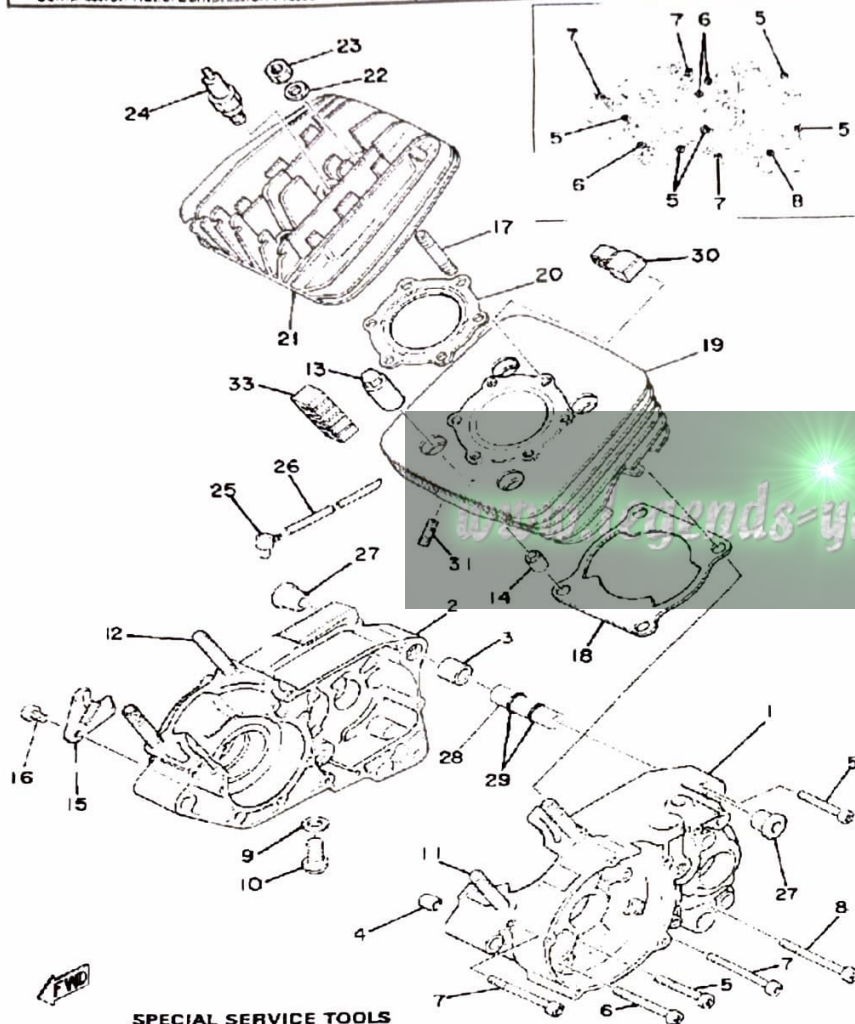

SPECIAL SERVICE TOOLS
90890-01135-00 CRANKCASE SEPARATOR

Ref. No.	Part Number	Description	Qty	Remarks
1	3M2-15111-00-00	CRANKCASE 1	1	
2	2A6-15121-01-00	CRANKCASE 2	1	
3	99510-20020-00	PIN, DOWEL	1	
4	99530-10014-00	PIN, DOWEL	1	
5	98580-06550-00	SCREW PAN HEAD (92503-06050)	5	
6	92580-06560-00	SCREW PAN HEAD	3	
7	98501-06070-00	SCREW, PAN HEAD	3	
8	98501-06075-00	SCREW, PAN HEAD	1	
9	90430-12207-00	GASKET	1	
10	90340-12005-00	PLUG, DRAIN	1	
11	95611-10630-00	BOLT, STUD	2	
12	95611-10640-00	BOLT, STUD	2	
13	90179-10201-00	NUT	4	
14	99530-14016-00	PIN, DOWEL	2	
15	304-15128-00-00	HOLDER	1	
16	92501-08010-00	SCREW, PAN HEAD	1	
17	90116-08104-00	BOLT, STUD	6	
18	18G-11351-01-00	GASKET, CYLINDER	1	
19	2A7-11311-00-00	CYLINDER 1	1	
20	1W2-11181-00-00	GASKET, CYLINDER HEAD 1	1	
21	2A7-11111-00-00	HEAD, CYLINDER 1	1	
22	90201-08100-00	WASHER, PLATE	6	
23	95333-08600-00	NUT	6	
24	NGK-B8ES0-00-00	PLUG, SPARK (NGK B8ES)	1	
25	2N4-15371-00-00	BREATHER	1	
26	90445-07340-00	HOSE	1	
27	328-15316-00-00	DAMPER, ENG MOUNT 1 (328-15316-00)	2	

CONTINUED ON NEXT FRAME ►

CRANKCASE COVER

Ref. No.	Part Number	Description	Qty	Remarks
1	1W1-15411-00-00	COVER, CRANKCASE L	1	
2	1W1-15421-01-00	COVER, CRANKCASE R	1	
3	1W1-15455-00-00	GASKET 1	1	
4	98511-06025-00	SCREW PAN HEAD (92501-06025)	7	
5	2A6-15484-01-00	CLAMP 2	1	
6	2A6-15431-00-00	COVER, CRANKCASE 3	1	
7	18G-15451-01-00	GASKET, CRCS. COVER	1	
8	99530-10014-00	PIN, DOWEL	2	
9	98580-06030-00	SCREW PAN HEAD	3	
10	98580-06040-00	SCREW, pan head (92501-06040-00)	6	
11	2A6-15416-00-00	COVER, OIL PUMP	1	
12	2A6-15456-00-00	GASKET, O/PMP CVR 1	1	
13	98511-06025-00	SCREW PAN HEAD (92501-06025)	4	
14	18G-15362-00-00	PLUG, OIL LEVEL	1	
15	93210-21190-00	O-RING	1	
16	90338-19078-00	PLUG	1	
17	92601-06030-00	SCREW, OVAL HEAD	1	

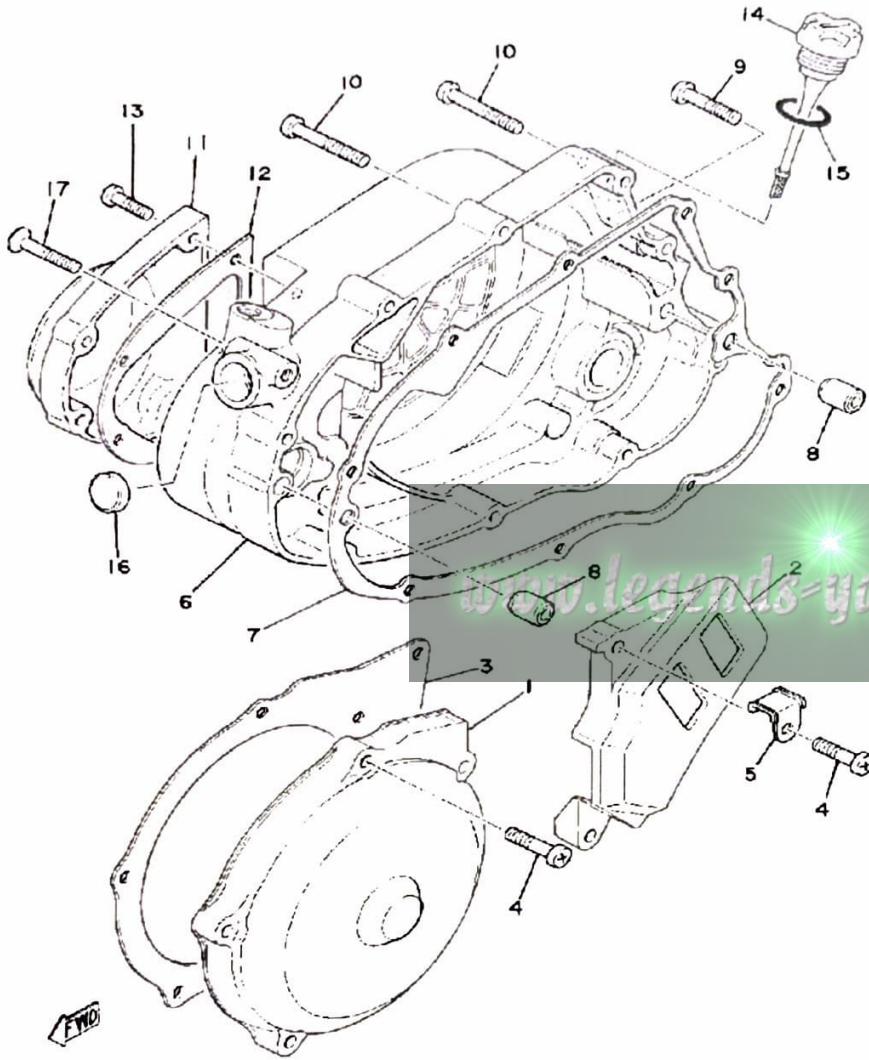

CRANK-PISTON

Piston Skirt Clearance new/max	0.040 ~ 0.045mm / 0.1mm
Ring End Gap top/2nd/3rd	0.3 ~ 0.5mm / 0.3 ~ 0.5mm / φ

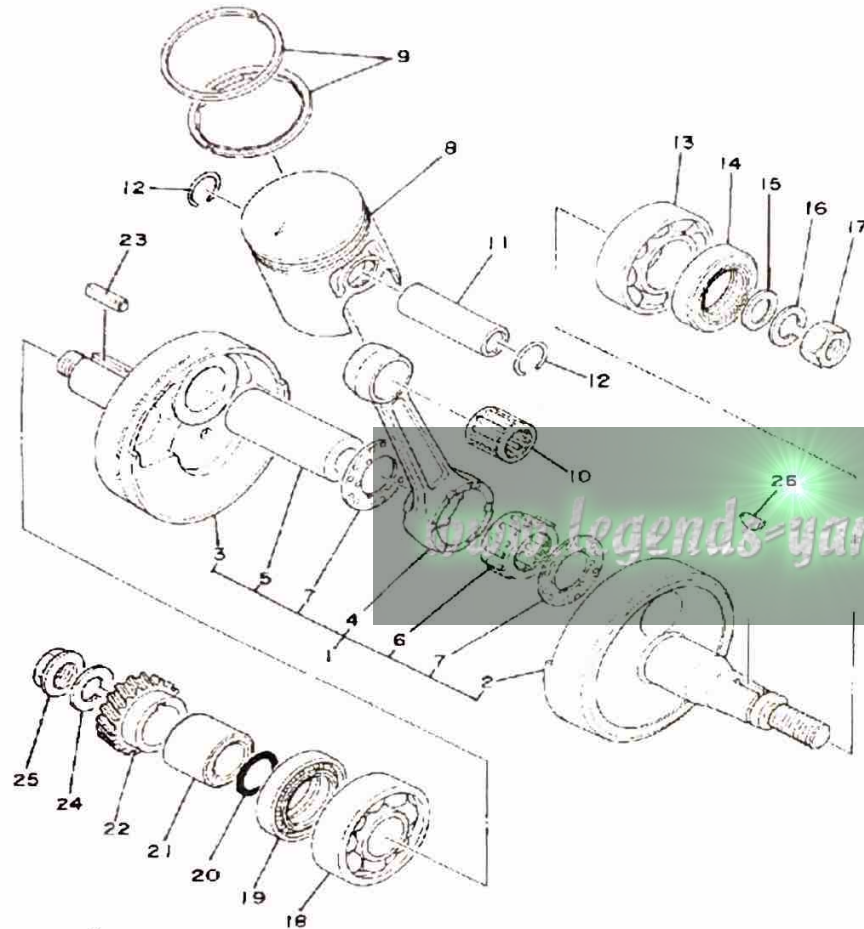

SPECIAL SERVICE TOOLS
TLU-90900-57-01 CRANKSHAFT INSTALLING SET

Ref. No.	Part Number	Description	Qty	Remarks
1	2N4-11400-00-00	CRANKSHAFT ASSEMBLY	1	
2	1W1-11412-01-00	CRANK 1	1	
3	1W1-11422-01-00	CRANK 2	1	
4	25V-11651-00-00	ROD, CONNECTING 1	1	
5	3M5-11681-00-00	PIN, CRANK 1	1	
6	93310-42277-00	BEARING, CYLINDER.#10 (93310-42231)	1	
7	90209-22248-00	WASHER	2	
8	2N5-11631-00-96	PISTON STD (2A7-11631-00-96)	1	
	2N5-11635-00-00	PISTON 1 O/S 0.25 (2A7-11635-00)	1	ALTERNATE PARTS
	2N5-11636-00-00	PISTON 2 O/S 0.50 (2A7-11636-00)	1	ALTERNATE PARTS
	2N5-11637-00-00	PISTON 3 O/S 0.75 (2A7-11637-00)	1	ALTERNATE PARTS
	2N5-11638-00-00	PISTON 4 O/S 1.00 (2A7-11638-00)	1	ALTERNATE PARTS
9	2N5-11610-00-00	PISTON RINGSET STD	1	
	2N5-11610-10-00	PISTON RINGSET 1ST	1	ALTERNATE PARTS
	2N5-11610-20-00	PISTON RINGSET 2ND	1	ALTERNATE PARTS
	2N5-11610-30-00	PISTON RINGSET 3RD	1	ALTERNATE PARTS
	2N5-11610-40-00	PISTON RINGSET 4TH	1	ALTERNATE PARTS
10	93310-216E1-00	BEARING	1	
11	251-11633-00-00	PIN, PISTON	1	
12	93450-17044-00	CIRCLIP	2	
13	93306-20529-00	BEARING (B6205C4)	1	
14	93102-25061-00	OIL SEAL, SD-TYPE	1	
15	90201-12593-00	WASHER, PLATE	1	
16	92901-12100-00	WASHER, SPRING	1	
17	90170-12347-00	NUT, HEXAGON	1	

CONTINUED ON NEXT FRAME ►

Piston Skirt Clearance new/max.	0.040 ~ 0.045mm / Ø 1mm
Ring End Gap top/2nd/3rd	0.3 ~ 0.5mm / 0.3 ~ 0.5mm / φ

CRANK-PISTON

Ref. No.	Part Number	Description	Qty	Remarks
18	93306-30421-00	BEARING (B6304C3)	1	
19	93103-28011-00	OIL SEAL	1	
20	93210-180A6-00	O-RING	1	
21	90387-20488-00	COLLAR	1	
22	1W1-16111-00-00	GEAR, PRI DRIVE	1	
23	90282-05005-00	KEY, STRAIGHT	1	
24	90204-12007-00	WASHER, SPRING	1	
25	90179-12244-00	NUT, SPEC'L SHAPE	1	
26	90280-03017-00	KEY, WOODRUFF	1	

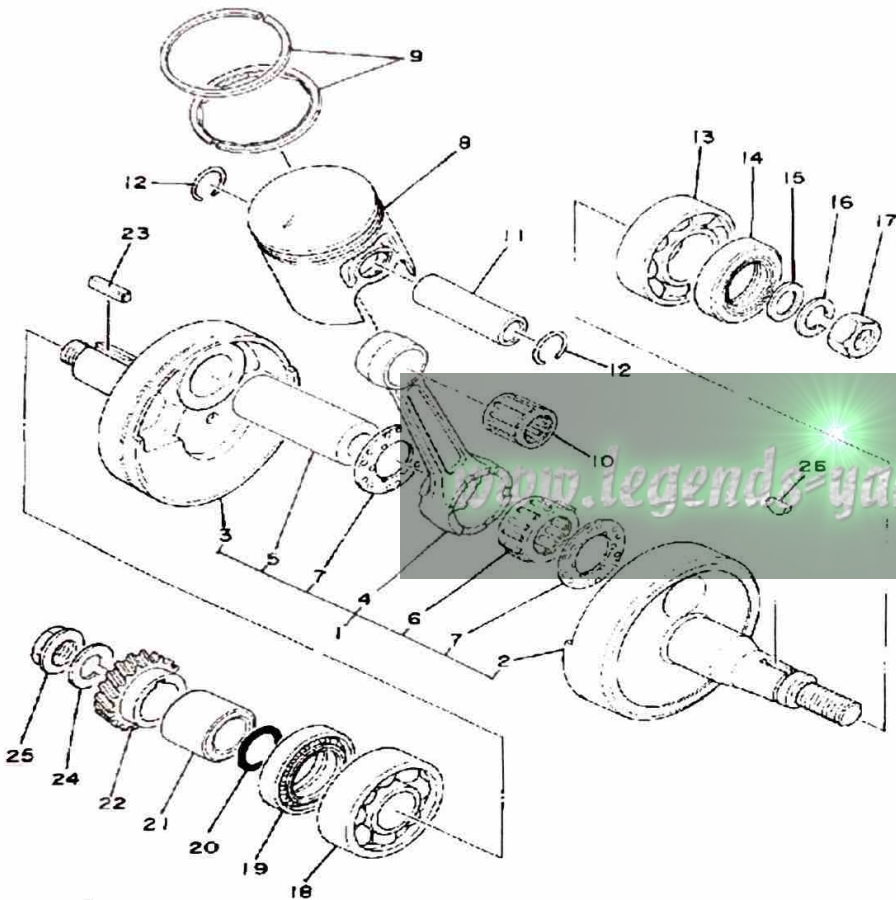

SPECIAL SERVICE TOOLS
TLU-90900-57-01 CRANKSHAFT INSTALLING SET

CLUTCH

Clutch Friction Plate Thickness Std ~ min	3.0 ~ 2.8mm
Clutch Spring Length Std ~ min	33.0 ~ 32.0mm

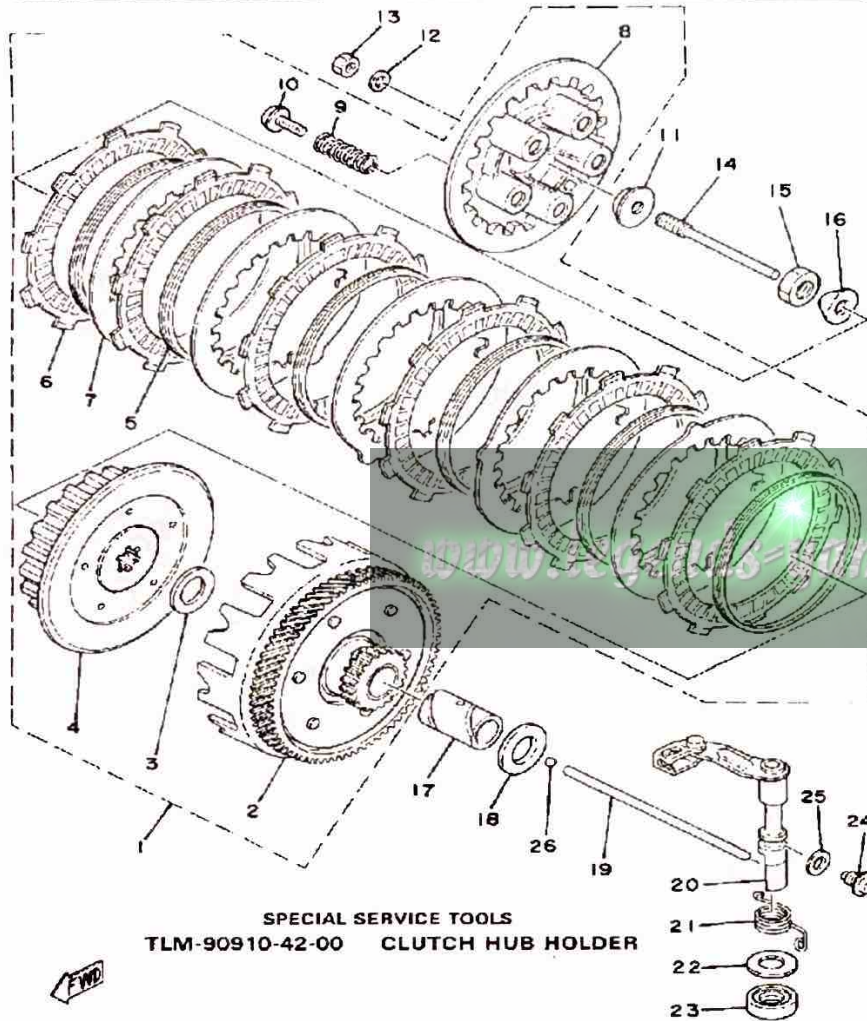

Ref. No.	Part Number	Description	Qty	Remarks
1	3J1-16300-00-00	CLUTCH ASSEMBLY	1	
		CLUTCH ASSEMBLY (2A7-16301-00)	1	
2	2A7-16150-00-00	. PRI DRVN GEAR COMP. (71T)	1	
3	90201-17543-00	. WASHER, PLATE	1	
4	1G8-16371-00-00	. BOSS, CLUTCH	1	
5	307-16367-00-00	. RING, CUSHION	6	
6	559-16321-01-00	. PLATE, FRICTION	6	
7	2A6-16324-00-00	. PLATE, CLUTCH 1	5	
8	1W1-16351-00-00	. PLATE, PRESSURE 1	1	
9	90501-20474-00	. SPRING, COMPRESSION	5	
10	90159-05011-00	. SCREW, WITH WASHER	5	
11	30X-16358-00-00	PLATE, PUSH	1	
12	92990-06200-00	WASHER	1	
13	95380-06600-00	NUT	1	
14	1W1-16356-02-00	ROD, PUSH 1	1	
15	90170-14171-00	NUT	1	
16	90215-14204-00	WASHER, LOCK	1	
17	90560-17147-00	SPACER	1	
18	90201-174E1-00	WASHER, PLATE	1	
19	1W1-16357-00-00	ROD, PUSH 2	1	
20	(1W1-16380-00-00)	PUSH LEVER ASSEMBLY	1	
21	90508-20345-00	SPRING, TORSION	1	
22	90201-14217-00	WASHER, PLATE	1	
23	93104-14059-00	OIL SEAL, SO-TYPE	1	
24	90149-08108-00	SCREW, SPEC'L SHAPE	1	
25	90430-08069-00	GASKET	1	
26	93503-16010-00	BALL	1	

TRANSMISSION

Ref. No.	Part Number	Description	Qty	Remarks
1	2A6-17411-00-00	AXLE, MAIN	1	
2	1W2-17151-00-00	GEAR, 5TH PINION	1	
3	90201-20266-00	WASHER, PLATE (1.0T)	2	
4	93410-20038-00	CIRCLIP	3	
5	2A6-17131-00-00	GEAR, 3RD PINION	1	
6	1W2-17161-00-00	GEAR, 6TH PINION	1	
7	2A6-17121-00-00	GEAR, 2ND PINION	1	
8	90201-15701-00	WASHER, PLATE (1.0T)	1	
9	93311-41530-00	BEARING	1	
10	93306-30309-00	BEARING	1	
11	1W1-17471-01-00	PLATE, COVER	1	
12	97013-06012-00	BOLT	2	
13	2A6-17421-00-00	AXLE, DRIVE	1	
14	2A6-17221-01-00	GEAR, 2ND WHEEL (2A6-17221-00)	1	
15	90201-22555-00	WASHER, PLATE	1	
16	93410-22039-00	CIRCLIP	4	
17	2A6-17261-00-00	GEAR, 6TH WHEEL	1	
18	90209-18135-00	WASHER	2	
19	1W2-17241-00-00	GEAR, 4TH WHEEL	1	
20	2A6-17231-00-00	GEAR, 3RD WHEEL	1	
21	2A6-17251-00-00	GEAR, 5TH WHEEL	1	
22	2A6-17211-01-00	GEAR, 1ST WHEEL (2A6-17211-00)	1	
23	90201-15701-00	WASHER, PLATE (1.0T)	1	
24	93440-15012-00	CIRCLIP	1	
25	93311-31567-00	BEARING, CYLINDRICAL	1	
26	525-15651-00-00	GEAR, KICK IDLE (25T)	1	
27	137-17417-00-05	SHIM 1 (0.5T)	2	

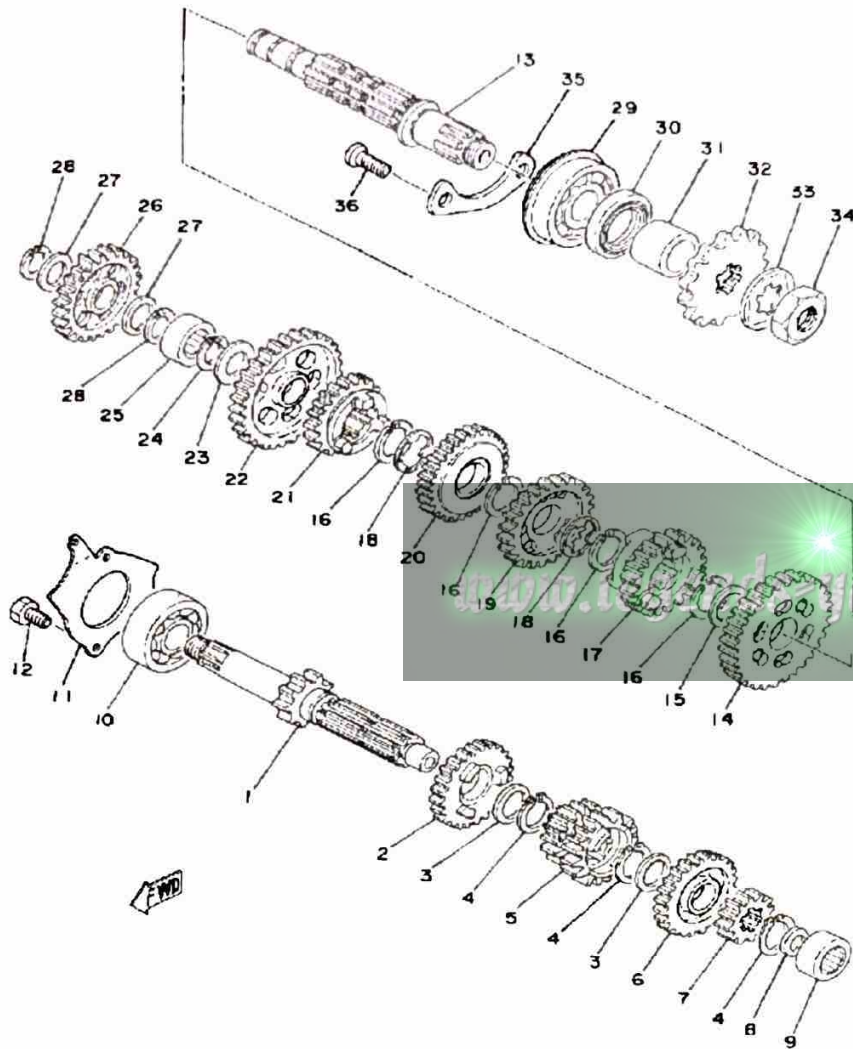

CONTINUED ON NEXT FRAME ►

TRANSMISSION

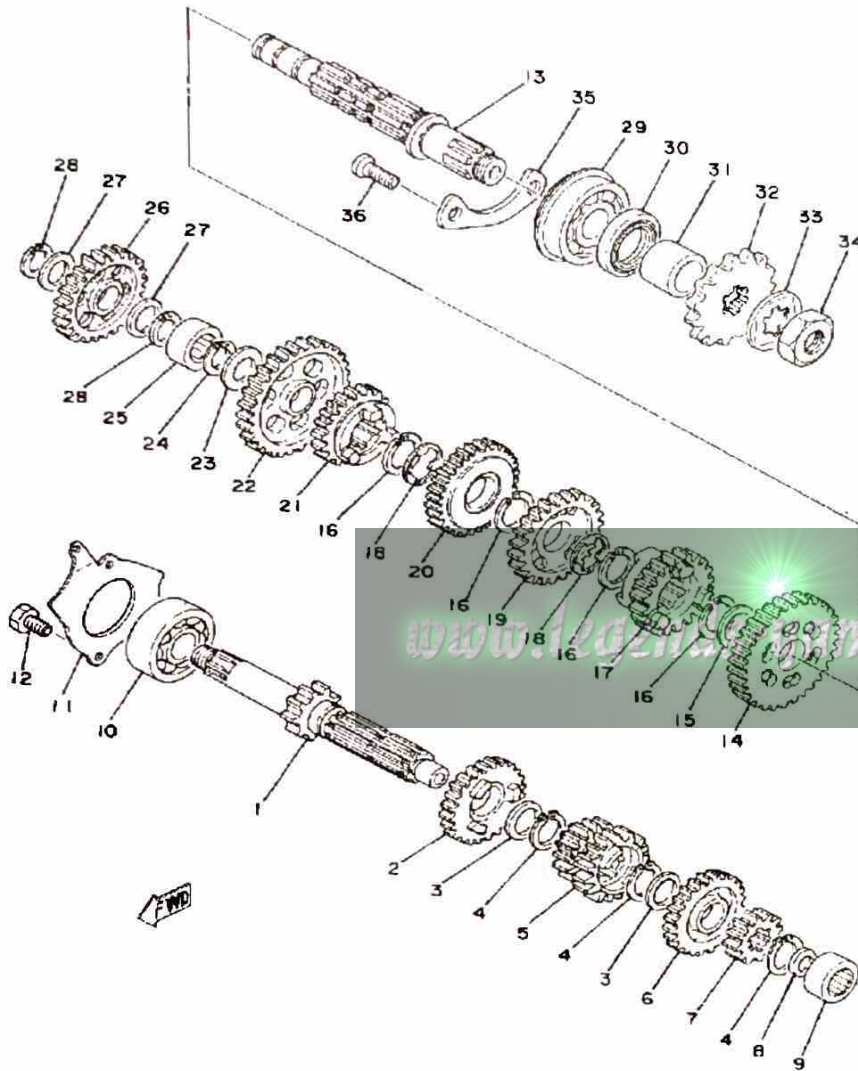

Ref. No.	Part Number	Description	Qty	Remarks
28	93440-15012-00	CIRCLIP	2	
29	93306-30411-00	BEARING (B6304)	1	
30	93102-26042-00	OIL SEAL	1	
31	90387-202A0-00	COLLAR	1	
32	93822-14037-00	SPROCKET, DRIVE 14T (1741746140)	1	
	93822-15065-00	SPROCKET, DRIVE 15T (1741746150)	1	STD
	93822-16093-00	SPROCKET, DRIVE		
33	90215-16127-00	WASHER, LOCK	1	
34	90179-16226-00	NUT	1	
35	1W1-15381-00-00	PLATE, BRNG COVER	1	
36	98603-06012-00	SCREW, OVAL HEAD (92701-06012)	2	

SHIFTER 1

Ref. No.	Part Number	Description	Qty	Remarks
1	1W1-18540-00-00	SHIFT CAM ASSEMBLY	1	
2	93315-21813-00	BEARING	1	
3	1W1-18185-00-00	SEGMENT	1	
4	93604-12037-00	PIN, DOWEL	6	
5	1W1-18561-00-00	PLATE, SIDE 1	1	
6	99001-08600-00	CIRCLIP	1	
7	2A6-18531-00-00	BAR, SHIFT FORK GUIDE 1	1	
8	2A6-18535-00-00	BAR, SHIF FRK GDE 2	1	
9	2A6-18511-00-00	FORK, SHIFT 1	2	
10	2A6-18512-00-00	FORK, SHIFT 2	1	
11	1W1-18140-00-00	STOPPER LEVER ASSEMBLY	1	
12	50W-21631-00-00	BOLT 1	1	
13	90506-09156-00	SPRING, TENSION	1	
14	93604-30018-00	PIN, DOWEL	1	
15	136-18542-00-00	POINT, NEUTRAL	1	

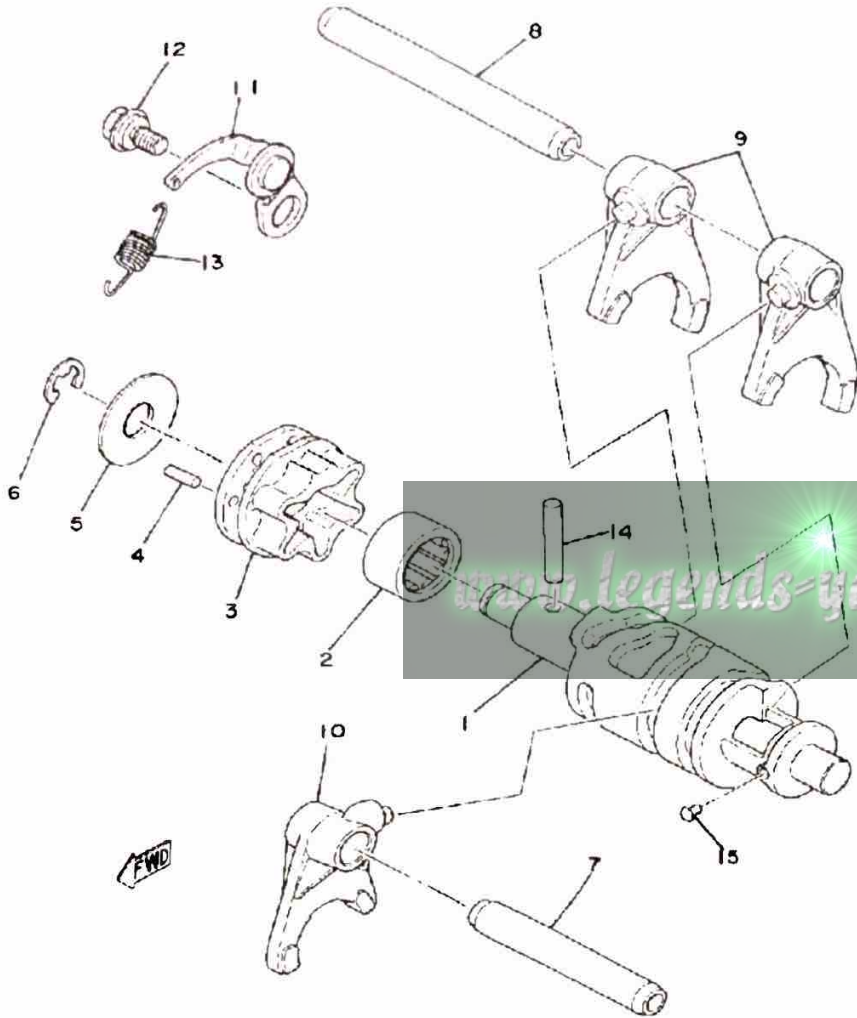

KICK STARTER

Ref. No.	Part Number	Description	Qty	Remarks
1	1W1-15620-01-00	KICK CRANK ASSEMBLY (1W1-15611-02-33)	1	
2	1W1-15621-01-00	BOSS, KICK CRANK	1	
3	90201-12541-00	WASHER, PLATE	1	
4	93430-08007-00	CIRCLIP	1	
5	90501-10459-00	SPRING, COMPRESSION	1	
6	93503-16010-00	BALL	1	
7	91316-08025-00	BOLT, SOCKET HEAD	1	
8	2A6-15660-01-00	KICK AXLE ASSEMBLY	1	
9	90468-26048-00	CLIP	1	
10	1W1-15641-00-00	GEAR, KICK (27T)	1	
11	248-15654-00-00	HOLDER, KICK GEAR	2	
12	99009-30400-00	CIRCLIP	1	
13	401-15676-00-00	COVER, SPRING	1	
14	90503-26346-00	SPRING, TORSION	1	
15	1W1-15666-00-00	SPACER	1	
16	93101-17062-00	OIL SEAL	1	
17	1W1-15618-01-00	COVER, KICK LEVER	1	
18	90336-06030-00	PLUG, TAPER	1	

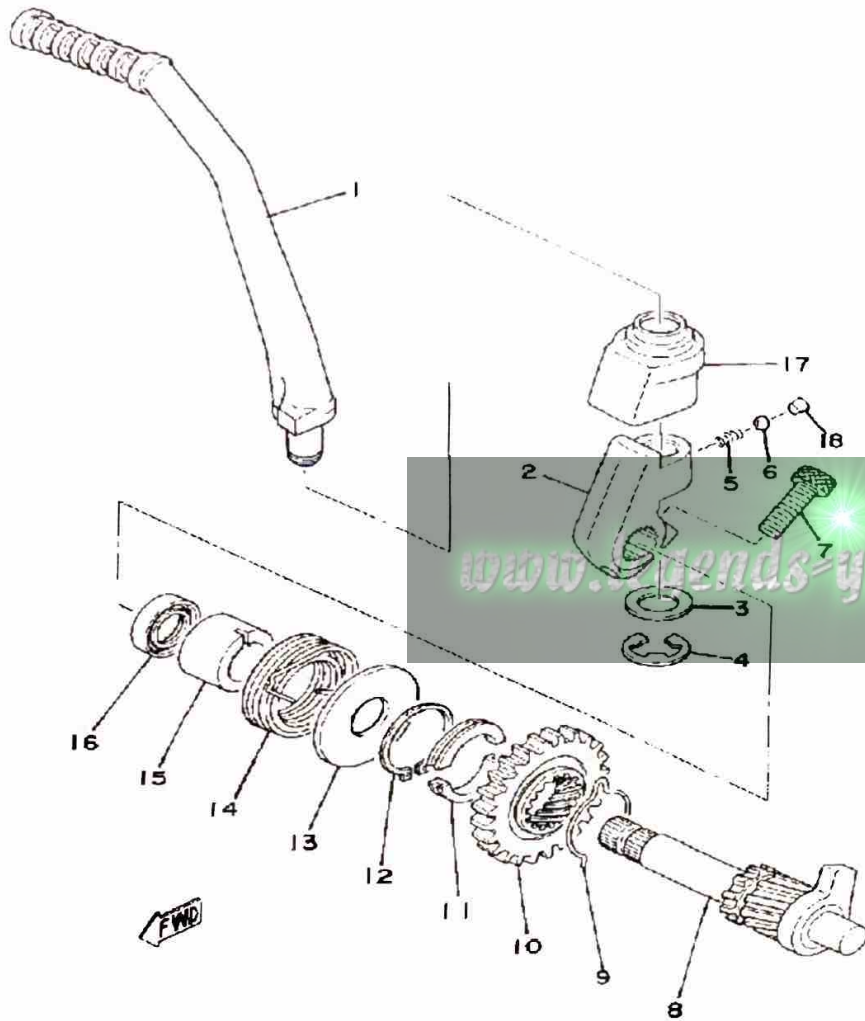

INTAKE

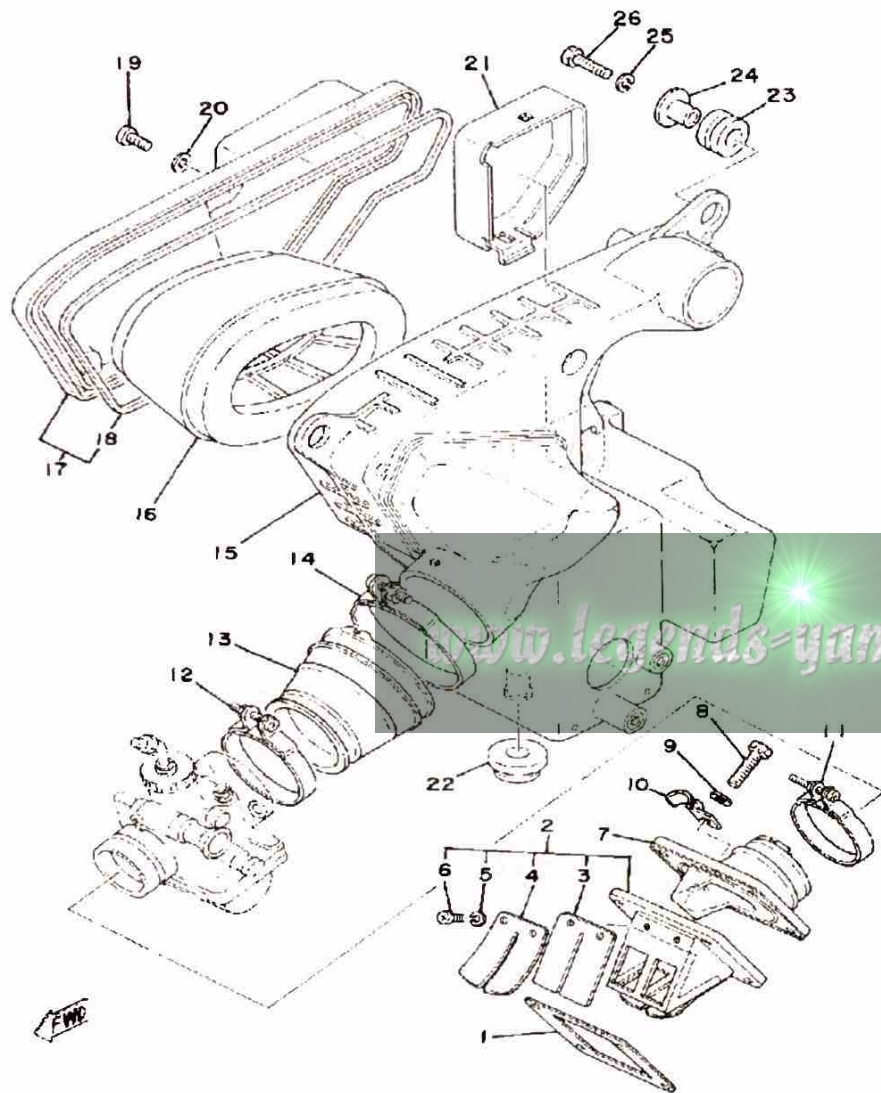

Ref. No.	Part Number	Description	Qty	Remarks
1	87A-13621-00-00	GASKET, VALVE SEAT	1	
2	558-13610-00-00	REED VALVE ASSEMBLY	1	
3	345-13613-70-00	. REED, VALVE	2	
4	345-13616-70-00	. STOPPER, REED VALVE	2	
5	92990-03100-00	. WASHER, SPRING (92901-03100)	4	
6	98580-03008-00	. SCREW, PAN HEAD	4	
7	401-13565-01-00	JOINT, CARBURETOR	1	
8	97011-06025-00	BOLT (97001-06025)	4	
9	92901-06600-00	WASHER	4	
10	90462-05005-00	CLAMP	1	
11	90460-43053-00	CLAMP, HOSE	1	
12	90460-49058-00	CLAMP, HOSE	1	
13	2A7-14453-00-00	JOINT, AIR CLNR 1	1	
14	90460-64065-00	CLAMP, HOSE	1	
15	3M2-14411-00-00	CASE, AIR CLEANER 1	1	
16	2A6-14451-00-00	ELEMENT, AIR CLNR	1	
17	2A6-14412-00-00	CAP, CLEANER CASE 1	1	
18	4L0-14457-01-00	. SEAL	1	
19	98580-05012-00	SCREW, PAN HEAD	5	
20	92901-05600-00	WASHER, PLATE	5	
21	2A6-14417-00-00	COVER 1	1	
22	90480-18171-00	GROMMET	1	
23	90480-14023-00	GROMMET	2	
24	90387-07391-00	COLLAR	2	
25	92995-06100-00	WASHER, SPRING	2	
26	97011-06025-00	BOLT (97001-06025)	2	

CARBURETOR

Ref. No.	Part Number	Description	Qty	Remarks
1	3M2-14101-00-00	CARBURETOR ASSEMBLY 1	1	
2	260-14142-27-00	. JET, PILOT (# 27.5)	1	
3	558-14141-32-00	. NOZZLE, MAIN	1	
4	137-14143-25-A0	. JET, MAIN #1 5	1	
	137-14143-26-A0	. JET, MAIN (#130)	1	STD
	137-14143-27-00	. JET, MAIN (#135)		
5	1V0-14190-25-00	. NEEDLE VALVE ASSEMBLY	1	
6	214-14195-00-00	. WASHER, NEEDLE VALVE	1	
7	314-14185-00-00	. FLOAT	1	
8	127-14186-00-00	. PIN, FLOAT	1	
9	304-14184-00-00	. GASKET, FLOAT CHAMBER	1	
10	539-14181-04-00	. BODY, FLOAT CHMBR 1	1	
11	98503-04014-00	. SCREW, PAN HEAD	4	
12	92901-04100-00	. WASHER, SPRING	4	
13	558-14147-00-00	. O-RING	1	
14	500-14115-00-00	. PLUG, SCREW	1	
15	493-14122-00-00	. SCREW, THROTTLE (443-14122-00)	1	
16	493-14133-00-00	. SPRING, THRTL STOP	1	
17	22K-14104-00-00	. AIR SCREW SET	1	
18	174-14134-00-00	. SPRING, AIR ADJUSTING	1	
19	314-14112-30-00	. VALVE, THROTTLE 1	1	
20	18L-1490J-00-00	. NEEDLE	1	
21	363-14137-00-00	. CLIP	1	
22	246-14132-00-00	. STOPPER, CABLE	1	
23	248-14131-00-00	. SPRING, THROTTLE VALVE	1	
24	164-14137-00-00	. CLIP	1	
25	2A6-14126-00-00	. GASKET	1	
26	2A6-14158-00-00	. TOP, MIXING CHAMBER	1	

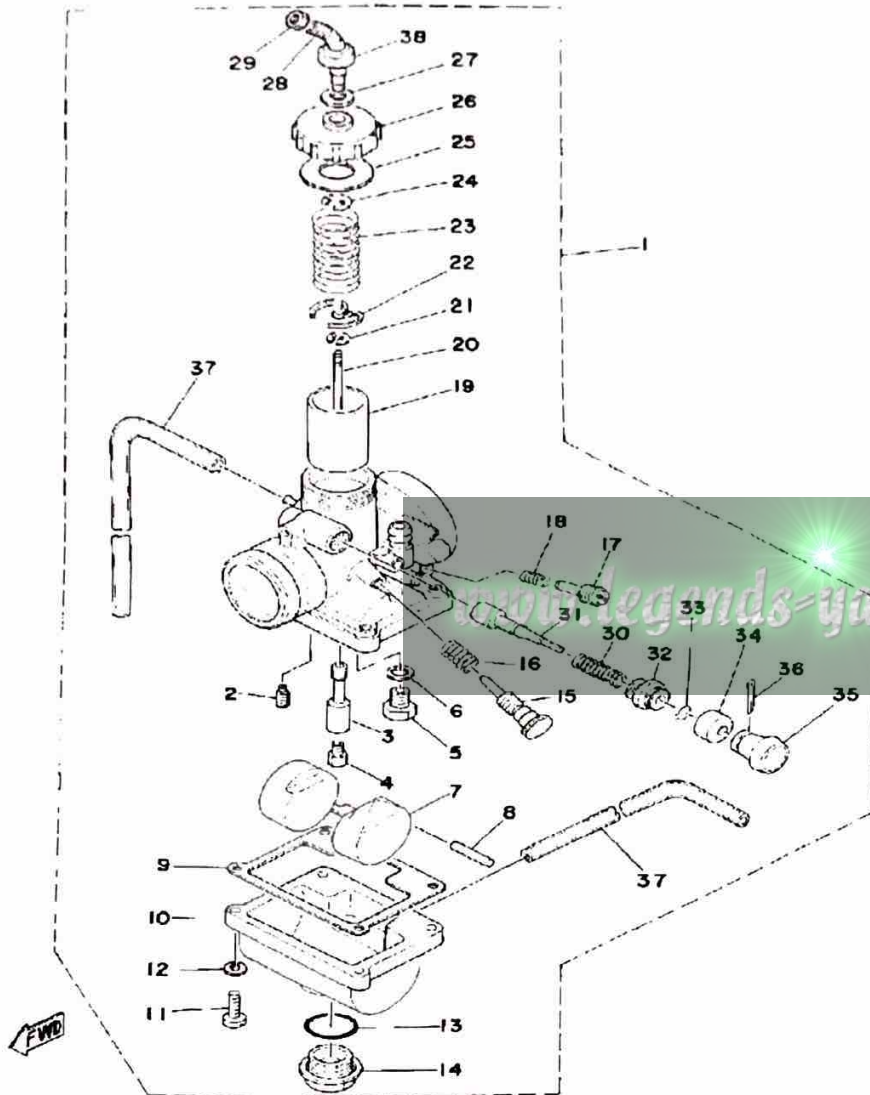

CONTINUED ON NEXT FRAME ►

CARBURETOR

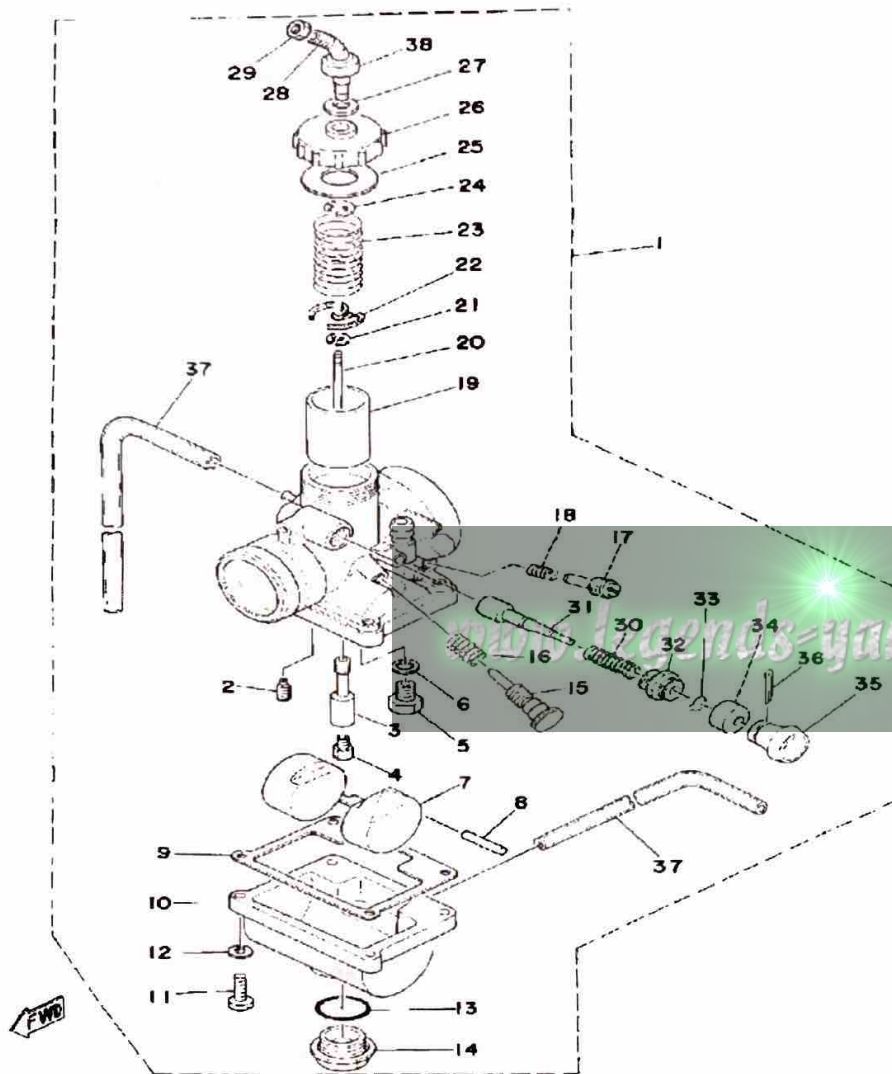

Ref. No.	Part Number	Description	Qty	Remarks
27	509-14198-00-00	GASKET	1	
28	10X-14106-00-00	CABLE ADJUST SCREW SET	1	
29	127-14161-00-00	NUT, CABLE ADJUSTING	1	
30	156-14135-00-00	SPRING, PLUNGER	1	
31	304-14171-00-00	PLUNGER, STARTER	1	
32	152-14174-00-00	CAP, PLUNGER	1	
33	353-14138-00-00	CLIP, PLUNGER	1	
34	132-14173-00-00	COVER, PLUNGER CAP	1	
35	304-14261-00-00	HOLDER	1	
36	91490-16020-00	PIN, COTTER	1	
37	23F-14197-00-00	PIPE, AIRVENT	2	
38	1M1-14169-00-00	CAP	1	

EXHAUST

Ref. No.	Part Number	Description	Qty	Remarks
1	3J0-14610-00-00	EXHAUST PIPE ASSEMBLY L (2A6-14610-00)	1	
2	152-14613-00-00	GASKET, EXST PIPE	1	
3	95380-06600-00	NUT	2	
4	2A6-14772-00-00	STAY, MUFFLER 2	1	
5	97313-08018-00	BOLT, HEXAGON (97301-08016)	2	
6	92990-08100-00	WASHER	2	
7	92901-08600-00	WASHER	2	
8	5V7-14771-00-00	STAY, MUFFLER 1	1	
9	90480-14023-00	GROMMET	2	
10	90387-06388-00	COLLAR	2	
11	92995-06100-00	WASHER, SPRING	2	
12	97011-06025-00	BOLT (97001-06025)	2	
13	97313-08018-00	BOLT, HEXAGON (97301-08016)	1	
14	92990-08100-00	WASHER	1	
15	92901-08600-00	WASHER	1	
16	1W2-14714-00-00	GASKET, MUFFLER	1	
17	90460-37026-00	CLAMP, HOSE	2	
18	2A6-14753-00-00	SILENCER, EXHAUST	1	
19	1M1-14752-01-00	PIPE, OUTLET	1	
20	98580-06012-00	SCREW, PAN HEAD	1	
21	92995-06100-00	WASHER, SPRING	1	
22	92901-06600-00	WASHER	1	
23	565-14747-00-00	DAMPER, MUFFLER	1	
24	90387-08258-00	COLLAR	1	
25	90201-08753-00	WASHER, PLATE	1	
26	92990-08100-00	WASHER	1	
27	97313-08030-00	BOLT, HEXAGON	1	

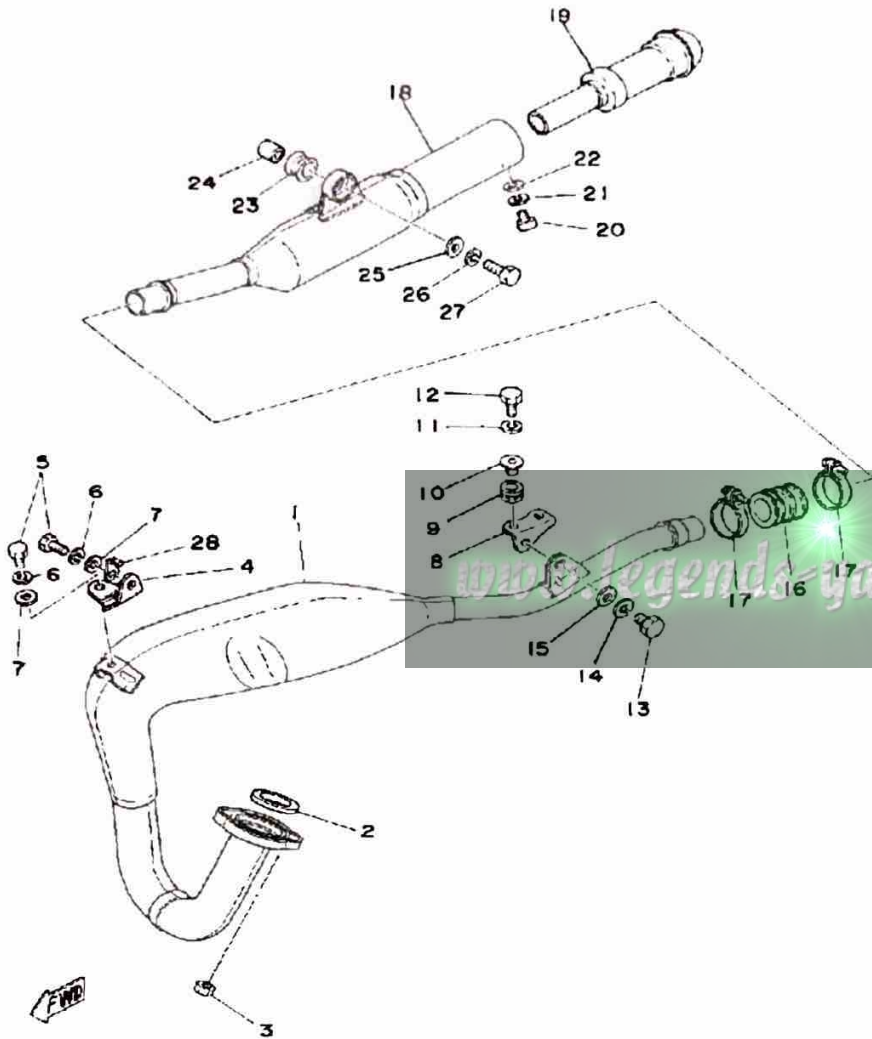

AUTOLUBE – Min. Stroke/Color Code	0.70 ~ 0.25mm / Gray
Minimum Output @ 200 cys/m	0.50cc
Maximum Output @ 200 cycles	5.13cc

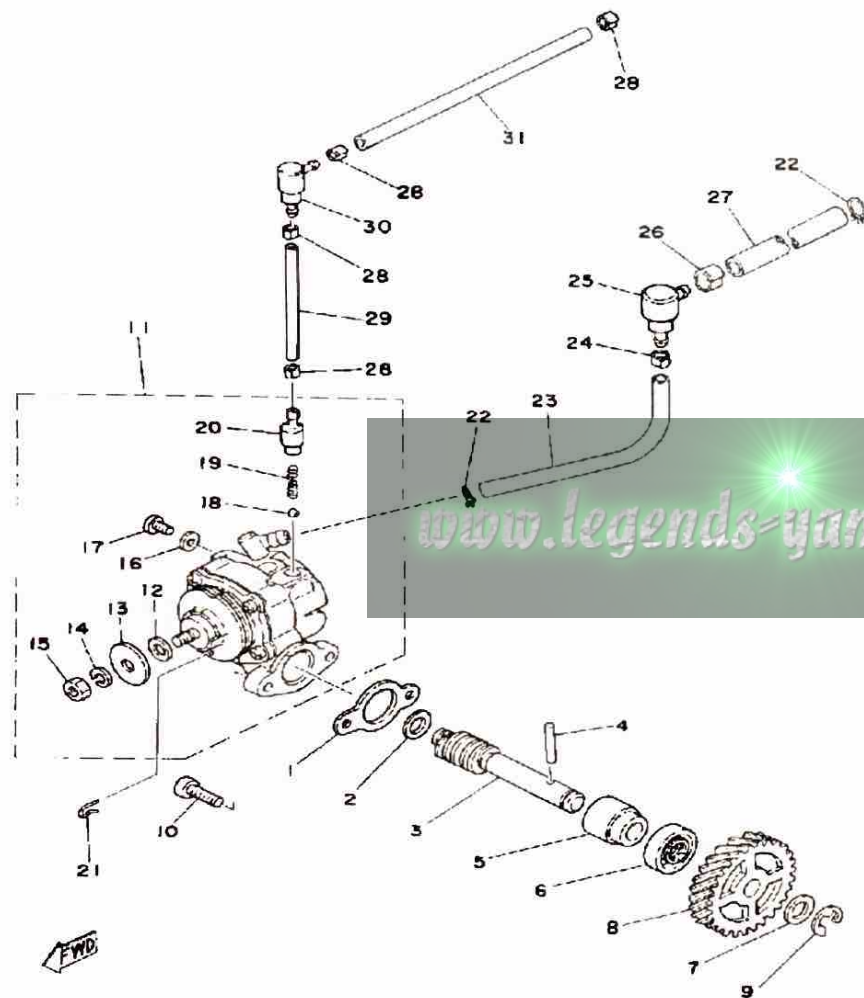

OIL PUMP

Ref. No.	Part Number	Description	Qty	Remarks
1	3MT-13116-00-00	GASKET, PUMP CASE (8Y0-13116-00)	1	
2	90201-08624-00	WASHER, PLATE	1	
3	(558-13175-00-00)	SHAFT, WORM	1	
4	93603-22028-00	PIN, DOWEL	1	
5	1E7-13176-00-00	METAL, WRM SHAF OTR	1	
6	93101-10002-00	OIL SEAL	1	
7	90201-105J4-00	WASHER, PLATE (90201-106H1)	1	
8	2A6-13178-00-00	GEAR, PUMP DRIVE	1	
9	99001-08600-00	CIRCLIP	1	
10	98580-05016-00	SCREW, PAN HEAD	2	
11	2A6-13101-00-00	OIL PUMP ASSEMBLY	1	
12	137-13137-00-03	SHIM (0.3T)	1	
	137-13137-00-05	SHIM (0.5T)	1	
	137-13137-00-10	SHIM (1.0T)	1	
13	137-13138-01-00	PLATE, ADJUSTING	1	
14	92990-05100-00	WASHER, SPRING	1	
15	95380-05600-00	NUT	1	
16	90430-04004-00	GASKET	1	
17	98901-04008-00	SCREW, BIND	1	
18	93505-32002-00	BALL	1	
19	90501-02018-00	SPRING, COMPRESSION	1	
20	402-13552-00-00	NOZZLE	1	
21	363-13133-01-00	CLIP	1	
22	90467-08003-00	CLIP	2	
23	90445-07219-00	HOSE	1	
24	90468-02025-00	CLIP	1	
25	2A6-13115-01-00	CONNECTOR, SCTN PPE	1	

CONTINUED ON NEXT FRAME ►

OIL PUMP

Ref. No.	Part Number	Description	Qty	Remarks
26	90468-02078-00	CLIP	1	
27	90445-09100-00	HOSE	1	
28	90468-02033-00	CLIP	4	
29	90445-05019-00	HOSE	1	
30	2A6-13164-01-00	CONCT, DELIVERY PPE	1	
31	90445-05024-00	HOSE (835-13171-00)	1	

AUTOLUBE - Min. Stroke/Color Code	0.20 ~ 0.25mm / Gray
Minimum Output @ 200 cycles	0.50cc
Maximum Output @ 200 cycles	5.13cc

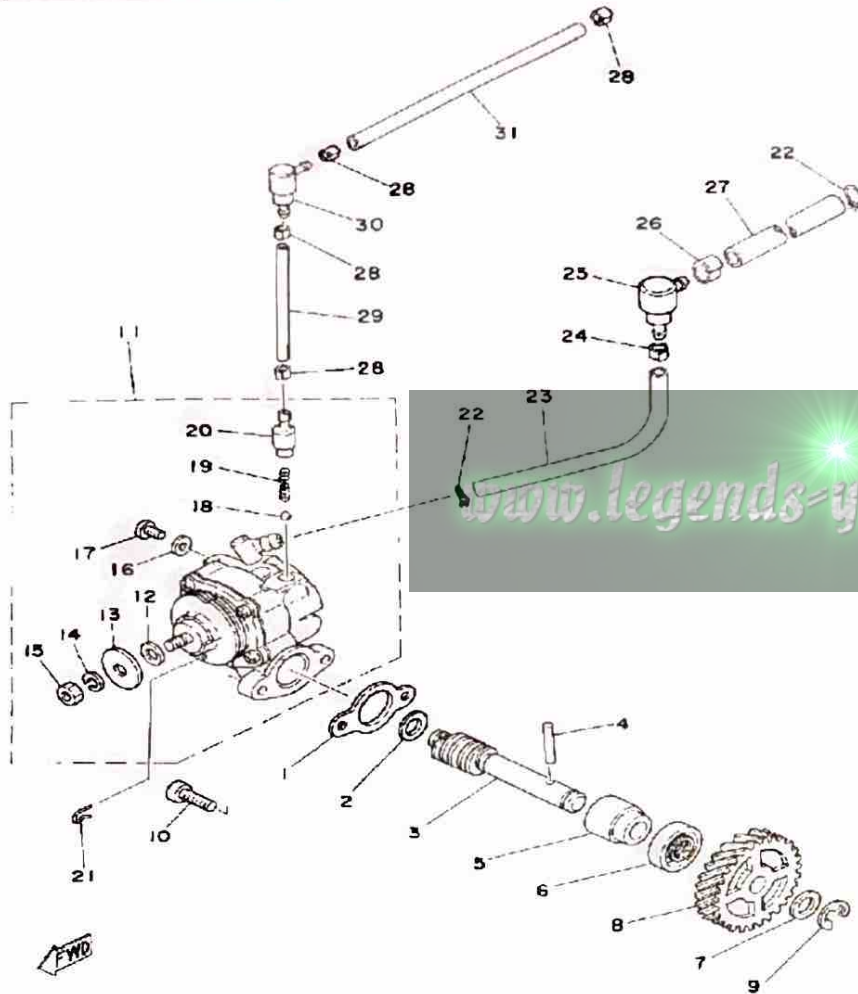

C - D - I - MAGNETO

- SPECIAL SERVICE TOOLS**
- 90890-01189-00 MAGNETO FLYWHEEL PULLER (UNIVERSAL)
 - 90890-01258-00 DIAL INDICATOR SPARK PLUG STAND, 14MM
 - 90890-03097-00 DIAL INDICATOR (UNIVERSAL)
 - 90890-03098-00 DIAL INDICATOR EXTENSION TIP (UNIVERSAL)

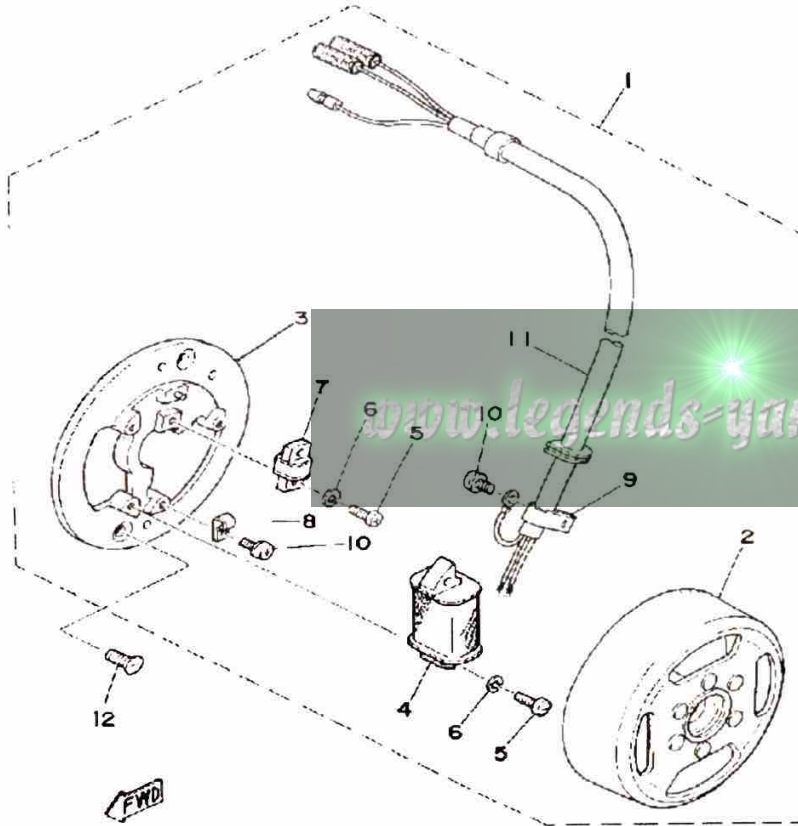

Ref. No.	Part Number	Description	Qty	Remarks
1	(3M2-85500-20-00)	CDI MAGNETO ASSEMBLY ...	1	
2	3M2-85550-20-00	. ROTOR ASSEMBLY	1	
3	3M2-85509-21-00	. BASE, MAGNETO	1	
4	3M2-85512-20-00	. COIL, SOURCE	1	
5	98503-04014-00	. SCREW, PAN HEAD	3	
6	92901-04100-00	. WASHER, SPRING	3	
7	3M2-85580-20-00	. COIL, PULSER	1	
8	(445-85528-20-00)	CLAMP, LEAD	1	
9	104-81328-20-00	. CLAMP	1	
10	97601-04106-00	. SCREW, PN/HD.W/WSHR ...	2	
11	3M2-85515-20-00	. LEAD WIRE ASSEMBLY	1	
12	98603-06012-00	SCREW, OVAL HEAD (92701-06012)	2	

Initial Engine Number/Frame Number 3M2-000101 / 3M2-000101

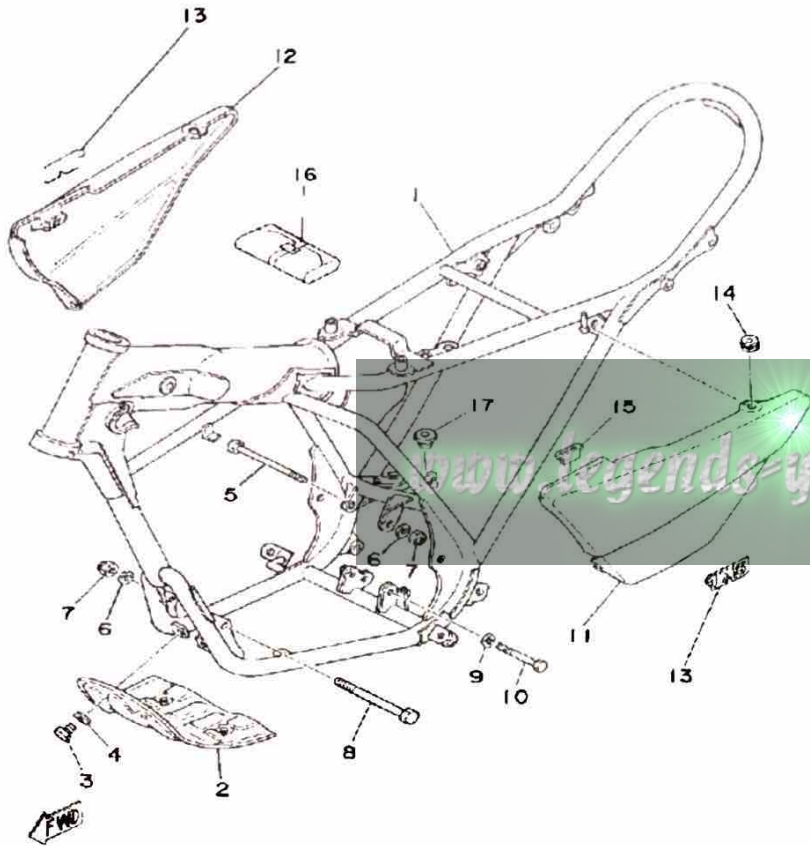

FRAME-SIDE COVER

Ref. No.	Part Number	Description	Qty	Remarks
1	(3M2-21110-00-33)	FRAME	1	YAMAHA BLACK
2	(2A6-21471-00-90)	PROTECTOR, ENGINE	1	YAMAHA BLACK
3	97013-06012-00	BOLT	4	
4	92901-06600-00	WASHER	4	
5	90105-08120-00	BOLT, WASHER BASED	1	
6	92990-08200-00	WASHER, PLAIN	2	
7	90185-08089-00	NUT, SELF-LOCKING	2	
8	90105-08099-00	BOLT, WASHER BASED	1	
9	92901-10100-00	WASHER, SPRING	1	
	92990-10100-00	WASHER, SPRING	1	
10	90105-10037-00	BOLT, WASHER BASED	1	
11	(2N4-21711-01-2H)	COVER, SIDE 1	1	
12	2N4-21721-01-2H	COVER, SIDE 2	1	
13	(3M2-21786-00-00)	EMBLEM 6	2	
14	90480-12053-00	GROMMET	4	
15	2N4-21717-00-00	DAMPER	2	
16	2A6-W2810-00-00	TOOL KIT	1	
17	90480-18171-00	GROMMET	1	

REAR ARM

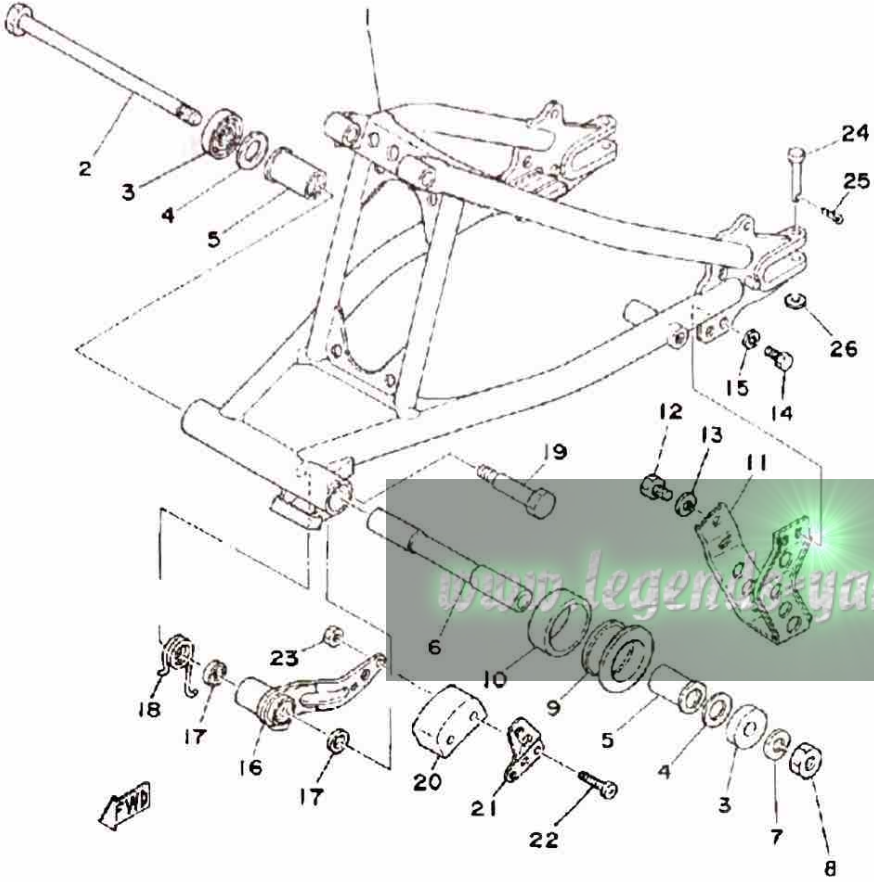

Ref. No.	Part Number	Description	Qty	Remarks
1	(3M2-22110-00-33)	REAR ARM	1	YAMAHA BLACK
2	2N4-22141-00-00	SHAFT, PIVOT	1	
3	401-22128-01-00	SEAL, GUARD	2	
4	401-22127-00-00	SHIM	1	
5	90386-18028-00	BUSH	2	
6	18G-22124-00-00	BUSH 2	1	
7	92901-12100-00	WASHER, SPRING	1	
8	90185-12046-00	NUT, SELF-LOCKING	1	
9	2A6-22151-00-00	SEAL, GUARD	1	
10	2A6-22152-00-00	SEAL, GUARD	1	
11	2A6-22318-00-00	GUARD, CHAIN	1	
12	97313-08012-00	BOLT	1	
13	92990-08100-00	WASHER	1	
14	97313-06016-00	BOLT, HEXAGON	2	
15	92995-06100-00	WASHER, SPRING	2	
16	2A6-22179-00-00	ARM, TENSIONER	1	
17	93104-14044-00	OIL SEAL	2	
18	90508-35350-00	SPRING, TORSION	1	
19	90109-10483-00	BOLT (90109-10533-00)	1	
20	ACC-11130-00-25	TENSIONER (2N0-22178-00-00)	1	
21	1W1-22187-00-00	GUIDE, CHAIN	1	
22	98501-05035-00	SCREW, PAN HEAD	2	
23	95311-05700-00	NUT	2	
24	91701-06042-00	PIN, CLEVIS	2	
25	91490-20020-00	PIN, COTTER	2	
26	92901-06600-00	WASHER	2	

REAR CUSHION

Ref. No.	Part Number	Description	Qty	Remarks
1	(3J0-22210-00-00)	SHK/ABS ASSEMBLY, REAR	1	
2	(1M1-22219-01-00)	BRACKET, UPPER	1	
3	(2N4-22213-00-00)	SEAT, SPRING UPPER	1	
4	91401-30040-00	PIN, COTTER	1	
5	(90501-90554-00)	SPRING, COMPRESSION	1	
6	(2N4-22496-00-00)	SLEEVE, ROD	1	
7	(3J0-22493-00-00)	BUMP, STOP	1	
8	90380-12051-00	BUSH, SOLID	2	
9	(3J0-22401-00-00)	DAMPER SUB-ASSEMBLY	1	
10	(2N4-22214-00-00)	GUIDE, SPRING 1	1	
11	1W1-22128-00-00	COVER, THRUST 1	2	
12	90109-10550-00	BOLT (90109-10453-00)	1	
13	92990-10200-00	WASHER, PLAIN	1	
14	95303-10900-00	NUT, SLOTTED	1	
15	91490-20025-00	PIN, SPLIT	1	
16	90240-12059-00	PIN, CLEVIS	1	
17	92990-12600-00	WASHER, PLATE	1	
18	91401-30030-00	PIN, COTTER	1	

Monoshock	Oil Type/Qty.	Not Recommended
	Gas Pressure	15 kg/cm ²

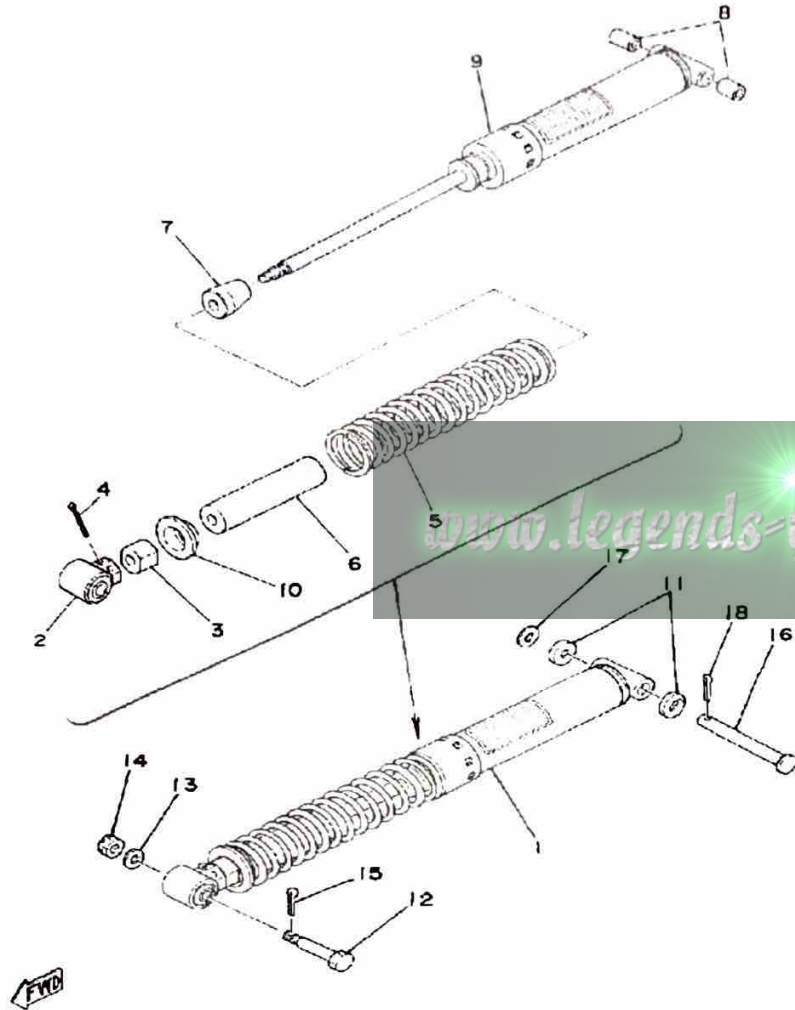

STAND-FOOTREST-BRANKE PEDAL

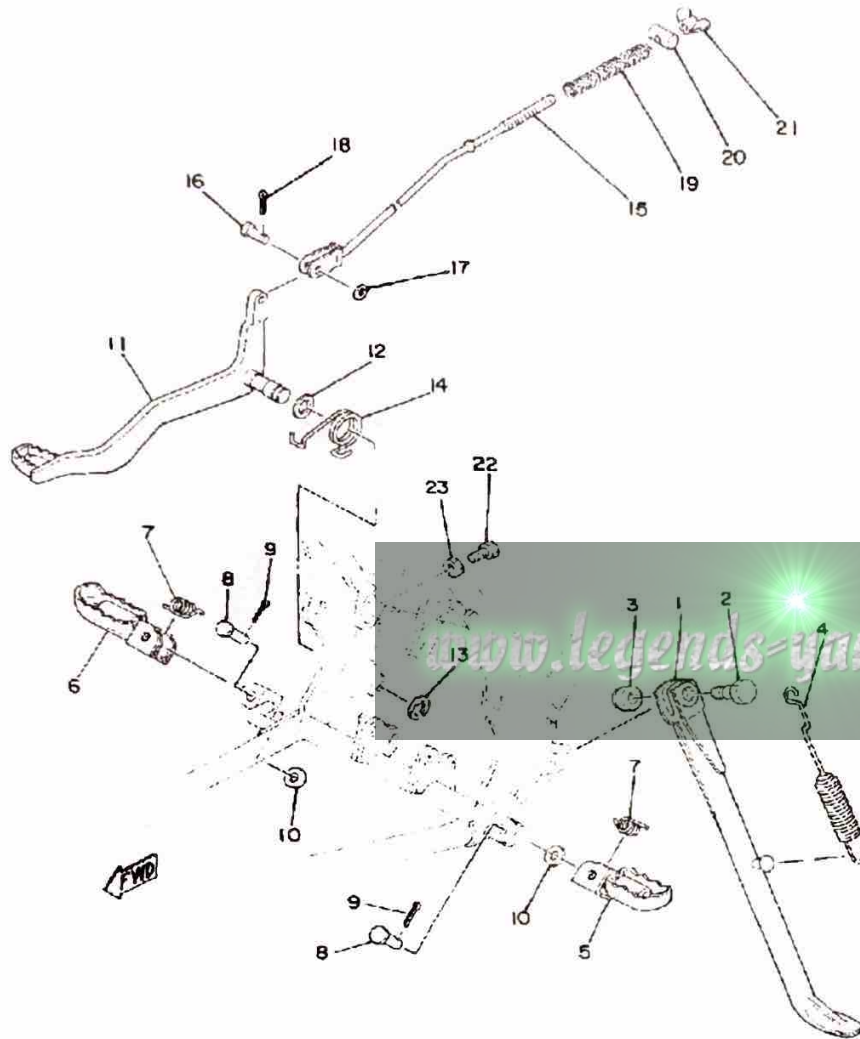

Ref. No.	Part Number	Description	Qty	Remarks
1	1W1-27311-10-00	STAND, SIDE	1	
2	90109-103A1-00	BOLT	1	
3	90185-10037-00	NUT, SELF-LOCKING	1	
4	90507-29008-00	SPRING, TENSION	1	
5	22W-27411-01-90	FOOTREST 1	1	YAMAHA BLACK
6	22W-27421-01-90	FOOTREST 2	1	YAMAHA BLACK
7	90508-20023-00	SPRING, TORSION	2	
8	91701-08038-00	PIN, CLEVIS	2	
9	91401-25020-00	PIN, COTTER	2	
10	92901-08600-00	WASHER	2	
11	3M2-27211-00-33	PEDAL, BRAKE	1	
12	90201-14212-00	WASHER, PLATE	1	
13	93430-10015-00	CIRCLIP, E-TYPE	1	
14	90508-32354-00	SPRING, TORSION	1	
15	1W2-27231-00-00	ROD, BRAKE	1	
16	90240-06006-00	PIN, CLEVIS	1	
17	92990-06200-00	WASHER	1	
18	91401-25020-00	PIN, COTTER	1	
19	90501-10245-00	SPRING, COMPRESSION	1	
20	90249-12008-00	PIN	1	
21	90179-06411-00	NUT	1	
22	97011-06020-00	BOLT	1	
23	95380-06700-00	NUT	1	

FRONT FENDER-REAR FENDER

Ref. No.	Part Number	Description	Qty	Remarks
1	3M2-21511-00-00	FENDER, FRONT	1	NEW WHITE
2	97011-06025-00	BOLT (97001-06025)	4	
3	92995-06100-00	WASHER, SPRING	4	
4	90201-06067-00	WASHER, PLATE	4	
5	90480-14198-00	GROMMET	4	
6	90387-06388-00	COLLAR	4	
7	2A8-21611-80-00	FENDER, REAR	1	NEW WHITE
8	97313-06016-00	BOLT, HEXAGON	4	
9	92995-06100-00	WASHER, SPRING	4	
10	92990-06200-00	WASHER	4	
11	(99999-01151-00)	GUARD, MUD	1	
12	2A6-21639-00-00	. DAMPER 2	1	
13	1M1-21621-00-00	FLAP	1	
14	90480-01254-00	GROMMET	2	
15	97313-06016-00	BOLT, HEXAGON	3	
16	92995-06100-00	WASHER, SPRING	3	
17	90201-06067-00	WASHER, PLATE	3	
18	90480-12012-00	GROMMET	3	

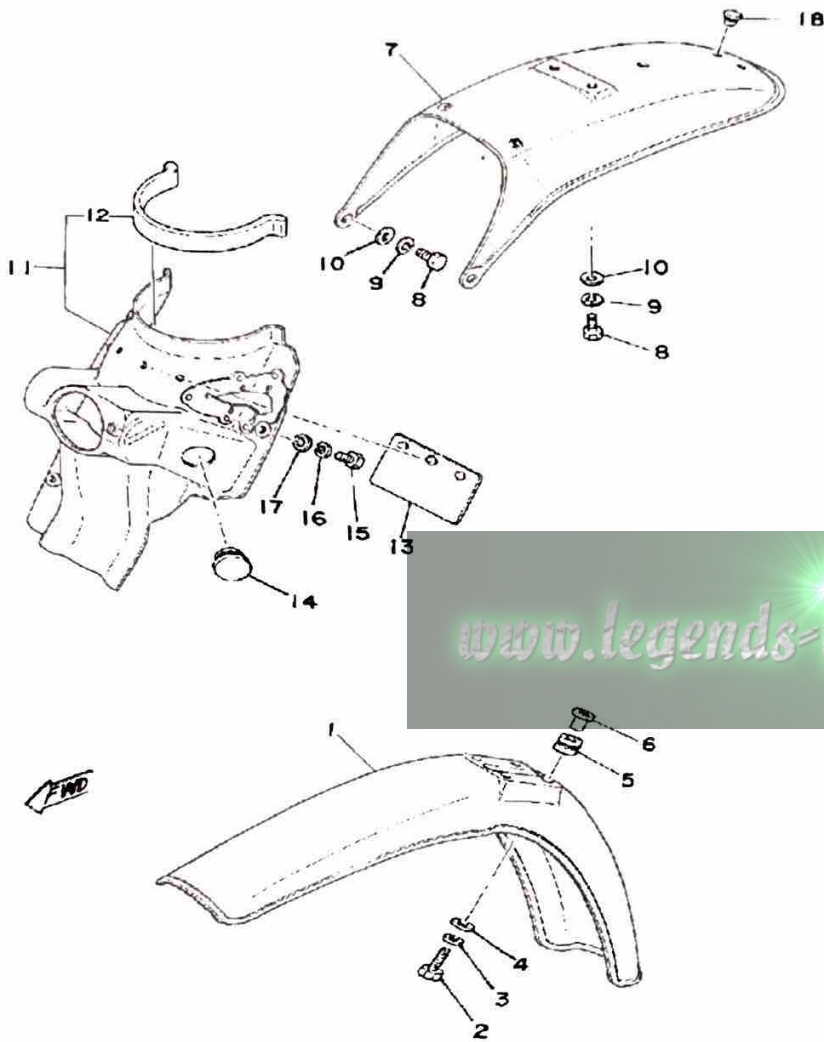

FRONT FORK

Front Forks	Oil Type/Level/Qty.	10 wt. Fork Oil* / ϕ / 170cc
	Spring Length Std	463.6mm

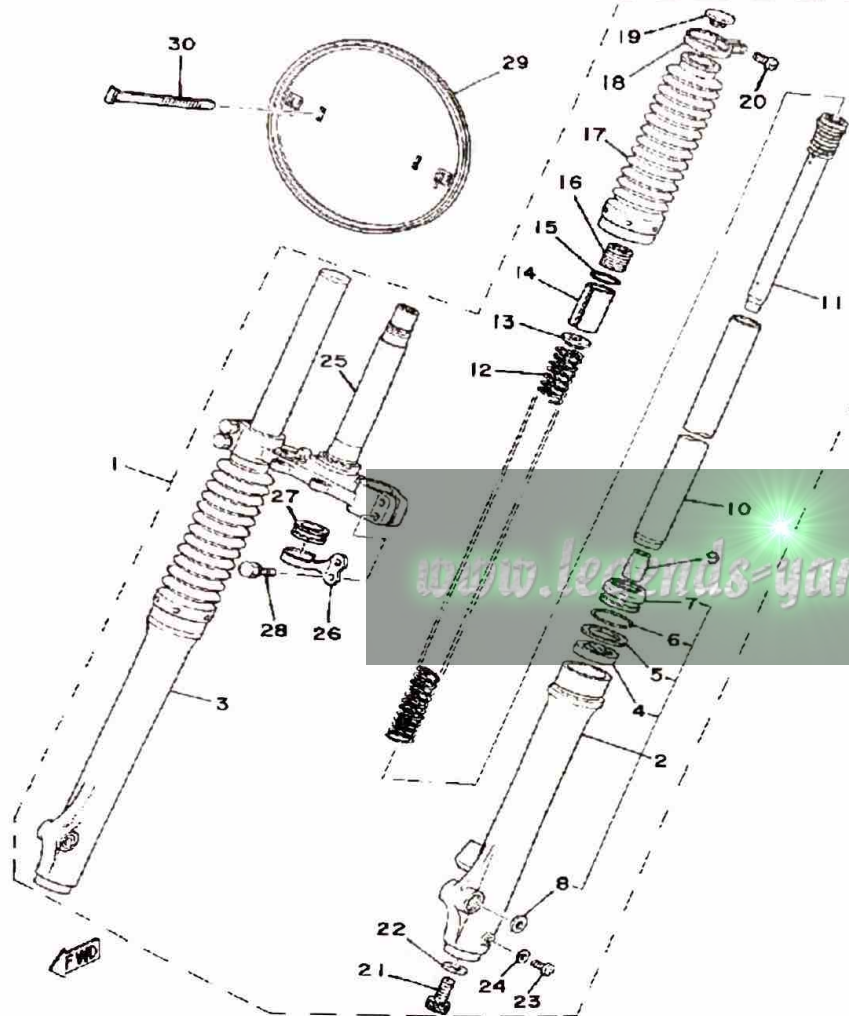

90890-01051-00

STEERING NUT WRENCH

Ref. No.	Part Number	Description	Qty	Remarks
1	(3M2-23101-00-00)	FRONT FORK ASSEMBLY	1	
2	(3J0-23126-00-00)	TUBE, OUTER 1	1	
3	(3J0-23136-00-00)	TUBE, OUTER 2	1	
4	2K5-23145-00-00	.. OIL SEAL	2	
5	2K5-23146-00-00	.. WASHER, OIL SEAL	2	
6	15E-23153-00-00	.. RING, SNAP	2	
7	3Y6-23144-00-00	.. SEAL, DUST (2K5-23144-00)	2	
8	(2K5-23165-00-00)	WASHER, FELT	2	
9	2K5-23173-00-00	.. SPINDLE, TAPER	2	
10	(3J0-23110-00-00)	INNER TUBE 1	2	
11	(3J0-23170-00-00)	CYLINDER, FRTRK	2	
12	(3J0-23141-00-00)	SPRING, FRONT FORK	2	
13	256-23142-60-00	.. SEAT, SPRING UPPER	2	
14	(3J0-23118-00-00)	SPACER	2	
15	146-23114-00-00	.. GASKET	2	
16	1X0-23111-00-00	.. BOLT, CAP	2	
17	2K5-23191-M0-00	.. BOOT, FRONT FORK	2	
18	2K5-23192-00-00	.. BAND	2	
19	1X0-23168-00-00	.. CAP (2N4-23168-00)	2	
20	509-23194-L0-00	.. SCREW, BOOT BAND	2	
21	278-23181-50-00	.. BOLT, HEXAGON SOCKET HEAD	2	
22	509-23158-L0-00	.. GASKET	2	
23	98580-04008-00	.. SCREW, PAN HEAD	2	
24	122-23129-00-00	.. GASKET, DRAIN PLUG	2	
25	(2N4-23340-00-33)	UNDER BRACKET	1	
26	1W1-23317-01-00	.. HOLDER, CABLE	1	
27	1W1-23389-00-00	.. GUIDE, CABLE	1	
28	5X6-23181-L0-00	.. BOLT, HEX SCKT HEADSOCKET HEAD	4	

CONTINUED ON NEXT FRAME ►

FRONT FORK

Front Forks: Oil Type/Level/Qty	10 wt. Fork Oil / ϕ / 170cc
Spring Length Std	463.6mm

Ref. No.	Part Number	Description	Qty	Remarks
29	3R0-23485-00-00	PLATE, NUMBER	1	
30	2X4-23489-00-00	BAND	2	

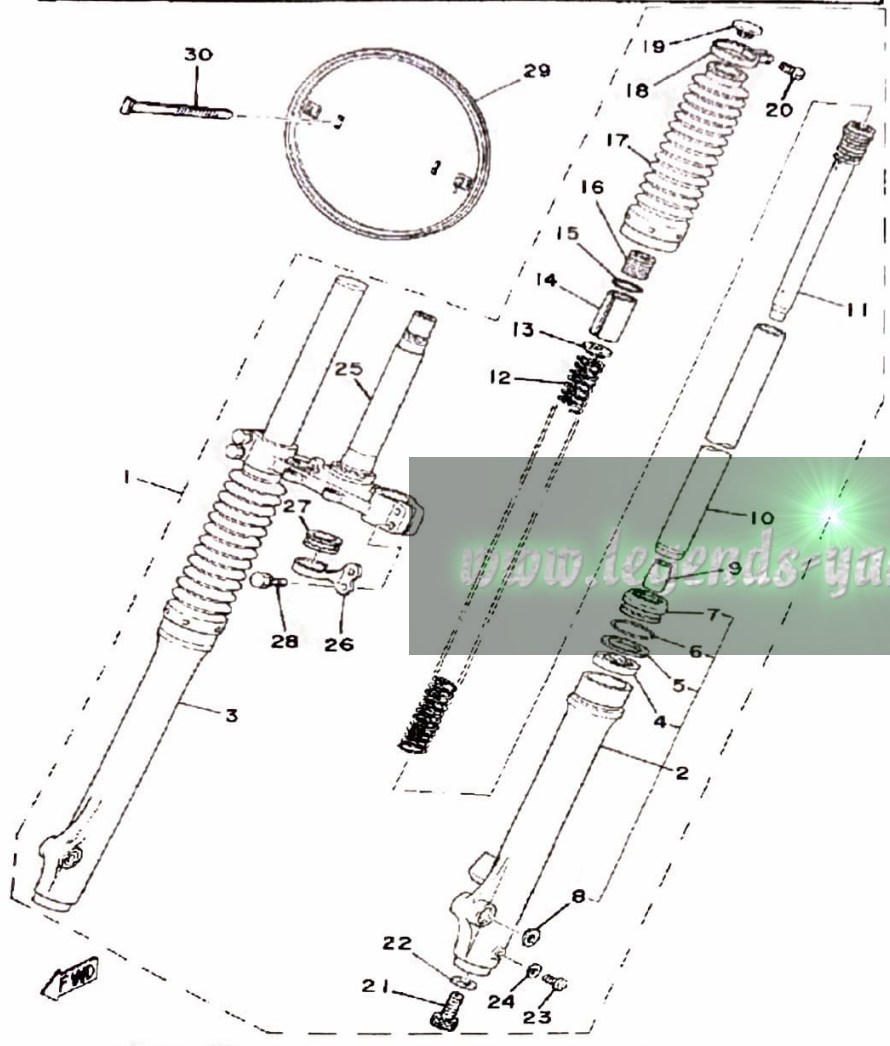

90890-01051-00 STEERING NUT WRENCH

STEERING

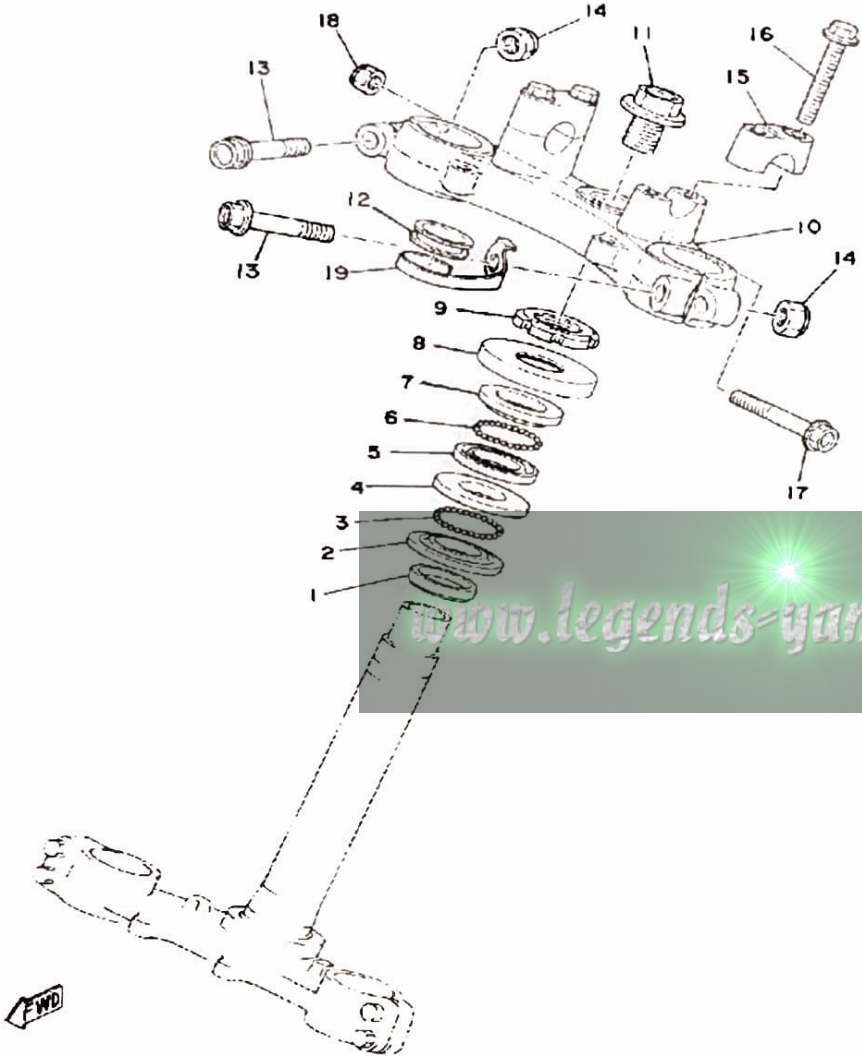

Ref. No.	Part Number	Description	Qty	Remarks
1	164-23462-00-00	SEAL, STEERING	1	
2	156-23411-00-00	RACE, BALL 1	1	
3	93501-04011-00	BALL	19	
4	156-23412-00-00	RACE, BALL 2	1	
5	22F-23412-01-00	RACE, BALL 2	1	
6	93503-16010-00	BALL	22	
7	22F-23411-01-00	RACE, BALL 1	1	
8	10V-23416-01-00	COVER, BALL RACE 2	1	
9	90179-25033-00	NUT	1	
10	2N4-23435-00-98	CROWN, HANDLE	1	
11	90105-14136-00	BOLT, WASHER BASED	1	
12	1W1-23389-00-00	GUIDE, CABLE	1	
13	95811-10060-00	BOLT, FLANGE	2	
14	90185-10060-00	NUT, SELF-LOCKING	2	
15	1E6-23441-00-00	HOLDER, HANDLE UPR	2	
16	95811-08035-00	BOLT, FLANGE (95821-08035)	4	
17	95811-08055-00	BOLT, FLANGE	1	
18	90185-08089-00	NUT, SELF-LOCKING	1	
19	2K5-23317-01-00	HOLDER, CABLE	1	

HANDLE-WIRE

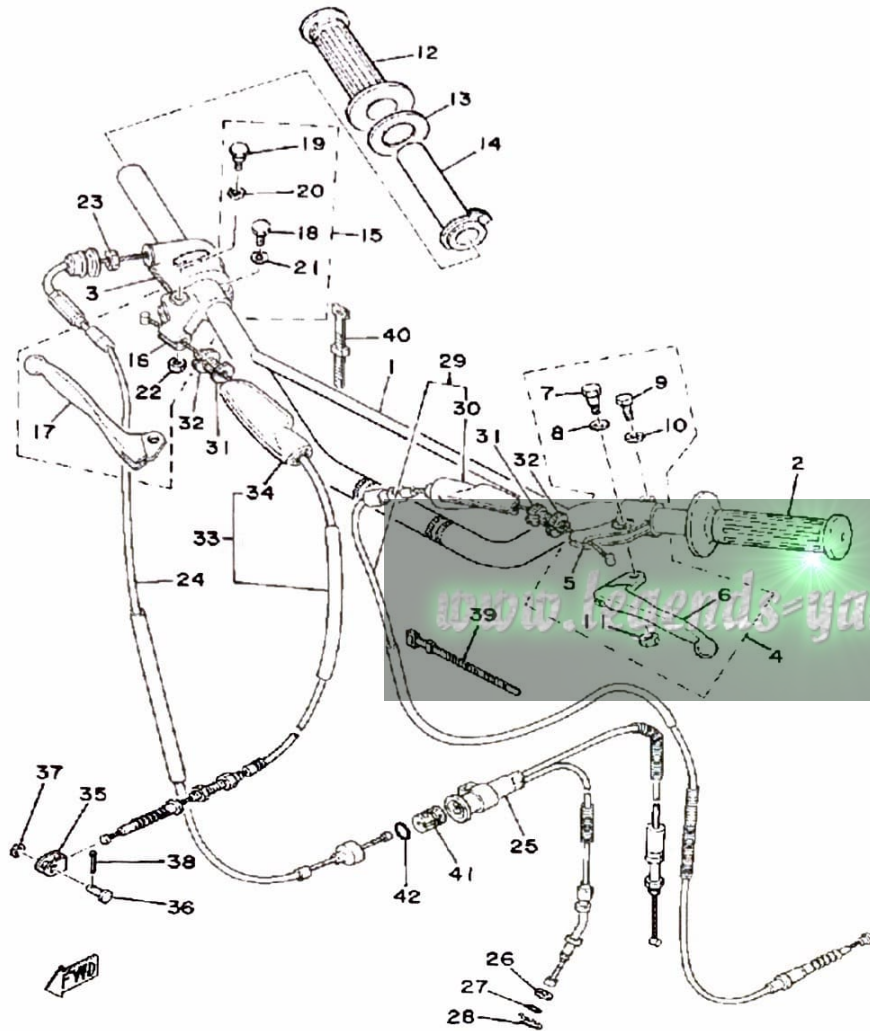

Ref. No.	Part Number	Description	Qty	Remarks
1	2A8-26111-00-00	HANDLEBAR	1	
2	1E6-26241-00-00	GRIP LH	1	
3	(2X6-83976-00-98)	SWITCH, HANDLE 1	1	
4	(1J3-82910-23-00)	LEVER HOLDER ASSEMBLY 1	1	
5	214-82911-01-00	. HOLDER, LEVER 1	1	
6	1J3-83912-20-00	. LEVER L	1	
7	90109-06797-00	. BOLT	1	
8	90201-08083-00	. WASHER, PLATE	1	
9	97003-06022-00	. BOLT, HEXAGON (97301-06022)	1	
10	92995-06100-00	. WASHER, SPRING	1	
11	95601-06100-00	. NUT, U	1	
12	1A0-26242-01-00	GRIP (RIGHT)	1	
13	1M1-26249-01-00	RING, LEAF	1	
14	434-26243-00-00	TUBE, THROTTLE GUIDE	1	
15	(2A6-W8292-02-00)	LEVER HOLDER ASSEMBLY R	1	
16	516-82921-30-00	. HOLDER, LEVER 2	1	
17	2A6-83922-00-00	. LEVER R	1	
18	97003-06022-00	. BOLT, HEXAGON (97301-06022)	1	
19	90109-06797-00	. BOLT	1	
20	90201-08083-00	. WASHER, PLATE	1	
21	92995-06100-00	. WASHER, SPRING	1	
22	95601-06100-00	. NUT, U	1	
23	90170-10038-00	NUT, HEXAGON	1	
24	2A6-26311-00-00	CABLE, THROTTLE 1	1	
25	2A6-26312-00-00	CABLE, THROTTLE 2	1	
26	92901-08600-00	WASHER	1	
27	93210-07100-00	O-RING	1	

CONTINUED ON NEXT FRAME ►

HANDLE-WIRE

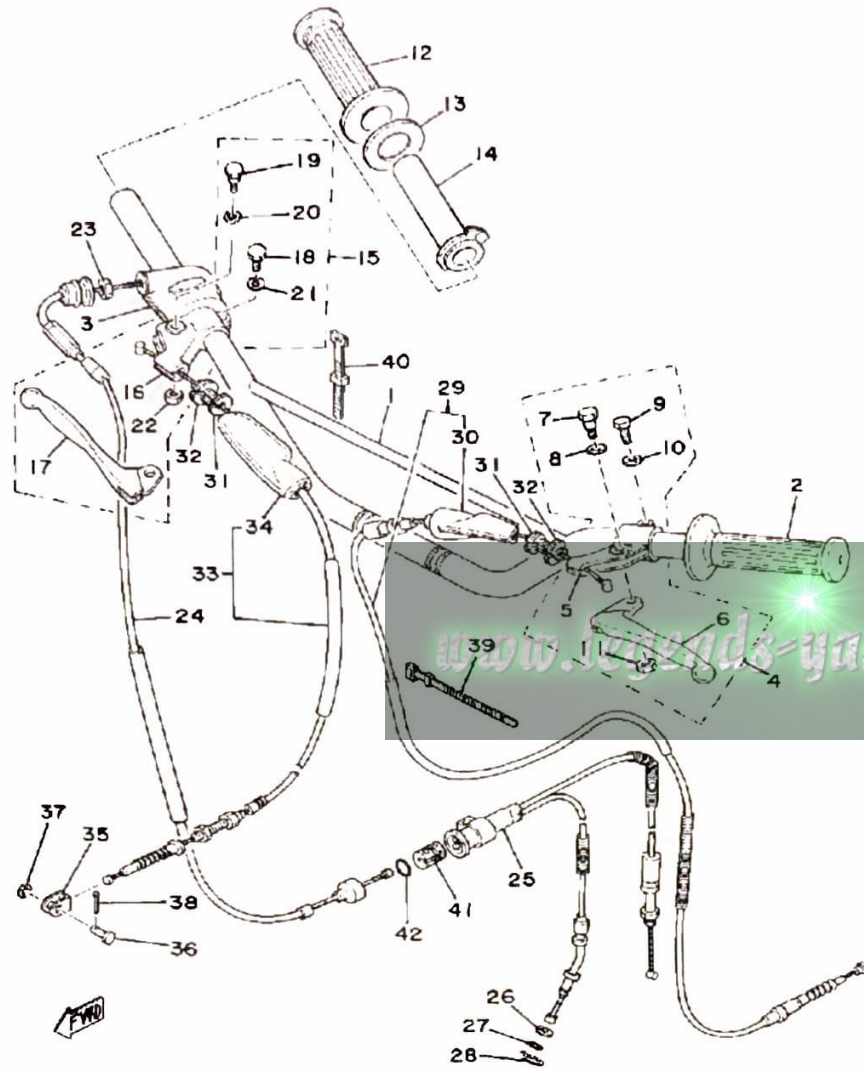

Ref. No.	Part Number	Description	Qty	Remarks
28	90468-08086-00	CLIP	1	
29	2A6-26335-01-00	CABLE, CLUTCH	1	
30	382-26372-01-00	. COVER, HANDLE LEVER ...	1	
31	90123-08046-00	BOLT	2	
32	90179-08148-00	NUT	2	
33	2K5-26341-00-00	CABLE, BRAKE	1	
34	382-26372-01-00	. COVER, HANDLE LEVER ...	1	
35	156-26347-00-00	JOINT, CABLE	1	
36	90240-08013-00	PIN, CLEVIS	1	
37	90201-08083-00	WASHER, PLATE	1	
38	91490-20020-00	PIN, COTTER	1	
39	437-83936-11-00	BAND, SWITCH CORD	1	
40	437-83936-01-00	BAND, SWITCH CORD	2	
41	1M1-26263-00-00	PIECE, CONNECTING	1	
42	93210-10118-00	O-RING	1	

Basic Color(s)	New White
Fuel Type/Fuel Tank Capacity/Reserve Capacity	Regular / 6.8 Lit (1.8 Gal) / 0.9 Lit. (0.2 Gal)

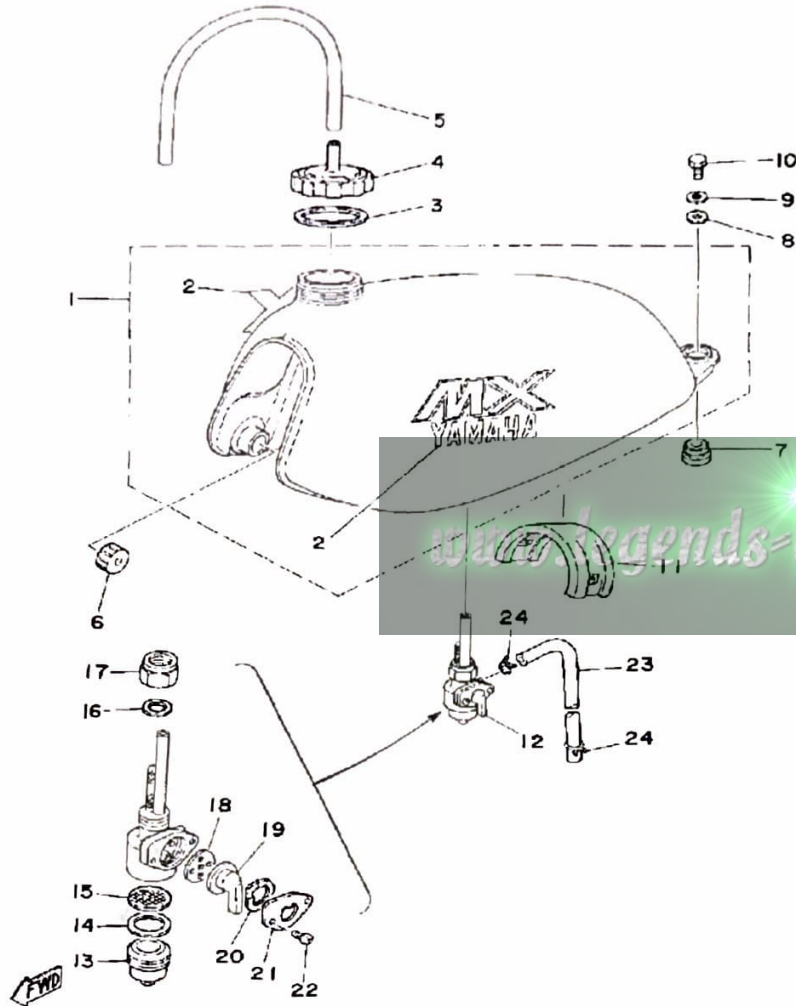

FUEL TANK

Ref. No.	Part Number	Description	Qty	Remarks
1	(2N4-24110-00-X1)	FUEL TANK	1	NEW WHITE
2	(3M1-24244-00-00)	GRAPHIC, FUEL TNK 1	2	
3	1W1-24612-00-00	GASKET, CAP	1	
4	2A6-24611-00-00	BODY, CAP	1	
5	90445-09115-00	HOSE	1	
6	278-24181-00-00	DAMPER, LOCATING 1	2	
7	90480-22231-00	GROMMET	2	
8	90201-06073-00	WASHER, PLATE	2	
9	92995-06100-00	WASHER, SPRING	2	
10	97013-06012-00	BOLT	2	
11	2A6-24182-00-00	DAMPER, LOCATING 2	1	
12	304-24500-12-00	FUEL COCK ASSEMBLY 1 ...	1	
13	1A0-24521-01-00	. CUP, FILTER	1	
14	132-24522-00-00	. GASKET	1	
15	304-24515-00-00	. NET, FILTER 2	1	
16	434-24532-00-00	. GASKET	1	
17	132-24531-00-00	. NUT	1	
18	137-24523-00-00	. GASKET	1	
19	447-24524-00-00	. LEVER, COCK	1	
20	132-24518-00-00	. WASHER, WAVE	1	
21	447-24525-00-00	. PLATE, LEVER FITTING ...	1	
22	98580-03008-00	. SCREW, PAN HEAD	2	
23	90445-09089-00	HOSE	1	
24	90467-08003-00	CLIP	2	

OIL TANK

Oil ng System	Auto/lane
Capacity: Dry	10 Lit.
Lubricant: Temp above 5°C (40°F)	Yamalube 2°
Below 15°C (60°F)	Yamalube 2°

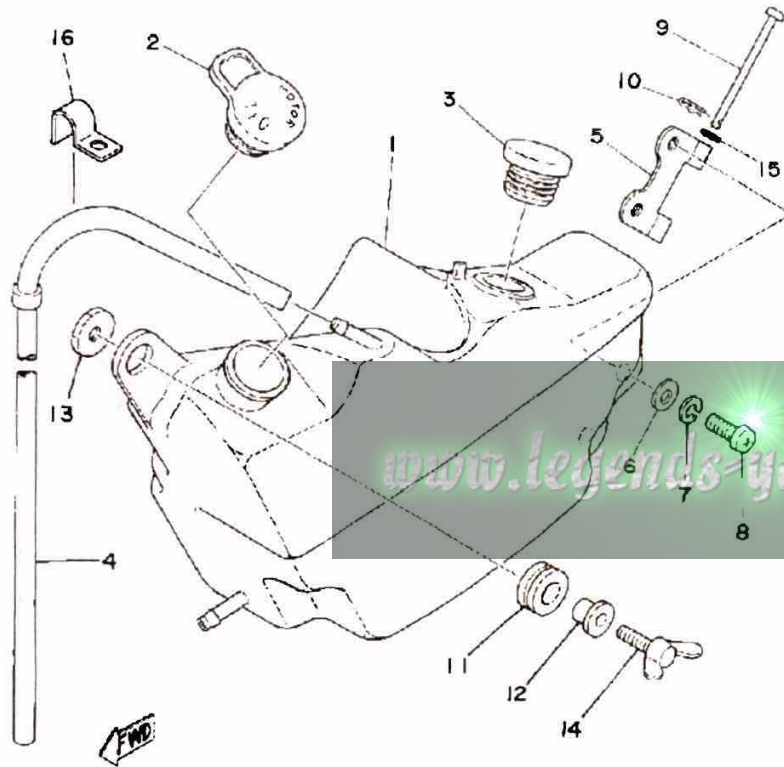

Ref. No.	Part Number	Description	Qty	Remarks
1	2A6-21751-00-00	TANK, OIL	1	
2	1T9-21771-00-00	BODY, CAP	1	
3	3M2-21771-00-00	BODY, CAP	1	
4	90445-09361-00	HOSE	1	
5	2A6-21796-00-00	HINGE	1	
6	90201-06067-00	WASHER, PLATE	2	
7	92995-06100-00	WASHER, SPRING	2	
8	98503-06014-00	SCREW, PAN HEAD (92502-06016)	2	
9	91701-05050-00	PIN, CLEVIS	1	
10	90468-10050-00	CLIP	1	
11	90480-14023-00	GROMMET	1	
12	90387-07391-00	COLLAR	1	
13	90179-06013-00	NUT, SPEC'L SHAPE	1	
14	90122-06021-00	BOLT, WING (38W)	1	
15	93210-04122-00	O-RING	1	
16	90462-05005-00	CLAMP	1	

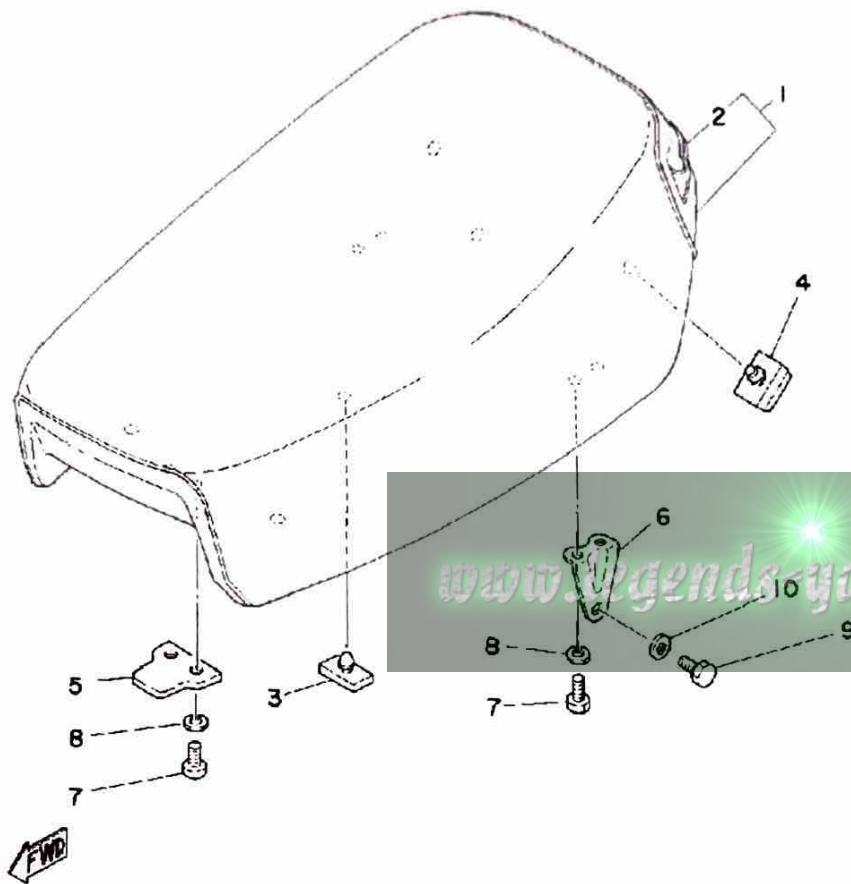

SEAT

Ref. No.	Part Number	Description	Qty	Remarks
1	2N4-W2473-00-00	SEMI-DBL-SEAT ASSEMBLY (2N4-24770-90)	1	
2	3M2-24771-00-00	. COVER, SM-DBL SEAT	1	
3	509-24724-00-00	DAMPER, SEAT	4	
4	214-24724-00-00	DAMPER, SEAT	2	
5	1M1-24748-00-00	BRACKET, SEAT	1	
6	2A6-24738-00-00	BRACKET, SEAT	2	
7	97013-06012-00	BOLT	6	
8	92995-06100-00	WASHER, SPRING	6	
9	97313-08012-00	BOLT	2	
10	92901-08600-00	WASHER	2	

www.legends-yamaha-enduros.com

FRONT WHEEL

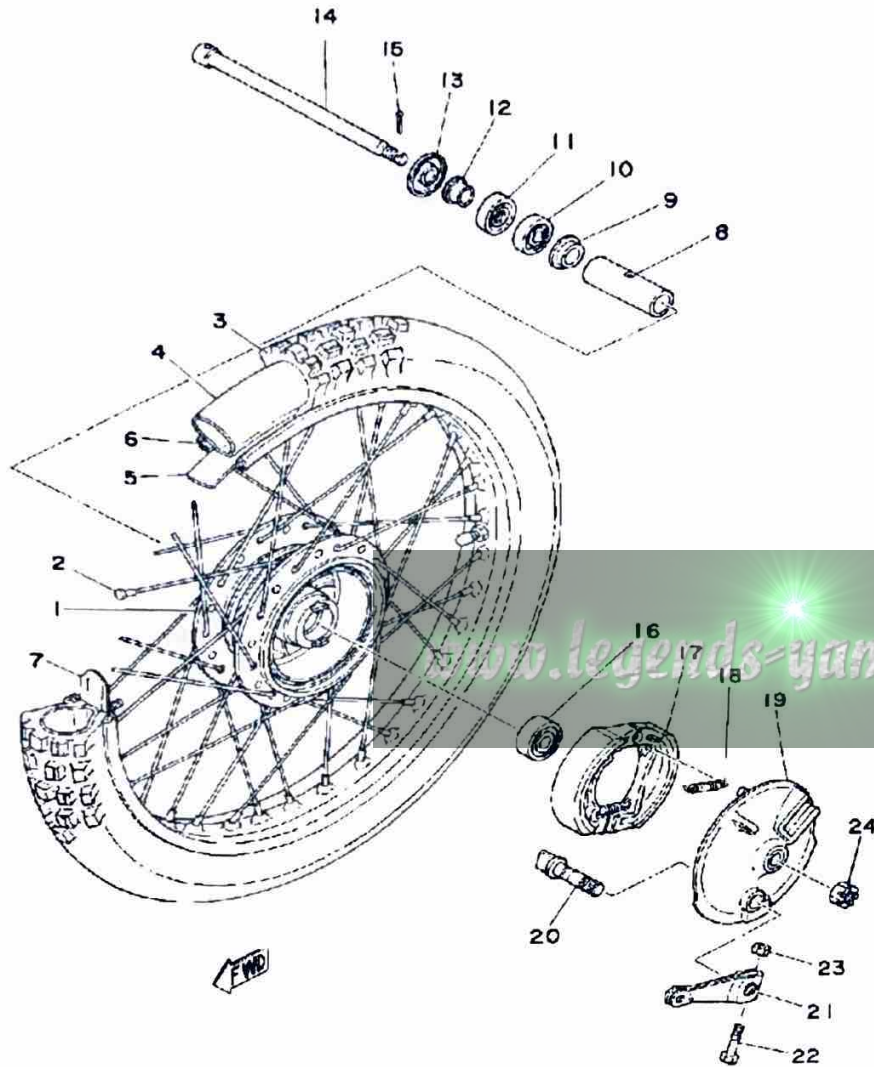

Ref. No.	Part Number	Description	Qty	Remarks
1	248-25111-00-98	HUB, FRONT	1	LOW GLOSS BLK
2	3M2-25104-00-00	SPOKE SET, FRONT	1	
3	(94127-21287-00)	275X21 IRC MX 5	1	
4	94230-21126-00	TUBE (3.00-21)	1	
5	(94330-21088-00)	BAND, RIM	1	
6	94416-21223-00	RIM 1.60X 1	1	
7	1T1-25194-00-00	SPACER, BEAD	1	
8	90560-12261-00	SPACER	1	
9	109-25315-00-00	FLANGE, SPACER	1	
10	93306-30103-00	BEARING (B6301Z)	1	
11	93102-18008-00	OIL SEAL	1	
12	90387-12265-00	COLLAR (183-25183-00)	1	
13	2K5-25118-00-00	COVER, HUB DUST	1	
14	353-25381-00-00	AXLE, WHEEL	1	
15	91490-20020-00	PIN, COTTER	1	
16	93306-30103-00	BEARING (B6301Z)	1	
17	22F-W2534-00-00	BRAKESHOE SET	2	
18	90506-16150-00	SPRING, TENSION (102-25333-00)	2	
19	2K5-25121-01-98	PLATE, BRAKE SHOE	1	LOW GLOSS BLK
20	122-25351-02-00	CAMSHAFT	1	
21	401-25155-11-00	LEVER, CAMSHAFT 1 (401-25155-00)	1	
22	90101-06278-00	BOLT	1	
23	95380-06600-00	NUT	1	
24	90171-10004-00	NUT, CASTLE	1	

REAR WHEEL

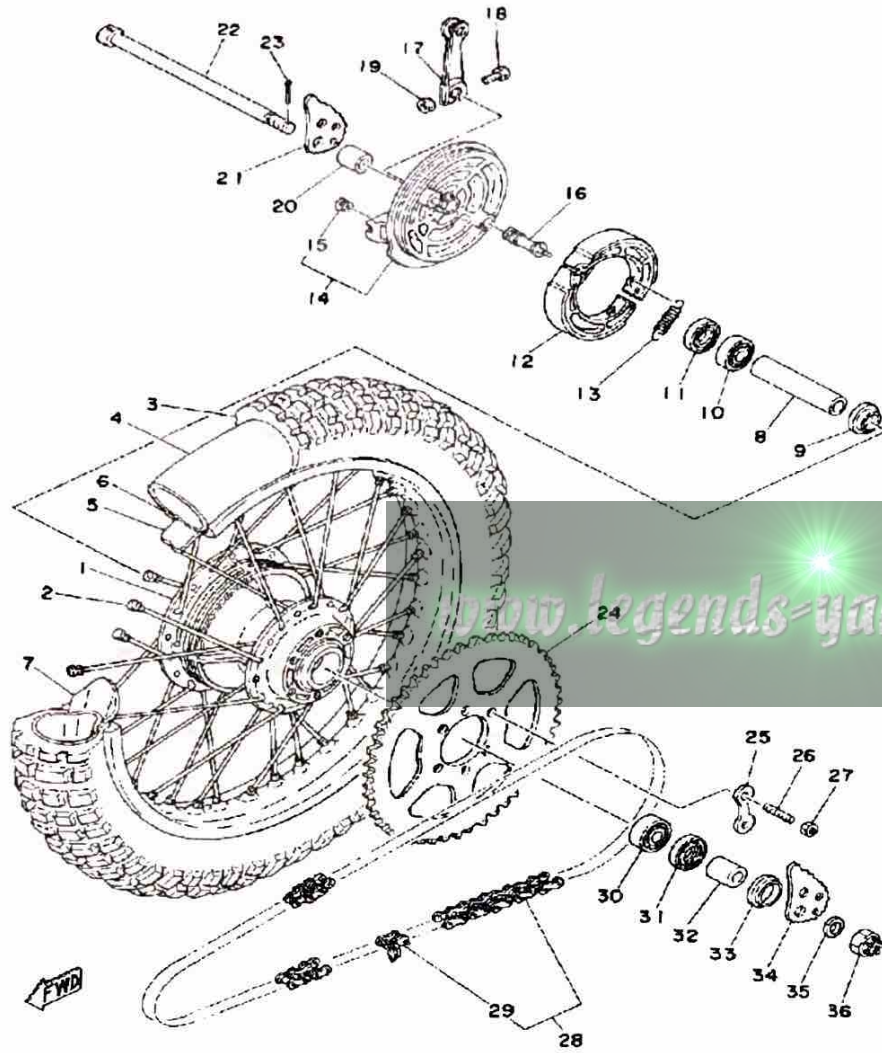

Ref. No.	Part Number	Description	Qty	Remarks
1	1W1-25311-00-98	HUB, REAR	1	LOW GLOSS BLK
2	401-25304-00-00	SPOKE SET, REAR	1	
3	(94135-18551-00)	CS 350X18 C-755 1	1	
4	94235-18085-00	TUBE	1	
5	94325-18043-00	BAND, RIM	1	
6	94418-18171-00	RIM 1.85X 8	1	
7	1T2-25394-00-00	SPACER, BEAD	1	
8	90560-15313-00	SPACER	1	
9	146-25115-00-00	FLANGE, SPACER 1	1	
10	93306-20204-00	BEARING (B6202Z)	1	
11	93104-22018-00	OIL SEAL	1	
12	437-W2536-00-00	BRAKESHOE SET-2PCS	2	
13	90506-17328-00	SPRING, TENSION	2	
14	99999-02024-00	BRAKE SHOE PLT ASSEMBLY (2A6-25026-00-98)BRAKE SHOE PLAT	1	
15	90480-10068-00	GROMMET	1	
16	2RH-25351-00-00	CAMSHAFT	1	
17	1E2-25155-00-00	LEVER, CAMSHAFT 1	1	
18	90101-06278-00	BOLT	1	
19	95380-06600-00	NUT	1	
20	90387-15524-00	COLLAR	1	
21	1W2-25389-01-00	PULLER, CHAIN 2	1	
22	5X3-25381-00-00	AXLE, WHEEL (2A6-25381-00-00)	1	
23	91401-30030-00	PIN, COTTER	1	
24	18L-25449-20-00	SPROCKET, DRVN 49T	1	
	1X0-25445-10-33	SPROCKET, DRVN 45T	1	
	2N0-25447-10-00	SPOCKET, DRVN 47T	1	YAMAHA BLACK
25	1G8-25412-00-00	WASHER	3	

CONTINUED ON NEXT FRAME ►

REAR WHEEL

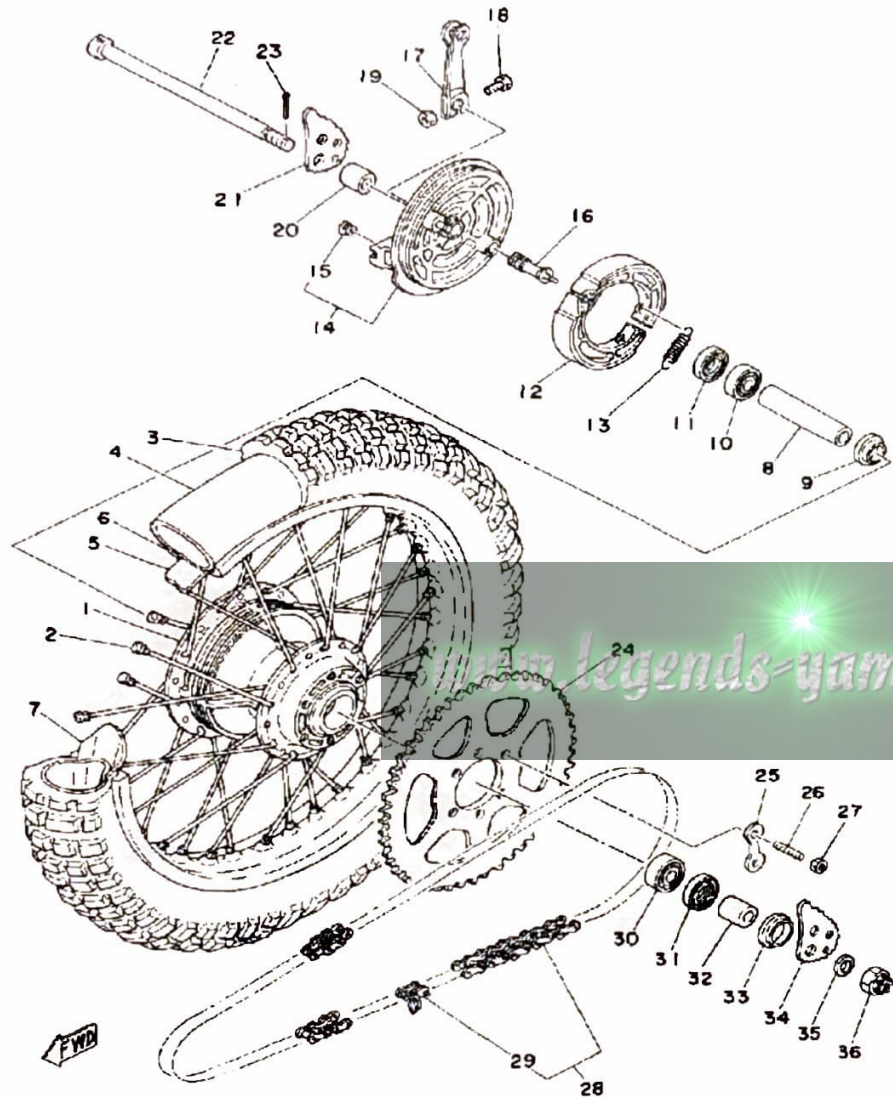

Ref. No.	Part Number	Description	Qty	Remarks
26	90116-10221-00	BOLT, STUD	6	
27	95701-10500-00	NUT, FLANGE (95702-10500) ..	6	
28	94580-33118-00	DID428DS-118L (94580-15118) .	1	
29	94680-15001-00	. JOINT CHAIN	1	
30	93306-30202-00	BEARING	1	
31	93106-26005-00	OIL SEAL	1	
32	90387-15524-00	COLLAR	1	
33	401-25367-00-00	COVER, HUB DUST	1	
34	1W2-25388-01-00	PULLER, CHAIN 1	1	
35	90201-15238-00	WASHER, PLATE	1	
36	90171-14020-00	NUT, CASTLE	1	

SPECIAL SERVICE TOOLS
TLU-11080-32-00 TIMING LIGHT

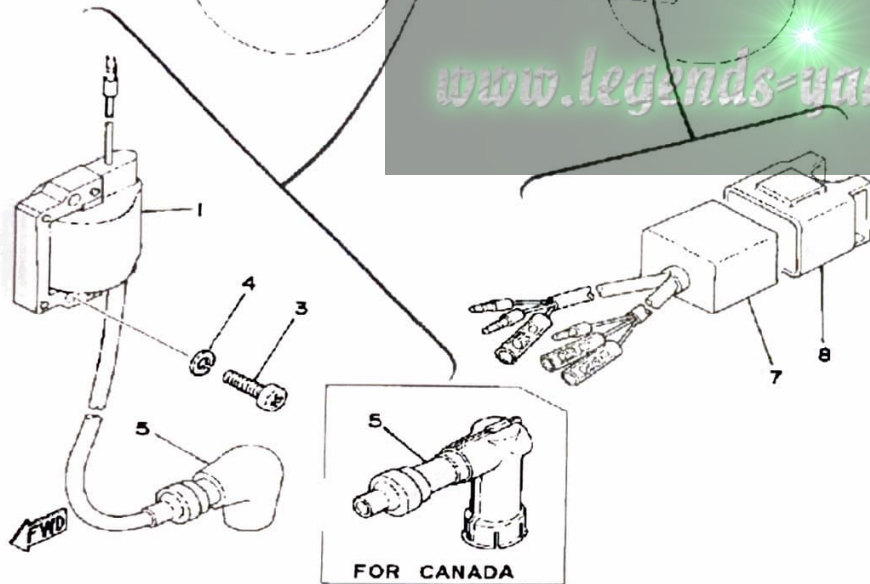
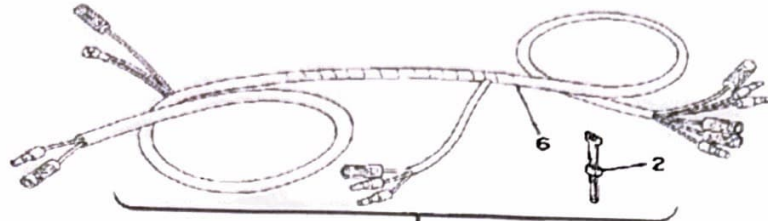

ELECTRICAL

Ref. No.	Part Number	Description	Qty	Remarks
1	5G4-82310-40-00	IGNITION COIL ASSEMBLY (J17-82310-21)	1	
2	437-83936-01-00	BAND, SWITCH CORD	4	
3	98580-06020-00	SCREW	2	
4	92995-06100-00	WASHER, SPRING	2	
5	81E-82370-20-00	PLUG CAP ASSEMBLY	1	
	8E7-82370-11-00	PLUG CAP ASSEMBLY	1	FOR CANADA
6	(3M2-82590-00-00)	WIRE HARNESS ASSEMBLY	1	
7	3M2-85540-20-00	CDI UNIT ASSEMBLY	1	
8	2A7-85546-00-00	BAND	1	

www.legends-yamaha-enduros.com

MX175F 1979 SERVICE DATA

MOTORCYCLE
MB-056

MODEL — IBM I.D. NUMBER	MX175F	3M2
Initial Engine Number/Frame Number	3M2-000101 / 3M2-000101	
Basic Color(s)	New White	
Fuel Type/Fuel Tank Capacity/Reserve Capacity	Regular / 6.8 Lit. (1.8 Gal.) / 0.9 Lit. (0.2 Gal.)	
Dry Vehicle Weight	91 kg (200 lbs.) / 6.8 Lit. (1.8 Gal.) / 0.9 Lit. (0.2 Gal.)	
ENGINE TYPE	2-Stroke, Air-Cooled, Reed Valve	
Bore/Stroke/Number Cylinders/Displacement (cc)	66mm / 50mm / 1 / 171cc	
Compression Ratio/Compression Pressure min ~ max	6.8:1 / ϕ	
Piston Skirt Clearance new/max.	0.040 ~ 0.045mm / 0.1mm	
Ring End Gap top/2nd/3rd	0.3 ~ 0.5mm / 0.3 ~ 0.5mm / ϕ	
Valve Clearance (cold) Intake/Exhaust	ϕ	
Oil Pressure hot/rpm	ϕ	
Oiling System	Autolube	
Capacity: Dry	1.0 Lit.	
Oil and Filter Change	ϕ	
Oil Change	ϕ	
Lubricant: Temp above 5°C (40°F)	Yamalube 2*	
Below 15°C (60°F)	Yamalube 2*	
AUTOLUBE — Min. Stroke/Color Code	0.20 ~ 0.25mm / Gray	
Minimum Output @ 200 cycles	0.50cc	
Maximum Output @ 200 cycles	5.13cc	
CARBURETOR — Mfr./Type/I.D. Number	Mikuni / VM24SS / 3M200	
Main Jet/Pilot Jet	130 / 27.5	
Needle Jet/Jet Needle Clip Position	0.2 / 4L6.3	
Slide Cutaway or Throttle Valve	3.0	
Float Level	21.0 ± 1.0mm	
Idle RPM	ϕ	
CO % @ Idle (Diagnostic Use Only)	ϕ	
SUSPENSION		
Front Forks: Oil Type/Level/Qty	10 wt. Fork Oil* / ϕ / 179cc	
Gas Pressure	ϕ	
Spring Length Std.	453.5mm	
Monoshock: Oil Type/Qty	Not Rebuildable	
Gas Pressure	15 kg/cm ²	
Minimum Brake Lining Thickness	Front: 2mm Rear: 2mm	
Tire Size (Nominal Pressure)	F: 2.75-21 (0.9 kg/cm ² / 13 psi) R: 3.50-18 (1.1 kg/cm ² / 16 psi)	
TRANSMISSION — Oil Type/Qty Chg/Qty Reassemble	SAE 10W30 SE / 650cc / 750cc	
Primary Drive Type/Teeth/Ratio	Helical Gear / 71:22 / 3.227	
Secondary Drive Type/Teeth/Chain	Chain / 49:15 / DID428DSM-118L	
Clutch Friction Plate Thickness Std ~ min.	3.0 ~ 2.8mm	
Clutch Spring Length Std ~ min.	33.0 ~ 32.0mm	
Middle Gear Case Capacity	ϕ	
Final Gear Case Capacity	ϕ	
Gear Case Lubricant: Temp above 5°C (40°F)	ϕ	
Temp below 15°C (60°F)	ϕ	
All Weather Conditions	ϕ	

Service Copy _____ Service Mgr. _____ Mechanic _____ Mechanic _____ Mechanic _____ Binder _____

Office Copy _____ General Mgr _____ Sales _____ Parts _____ Binder _____

©YAMAHA MOTOR CORPORATION, U. S. A., BUENA PARK, CALIFORNIA December 9, 1978 PAGE 1 OF 2

CHARGING SYSTEM	Flywheel Magneto
Battery: Model / Spec. Grav. / Chg. Rate	ϕ
Maximum Output	ϕ
TROUBLESHOOTING	
Field Coil Color Code / Ω	ϕ
Charge Coil Color Code / Ω	ϕ
IGNITION SYSTEM	Capacitor Discharge Ignition
Ignition Timing	1.8mm BTDC
Spark Plug Type	NGK B8ES
Spark Plug Gap / Torque / Cap Ω	0.6 ~ 0.8mm / 2.0 m·kg / 5K Ω ± 10%
Point Gap / Condenser Capacitance	ϕ
TROUBLESHOOTING	
Ignition Coil Test Gap / Primary Ω / Secondary Ω	6mm / 1.0 Ω ± 10% / 5.9K Ω ± 20%
Pulse Coil or Pick-up Coil Color Code / Ω	Wht-Red ~ Blk / 10 Ω ± 10%
Source Coil Color Code / Ω	Brn-Blk / 300 Ω ± 10%
LIGHTING SYSTEM	
Headlight / Taillight / Signal Rating	ϕ
TROUBLESHOOTING	
Lighting Coil Color Code / Ω	ϕ
TORQUE VALUES	
Front Axle Nut	10 x 1.25: 4.0 m·kg
Front Axle Holder Nut	ϕ
Rear Axle Nut	14 x 1.5: 8.5 m·kg
Rear Axle Pinch Bolt	ϕ
Clutch Nut	14 x 1.5: 5.0 m·kg
Drain Plug	12 x 1.5: 2.5 m·kg
Cylinder Head Cover	ϕ
Cylinder Head:	Nut 8 x 1.25: 2.5 m·kg
	Stud 8 x 1.25: 2.5 m·kg
Engine Mounting Bolts:	Front
	Rear, Upper
	Rear, Lower
	8 x 1.25: 2.5 m·kg
	8 x 1.25: 2.5 m·kg
	10 x 1.25: 4.0 m·kg

ϕ Does Not Apply to This Model

* Available From Yamaha Parts Distributors, Inc.

PAGE 2 OF 2

CHARGING SYSTEM	Flywheel Magneto
Battery: Model / Spec. Grav. / Chg. Rate	φ
Maximum Output	φ
TROUBLESHOOTING	
Field Coil Color Code / Ω	φ
Charge Coil Color Code / Ω	φ
IGNITION SYSTEM	Capacitor Discharge Ignition
Ignition Timing	1.8mm BTDC
Spark Plug Type	NGK BBES
Spark Plug Gap / Torque / Cap Ω	0.6 ~ 0.8mm / 2.0 m·kg / 5K Ω ± 10%
Point Gap / Condenser Capacitance	φ
TROUBLESHOOTING	
Ignition Coil Test Gap / Primary Ω / Secondary Ω	6mm / 1.0 Ω ± 10% / 5.9K Ω ± 20%
Pulse Coil or Pick-up Coil Color Code / Ω	Wht-Red ~ Blk / 10 Ω ± 10%
Source Coil Color Code / Ω	Brn-Blk / 300 Ω ± 10%
LIGHTING SYSTEM	
Headlight / Taillight / Signal Rating	φ
TROUBLESHOOTING	
Lighting Coil Color Code / Ω	φ
TORQUE VALUES	
Front Axle Nut	10 x 1.25: 4.0 m·kg
Front Axle Holder Nut	φ
Rear Axle Nut	14 x 1.5: 8.5 m·kg
Rear Axle Pinch Bolt	φ
Clutch Nut	14 x 1.5: 5.0 m·kg
Drain Plug	12 x 1.5: 2.5 m·kg
Cylinder Head Cover	φ
Cylinder Head:	
	Nut 8 x 1.25: 2.5 m·kg
	Stud 8 x 1.25: 2.5 m·kg
Engine Mounting Bolts:	
Front	8 x 1.25: 2.5 m·kg
Rear, Upper	8 x 1.25: 2.5 m·kg
Rear, Lower	10 x 1.25: 4.0 m·kg

φ Does Not Apply to This Model

* Available From Yamaha Parts Distributors, Inc.

www.legends-yamaha-enduros.com

www.legends-yamaha-enduros.com