



# YAMAHA

[www.legends-yamaha-enduros.com](http://www.legends-yamaha-enduros.com)

# YZ80J

## SUPPLEMENTARY ASSEMBLY MANUAL



## FOREWORD

This Supplementary assembly manual has been prepared to introduce the setup procedures and predelivery service for the YZ80J.

For complete information, it is necessary to use the YZ/IT series Basic assembly manual (LIT-11666-03-31) together with this Supplementary assembly manual.

## NOTICE

The service specifications given in this Supplementary assembly manual are based on the model as manufactured. Modifications and significant changes in specifications and/or procedures will be forwarded to Authorized Yamaha Dealers. The procedures below are described in the order that the procedures are carried out correctly and completely. Failure to do so can result in poor performance and possible harm to the machine and/or rider.

**CONCERNING CRATE DAMAGE:** \_\_\_\_\_

Follow the instructions in the Dealer warranty handbook, Procedure section.

---

Particularly important information is distinguished in this manual by the following notations:

**NOTE:** A NOTE provides key information to make procedure easier or clearer.

**CAUTION:** A CAUTION indicates special procedures that must be followed to avoid damage to the machine.

**WARNING:** A WARNING indicates special procedures that must be followed to avoid injury to a machine operator or person inspecting or repairing the machine.

SERVICE DEPT.  
INTERNATIONAL DIVISION  
YAMAHA MOTOR CO., LTD.

**YZ80J SUPPLEMENTARY  
ASSEMBLY MANUAL**

© 1981 by Yamaha Motor Corporation, U.S.A.  
1st edition, August 1981

All rights reserved. Any reprinting or  
unauthorized use without the written permission of  
Yamaha Motor Corporation, U.S.A.,  
is expressly prohibited

Printed in U.S.A.

LIT-11666-03-18

## **GLOSSARY**

(Symbols most commonly used)

- C** : The "C" marked parts are contained in the small carton box.
- S** : The "S" marked parts are contained in the styrofoam tray (Upper or Lower).
- V** : The "V" marked parts are contained in the vinyl bag.
- \*** : The asterisk (\*) parts are temporarily fitted on the machine.

# SETUP PROCEDURES

**NOTE:** \_\_\_\_\_

Please read the following chapters in the Basic assembly manual before proceeding to the setup.

CHAPTER 1: INTRODUCTION

CHAPTER 2: SETUP AND PREDELIVERY CHECK

CHAPTER 3: TOOLS AND TORQUE SPECIFICATIONS

CHAPTER 4: CRATES

CHAPTER 5: INSTALLATION PROCEDURES

## ① Front fender [F.F – A]

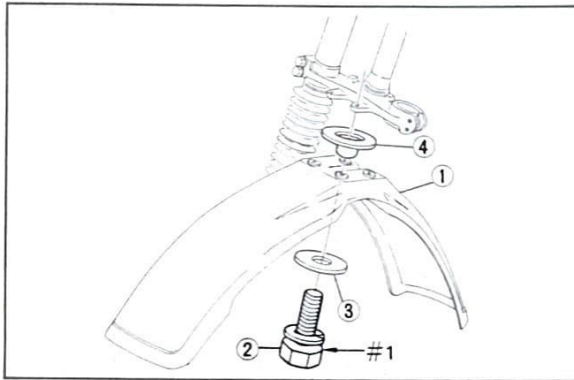

### Parts list

No.	Part name	Q'ty	Locating mark	Remarks
1	Front fender	1	S	
2	Hexagon bolt with spring washer	4	V	d = 6 mm (0.24 in), ℓ = 20 mm (0.79 in)
3	Plain washer	4	V	d = 6 mm (0.24 in)
4	Special washer	4	V	d = 6 mm (0.24 in)

## ② Front wheel [F.W – A]

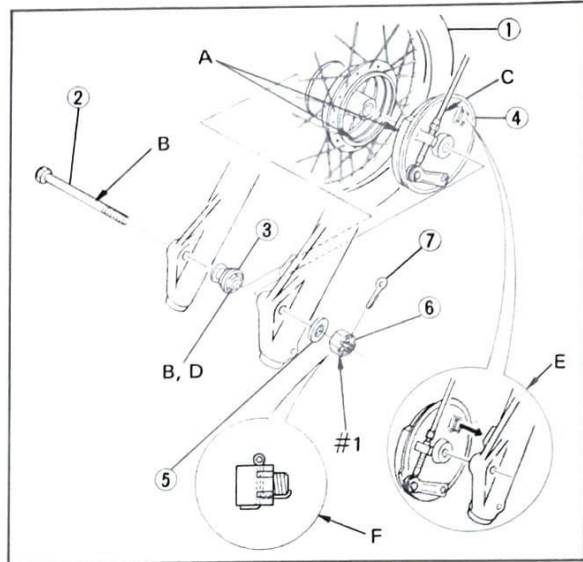

### Parts list

No.	Part name	Q'ty	Locating mark	Remarks
1	Front wheel	1	S	
2	Front wheel axle	1	*	
3	Wheel axle collar	1	V	
4	Brake shoe plate assembly	1	S	
5	—	—	—	—
6	Castle nut	1	*	
7	Cotter pin	1	V	d = 3 mm (0.12 in), ℓ = 25 mm (0.98 in)

## ③ Cable holder [C.H – C]

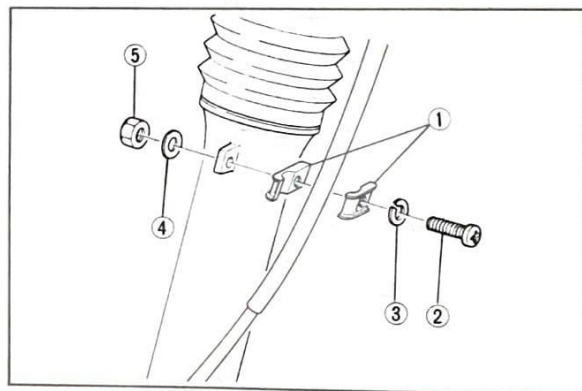

### Parts list

No.	Part name	Q'ty	Locating mark	Remarks
1	Cable holder (Left and Right)	2	*	
2	Panhead screw	1	*	d = 6 mm (0.24 in), ℓ = 25 mm (0.98 in)
3	Spring washer	1	*	d = 6 mm (0.24 in)
4	Plain washer	1	*	d = 6 mm (0.24 in)
5	Hexagon nut	1	*	d = 6 mm (0.24 in)

[www.legends-yamaha-enduros.com](http://www.legends-yamaha-enduros.com)



#### 4 Handlebar [H.B – A]

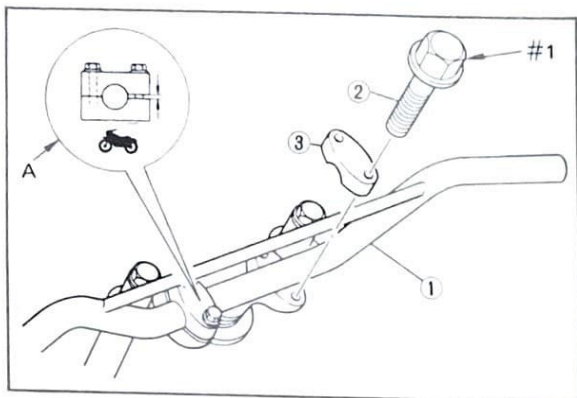

#### Parts list

No.	Part name	Q'ty	Locating mark	Remarks
1	Handlebar	1	S	
2	Flange bolt	4	V	d = 8 mm (0.32 in), ℓ = 35 mm (1.4 in)
3	Handlebar upper holder	2	V	

#### 5 Throttle grip [T.G – B]

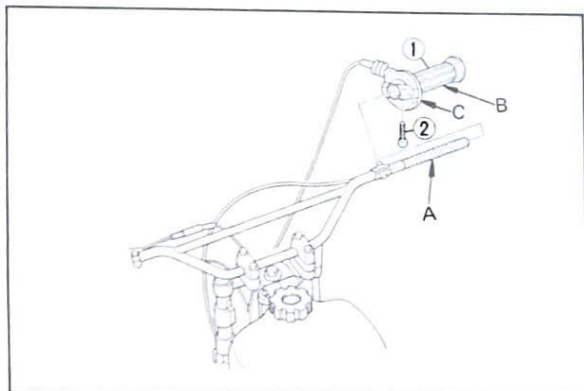

#### Parts list

No.	Part name	Q'ty	Locating mark	Remarks
1	Throttle grip	1	*	
2	Panhead screw	2	*	d = 5 mm (0.2 in), ℓ = 16 mm (0.63 in)

#### 6 Brake and clutch cable [B.C – A]

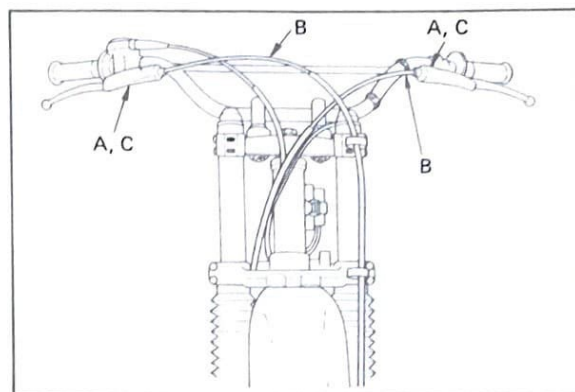

#### 7 Engine stop switch [E.S – B]

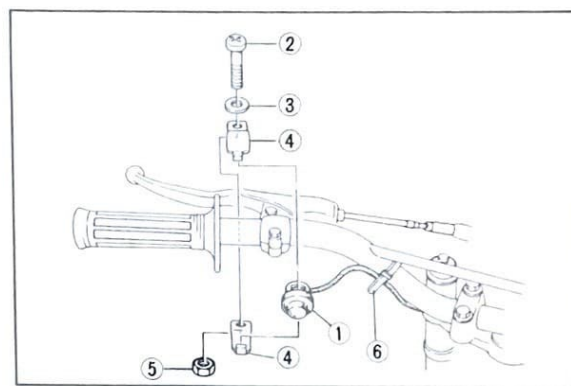

#### Parts list

No.	Part name	Q'ty	Locating mark	Remarks
1	Engine stop switch	1	*	
2	Panhead screw	1	V	d = 3 mm (0.12 in)
3	Plain washer	1	V	d = 3 mm (0.12 in)
4	Engine stop switch holder (Upper and Lower)	2	V	
5	Hexagon nut	1	V	d = 3 mm (0.12 in)
6	Handlebar band	2	V	Plastic

### 8 Fuel tank breather pipe [F.B – E]

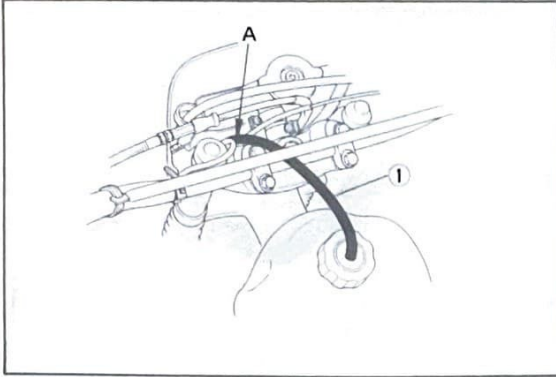

#### Parts list

No.	Part name	Q'ty	Locating mark	Remarks
1	Fuel tank breather pipe	1	C	Rubber

### 9 Footrest [F.R – B]

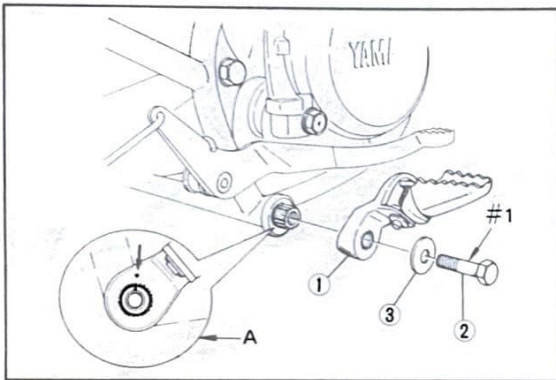

#### Parts list

No.	Part name	Q'ty	Locating mark	Remark
1	Footrest (Right)	1	S	
2	Hexagon bolt	1	V	d = 10 mm (0.4 in), ℓ = 16 mm (0.63 in)
3	Plain washer	1	V	d = 10 mm (0.4 in)

### Fender plate

This fender plate prevents the number plate grille from clogging with mud. It should be used only when you ride the machine in the rain.

**NOTE:** \_\_\_\_\_  
 Don't use this plate when it is raining.

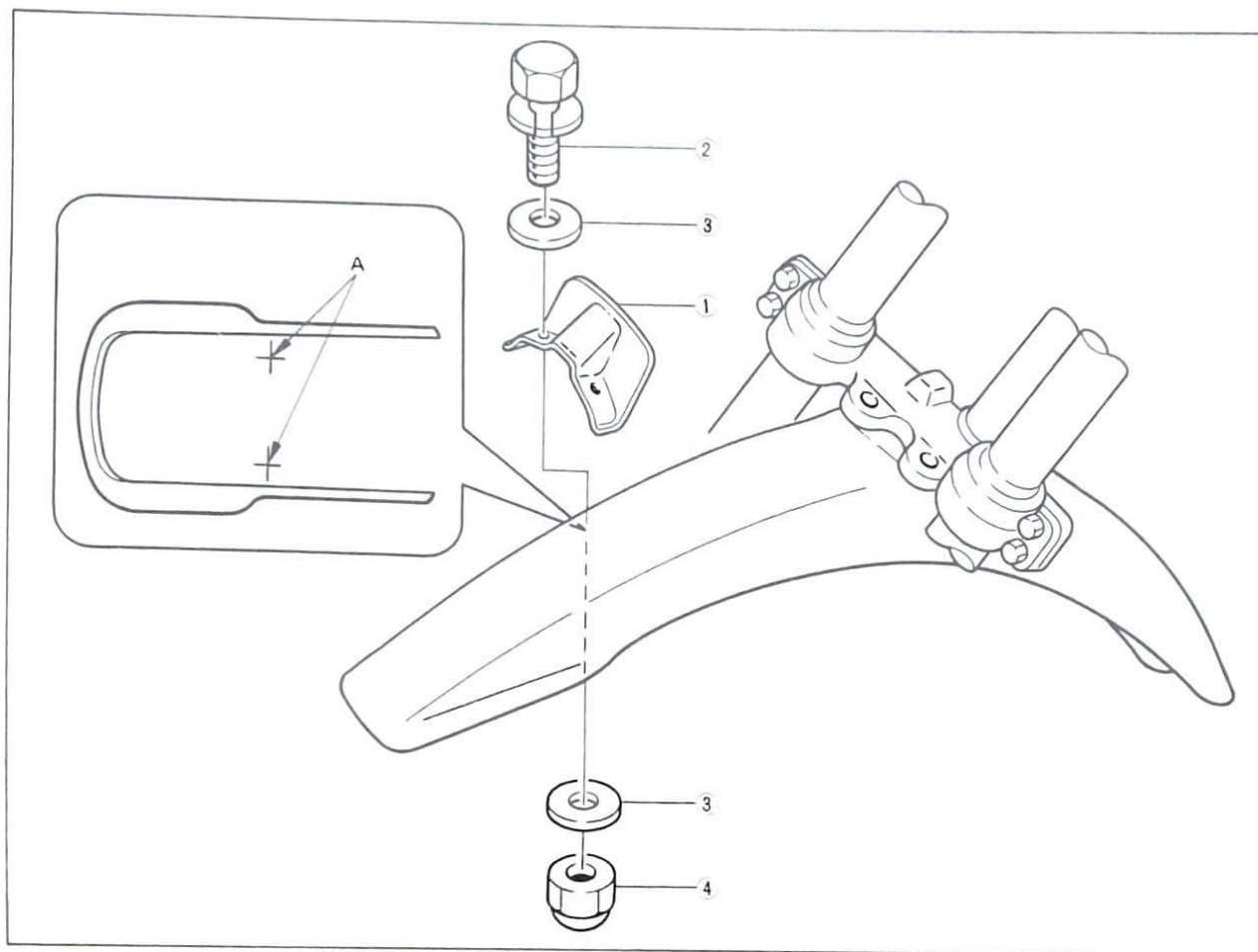

### Parts list

No.	Part name	Q'ty	Locating mark	Remark
1	Fender plate	1	V	
2	Hexagon bolt with spring washer	2	V	d = 6 mm (0.24 in), ℓ = 16 mm (0.63 in)
3	Plain washer	4	V	d = 6 mm (0.24 in)
4	Self-locking nut	2	V	d = 6 mm (0.24 in)

### Setup points

A: Drill two 6 mm holes in the front fender with embossed crosses on the inside as a guide.

### CAUTION:

While drilling holes, hold the front fender steady.

# CABLE ROUTING

**CAUTION:**

Proper cable and lead routing is essential to insure safe vehicle operation. REFER TO "CABLE ROUTING".

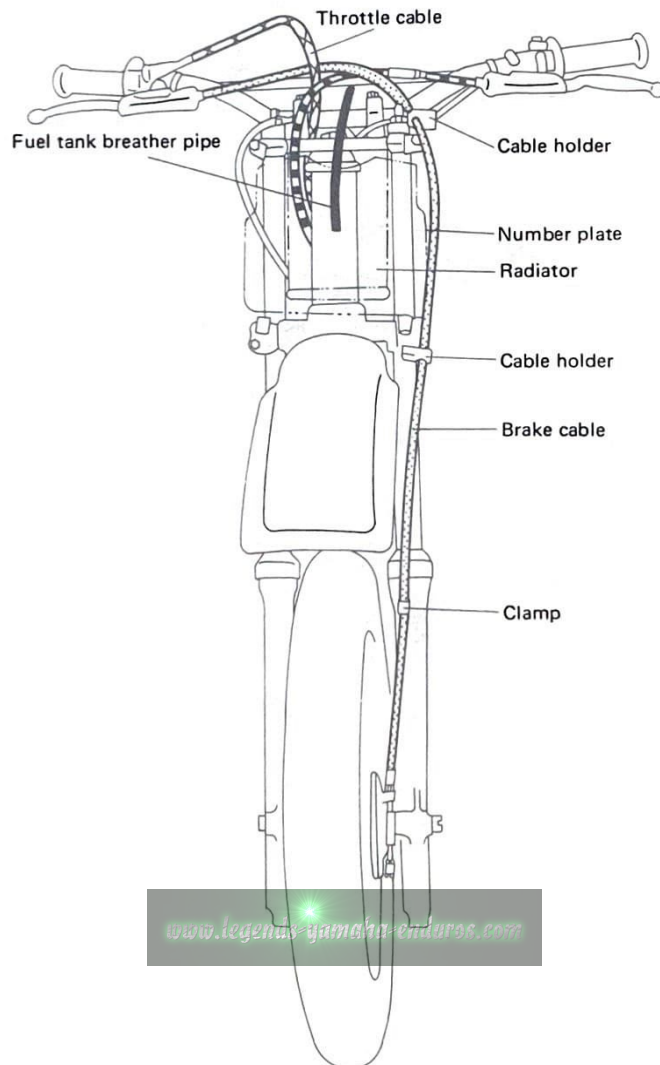
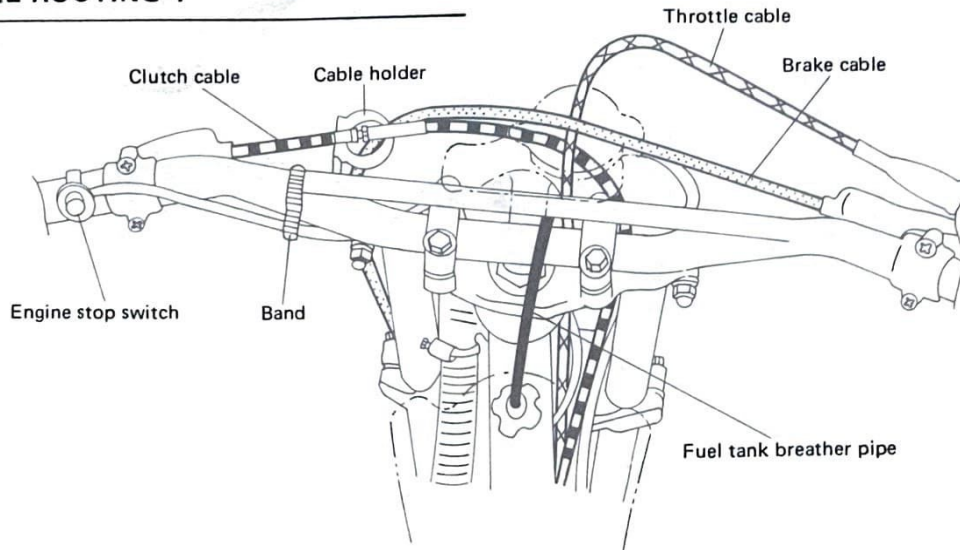

[www.legendaryyamaharenduros.com](http://www.legendaryyamaharenduros.com)



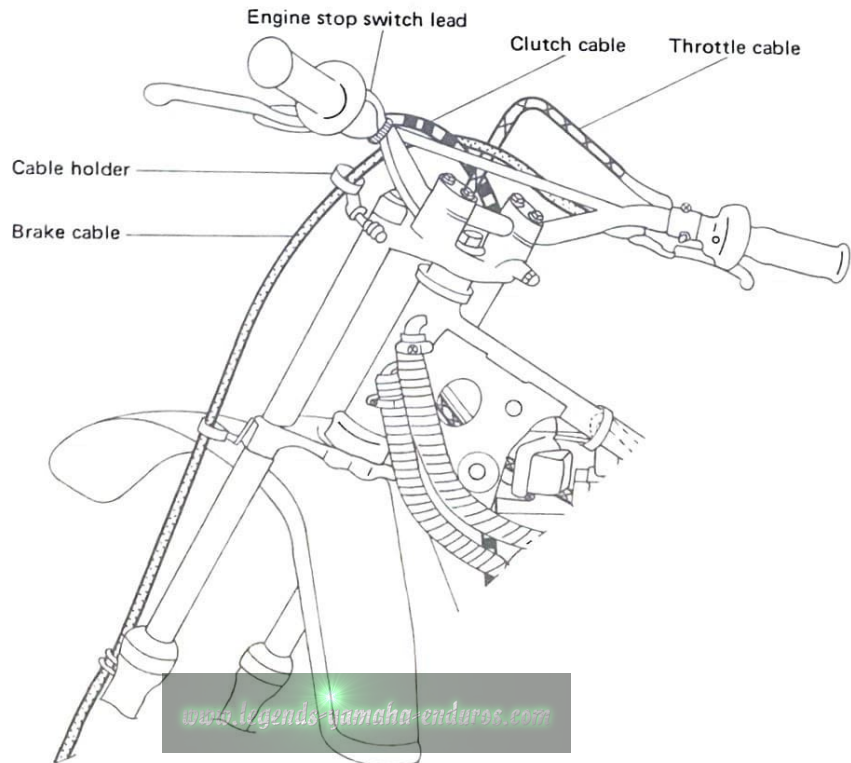
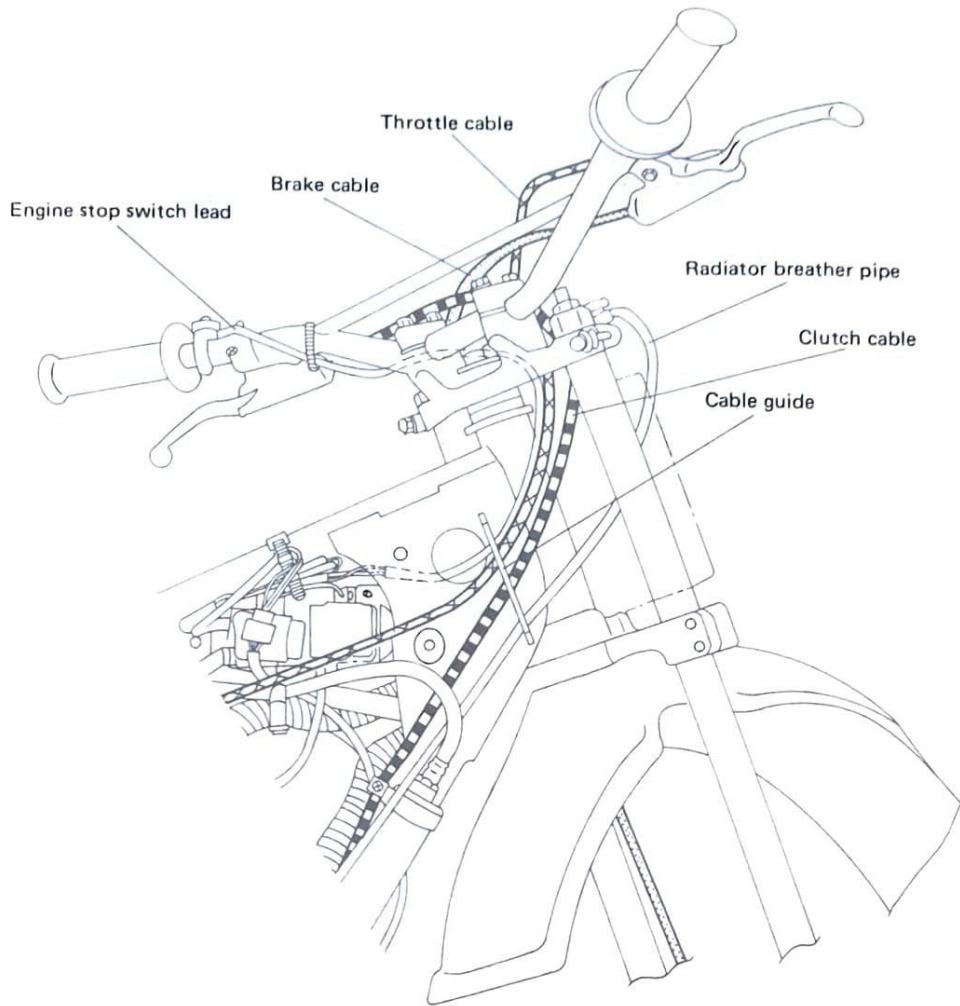

# ADJUSTMENTS AND PREDELIVERY SERVICE

**NOTE:** \_\_\_\_\_  
Please read the following chapter in the Basic assembly manual before preceeding to the adjustments and predelivery service.  
CHAPTER 6: APPENDICES

---

## ① Front brake adjustment [F.B – A]

Front brake lever free play:  
5 ~ 8 mm (0.2 ~ 0.3 in)

## ② Rear brake pedal position adjustment [R.B – A]

## ③ Rear brake adjustment [R.B – A]

Rear brake pedal free play:  
20 ~ 30 mm (0.8 ~ 1.2 in)

## ④ Clutch adjustment [C.A – A]

Clutch lever free play:  
2 ~ 3 mm (0.08 ~ 0.12 in)

## ⑤ Throttle cable adjustment [T.C – A]

Throttle cable free play:  
3 ~ 5 mm (0.12 ~ 0.21 in)

## ⑥ Fuel draining [F.D – A]

## ⑦ Transmission oil level check [T.L – A]

## ⑧ Drive chain tension check [D.C – A]

Drive chain deflection:  
15 ~ 20 mm (0.6 ~ 0.8 in)

## ⑨ Troubleshooting [T.S – A]

## SERVICE DATA

Spark plug: Type Gap	N-2C (CHAMPION) 0.7 ~ 0.8 mm (0.028 ~ 0.031 in)
Fuel: Recommended fuel Fuel tank capacity	Premium gasoline (Mixed gas 24 : 1) 5.2 L (1.1 Imp gal, 1.4 US gal)
Engine oil: Recommended oil	Yamalube Racing 2-cycle oil (See Owner's manual)
Transmission oil: Recommended oil Oil quantity (Periodic oil change)	Yamalube 4-cycle oil or SAE 10W30 motor oil 650 cm <sup>3</sup> (0.57 Imp qt, 0.69 US qt)
Coolant: Recommended coolant  Coolant and water mixed ratio Total amount	High quality ethylene glycol anti-freeze containing corrosion inhibitors for aluminum engine 1 : 1 (50% water, 50% coolant) 1 L (0.88 Imp qt, 1.06 US qt)
Tire pressure (Cold tire pressure): Front Rear	98.1 kPa (1.0 kg/cm <sup>2</sup> , 14 psi) 98.1 kPa (1.0 kg/cm <sup>2</sup> , 14 psi)

## TORQUE SPECIFICATION CHART

Parts to be tightened	Tightening torque		
	Nm	m·kg	ft·lb
Spark plug	25	2.5	18
Drain bolt	20	2.0	14
Front fender and under bracket (F.F – A)	74	7.4	53
Front wheel axle (F.W – A)	7	0.7	5.1
Handle crown and steering shaft	130	13.0	94
Handle crown and inner tube	18	1.8	13
Handle crown and handle holder (H.B – A)	27	2.7	19
Footrest and frame (F.R – B)	50	5.0	36
Rear wheel axle	85	8.5	61
Sidestand	21	2.1	15
Rear fender and frame	17	1.7	12

## OWNER'S TOOL KIT

No.	Part name	Q'ty
1	Owner's tool bag	1
2	Spark plug wrench	1
3	Box handle	1
4	Special spanner (4)	1
5	Rotor puller	1



**YAMAHA MOTOR CO., LTD.**

IWATA, JAPAN

PRINTED IN U.S.A.